

22

NOTES:

Shutter Color: Timeless White(覆盖色)

Hinges Color: White(白色)

Qty(数量): 1

Material(材质): Palowania(桐木)

Configuration(窗扇结构): L, IN, 4Side, 41.3mm Butt, Deep Plain L Frame 60mm

Tilt rod type(拉杆类型): Easy tilt rod(齿条拉杆)

Louvre Quantity(叶片数量): 22

Louvre Size(叶片尺寸): 497mm

Rail Size(上下板尺寸): 549mm

Order No(订单号): SCO SB 8035 GIBSON

Item(序号): 1

Room(房间号): LIV L

Louvre Size(叶片类型): 76mm

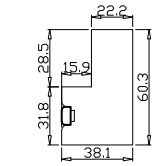

Deep Plain L Frame 60mm



Batten: 40*5*1636 (mm) *2
40*5*1643 (mm) *2

Timeless White(覆盖色)

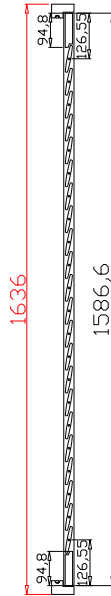
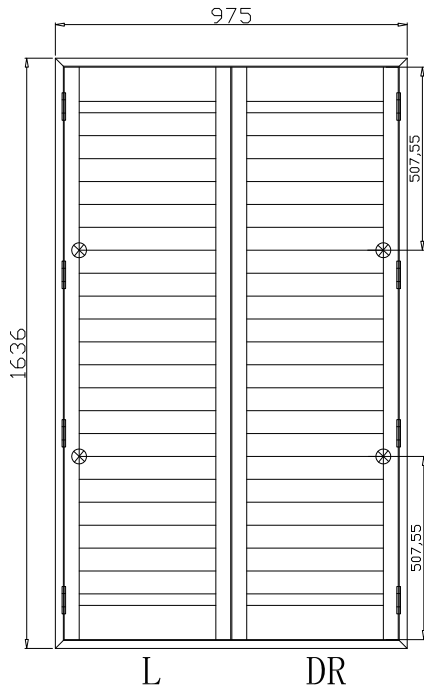
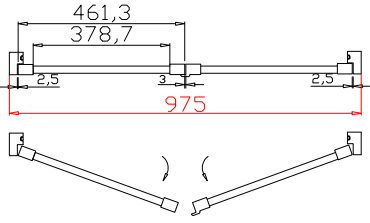

22

NOTES:

Shutter Color: Timeless White(覆盖色)

Hinges Color: White(白色)

Qty(数量): 1

Material(材质): Palowania(桐木)

Configuration(窗扇结构): L-DR,IN, 4Side, 41.3mm Astrigal, Deep Plain L Frame 60mm

Tilt rod type(拉杆类型): Easy tilt rod(齿条拉杆)

Louvre Quantity(叶片数量): 44

Louvre Size(叶片尺寸): 376.7mm

Rail Size(上下板尺寸): 428.7mm

Order No(订单号): SCO SB 8035 GIBSON

Item(序号): 2

Room(房间号): LIV M

Louvre Size(叶片类型): 76mm

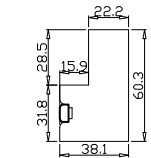

Deep Plain L Frame 60mm

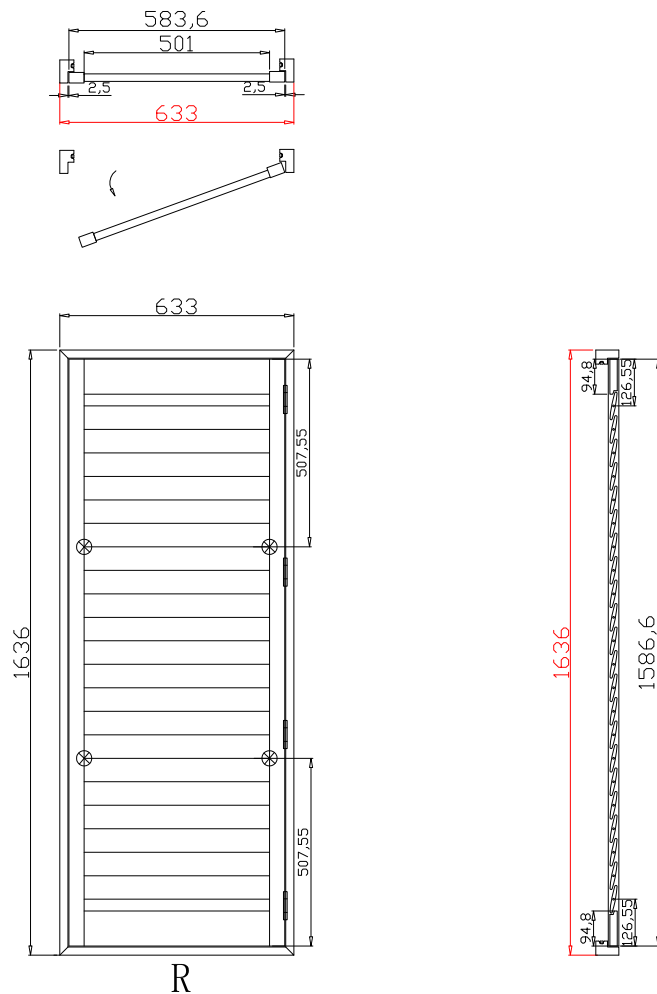

22

NOTES:

Shutter Color:Timeless White(覆盖色)

Hinges Color:White(白色)

Qty(数量): 1

Material(材质): Palowania(桐木)

Configuration(窗扇结构): R,IN, 4Side, 41.3mm Butt, Deep Plain L Frame 60mm

Tilt rod type(拉杆类型): Easy tilt rod(齿条拉杆)

Louvre Quantity(叶片数量): 22

Louvre Size(叶片尺寸): 499mm

Rail Size(上下板尺寸): 551mm

Order No(订单号):SCO SB 8035 GIBSON

Item(序号): 3

Room(房间号): LIV R

Louvre Size(叶片类型): 76mm

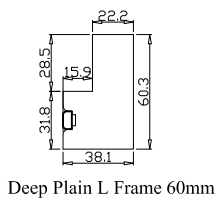

Deep Plain L Frame 60mm

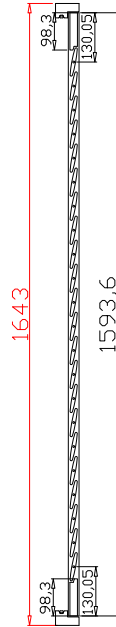
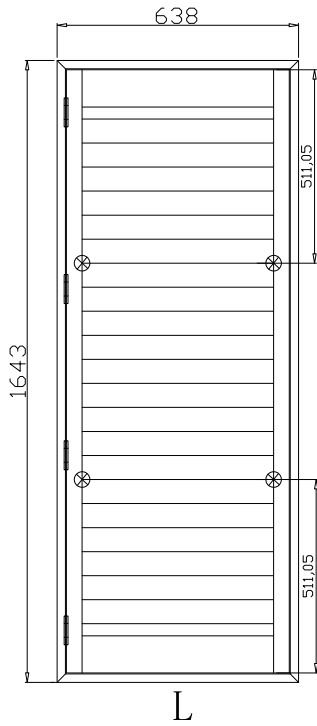
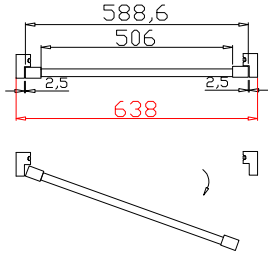

22

NOTES:

Shutter Color: Timeless White(覆盖色)

Hinges Color: White(白色)

Qty(数量): 1

Material(材质): Palowania(桐木)

Configuration(窗扇结构): L, IN, 4Side, 41.3mm Butt, Deep Plain L Frame 60mm

Tilt rod type(拉杆类型): Easy tilt rod(齿条拉杆)

Louvre Quantity(叶片数量): 22

Louvre Size(叶片尺寸): 504mm

Rail Size(上下板尺寸): 556mm

Order No(订单号): SCO SB 8035 GIBSON

Item(序号): 4

Room(房间号): BED L

Louvre Size(叶片类型): 76mm

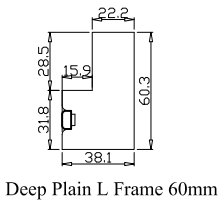

Deep Plain L Frame 60mm

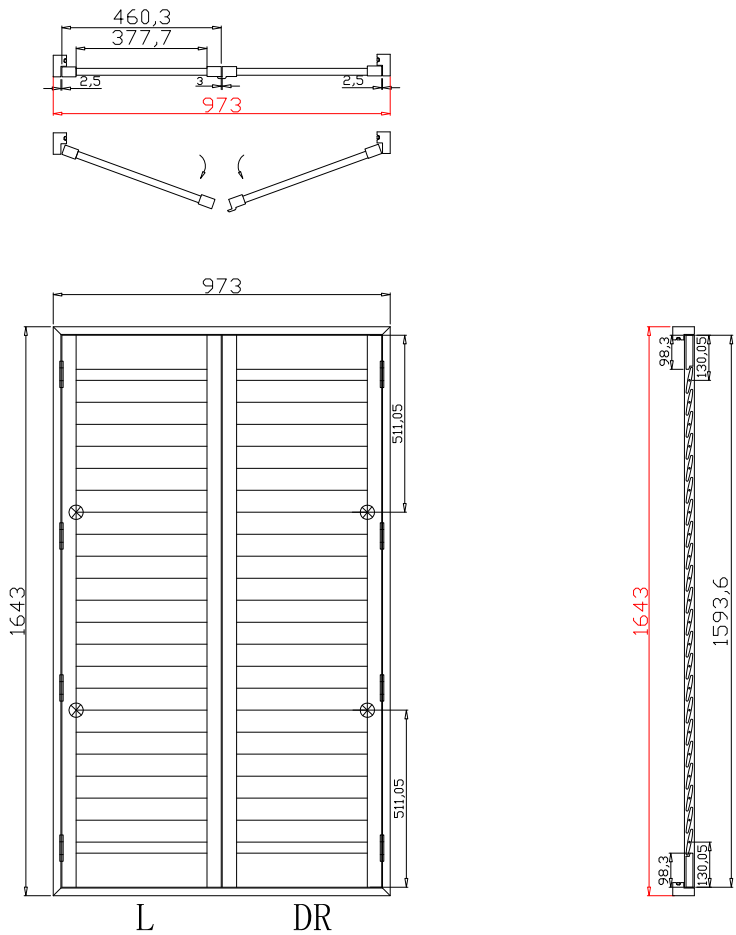

22

NOTES:

Shutter Color: Timeless White(覆盖色)

Hinges Color: White(白色)

Qty(数量): 1

Material(材质): Palowania(桐木)

Configuration(窗扇结构): L-DR, IN, 4Side, 41.3mm Astrigal, Deep Plain L Frame 60mm

Tilt rod type(拉杆类型): Easy tilt rod(齿条拉杆)

Louvre Quantity(叶片数量): 44

Louvre Size(叶片尺寸): 375.7mm

Rail Size(上下板尺寸): 427.7mm

Order No(订单号): SCO SB 8035 GIBSON

Item(序号): 5

Room(房间号): BED M

Louvre Size(叶片类型): 76mm

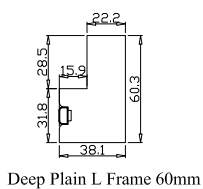

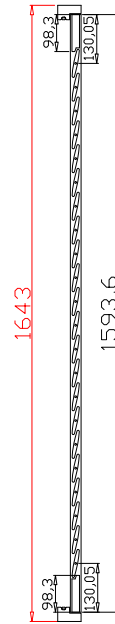
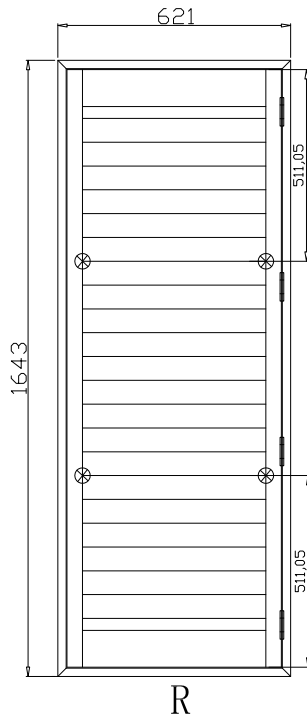
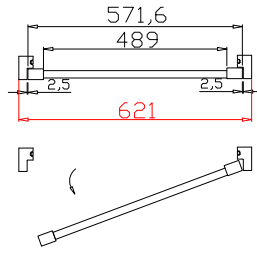

22

NOTES:

Shutter Color: Timeless White(覆盖色)

Hinges Color: White(白色)

Qty(数量): 1

Material(材质): Palowania(桐木)

Configuration(窗扇结构): R, IN, 4Side, 41.3mm Butt, Deep Plain L Frame 60mm

Tilt rod type(拉杆类型): Easy tilt rod(齿条拉杆)

Louvre Quantity(叶片数量): 22

Louvre Size(叶片尺寸): 487mm

Rail Size(上下板尺寸): 539mm

Order No(订单号): SCO SB 8035 GIBSON

Item(序号): 6

Room(房间号): BED R

Louvre Size(叶片类型): 76mm

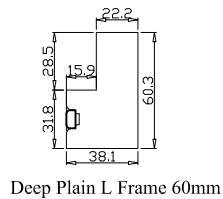

Deep Plain L Frame 60mm