

4

16

NOTES:

Shutter Color: Timeless White(覆盖色)

Hinges Color: White(白色)

Qty(数量): 1

Material(材质): Palowania(桐木)

Configuration(窗扇结构): LDL-DRDR,IN, 4Side, 41.3mm Astrigal, 46mm Plain L

Tilt rod type(拉杆类型): Easy tilt rod(齿条拉杆)

Louvre Quantity(叶片数量): 80

Louvre Size(叶片尺寸): 345.7mm

Rail Size(上下板尺寸): 397.7mm

Order No(订单号): ABC 50835 RYAN

Item(序号): 1

Room(房间号):

Louvre Size(叶片类型): 76mm

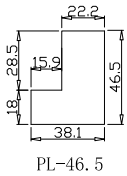

PL-46.5

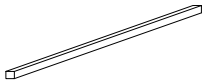

Batten: 3\*30\*1600 (mm)\*6  
Timeless White(覆盖色)

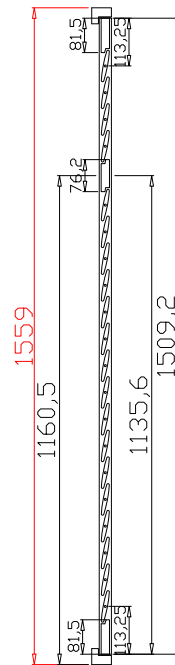
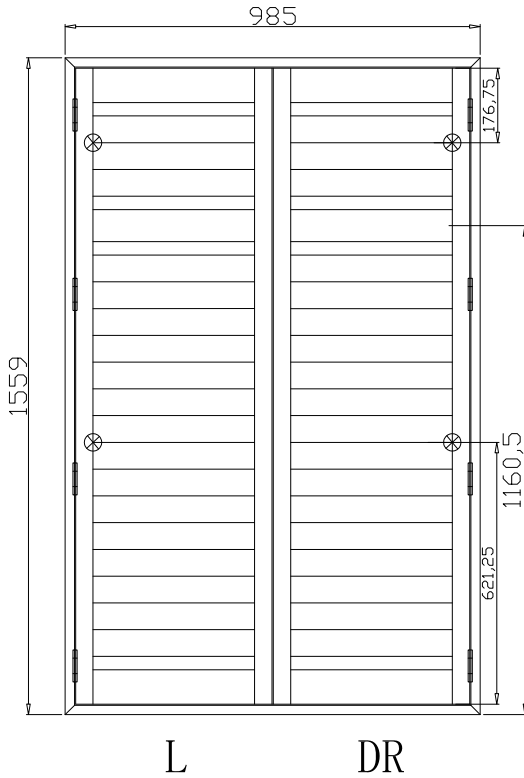
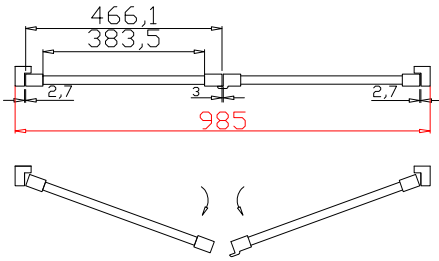

4

16

**NOTES:**

Shutter Color: Timeless White(覆盖色)

Hinges Color: White(白色)

Qty(数量): 1

Material(材质): Palowania(桐木)

Configuration(窗扇结构): L-DR,IN, 4Side, 41.3mm Astrigal, 46mm Plain L

Tilt rod type(拉杆类型): Easy tilt rod(齿条拉杆)

Louvre Quantity(叶片数量): 40

Louvre Size(叶片尺寸): 381.5mm

Rail Size(上下板尺寸): 433.5mm

Order No(订单号): ABC 50835 RYAN

Item(序号): 2

Room(房间号):

Louvre Size(叶片类型): 76mm

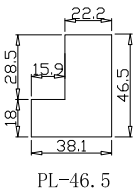

PL-46.5

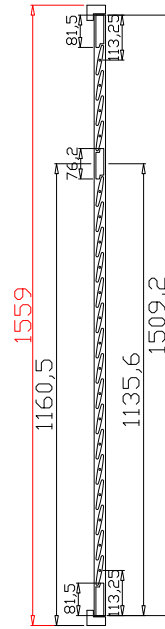
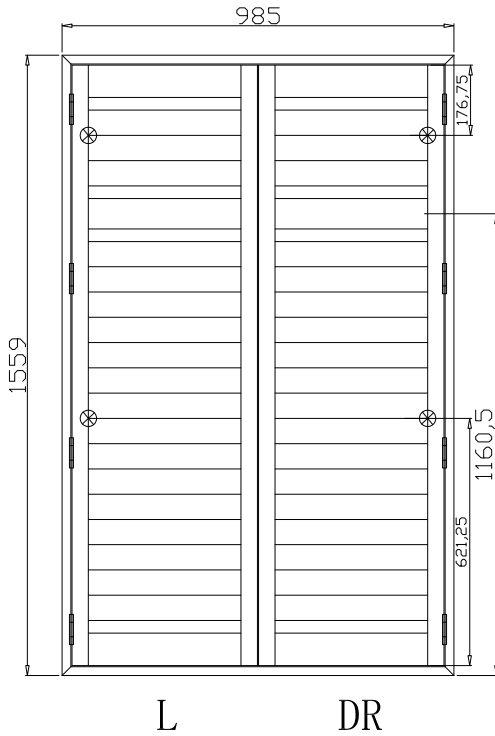
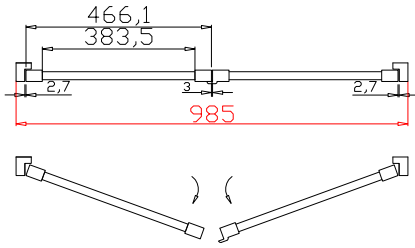

4

16

**NOTES:**

Shutter Color: Timeless White(覆盖色)

Hinges Color: White(白色)

Qty(数量): 1

Material(材质): Palowania(桐木)

Configuration(窗扇结构): L-DR,IN, 4Side, 41.3mm Astrigal, 46mm Plain L

Tilt rod type(拉杆类型): Easy tilt rod(齿条拉杆)

Louvre Quantity(叶片数量): 40

Louvre Size(叶片尺寸): 381.5mm

Rail Size(上下板尺寸): 433.5mm

Order No(订单号): ABC 50835 RYAN

Item(序号): 3

Room(房间号):

Louvre Size(叶片类型): 76mm

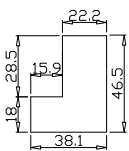

PL-46.5