

12

NOTES:

Shutter Color: Timeless White(覆盖色)

Hinges Color: White(白色)

Qty(数量): 1

Material(材质): Paulownia(桐木)

Configuration(窗扇结构): L-DR, IN, 4Side, 41.3mm Astrigal, Deep Plain L Frame 60mm

Tilt rod type(拉杆类型): Easy tilt rod(齿条拉杆)

Louvre Quantity(叶片数量): 24

Louvre Size(叶片尺寸): 251.7mm

Rail Size(上下板尺寸): 303.7mm

Order No(订单号): ABC 50619 RUSH

Item(序号): 1

Room(房间号): BED

Louvre Size(叶片类型): 89mm

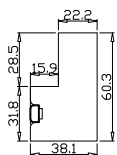

Deep Plain L Frame 60mm



Batten: 3*20*1072 (mm) *2
3*45*962 (mm)
Timeless White(覆盖色)

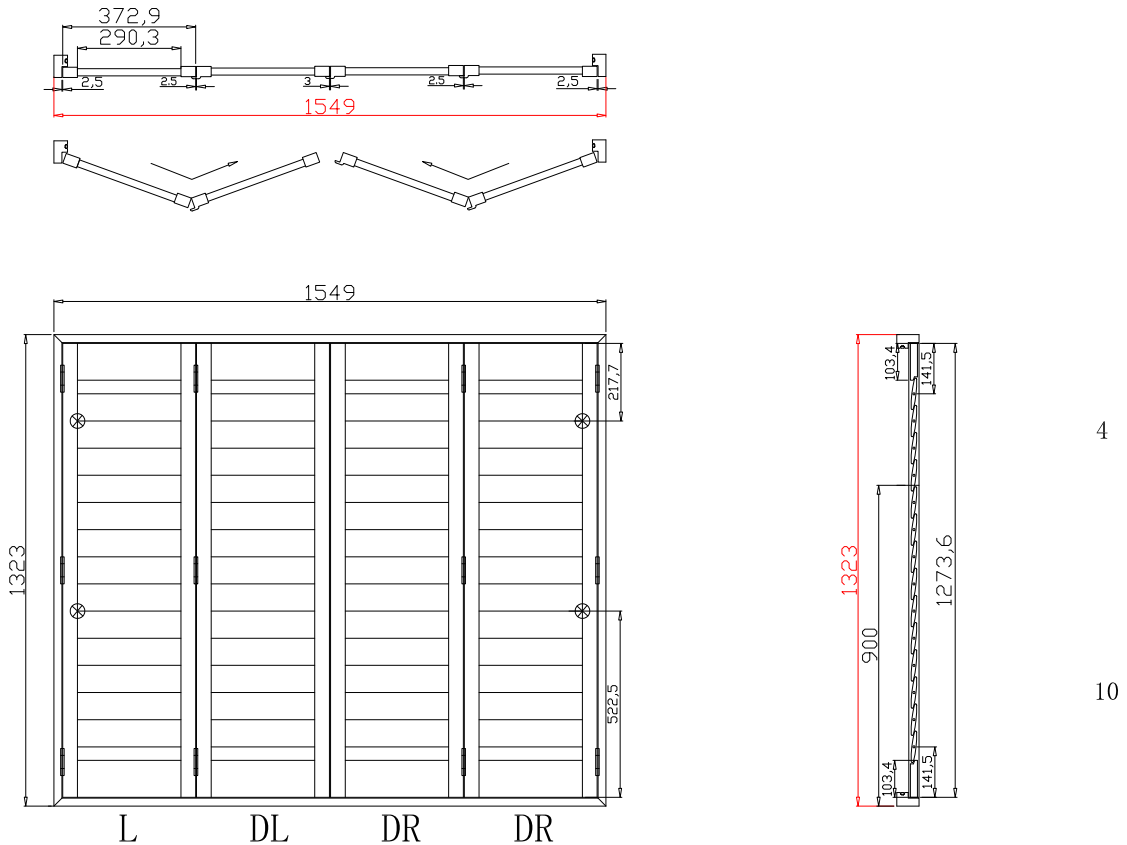

NOTES:

- Shutter Color: Timeless White(覆盖色)
- Hinges Color: White(白色)
- Qty(数量): 1
- Material(材质): Palowania(桐木)
- Configuration(窗扇结构): LDL-DRDR,IN, 4Side, 41.3mm Astrigal, Deep Plain L Frame 60mm
- Tilt rod type(拉杆类型): Easy tilt rod(齿条拉杆)
- Louvre Quantity(叶片数量): 56
- Louvre Size(叶片尺寸): 288.3mm
- Rail Size(上下板尺寸): 340.3mm

Order No(订单号): ABC 50619 RUSH

Item(序号): 2

Room(房间号): kit

Louvre Size(叶片类型): 89mm

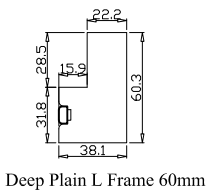

Deep Plain L Frame 60mm

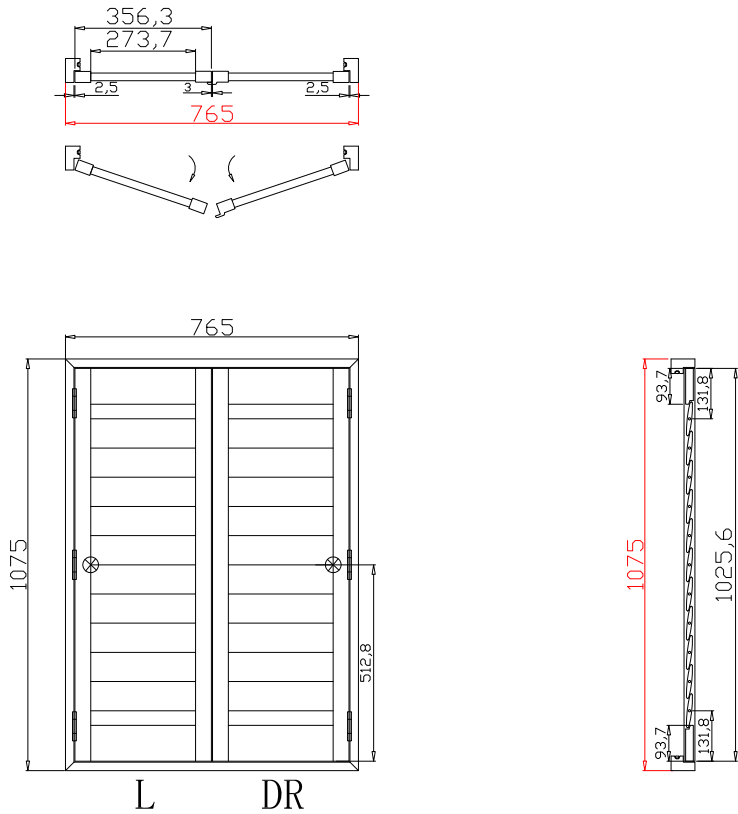

11

NOTES:

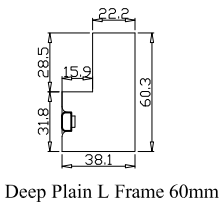

Deep Plain L Frame 60mm

Shutter Color: Timeless White(覆盖色)

Hinges Color: White(白色)

Qty(数量): 1

Material(材质): Paulownia(桐木)

Configuration(窗扇结构): L-DR, IN, 4Side, 41.3mm Astrigal, Deep Plain L Frame 60mm

Tilt rod type(拉杆类型): Easy tilt rod(齿条拉杆)

Louvre Quantity(叶片数量): 22

Louvre Size(叶片尺寸): 271.7mm

Rail Size(上下板尺寸): 323.7mm

Order No(订单号): ABC 50619 RUSH

Item(序号): 3

Room(房间号): kit

Louvre Size(叶片类型): 89mm

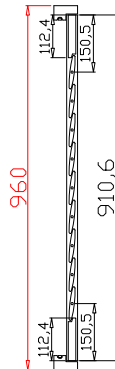
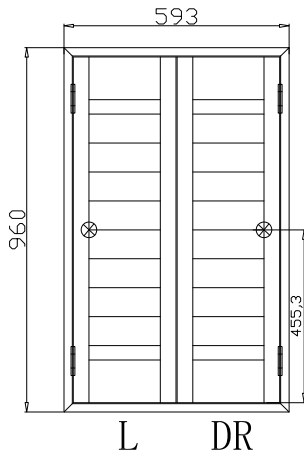
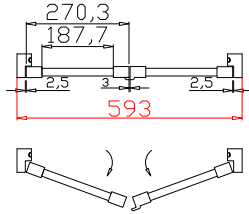

9

NOTES:

Shutter Color: Timeless White(覆盖色)

Hinges Color: White(白色)

Qty(数量): 1

Material(材质): Paulownia(桐木)

Configuration(窗扇结构): L-DR, IN, 4Side, 41.3mm Astrigal, Deep Plain L Frame 60mm

Tilt rod type(拉杆类型): Easy tilt rod(齿条拉杆)

Louvre Quantity(叶片数量): 18

Louvre Size(叶片尺寸): 185.7mm

Rail Size(上下板尺寸): 237.7mm

Order No(订单号): ABC 50619 RUSH

Item(序号): 4

Room(房间号): kit

Louvre Size(叶片类型): 89mm

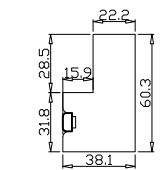

Deep Plain L Frame 60mm

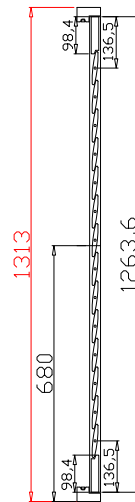
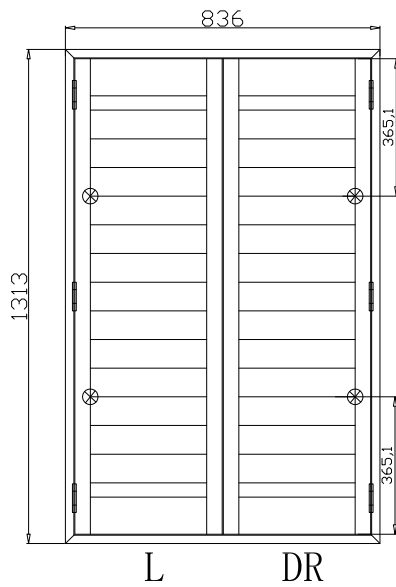
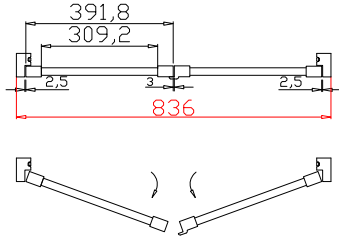

7

7

NOTES:

Shutter Color:Timeless White(覆盖色)

Hinges Color:White(白色)

Qty(数量): 1

Material(材质): Paulownia(桐木)

Configuration(窗扇结构): L-DR,IN, 4Side, 41.3mm Astrigal, Deep Plain L Frame 60mm

Tilt rod type(拉杆类型): Easy tilt rod(齿条拉杆)

Louvre Quantity(叶片数量): 28

Louvre Size(叶片尺寸): 307.2mm

Rail Size(上下板尺寸): 359.2mm

Order No(订单号):ABC 50619 RUSH

Item(序号): 5

Room(房间号): BED

Louvre Size(叶片类型): 89mm

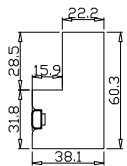

Deep Plain L Frame 60mm

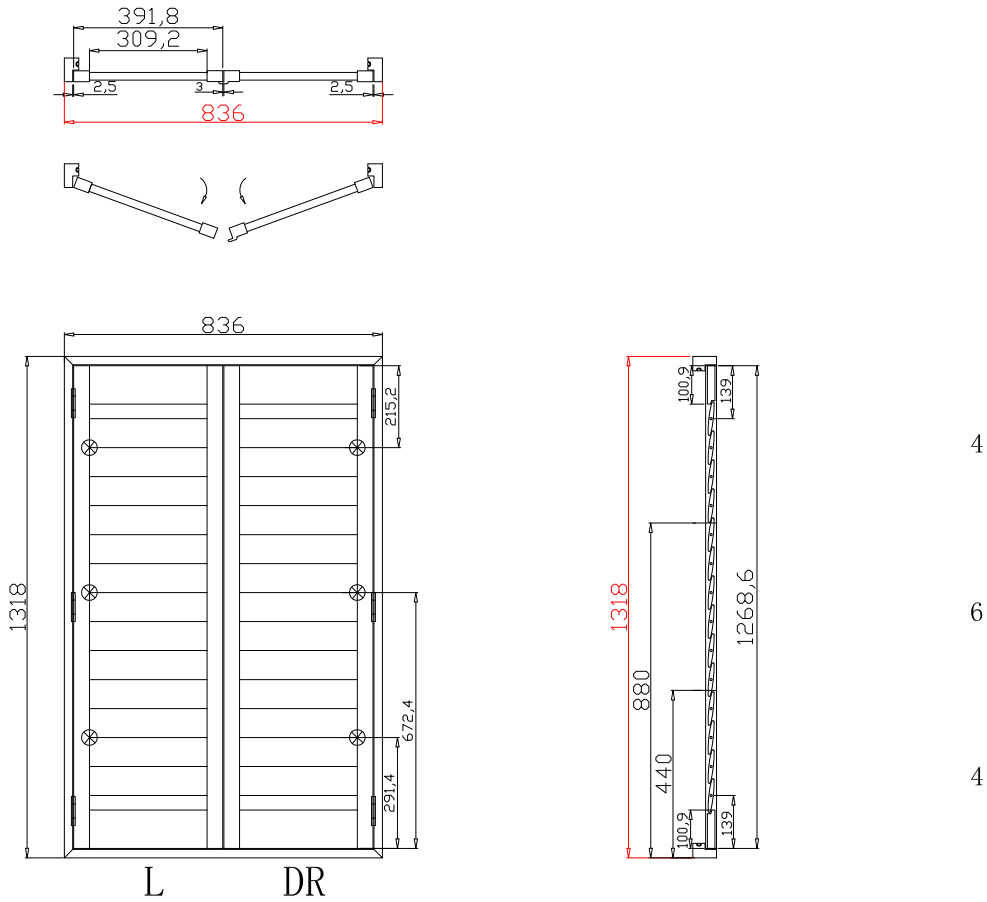

NOTES:

Shutter Color: Timeless White(覆盖色)

Hinges Color: White(白色)

Qty(数量): 1

Material(材质): Paulownia(桐木)

Configuration(窗扇结构): L-DR, IN, 4Side, 41.3mm Astrigal, Deep Plain L Frame 60mm

Tilt rod type(拉杆类型): Easy tilt rod(齿条拉杆)

Louvre Quantity(叶片数量): 28

Louvre Size(叶片尺寸): 307.2mm

Rail Size(上下板尺寸): 359.2mm

Order No(订单号): ABC 50619 RUSH

Item(序号): 6

Room(房间号): ENSUITE

Louvre Size(叶片类型): 89mm

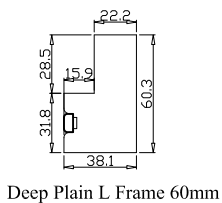

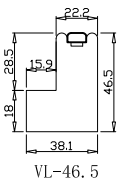
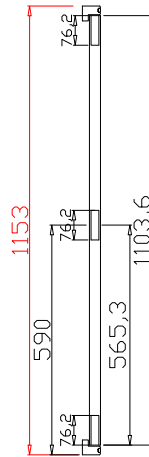
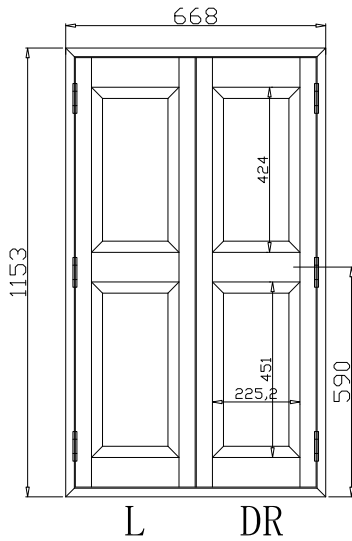
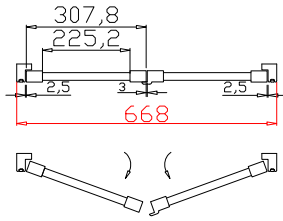

NOTES:

Shutter Color: Antique Oak(染色)

Hinges Color: Bright Brass(亮铜色合页)

Qty(数量): 1

Material(材质): Basswood(椴木)

Configuration(窗扇结构): L-DR,IN, 4Side, 41.3mm Astrigal, 46.5mm Vintage L

Tilt rod type(拉杆类型):

Louvre Quantity(叶片数量):

Louvre Size(叶片尺寸):

Rail Size(上下板尺寸): 275.2mm

Knob A Ball

配置不锈钢五金旋钮把手

Order No(订单号): ABC 50619 RUSH

Item(序号): 7

Room(房间号): SNUG

Louvre Size(叶片类型): Solid Panel