

212885

ite 1 = 8 no.
ardroom = 4 no.
ite 2 = 10 no.

22

Suite 1 12x2200

Suite 2

All
R4 Motors

NO fascia
or cassette

2060 x 2880 R/S

SO17285
AF Capital

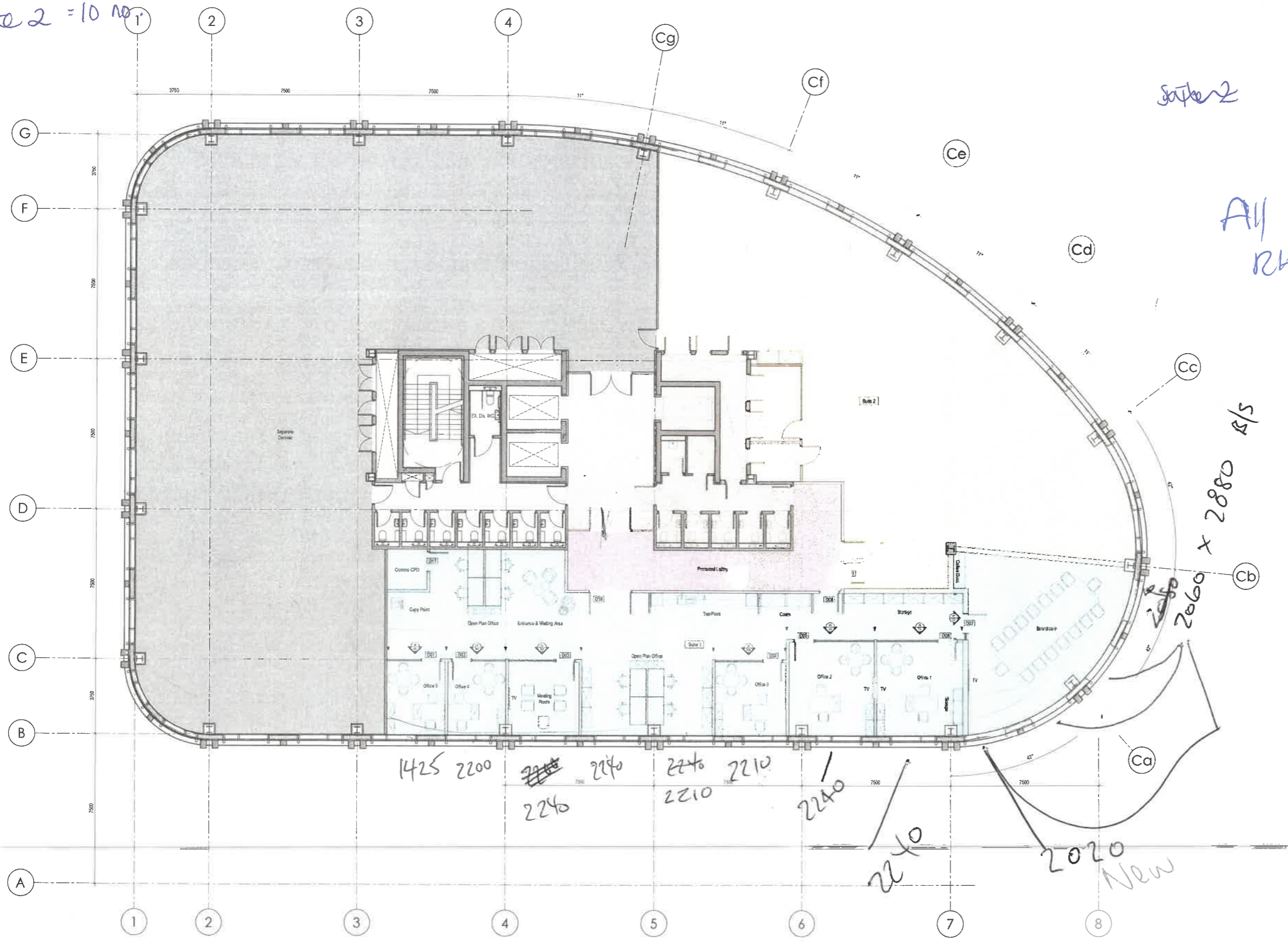

NOTES

Figured dimensions only are to be taken from this drawing. All dimensions are to be checked on site before any work is put in hand. If in doubt, seek confirmation.

This drawing must be read in conjunction with all other architectural detail drawings, schedules and specifications.

All drawings are to be read in conjunction with relevant drawings from other consultants. In the case of inconsistencies, seek confirmation.

This drawing must not be copied in whole or in part without the prior written permission of Axis Mason Ltd.

© Copyright Axis Mason Ltd

Rev	Description	Dwn	Ckd	Date
T1	TENDER ISSUE	KC	MC	20/08/25

LEGEND

[Symbol]	EXISTING AREA UNCHANGED
[Symbol]	SEPARATE DEMISE
[Symbol]	SUITE 1
[Symbol]	SHARED PROTECTED LOBBY
[Symbol]	SUITE 2

AXIS MASON Surreyville House, Philips Street
St. Helier, Jersey, JE2 4JF
01534 870 137 WWW.AXISMASON.COM

LONDON GLASGOW JERSEY DUBLIN BIRMINGHAM

Client:	AF Capital
Project:	IFC - 5 Third Floor Fit-out
Drawing Title:	General Arrangement Plan