

GENERAL NOTES:
 This drawing must not be copied in whole or in part without prior written permission of Riva Architects Limited. This drawing must be read in conjunction with other architect's drawings & all schedules/Building Bye-Law check list and with all relevant structural engineering drawings, details and specifications. It is the contractor's responsibility to ensure that all work is carried out in accordance with all statutory requirements and to the approval of the building control officer (B.C.O.) The contractor is responsible for the setting out of the works. Any discrepancy found between this drawing and any other architect's detail drawing, schedule and/or specification must be reported to the architect before the work is carried out. Do not scale from this drawing. Refer only to written dimensions. All dimensions must be checked on site. The relevant British Standards for materials and their uses are to be adhered to. Manufacturers installation & fitting instructions must be obtained and adhered to at all times.

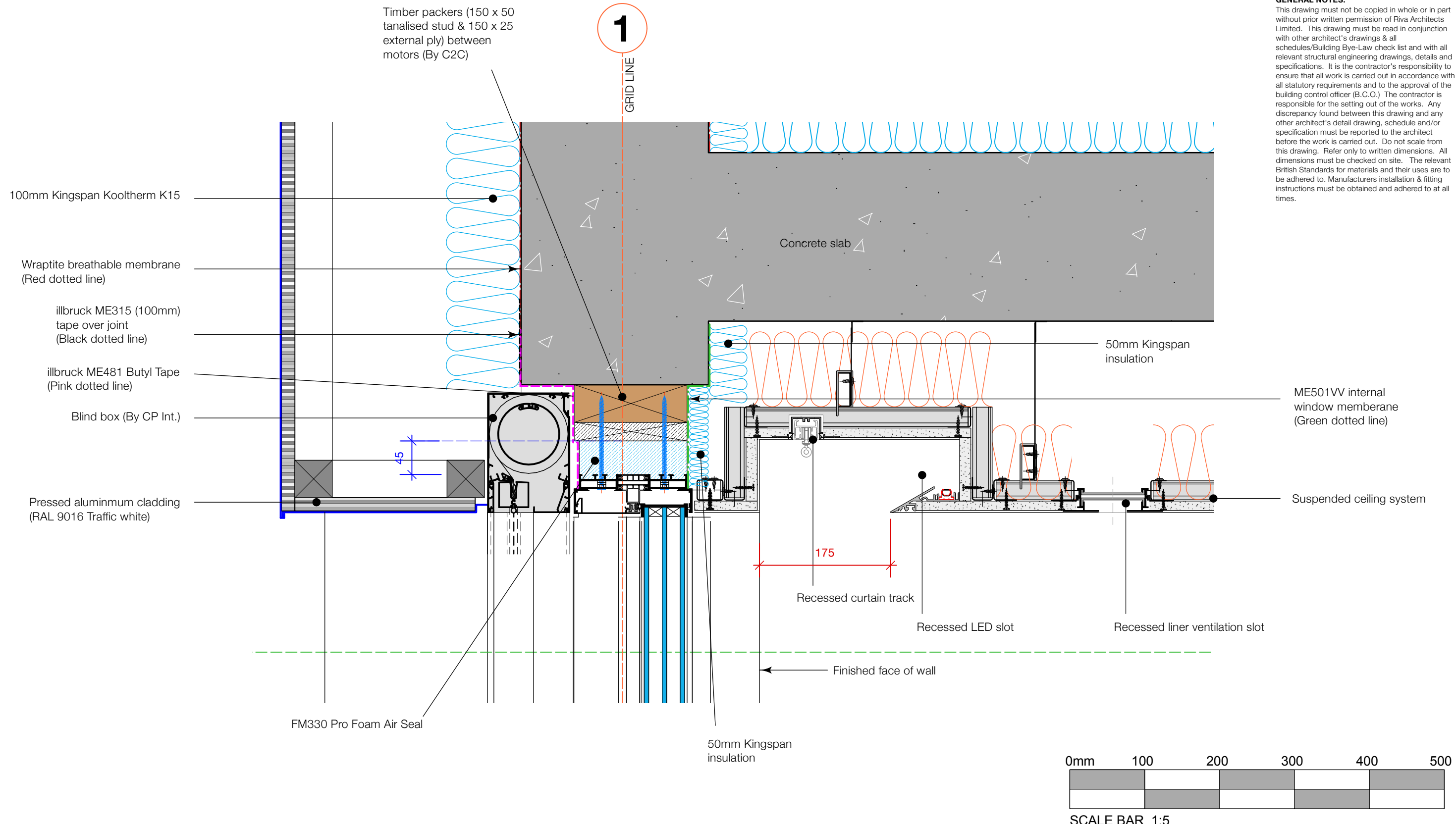

RIVA ARCHITECTS
 1ST FLOOR, INDUSTRIA HOUSE,
 RED HOUSES, ST. BRELADE,
 JERSEY, JE3 8LD.
 T +44 (0) 1534 499383
 E office@riva-architects.com
 W www.riva-architects.com

eco active member business

REV	DESCRIPTION	DATE

DRAWING TITLE		
EXTERNAL DOOR DETAILS W12, W13		
HEAD DETAIL		
DATE	SCALE	
NOVEMBER 2025	1:5 @ A3	
JOB NO.	DRG NO.	REVISION
959	515-4	

JOB TITLE
Proposed Dwelling
MAKAI
Le Route de la Baie, St Brelade, JE3 8EF
Mr & Mrs Cooke