



CP INTERIORS

QUOTE

To:
Richard & Debbie Prosser
Fairfield
Rue Du Coin
St Ouen

Job Number: SO16464

Customer Reference:

Quote Date: Tuesday 11 Feb 2025

Deposit required: £ 855.75

Your Contact: Tamara

JE3 2LJ

Our Price Promise to you

We are so confident our pricing is competitive, that we will beat any written quotation for equivalent product by 5%

To supply and fit unless otherwise stated.

Location	Product	Description	Qty	Price
	Carpet / Rug	Custom made door mats in Crucial Trading Divine Roasted Coffee SD104 (as previously supplied), with Intec stain treatment and black whipped edge.,	2	£ 1,630.00

Terms: 50% deposit due with order, 50% on completion

**** To go ahead with this quote please make deposit payment. To pay by card call us on 01534 768141 ****

Direct Deposit - Sort Code: 60-12-03 Account: 66577772

If you have any queries please call us on 01534 768141 or visit our showroom
Rue des Pres Trading Estate St Saviour

**** For Our Terms & Conditions of Sale please go to www.cpinteriors.je ****

Subtotal	£ 1,630.00
GST	£ 81.50
Total	£ 1,711.50
Paid amount	£ 0.00
Total amount	£ 1,711.50

Please note: This quotation is only valid for acceptance for 7 days. Our estimate does not include any electrical work or additional carpentry work to install the above unless otherwise specified. Please note there is a handling charge on customer own fabric of £7.50 per metre. Due to high costs of labour, pre-arranged missed fitting appointments will be charged on a time-wasted basis. Settlement is due on completion of works and an administration charge of £25 will be added per month if unpaid within 30 days. We reserve the right to charge for design, advice and liaison work carried out should an order not be placed. Goods remain the property of CP Interiors until full settlement is received. Should payment not be received we reserve the right to attend premises during working hours to remove goods and not be required to make good. Our full terms and conditions apply and are available on request.

Tamara Lopez-Dominguez

Subject: SO16464 Prosser

Good afternoon,

Could I please order a 4m x 1.8m of Divine Roasted Coffee SD104 with Intec? Please use the above reference in the order confirmation and invoice. Many thanks.

Kind Regards

Tamara
Lopez-Dominguez

Interior Design Advisor
tamara@cpinteriors.je



Unit 28 Rue Des Pres Trading Estate
St Saviour
Jersey
JE2 7QN

01534 768141 | www.cpinteriors.je



*RB ✓
checked.*

With our CP Price promise, we will beat any
** On like for like products only

NO ORDER CONFIRMATION

Tamara Lopez-Dominguez

From: Sales, Crucial Trading <sales@crucial-trading.com>
Sent: 31 January 2025 09:56
To: Tamara Lopez-Dominguez
Subject: RE: SO16464 Prosser

Follow Up Flag: Follow up
Flag Status: Completed

Hi Tamara,

Your cut price is £83.92m2 + Vat
Intec is £1.33m2 + Vat

Delivery to your self will be free of charge

DIVINE ROASTED COFFEE SD104
(Same as supplied for Rear Door, Entrance,
Den Door & Loft Door).
2019

Kind Regards
Rachel Willis-Priestly



HFD
TAMWORTH

From: Tamara Lopez-Dominguez <Tamara@cpinteriors.je>
Sent: 30 January 2025 16:53
To: Sales, Crucial Trading <sales@crucial-trading.com>
Subject: [EXTERNAL] RE: SO16464 Prosser

Hi Michelle,

We are not after a rug. We would only order the piece of carpet 4x1.8m, with the stain resistant treatment. Our carpet fitter would do the rest.

Otherwise, I will calculate the price with what you have given me. I just need to know the cost for the additional treatment and delivery cost. Thanks.

Kind Regards

Tamara
Lopez-Dominguez

Interior Design Advisor
tamara@cpinteriors.je

No Service

08:41

Matt Rowles

message. We're closed for the day, we'll get back to you soon 😊 18:00 ✓✓

Tuesday

That's great. Could you please get a quote to have it done? Many thanks 09:01 ✓✓

Yesterday

Ok based on 23.589 feet of whipping for square piece

$£129.74 \times \cancel{2} = \cancel{£259.48} \times 1.5 = £194.61$

for the other 25.115 feet

$£138.14 \times \cancel{2} = \cancel{£276.28} \times 1.5 = £207.21$

£402.82

+



CARPET

$£83.92 \times \cancel{2}$

$£167.84 \text{ sqm}$

$£167.84$

INTEC

$£1.33 \times \cancel{2}$

$£2.66 \text{ sqm}$

$\cancel{£2.66} \text{ sqm}$

7.2 sqm

CARPET $£1208.45$

INTEC $£19.15$

WHIPPING FOR BOTH $£53.16$

TOTAL $(£1228)$ CARPET + INTEC = $\cancel{£1228} + £1208.45 + £19.15 = £1228$

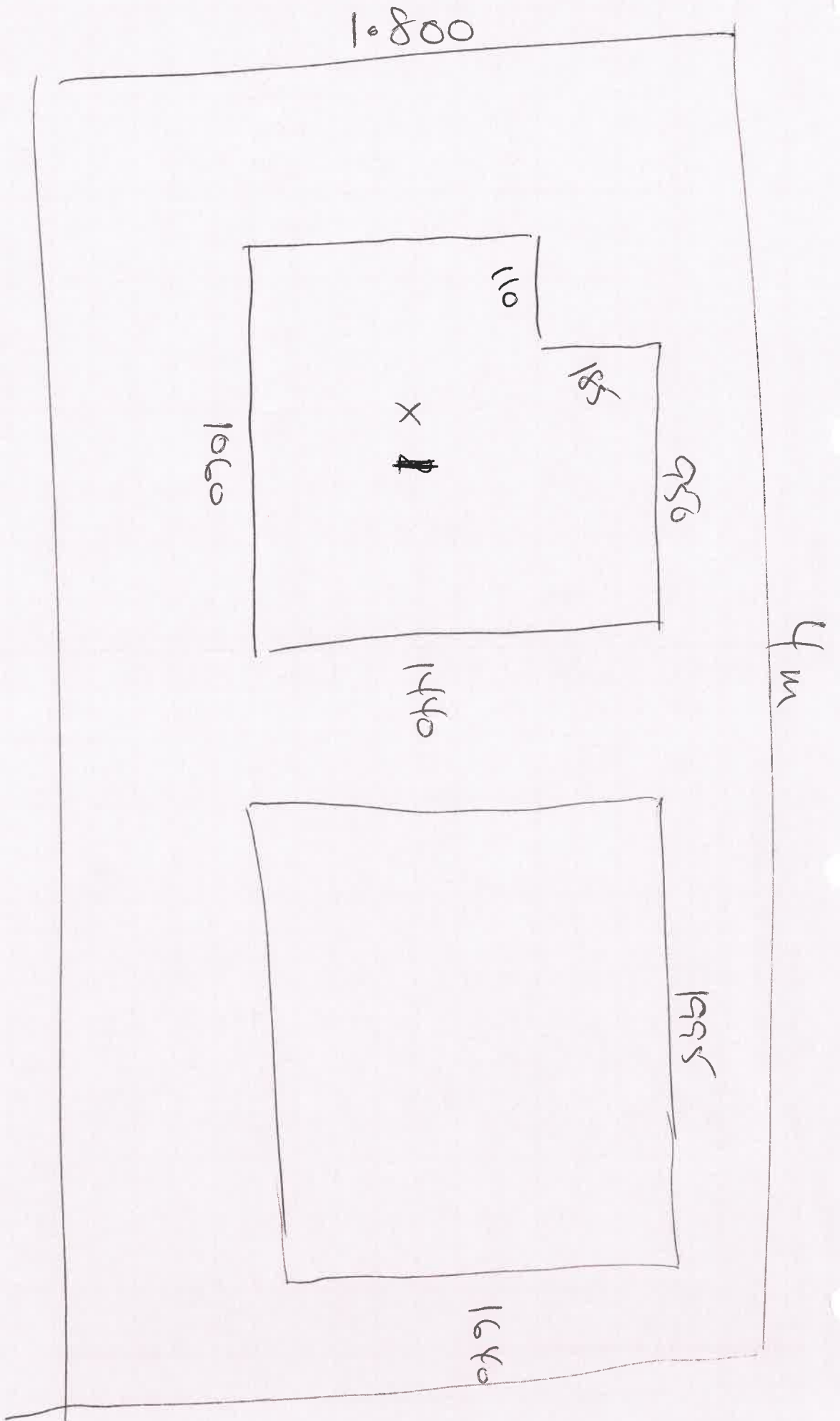

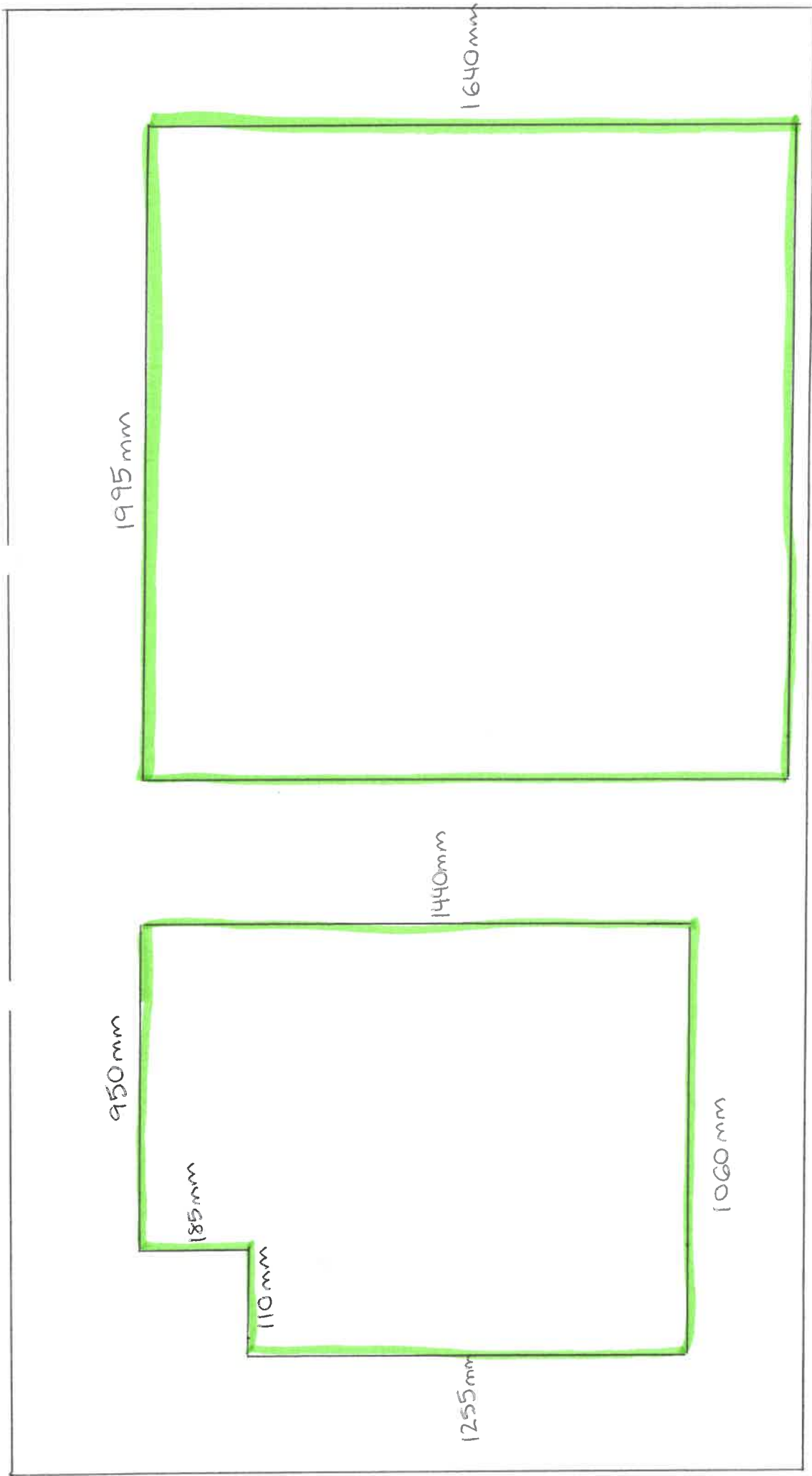

4m

DIVINE ROASTED COFFEE SD104 + Whipped in black + Stain resistant
 (previous order on proforma dated 15/07/2020)

5016464 PROSSER

509254

PRO-FORMA

CRUCIAL TRADING

Where Inspiration Begins

24/7

Invoice
 CP INTERIORS LTD
 RUE DES PRES TRADING ESTATE
 ST SAVIOUR
 JERSEY
 JE2 7QN

Fairfield / Prosser
 Larsen
 509254

RECEIVED
 15 JUL 2020

PRO-FORMA		CRU No.:	333 9709 40		Page :	1			
					Date :	15/07/2020			
Account No. :	2676	VAT No. :			Rep :	29			
Customer Ref	Desp No.	Commodity Code	Len.	Width	Qty	Unit	Price	Goods	Vat
Quality / Design : MACHINE TUFTED CARPET									
Quality / Design : CT WOOL SNUG / SN502 WARM G									
SO9254	29191628	5703100000	2.90	5.00	14.50	m2	73.67	1068.22	0.00 2
Quality / Design : CT WOOL SNUG / SN502 WARM G									
SO9254	29191629	5703100000	3.00	5.00	15.00	m2	73.67	1105.05	0.00 2
Quality / Design : POWER LOOMED FLAT-WOVEN NATURAL FLO									
Quality / Design : CT SISAL DIVINE / SD104 ROASTE									
SO9254	29191630	5702509030	2.10	4.00	8.40	m2	61.89	519.88	0.00 2
- Friday 7/8									
Volume :	0.00m3	Weight	120.03Kg		VAT ANALYSIS			INVOICE TOTALS	
Total m2 :	37.90			IND.	GOODS	RATE	VAT	AMOUNT	
				2	2693.15	0.00	0.00		Goods 2693.15
									Vat 0.00
									Total 2693.15

Goods supplied are subject to our normal Terms and Conditions, a copy of which is available on request.

HFD LT T/A CRUCIAL TRADING
 BARCLAYS BANK, COLMORE ROW, BIRMINGHAM
 SORT CODE 20-07-71
 ACCOUNT NO: 40268453

Payment Terms
 Pro-Forma

Crucial Trading, Gorseley Lane, Coleshill, Birmingham, B46 1JU
 TELEPHONE: (01675) 433 505, TELEFAX: (01675) 433 521
 EMAIL: sales@crucial-trading.com

Posted	21693.15
Date	15-07-20
Initials	RS

- BACS

Handwritten signature

ORDER ACKNOWLEDGEMENT

CRUCIAL TRADING

Where Inspiration Begins

Invoice
 CP INTERIORS LTD
 RUE DES PRES TRADING ESTATE
 ST SAVIOUR
 JERSEY
 JE2 7QN

ORDER ACKNOWLEDGEMENT		CRU No.: 333 9709 40		Page : 2	
Account No. : 2676		VAT No. :		Date : 10/06/2020	
Customer Ref		Desp No.		Rep : 29	
Expected Week		Len. Width		Qty Unit Price Goods Vat	
PO10033 Comprising of:		Made Up CT SISAL RUG / . 29076008 27		1 EA 72.13 72.13 0.00 2	
		CT SISAL HARRY / D704 ALUMINI 0.92 0.80 0.74			
		Inner Border - CT PLAIN BORDERS / C32 DOWN 3CM BORDER VIS PLS 3.44			
PO10033 Comprising of:		Made Up CT SISAL RUG / . 29076009 27		1 EA 85.98 85.98 0.00 2	
		CT SISAL HARRY / D704 ALUMINI 0.92 1.00 0.92			
		Inner Border - CT PLAIN BORDERS / C32 DOWN 3.84			
Volume : 0.00m3		Weight 12.45Kg		VAT ANALYSIS	
Total m2 : 3.26				IND. GOODS RATE VAT AMOUNT	
				2 293.01 0.00 0.00	
				INVOICE TOTALS	
				Goods 293.01	
				Vat 0.00	
				Total 293.01	

All supplied are subject to our other Terms & Conditions, some of which are available on request

Payment Terms
 Pro-Forma

HED LT T/A CRUCIAL TRADING
 BARCLAYS BANK, COLMORE ROW, BIRMINGHAM
 SORT CODE 20-07-71
 ACCOUNT NO: 40268453

Crucial Trading, Gorse Lane, Coleshill, Birmingham, B46 1JU
 TELEPHONE: (01675) 433 505, TELEFAX: (01675) 433 521
 EMAIL: sales@crucial-trading.com

920 x 898

BREKIDAN La Carriere zhouse Garage

920 x

898

Size to be
adjusted to.

= Sea/Stone? take to

Comptrol you
to see if they
can adjust.

(Birdys will need
altering too)



CP INTERIORS

QUOTE

To:
Richard & Debbie Prosser
Fairfield
Rue Du Coin
St Ouen

Job Number: SO16464

Quote Date: Monday 10 Feb 2025

Customer Reference:

Deposit required: £ 644.70

Your Contact: Tamara

JE3 2LJ

Our Price Promise to you

We are so confident our pricing is competitive, that we will beat any written quotation for equivalent product by 5%

To supply and fit unless otherwise stated.

Location	Product	Description	Qty	Price
	Carpet / Rug	Custom made door mats in Crucial Trading Divine Roasted Coffee SD104 (as previously supplied), with Intec stain treatment.,	2	£ 1,228.00
	Optional Upgrade	Black whipped edging @£402. To be added to the subtotal.,	1	

Alternative option standard matting.

Terms: 50% deposit due with order, 50% on completion

**** To go ahead with this quote please make deposit payment. To pay by card call us on 01534 768141 ****

Direct Deposit - Sort Code: 60-12-03 Account: 66577772

If you have any queries please call us on 01534 768141 or visit our showroom
Rue des Pres Trading Estate St Saviour

**** For Our Terms & Conditions of Sale please go to www.cpinteriors.je ****

Subtotal	£ 1,228.00
GST	£ 61.40
Total	£ 1,289.40
Paid amount	£ 0.00
Total amount	£ 1,289.40

Please note: This quotation is only valid for acceptance for 7 days. Our estimate does not include any electrical work or additional carpentry work to install the above unless otherwise specified. Please note there is a handling charge on customer own fabric of £7.50 per metre. Due to high costs of labour, pre-arranged missed fitting appointments will be charged on a time-wasted basis. Settlement is due on completion of works and an administration charge of £25 will be added per month if unpaid within 30 days. We reserve the right to charge for design, advice and liaison work carried out should an order not be placed. Goods remain the property of CP Interiors until full settlement is received. Should payment not be received we reserve the right to attend premises during working hours to remove goods and not be required to make good. Our full terms and conditions apply and are available on request.



CP INTERIORS

QUOTE

To: Richard & Debbie Prosser
Fairfield
Rue Du Coin
St Ouen

Job Number: SO16464
Customer Reference:

Quote Date: Thursday 06 Feb 2025
Deposit required: £ 925.57
Your Contact: Tamara

JE3 2LJ

Our Price Promise to you
We are so confident our pricing is competitive, that we will beat any written quotation for equivalent product by 5%

To supply and fit unless otherwise stated.

Location	Product	Description	Qty	Price
	Carpet / Rug	Custom made door mats in Crucial Trading Divine Roasted Coffee SD104 (as previously supplied), with Intec stain treatment, whipped in black.,	2	£ 1,763.00
Subtotal				£ 1,763.00
GST				£ 88.15
Total				£ 1,851.15
Paid amount				£ 0.00
Total amount				£ 1,851.15

Cost carpet
Cost whipping

Just split into component parts

Terms: 50% deposit due with order, 50% on completion

**** To go ahead with this quote please make deposit payment. To pay by card call us on 01534 768141 ****

Direct Deposit - Sort Code: 60-12-03 Account: 66577772

If you have any queries please call us on 01534 768141 or visit our showroom Rue des Pres Trading Estate St Saviour

** For Our Terms & Conditions of Sale please go to www.cpinteriors.je **

Please note: This quotation is only valid for acceptance for 7 days. Our estimate does not include any electrical work or additional carpentry work to install the above unless otherwise specified. Please note there is a handling charge on customer own fabric of £7.50 per metre. Due to high costs of labour, pre-arranged missed fitting appointments will be charged on a time-wasted basis. Settlement is due on completion of works and an administration charge of £25 will be added per month if unpaid within 30 days. We reserve the right to charge for design, advice and liaison work carried out should an order not be placed. Goods remain the property of CP Interiors until full settlement is received. Should payment not be received we reserve the right to attend premises during working hours to remove goods and not be required to make good. Our full terms and conditions apply and are available on request.

can we do offer standard matting
whipping & cost as option
x 1.05 tax as with
whipping adds up
quick