



# CP INTERIORS

## QUOTE

**To:**  
 Paul & Megan Gaudin  
 Haut Des Paliers  
 La Rue De La Genestiere  
 St Martin  
 JE3 6DW

**Job Number:** SO16230Q1

**Quote Date:** Wednesday 23 Oct 2024

**Customer Reference:**

**Deposit required:** £ 1,731.45

**Main House - Option 2 Roman blinds**

**Your Contact:** Tamara

Our Price Promise to you

We are so confident our pricing is competitive, that we will beat any written quotation for equivalent product by 5%

**To supply and fit unless otherwise stated.**

Location	Product	Description	Qty	Price
Dining Room W1	Duorol blind	in Viale Linen fabric (Band B) and white hardware. Hand operated with a left hand side silver chain.	1	£ 241.00
Dining Room W2	Duorol blind	in Vilae Linen fabric (Band B) and white hardware. Hand operated with a left hand side silver chain.	1	£ 440.00
Dining Room W3	Duorol blind	in Viale Linen fabric (Band B) and white hardware. Hand operated with a right hand side silver chain.	1	£ 241.00
Kitchen	Duorol blind	in Viale Linen fabric (Band B) and white hardware. Hand operated with a side silver chain.	1	£ 580.00
Megan's Study	Duorol blind	in Viale Linen fabric (Band B) and white hardware. Hand operated with a side silver chain.	1	£ 351.00
Lola's Bedroom	Roman blind	with bonded blackout lining. Manually operated with a side silver chain.	1	£ 362.00
	Fabric	2m of Romo Leander Orchid 7714/01 @£75.50 per metre. ✓	1	£ 151.00
Bedroom 3 W1	Roman blind	with bonded blackout lining. Manually operated with a side silver chain.	1	£ 433.00
Bedroom 3 W2	Roman blind	with bonded blackout lining. Manually operated with a side silver chain.	1	£ 362.00
	Fabric	6m of Villa Nova Arwen Sapphire V3513/03 @£36.50 per metre., ✓	1	£ 219.00

Already measured



NOT READY TO MEASURE YET

Subject to final measurements,

Terms: 50% deposit due with order, 50% on completion

**\*\* To go ahead with this quote please make deposit payment. To pay by card call us on 01534 768141 \*\***

Direct Deposit - Sort Code: 60-12-03 Account: 66577772

If you have any queries please call us on 01534 768141 or visit our showroom Rue des Pres Trading Estate St Saviour

**\*\* For Our Terms & Conditions of Sale please go to [www.cpinteriors.je](http://www.cpinteriors.je) \*\***

Subtotal	£ 3,380.00
GST	£ 169.00
<b>Total</b>	<b>£ 3,549.00</b>
Paid amount	£ 0.00
<b>Total amount</b>	<b>£ 3,549.00</b>

Please note: This quotation is only valid for acceptance for 7 days. Our estimate does not include any electrical work or additional carpentry work to install the above unless otherwise specified. Please note there is a handling charge on customer own fabric of £7.50 per metre. Due to high costs of labour, pre-arranged missed fitting appointments will be charged on a time-wasted basis. Settlement is due on completion of works and an administration charge of £25 will be added per month if unpaid within 30 days. We reserve the right to charge for design, advice and liaison work carried out should an order not be placed. Goods remain the property of CP Interiors until full settlement is received. Should payment not be received we reserve the right to attend premises during working hours to remove goods and not be required to make good. Our full terms and conditions apply and are available on request.

# THE ROMO GROUP

Romo Ltd.  
Oddicroft Lane  
Sutton-in-Ashfield  
Nottingham NG17 5FB

EORI No. GB116619866000  
VAT Reg No. 116619866  
Tel No. 00 44 1623 727016

## ORDER CONFIRMATION

### Invoice Address

CARPET PROTECTION (CI) LIMITED  
T/A CP INTERIORS  
RUE DES PRES TRADING ESTATE  
ST SAVIOUR  
JERSEY  
JE2 7QN

### Delivery Address

TROPICAL BLINDS  
UNITS 6-7 FIVE ARCHES BUSINESS EST  
OFF MAIDSTONE ROAD  
SIDCUP KENT  
DA14 5AQ

PAGE 1

Account	Invoice Date	Order No.	Carrier	Parcels	Your Order No.	Currency
57744	09/12/24	EX316165	UPS UK Standard		SQ16230Q1 GAUDIN	STERLING

Quantity	Description	Price	%	Value
2.0	METRES RF 7714/01 LEANDER ORCHID Commodity Code: 5309290000 53% Linen 35% Cotton 12% Nylon This fabric has been dyed using reactive dyes. Do not apply any treatments to the face of the cloth as this may affect the colour	37.75		75.50
6.0	METRES VN V3513/03 ARWEN SAPPHIRE Commodity Code: 5209510099 100% Cotton	18.25		109.50

We note these goods are being sent to an address that differs from the accounting address. It is particularly important you check visually that the goods physically correspond with the sample from which the order was placed. i.e. correct design, colour, shade etc.

All supplies are made subject to the Romo Terms and Conditions of Sale (as amended), copies of which are available on request in our Trade Price List or on the trade section of our website at [www.romo.com](http://www.romo.com).

THIS IS AN ORDER CONFIRMATION  
PLEASE DO NOT PAY. A VAT INVOICE WILL FOLLOW.

VAT Summary		
Code	Goods	VAT
S 20.00%		37.00

Goods	185.00
VAT	37.00
<b>Total</b>	<b>222.00</b>

\_index\_OC175779

1

**Tropical Blinds Ltd**

Unit 6 and 7 Five Arches Business Est  
off Maidstone Road  
Sidcup  
Kent  
DA14 5AE  
Tel: 020 8269 6400 Fax: 020 8269 6401

*ORDER IN TROPICAL'S SYSTEM  
ON 12/12/24 as per daily  
REPORT.*

Vat No: 324 0532 02  
Cust Order No: SO16230Q1 GAUDIN  
Order Date: 09/12/2024  
Order No: 4748854  
Cust Ref:  
Account Ref: CPS007  
Despatch Method: DHL Economy

**Order To:**  
C.P Interiors  
Rue Des Pres Trading Estate  
St Saviour  
Jersey  
Channel Islands  
JE2 7QN

**Deliver To:**  
C.P Interiors 2  
Rue Des Pres Trading Estate  
St Saviour  
Jersey  
Channel Islands  
JE2 7QN

*RS checked*

Type	Colour	Width	Drop	Quantity	Unit Price	Disc %	Net
1. Duorol	Viale Linen Vision Fabric (L)	575 ✓	1360 ✓	1	126.24	30	88.37
38mm Tube Duoflor, White, Duorol Two Part Bottom Rail - White, Left Control, Silver Metal No.10 Duo Op Chain, Duorol Top Fix Bracket, Child Safety Chain Holder (Duorol)							
Measurement: Recess Size ✓ Spec. ins: To line up with W2 and W3 as sitting right next to each other.							
Location: Dining Room Fitting ins: Chain Length: 900							
2. Duorol	Viale Linen Vision Fabric (L)	1315 ✓	1360 ✓	1	251.17	30	175.82
38mm Tube Duoflor, White, Duorol Two Part Bottom Rail - White, Left Control, Silver Metal No.10 Duo Op Chain, Duorol Top Fix Bracket, Child Safety Chain Holder (Duorol)							
Measurement: Recess Size ✓ Spec. ins: To line up with W1 and W3 as sitting right next to each other.							
Location: Dining Room Fitting ins: Chain Length: 900							
3. Duorol	Viale Linen Vision Fabric (L)	575 ✓	1360 ✓	1	126.24	30	88.37
38mm Tube Duoflor, White, Duorol Two Part Bottom Rail - White, Right Control, Silver Metal No.10 Duo Op Chain, Duorol Top Fix Bracket, Child Safety Chain Holder (Duorol)							
Measurement: Recess Size ✓ Spec. ins: To line up with W1 and W2 as sitting right next to each other.							
Location: Dining Room Fitting ins: Chain Length: 900							
4. Duorol	Viale Linen Vision Fabric (L)	960 ✓	1360 ✓	1	200.60	30	140.42
38mm Tube Duoflor, White, Duorol Two Part Bottom Rail - White, Left Control, White Plastic Duo Op Chain, Duorol Top Fix Bracket, Child Safety Chain Holder (Duorol)							
Measurement: Recess Size ✓ Spec. ins: <i>RHC SILVER? TOP FIX</i>							
Location: Megan's Study Fitting ins: Chain Length: 900							

5. Cust Own Roman ~~Customer's Own Fabric~~ *Control side?* *Right confirmed by Adriana in office*  
 Waterfall (Standard), Lining - Bonded BLACKOUT (with Fleece 400g EB), No Pelmet Req, Evans Left Hand Control (Breakaway), Continuous Metal Chain Chrome, N/A, None *1385* ✓ *1175* ✓  
 Required, No Handset Required, No Power Supply Required, Not Required, Not Required, No Hub Required, Roman Breakaway Chain Mechanism, Not Applicable  
 Measurement: Recess Size Spec. ins: 2m of Korro Leander Orchid 7714/01  
 Location: Lola's Bedroom Fitting ins: Chain Length: 700

6. Cust Own Roman ~~Customer's Own Fabric~~ *Control side?* *Right confirmed by Adriana in office*  
 Waterfall (Standard), Lining - Bonded BLACKOUT (with Fleece 400g EB), No Pelmet Req, Evans Left Hand Control (Breakaway), Continuous Metal Chain Chrome, N/A, None 1530 ✓ 1330 ✓  
 Required, No Handset Required, No Power Supply Required, Not Required, Not Required, No Hub Required, Roman Breakaway Chain Mechanism, Not Applicable  
 Measurement: Recess Size Spec. ins: 6m of Villa Nova Arwen Sapphire V3513/03 for both blinds in same room. Please pattern match within same blind.  
 Location: Bedroom 3 W1 Fitting ins: Chain Length: 800

7. Cust Own Roman ~~Customer's Own Fabric~~ *Control side?* *Right confirmed by Adriana in office*  
 Waterfall (Standard), Lining - Bonded BLACKOUT (with Fleece 400g EB), No Pelmet Req, Evans Left Hand Control (Breakaway), Continuous Metal Chain Chrome, N/A, None 1160 ✓ 1180 ✓  
 Required, No Handset Required, No Power Supply Required, Not Required, Not Required, No Hub Required, Roman Breakaway Chain Mechanism, Not Applicable  
 Measurement: Recess Size Spec. ins: 6m of Villa Nova Arwen Sapphire V3513/03 for both blinds in same room.  
 Location: Bedroom 3 W2 Fitting ins: Chain Length: 700

Net Total: 956.08  
 VAT: 0.00  
 Total: 956.08

pavilbgardin@gmail.com

Staff Name Rachel

Order No SO16230  
 Measurer or Fitter Measurer

Contact Address  
 Mr & Mrs Paul & Megan Gaudin, Haut Des Pailiers, La Rue De La Genestiere, St Martin, JE3 6DW, 07797765603,

Customer Ref

Date 07-10-2024

Time 12:00

**Work Diary**

APPROX

Notes : To advise and measure for blinds. Possibly Duorol and roller blinds. Please get email address.

Location	Supplier	Blind Type /Description	Colour	Qty	Width	Drop	Fitting Height	Blind/Recess	Controls	Brackets	Surface	Unit Price
DINING		Duorol			1360	2500		RC		TOP		
KITCHEN		KITCHEN			1880	1150	> Sp'd in 3	II□□	600	1300/600		
MEGANS STUDY		Chande 60mm from window frame			970	1370	NOT READY	RS	575	1315/575		
CONSERVATORY		PTO (Rollers?)			960	1360	Recess	Not	TD			
Master WI		Rollers /			1140	1180						
Bed 2 (Lola)		Rollers /			1530	1325						
Bed 3 WI		Rollers / Rollers			1150	1175						
		ON OTHER PINK			1530	1330	Recess					
		Rollers / Rollers			1530	1320						
		Rollers / Rollers			1160	1180	Recess					

Answer to Rachel

Comments:

Order Date

Customer Signature  
 I have checked and agree with the above choices

Target Fitting Date



# Work Diary

Staff Name: Adrian  
 Order No: SO16234  
 Measurer or Fitter: Measurer

Contact Address:  
 Paul & Megan Gaudin, Haut Des Palliers, La Rue De La Genestiere, St Martin,  
 JE3 6DW, 07797765603, paulbgaudin@gmail.com

Customer Ref:  
 Anex Plus House Master Bedroom

Date: 04-11-2024  
 Time: 10:00

Notes: To take final measurements and to measure for intur-rollers in conservatories.

P70

Location	Supplier	Blind Type / Description	Colour	Qty	Width	Drop	Fitting Height	Blind/Recess	Controls	Brackets	Surface	Unit Price
Main Bed	<del>epex</del>	<del>Power</del>		1	1140	1175		B/S	L	TOP		
u		u		1	1525	1325		u	R	u		
Beaz folda		<del>Duo roll Roman</del>		1	1155	1175		Recc	L	u		
Arched window		Power		1	860	1450		B/S	UTC	FRONT		
ANEX Kitchen		Roller		1	1200	1040		B/S				
ANEX LTV				1	1875	1550						
				1	590	1550						
ANEX Bed		Duo-rom		1	955	1355		u				

Comments:

Order Date: \_\_\_\_\_

Customer Signature: \_\_\_\_\_

I have checked and agree with the above choices

Target Fitting Date: \_\_\_\_\_

Main House

Conservation

85N<sup>o</sup> 802 x 1025

2N<sup>o</sup> 665 x 1025

2N<sup>o</sup> 573 x 1025

2N<sup>o</sup> 620 x 1775

Annex

Conservation

795 x 885

845 x 885

797 x 885

810 x 885

798 x 885

834 x 885

607 x 1772

Shed 17x

Profile B

22 mm deep

pavilbgaudin@gmail.com

**Staff Name** Rachel  
**Order No** SO16230  
**Measurer or Fitter** Measurer

**Work Diary**

**Contact Address** Mr & Mrs Paul & Megan Gaudin, Haut Des Paliers, La Rue De La Genesiere, St Martin, JE3 6DW, 07797765603,

**Customer Ref** APPROX  
**Date** 07-10-2024  
**Time** 12:00

**Notes :** To advise and measure for blinds. Possibly Duorol and roller blinds. Please get email address.

Location	Supplier	Blind Type /Description	Colour	Qty	Width	Drop	Fitting Height	Blind/Recess	Controls	Brackets	Surface	Unit Price
DINING		Duorol			1360	2500		RS		TOP		
KITCHEN		KITCHEN			1880	1150	> Split in 3	RS	600	1300/600		
MEGAN'S STUDY		Chande 60mm from window frame]			970	1370						
<del>CONSERVATORY</del>		<del>PTO (Rollers?)</del>										
MASTER (W1)		Rollers			1140	1180						
W2		ROMANS			1530	1325						
BED 2 (LOLA)		Roller/Recess			1150	1175						
BED 3 W1		Recess/Romans			1580	1320						
W2					1160	1180						

Answer to Rachel

**Comments:**

**Order Date**

**Customer Signature**  
 I have checked and agree with the above choices

**Target Fitting Date**

CONSERVATORY

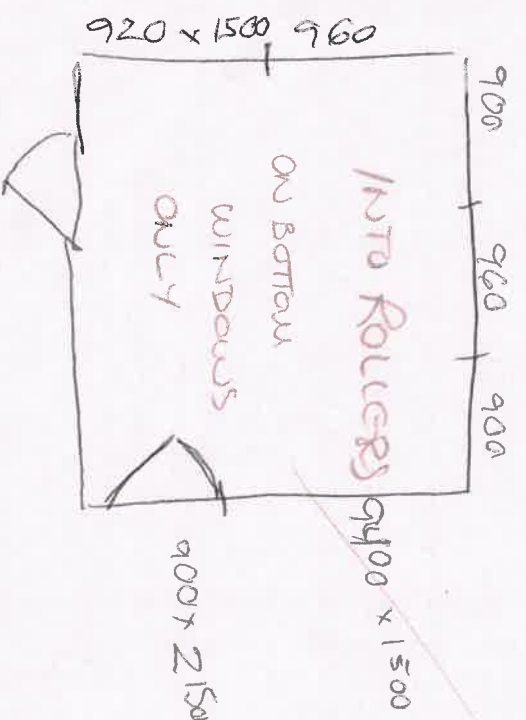
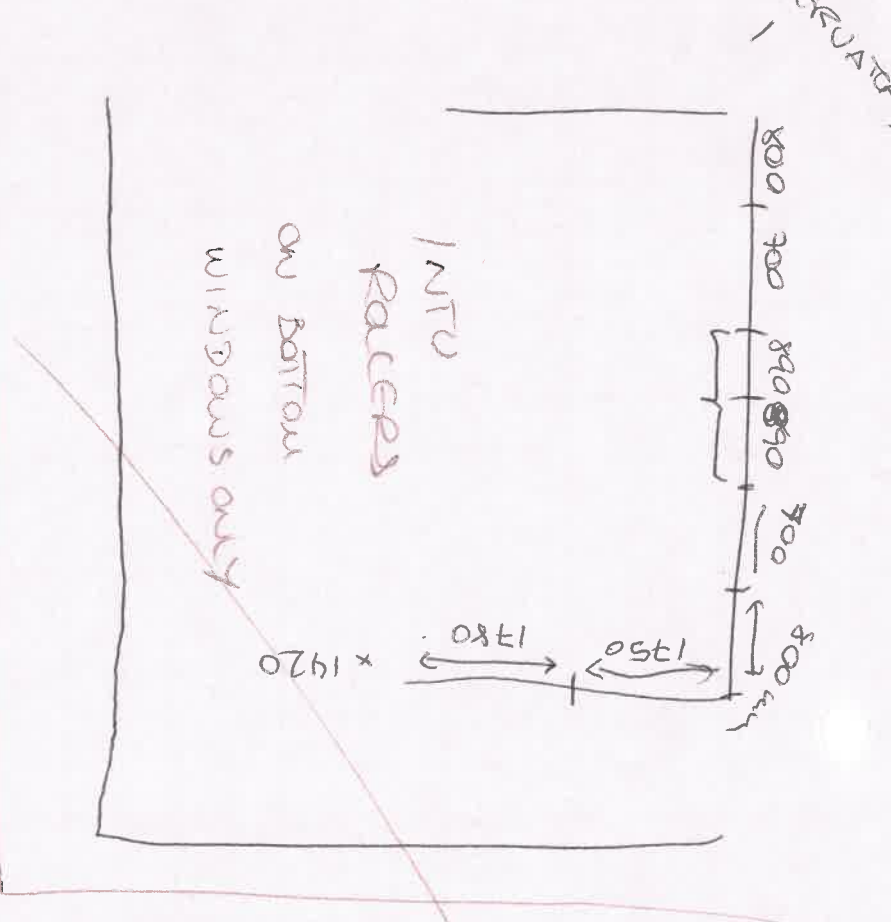

or Glass size 640 x 1875

~~BEDROOM 950 x 525~~  
Roller

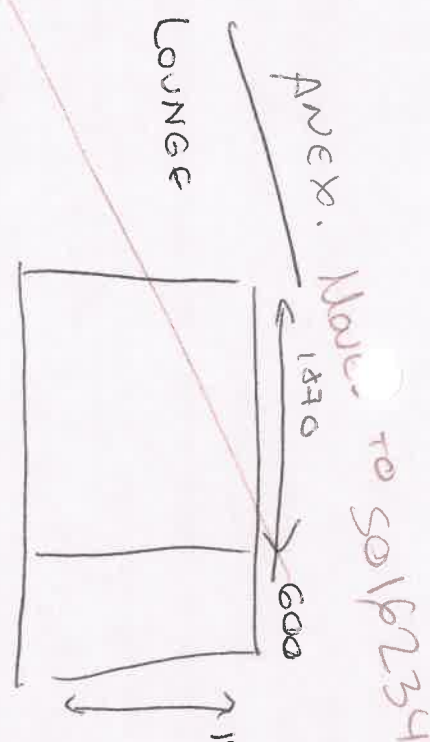

KITCHEN  
1195 mm x 1035 mm  
Rollers  
+ 100 to fit over doors  
+ 100 to side

Bed. ~~Roller~~ **Diary**  
Roller (translucent) 985 x 1360  
Roman / 1055 x 1460  
Curtain 1350 x 1620



# CP INTERIORS

Paul & Megan Gaudin

Haut Des Paliers  
La Rue De La Genestiere  
St Martin  
JE3 6DW

Date	Reference	Your Contact
15-10-2024	SO16230Q1	Tamara
Customer Ref.		
Main House - Option 2 Roman blinds		

## Quote

Our Price Promise to you  
We are so confident our pricing is competitive, that we will beat any written quotation for equivalent product by 5%

Supply & Fit/Supply Only

*Duora Viale Lining*

Location	Product	Description	Qty	Price
Dining Room W1	Duorol blind	<i>band</i> in a and A fabric of your choice and white hardware. Hand operated with a left hand side silver chain.	1	£ 232.00
Dining Room W2	Duorol blind	in a and A fabric of your choice and white hardware. Hand operated with a left hand side silver chain.	1	£ 382.00
Dining Room W3	Duorol blind	in a and A fabric of your choice and white hardware. Hand operated with a right hand side silver chain.	1	£ 232.00
Kitchen	Duorol blind	in a and A fabric of your choice and white hardware. Hand operated with a side silver chain.	1	£ 505.00
Megan's Study	Duorol blind	in a and A fabric of your choice and white hardware. Hand operated with a side silver chain.	1	£ 305.00
Master Bedroom W1	Roman blind	with a pelmet flap and bonded blackout lining. Manually operated with a side silver chain.	1	£ 382.00
Master Bedroom W2	Roman blind	with a pelmet flap and bonded blackout lining. Manually operated with a side silver chain.	1	£ 458.00
Master Bedroom	Fabric	5.5m of a plain single width fabric of your choice. Price guide based on Villa Nova Seville @£34.50 per metre,	1	£ 189.75
Lola's Bedroom	Roman blind	with a pelmet flap and bonded blackout lining. Manually operated with a side silver chain.	1	£ 382.00
Lola's Bedroom	Fabric	2m of a plain single width fabric of your choice. Price guide based on Villa Nova Seville @£34.50 per metre,	1	£ 69.00
Bedroom 3 W1	Roman blind	with a pelmet flap and bonded blackout lining. Manually operated with a side silver chain.	1	£ 458.00
Bedroom 3 W2	Roman blind	with a pelmet flap and bonded blackout lining. Manually operated with a side silver chain.	1	£ 382.00
Bedroom 3	Fabric	5.5m of a plain single width fabric of your choice. Price guide based on Villa Nova Seville @£34.50 per metre, Subject to final measurements, <i>VILLA NOVA ARWON SHESHIRE → 134cm</i> <i>↓ 62cm ← 134cm</i>	1	£ 189.75

*Moved TO ANEX*  
*134cm*  
*↓ 60*  
*↔ 68.5*

Terms : 50% deposit due with order, 50% on completion

BACS Payment	
Bank:	NatWest
Sort Code:	60 12 03
Account No:	66577772
Carpet Protection (C.I) Ltd T/A CP Interiors	

Phone and Card Payment
Payment can be made in person or by phone. If phone, please call us on 01534 768141 and have your card details ready. Note, we do not accept American Express or Cheque payments.

Subtotal :	£ 4,166.50
GST :	£ 208.33
<b>Total :</b>	<b>£ 4,374.83</b>

Please note: This quotation is only valid for acceptance for 7 days. Our estimate does not include any electrical work or additional carpentry work to install the above unless otherwise specified. Please note there is a handling charge on customer own fabric of £7.50 per metre. Due to high costs of labour, pre-arranged missed fitting appointments will be charged on a time-wasted basis. Settlement is due on completion of works and an administration charge of £25 will be added per month if unpaid within 30 days. We reserve the right to charge for design, advice and liaison work carried out should an order not be placed. Goods remain the property of CP Interiors until full settlement is received. Should payment not be received we reserve the right to attend premises during working hours to remove goods and not be required to make good. Our full terms and conditions apply and are available on request.

**Tropical Blinds Ltd**

**Quotation**  
Customer Copy

Unit 6 and 7 Five Arches Business Est  
off Maidstone Road  
Sidcup  
Kent  
DA14 5AE  
Tel: 020 8269 6400 Fax: 020 8269 6401

**Vat No:** 324 0532 02  
**Cust Order No:** SO16230 GAUDIN  
**Order Date:** 23/10/2024  
**Order No:** 4748854  
**Cust Ref:**  
**Account Ref:** CPS007  
**Despatch Method:** DHL Economy

**Order To:**  
C.P Interiors  
Rue Des Pres Trading Estate  
St Saviour  
Jersey  
Channel Islands  
JE2 7QN

**Deliver To:**  
C.P Interiors 2  
Rue Des Pres Trading Estate  
St Saviour  
Jersey  
Channel Islands  
JE2 7QN

Type	Colour	Width	Drop	Quantity	Unit Price	Disc %	Net
1. Duorol 38mm Tube Duoflor, White, Metal No.10 Duo Op Chain, Measurement: Recess Size Location: Dining Room	Viale Linen Vision Fabric (L) Duorol Two Part Bottom Rail - White, Left Control, Silver Duorol Top Fix Bracket, Child Safety Chain Holder (Duorol) Spec. ins: Fitting ins:	600	1360	1	126.24	30	88.37
Chain Length: 900							<b>£241</b>
2. Duorol 38mm Tube Duoflor, White, Plastic Duo Op Chain, Duorol Measurement: Recess Size Location: Dining Room	Viale Linen Vision Fabric (L) Duorol Two Part Bottom Rail - White, Left Control, White Top Fix Bracket, Child Safety Chain Holder (Duorol) Spec. ins: Fitting ins:	1300	1360	1	251.17	30	175.82
Chain Length: 900							<b>£440</b>
3. Duorol 38mm Tube Duoflor, White, Plastic Duo Op Chain, Duorol Measurement: Recess Size Location: Dining Room	Viale Linen Vision Fabric (L) Duorol Two Part Bottom Rail - White, Right Control, White Top Fix Bracket, Child Safety Chain Holder (Duorol) Spec. ins: Fitting ins:	600	1360	1	126.24	30	88.37
Chain Length: 900							<b>£241</b>
4. Duorol 38mm Tube Duoflor, White, Plastic Duo Op Chain, Duorol Measurement: Recess Size Location: Kitchen	Viale Linen Vision Fabric (L) Duorol Two Part Bottom Rail - White, Left Control, White Top Fix Bracket, Child Safety Chain Holder (Duorol) Spec. ins: Fitting ins:	1880	1150	1	331.58	30	232.11
Chain Length: 900							<b>£580</b>
5. Duorol 38mm Tube Duoflor, White, Plastic Duo Op Chain, Duorol Measurement: Recess Size Location: Megan's Study	Viale Linen Vision Fabric (L) Duorol Two Part Bottom Rail - White, Left Control, White Face Fix Bracket, Child Safety Chain Holder (Duorol) Spec. ins: Fitting ins:	970	1370	1	200.60	30	140.42
Chain Length: 900							<b>£351</b>
6. Cust Own Roman Waterfall (Standard), Lining - Bonded BLACKOUT (with Fleece 400g EB), No Pelmet Req, Evans Right Hand Control (Breakaway), Continuous Metal Chain Chrome, N/A, None Required, No Handset Required, No Power Supply Required, Not Required, No Hub Required, Roman Breakaway Chain Mechanism, Not Applicable Measurement: Recess Size Location: Lola's Bedroom	Customer`s Own Fabric Spec. ins: Fitting ins:	1150	1175	1	125.42	10 34.46	144.86
Chain Length: 700							<b>£362</b>
7. Cust Own Roman	Customer`s Own Fabric	1530	1320	1	154.36	10	173.38
							<b>£433</b>

Waterfall (Standard), Lining - Bonded BLACKOUT (with Fleece 400g EB), No Pelmet Req, Evans Right Hand Control (Breakaway), Continuous Metal Chain Chrome, N/A, None Required, No Handset Required, No Power Supply Required, Not Required, Not Required, No Hub Required, Roman Breakaway Chain Mechanism, Not Applicable  
 Measurement: Recess Size Spec. ins:  
 Location: Bedroom 3 W1 Fitting ins:

37.21

Chain Length: 1300

8. Cust Own Roman Customer's Own Fabric 1160 1180 1 125.42 10 144.86  
 Waterfall (Standard), Lining - Bonded BLACKOUT (with Fleece 400g EB), No Pelmet Req, Evans Right Hand Control (Breakaway), Continuous Metal Chain Chrome, N/A, None Required, No Handset Required, No Power Supply Required, Not Required, Not Required, No Hub Required, Roman Breakaway Chain Mechanism, Not Applicable  
 Measurement: Recess Size Spec. ins:  
 Location: Bedroom 3 W2 Fitting ins:

34.46

Chain Length: 700

£382

Net Total: 1188.19

VAT: 0.00

Total: 1188.19

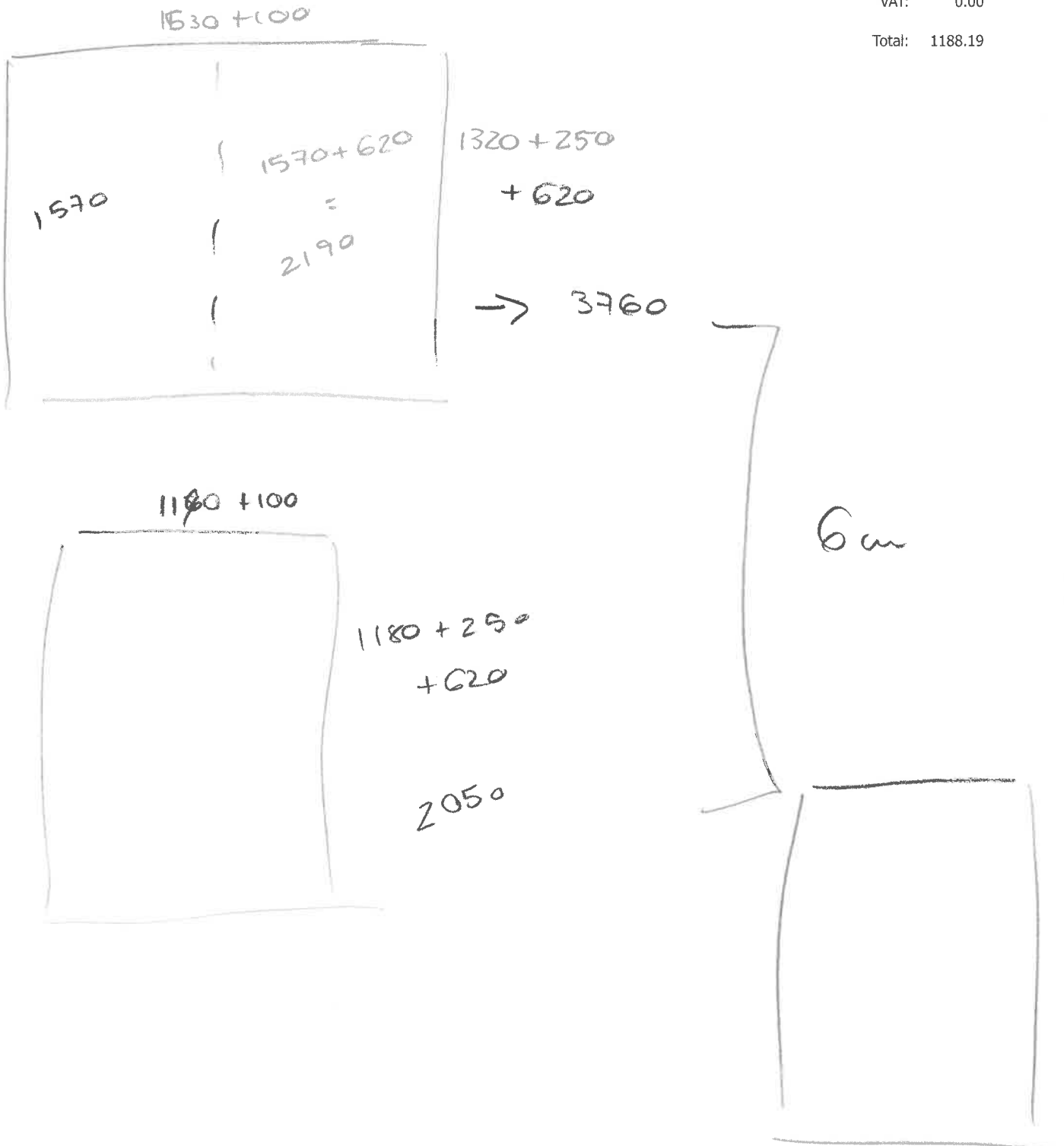



# CP INTERIORS

## QUOTE

**To:**  
 Paul & Megan Gaudin  
 Haut Des Paliers  
 La Rue De La Genestiere  
 St Martin  
 JE3 6DW

**Job Number:** SO16230Q1

**Quote Date:** Wednesday 23 Oct 2024

**Customer Reference:**

**Deposit required:** £ 1,731.45

**Main House - Option 2 Roman blinds**

**Your Contact:** Tamara

Our Price Promise to you

We are so confident our pricing is competitive, that we will beat any written quotation for equivalent product by 5%

**To supply and fit unless otherwise stated.**

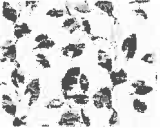
Location	Product	Description	Qty	Price
Dining Room W1	<b>Duorol blind</b>	in Viale Linen fabric (Band B) and white hardware. Hand operated with a left hand side silver chain.	1	£ 241.00
Dining Room W2	<b>Duorol blind</b>	in Vilae Linen fabric (Band B) and white hardware. Hand operated with a left hand side silver chain.	1	£ 440.00
Dining Room W3	<b>Duorol blind</b>	in Viale Linen fabric (Band B) and white hardware. Hand operated with a right hand side silver chain.	1	£ 241.00
Kitchen	<b>Duorol blind</b>	in Viale Linen fabric (Band B) and white hardware. Hand operated with a side silver chain.	1	£ 580.00
Megan's Study	<b>Duorol blind</b>	in Viale Linen fabric (Band B) and white hardware. Hand operated with a side silver chain.	1	£ 351.00
Lola's Bedroom	<b>Roman blind</b>	with bonded blackout lining. Manually operated with a side silver chain.	1	£ 362.00
Lola's Bedroom	<b>Fabric</b>	2m of a plain single width fabric of your choice. Price guide based on Villa Nova Seville @£34.50 per metre,	1	£ 69.00
Bedroom 3 W1	<b>Roman blind</b>	with bonded blackout lining. Manually operated with a side silver chain.	1	£ 433.00
Bedroom 3 W2	<b>Roman blind</b>	with bonded blackout lining. Manually operated with a side silver chain.	1	£ 362.00
	<b>Fabric</b>	6m of Villa Nova Arwen Sapphire V3513/03 @£36.50 per metre.,	1	£ 219.00

Subject to final measurements,

Terms: 50% deposit due with order, 50% on completion

**\*\* To go ahead with this quote please make deposit payment. To pay by card call us on 01534 768141 \*\***

Direct Deposit - Sort Code: 60-12-03 Account: 66577772

If you have any queries please call us on 01534 768141 or visit our showroom Rue des Pres Trading Estate St Saviour

**\*\* For Our Terms & Conditions of Sale please go to [www.cpinteriors.je](http://www.cpinteriors.je) \*\***

Subtotal	£ 3,298.00
GST	£ 164.90
<hr/>	
<b>Total</b>	<b>£ 3,462.90</b>
Paid amount	£ 0.00
<b>Total amount</b>	<b>£ 3,462.90</b>

Please note: This quotation is only valid for acceptance for 7 days. Our estimate does not include any electrical work or additional carpentry work to install the above unless otherwise specified. Please note there is a handling charge on customer own fabric of £7.50 per metre. Due to high costs of labour, pre-arranged missed fitting appointments will be charged on a time-wasted basis. Settlement is due on completion of works and an administration charge of £25 will be added per month if unpaid within 30 days. We reserve the right to charge for design, advice and liaison work carried out should an order not be placed. Goods remain the property of CP Interiors until full settlement is received. Should payment not be received we reserve the right to attend premises during working hours to remove goods and not be required to make good. Our full terms and conditions apply and are available on request.

**Tropical Blinds Ltd**

Unit 6 and 7 Five Arches Business Est  
 off Maidstone Road  
 Sidcup  
 Kent  
 DA14 5AE  
 Tel: 020 8269 6400 Fax: 020 8269 6401

**Quotation**  
 Customer Copy

**Vat No:** 324 0532 02  
**Cust Order No:** SO16230 GAUDIN  
**Order Date:** 15/10/2024  
**Order No:** 4748854  
**Cust Ref:**  
**Account Ref:** CPS007  
**Despatch Method:** DHL Economy

**Order To:**  
 C.P Interiors 2  
 Rue Des Pres Trading Estate  
 St Saviour  
 Jersey  
 Channel Islands  
 JE2 7QN

**Deliver To:**  
 C.P Interiors 2  
 Rue Des Pres Trading Estate  
 St Saviour  
 Jersey  
 Channel Islands  
 JE2 7QN

Type	Colour	Width	Drop	Quantity	Unit Price	Disc %	Net
1. Duorol 38mm Tube Duoflor, White, Duorol Two Part Bottom Rail - White, Left Control, White Plastic Duo Op Chain, Duorol Top Fix Bracket, Child Safety Chain Holder (Duorol) Measurement: Recess Size Location: Dining Room	Capri Jasmine Vision Fabric (L)	600	1360	1	109.78	30	76.85
Chain Length: 900							
2. Duorol 38mm Tube Duoflor, White, Duorol Two Part Bottom Rail - White, Left Control, Silver Metal No.10 Duo Op Chain, Duorol Top Fix Bracket, Child Safety Chain Holder (Duorol) Measurement: Recess Size Location: Dining Room	Capri Jasmine Vision Fabric (L)	1300	1360	1	218.41	30	152.89
Chain Length: 900							
3. Duorol 38mm Tube Duoflor, White, Duorol Two Part Bottom Rail - White, Right Control, Silver Metal No.10 Duo Op Chain, Duorol Top Fix Bracket, Child Safety Chain Holder (Duorol) Measurement: Recess Size Location: Dining Room	Capri Jasmine Vision Fabric (L)	600	1360	1	109.78	30	76.85
Chain Length: 900							

£232

£382

£232

4. Duorol Capri Jasmine Vision Fabric (L) 1880 1150 201.84  
 38mm Tube Duoflor, White, Duorol Two Part Bottom Rail - White, Left Control, White Plastic  
 Duo Op Chain, Duorol Top Fix Bracket, Child Safety Chain Holder (Duorol)  
 Measurement: Recess Size Chain Length: 900  
 Location: Kitchen Spec. ins: £505  
 Fitting ins:

5. Duorol Capri Jasmine Vision Fabric (L) 970 1370 122.09  
 38mm Tube Duoflor, White, Duorol Two Part Bottom Rail - White, Left Control, Silver Metal  
 No.10 Duo Op Chain, Duorol Face Fix Bracket, Child Safety Chain Holder (Duorol)  
 Measurement: Recess Size Chain Length: 900  
 Location: Megan's Study Spec. ins: £305  
 Fitting ins:

6. Roller - With Cass H/box SW/SprngCarnival BO FR Cream R/F (LL) 1140 1180 73.99  
 32mm Roller Tube, Full Fas Cas (70mm) White, Standard Brackets Req., Cass/Fasc Spring  
 Top Bracket - White, Standard P.V.C. Bottom Rail - 5m - White, Right Hand Control, White,  
 Silver No. 10 Metal Operating Chain, No Scallop, No Braid Required, N/A, No Pole, No Finial,  
 No Eyelets Required, No Pull Required, No Hold Down Clips Required, Reverse Roll, No  
 Specials, No Specials, Easybreak No.10 Chain Connector - Grey For Metal Chain, Not  
 Applicable £225  
 Measurement: Blind Size Spec. ins:  
 Location: Master Bedroom W1 Fitting ins:

7. Roller - With Cass H/box SW/SprngCarnival BO FR Cream R/F (LL) 1530 1325 104.10  
 32mm Roller Tube, Full Fas Cas (70mm) White, Standard Brackets Req., Cass/Fasc Spring  
 Top Bracket - White, Standard P.V.C. Bottom Rail - 5m - White, Right Hand Control, White,  
 Silver No. 10 Metal Operating Chain, No Scallop, No Braid Required, N/A, No Pole, No Finial,  
 No Eyelets Required, No Pull Required, No Hold Down Clips Required, Reverse Roll, No  
 Specials, No Specials, Easybreak No.10 Chain Connector - Grey For Metal Chain, Not  
 Applicable £280  
 Measurement: Blind Size Spec. ins:  
 Location: Master Bedroom W2 Fitting ins:

8. Roller - With Cass H/box SW/SprngCarnival BO FR Cream R/F (LL) 1150 1175 73.99  
 32mm Roller Tube, Full Fas Cas (70mm) White, Standard Brackets Req., Cass/Fasc Spring  
 Top Bracket - White, Standard P.V.C. Bottom Rail - 5m - White, Right Hand Control, White,  
 Silver No. 10 Metal Operating Chain, No Scallop, No Braid Required, N/A, No Pole, No Finial,  
 No Eyelets Required, No Pull Required, No Hold Down Clips Required, Reverse Roll, No  
 Specials, No Specials, Easybreak No.10 Chain Connector - Grey For Metal Chain, Not  
 Applicable £225

Measurement: Recess Size SW Spec. ins:  
 Location: Bedroom 2 Fitting ins:

Chain Length: 900

9. Roller - With Cass H/box SW/SprngCarnival BO FR Cream R/F (LL) 1530 1320 171.94 51.92 104.10	1	171.94	51.92	104.10
32mm Roller Tube, Full Fas Cas (70mm) White, Standard Brackets Req., Cass/Fasc Spring Top Bracket - White, Standard P.V.C. Bottom Rail - 5m - White, Right Hand Control, White, Silver No. 10 Metal Operating Chain, No Scallop, No Braid Required, N/A, No Pole, No Finial, No Eyelets Required, No Pull Required, No Hold Down Clips Required, Reverse Roll, No Specials, No Specials, Easybreak No.10 Chain Connector - Grey For Metal Chain, Not Applicable			44.58	

f280

Measurement: Recess Size SW Spec. ins:  
 Location: Bedroom 3 W1 Fitting ins:

Chain Length: 1100

10. Roller - With Cass H/box SW/SprngCarnival BO FR Cream R/F (LL) 1160 1180 120.46 51.92 73.99	1	120.46	51.92	73.99
32mm Roller Tube, Full Fas Cas (70mm) White, Standard Brackets Req., Cass/Fasc Spring Top Bracket - White, Standard P.V.C. Bottom Rail - 5m - White, Right Hand Control, White, Silver No. 10 Metal Operating Chain, No Scallop, No Braid Required, N/A, No Pole, No Finial, No Eyelets Required, No Pull Required, No Hold Down Clips Required, Reverse Roll, No Specials, No Specials, Easybreak No.10 Chain Connector - Grey For Metal Chain, Not Applicable			33.42	

f225

Measurement: Recess Size SW Spec. ins:  
 Location: Bedroom 3 W2 Fitting ins:

Chain Length: 900

11. Cust Own Roman Waterfall (Standard), Lining - Bonded BLACKOUT (with Fleece 400g EB), Pelmet Required, Evans Right Hand Control (Breakaway), Continuous Metal Chain Chrome, N/A, None Required, No Handset Required, No Power Supply Required, Not Required, Not Required, No Hub Required, Roman Breakaway Chain Mechanism, Not Applicable	1	125.42	10	152.98
Measurement: Recess Size Spec. ins: Location: Master Bedroom W1 Fitting ins:			43.48	

f382

Measurement: Recess Size Spec. ins:  
 Location: Master Bedroom W2 Fitting ins:

Chain Length: 700

12. Cust Own Roman Waterfall (Standard), Lining - Bonded BLACKOUT (with Fleece 400g EB), Pelmet Required, Evans Right Hand Control (Breakaway), Continuous Metal Chain Chrome, N/A, None Required, No Handset Required, No Power Supply Required, Not Required, Not Required, No Hub Required, Roman Breakaway Chain Mechanism, Not Applicable	1	154.36	10	183.23
Measurement: Recess Size Spec. ins: Location: Master Bedroom W2 Fitting ins:			48.16	

f457

Measurement: Recess Size Spec. ins:  
 Location: Master Bedroom W2 Fitting ins:

Chain Length: 1300

13. Cust Own Roman	1	125.42	10	152.98
--------------------	---	--------	----	--------

f382

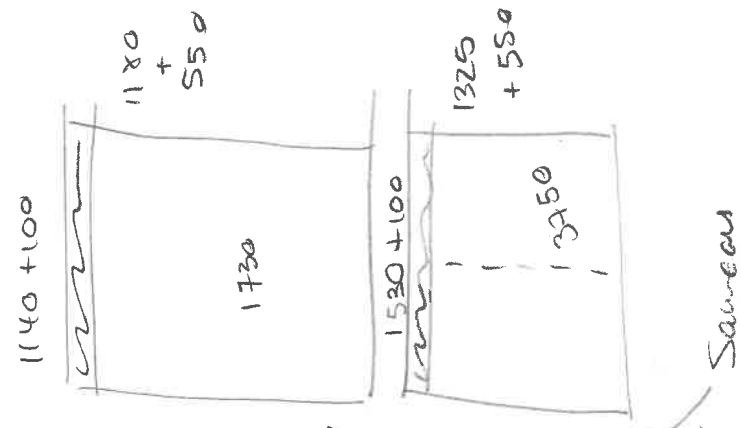

43.48

Waterfall (Standard), Lining - Bonded BLACKOUT (with Fleece 400g EB), Pelmet Required,  
 Evans Right Hand Control (Breakaway), Continuous Metal Chain Chrome, N/A, None  
 Required, No Handset Required, No Power Supply Required, Not Required, Not Required, No  
 Hub Required, Roman Breakaway Chain Mechanism, Not Applicable  
 Measurement: Recess Size Spec. ins:  
 Location: Lola's Bedroom Chain Length: 1100  
 Fitting ins:

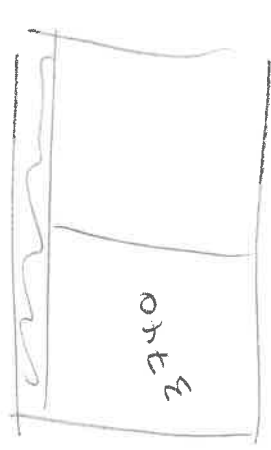

14. Cust Own Roman Customer's Own Fabric 1530 1320 1 154.36 10 183.23

Waterfall (Standard), Lining - Bonded BLACKOUT (with Fleece 400g EB), Pelmet Required,  
 Evans Right Hand Control (Breakaway), Continuous Metal Chain Chrome, N/A, None  
 Required, No Handset Required, No Power Supply Required, Not Required, Not Required, No  
 Hub Required, Roman Breakaway Chain Mechanism, Not Applicable  
 Measurement: Recess Size Spec. ins:  
 Location: Bedroom 3 W1 Chain Length: 1300  
 Fitting ins:

£452

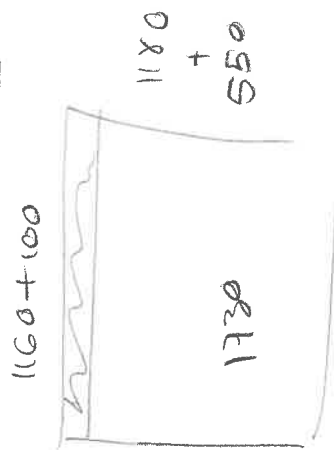

15. Cust Own Roman Customer's Own Fabric 1160 1180 1 125.42 10 152.98

Waterfall (Standard), Lining - Bonded BLACKOUT (with Fleece 400g EB), Pelmet Required,  
 Evans Right Hand Control (Breakaway), Continuous Metal Chain Chrome, N/A, None  
 Required, No Handset Required, No Power Supply Required, Not Required, Not Required, No  
 Hub Required, Roman Breakaway Chain Mechanism, Not Applicable  
 Measurement: Recess Size Spec. ins:  
 Location: Bedroom 3 W2 Chain Length: 1100  
 Fitting ins:

£382

Net Total: 1886.09

VAT: 0.00

Total: 1886.09

1180 + 550

**Mr & Mrs. Paul & Megan Gaudin**

**Haut Des Paliers  
La Rue De La Genestiere  
St Martin  
JE3 6DW**

Date	Reference	Your Contact
15-10-2024	SO16230	Tamara

<b>Customer Ref.</b>
----------------------

Main House - Option 1 Roller Blinds
-------------------------------------

## Quote

Our Price Promise to you  
We are so confident our pricing is competitive, that we will beat any written quotation for equivalent product by 5%

### Supply & Fit/Supply Only

Location	Product	<i>band</i> Description	Qty	Price
Dining Room W1	Duorol blind	in a and A fabric of your choice and white hardware. Hand operated with a left hand side silver chain.	1	£ 232.00
Dining Room W2	Duorol blind	in a and A fabric of your choice and white hardware. Hand operated with a left hand side silver chain.	1	£ 382.00
Dining Room W3	Duorol blind	in a and A fabric of your choice and white hardware. Hand operated with a right hand side silver chain.	1	£ 232.00
Kitchen	Duorol blind	in a and A fabric of your choice and white hardware. Hand operated with a side silver chain.	1	£ 505.00
Megan's Study	Duorol blind	in a and A fabric of your choice and white hardware. Hand operated with a side silver chain.	1	£ 305.00
Master Bedroom W1	Roller blind	with a 70mm white fascia, in a blackout fabric of your choice (Band B). Reverse roll. Manually operated with a side silver chain.	1	£ 225.00
Master Bedroom W2	Roller blind	with a 70mm white fascia, in a blackout fabric of your choice (Band B). Reverse roll. Manually operated with a side silver chain.	1	£ 280.00
Lola's bedroom	Roller blind	with a 70mm white fascia, in a blackout fabric of your choice (Band B). Reverse roll. Manually operated with a side silver chain.	1	£ 225.00
Bedroom 3 W1	Roller blind	with a 70mm white fascia, in a blackout fabric of your choice (Band B). Reverse roll. Manually operated with a side silver chain.	1	£ 280.00
Bedroom 3 W2	Roller blind	with a 70mm white fascia, in a blackout fabric of your choice (Band B). Reverse roll. Manually operated with a side silver chain.	1	£ 225.00

Subject to final measurements,

**Terms : 50% deposit due with order, 50% on completion**

BACS Payment	
Bank:	NatWest
Sort Code:	60 12 03
Account No:	66577772
Carpet Protection (C.I) Ltd T/A CP Interiors	

Phone and Card Payment
Payment can be made in person or by phone. If phone, please call us on 01534 768141 and have your card details ready. Note, we do not accept American Express or Cheque payments.

<b>Subtotal :</b>	<b>£ 2,891.00</b>
<b>GST :</b>	<b>£ 144.55</b>
<b>Total :</b>	<b>£ 3,035.55</b>

Please note: This quotation is only valid for acceptance for 7 days. Our estimate does not include any electrical work or additional carpentry work to install the above unless otherwise specified. Please note there is a handling charge on customer own fabric of £7.50 per metre. Due to high costs of labour, pre-arranged missed fitting appointments will be charged on a time-wasted basis. Settlement is due on completion of works and an administration charge of £25 will be added per month if unpaid within 30 days. We reserve the right to charge for design, advice and liaison work carried out should an order not be placed. Goods remain the property of CP Interiors until full settlement is received. Should payment not be received we reserve the right to attend premises during working hours to remove goods and not be required to make good. Our full terms and conditions apply and are available on request.

