

1050

~~1045~~ ~~1045~~ x

1000 x 2100

1060 ~~1055~~ x

2065
1060

3125

3125
FASCIA

BARRY drop?
SAW

920

865 x 2100

930



RECEIVED
26 NOV 2014
SCANNED

7000 x 3000

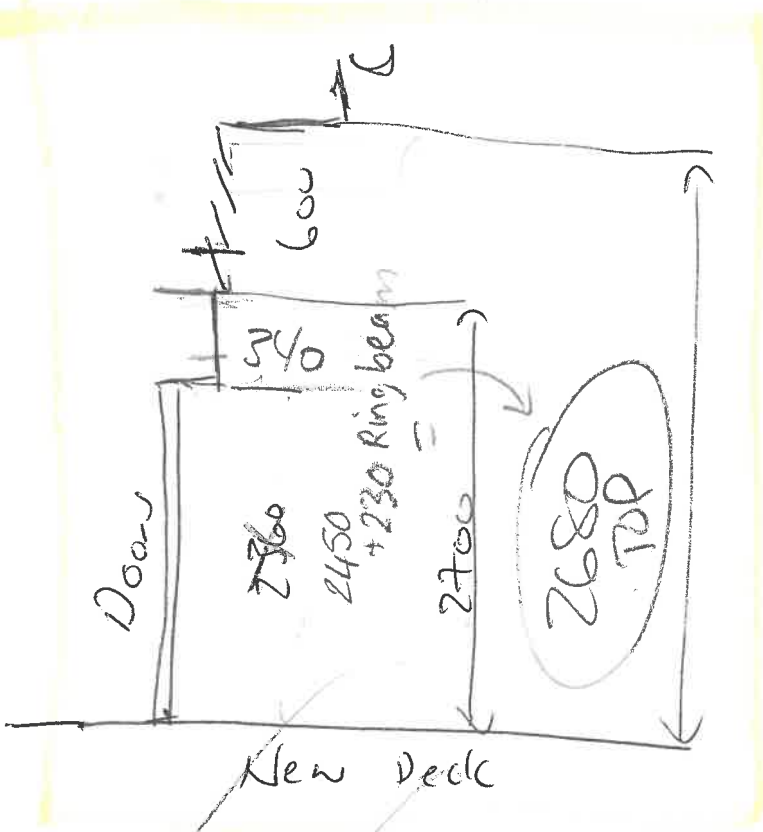

4300 x 1370
T/W
FD

FR Trade
So Fabric
170mm above
newest

Paul Mann
JA 7063-070
Double ply
Standard Lining

Kitchen Inu roller
535 x 1040 Slan
22m deep

1210 x 1000 Rec



Configuration details

weinor Ltd 73 Cornhill EC3V 3QQ London

C P Interiors

Rue Des Pres Trading Estate
GB-JEZ 7QN St Saviour Jersey

reference: BEANEY
Your order no.: SO15999
weinor customnumber: 165708
creation Date: 26.09.2024
weinor pers. in charge: William Abbott
phone / fax number: +49-221-59709-472
representat.: Chris Spickett
tel (representat.): 0044 (0) 7894443907

| pos | quantity | article | weinor Artares | price |
|-----|----------|---------|----------------|-----------|
| 1 | 1 | | | 32.700,00 |

Product use : private house
Permissible snow load on the roof : 0,52 (kN/m²)
Wind load (kN/m²) : 0,84
Long side fascia dimension [mm] : 3000 mm
Short side dimension [mm] : 7000 mm
Bottom fascia edge height [mm] : 2450 mm
measurement : 3000mm x 7000mm
Revision profile version : Blank-Design
Base colour : WTD29/71289 Approx. RAL 7016
Base colour 2 : RAL 6009 Fir green
Attika
Vertical sun protection S1 : Continuous
Vertical sun protection S2 : Double-sided
Vertical sun protection S3 : Continuous
colour LED strip in short side fascia : 2 Piece
Quantity of electronic components profiles : 2 Piece
Number of standard louvers 190 total : 34 Piece
with white light LED strips : 3 Piece
Louvre pitch (viewed from side 3) : From the left to the right (side 4 - side 2)
Louvers' direction of opening (seen from the lower side) : Clockwise
Power supply via : E1



Configuration details

weinor Ltd 73 Cornhill EC3V 3QQ London

customer: 165708 reference: BEANEY
pos quantity article price

Operation type : Remote control Somfy IO
Side of control : E2
With remote control BiConnectWith : no
remote control BiConnect

control : hand transmitter Situo 5 to Variation ALM II by weinor
light receiver : 1 Piece
Somfy RGBW inkl. Netzteil 24 V : 1 Piece
240W für Attika : 1 Piece

Integrierte Beschattung / W17
Vertical sun protection height (frame profile bottom edge (UKR) + 180 mm to the end of the cover plate guide profile for vertical sun protection) [mm] : 2625 0

Vorderseite Tuch : WET-210
Number of standard centre posts : 1 Piece
page 2 : 3500
Position M3 from the left [mm] : 300 mm

Insertion floor (mm) : 300 mm
Post type E1 : External post
Post attachment E1 : Post base M
Post type E2 : External post
Post attachment E2 : Post base M

Drain? : Drain through the post
Drain angle E2 : 90° drainage to the left
Post type E3 : External post
Post attachment E3 : Post base M
Drain? : Drain through the post

Drain angle E3 : 90° drainage to the right
Post type E4 : External post
Post attachment E4 : Post base M
Quantity of post bases for post : 5 Piece
Quantity of Universal Artares small parts sets : 1 Piece

weinor Ltd
73 Cornhill
GB-ECV 3QQ London
weinor.com

Managing Director:
Tim Fuldner
General partner:
Weinor Retailings-GmbH
Köln

VAT no.: 335 2381 16
Company no.: 1283056
UFR no.: 33431 26084
EORI no.: GB335238156000

Domestic transfers:
Commerzbank London
Sort Code: 405201
Account Number: 307 537 10
Intentional transfers:
Commerzbank London
IBAN: GB51 0904 4065 0130 7537 10
SWIFT: MIDL3322 a/c: CDBAG32X

weinor Ltd
73 Cornhill
GB-ECV 3QQ London
weinor.com

Managing Director:
Tim Fuldner
General partner:
Weinor Retailings-GmbH
Köln

VAT no.: 335 2381 16
Company no.: 1283056
UFR no.: 33431 26084
EORI no.: GB335238156000

Domestic transfers:
Commerzbank London
Sort Code: 405201
Account Number: 307 537 10
Intentional transfers:
Commerzbank London
IBAN: GB51 0904 4065 0130 7537 10
SWIFT: MIDL3322 a/c: CDBAG32X

Subject: RE: Artares Louvered Roof Quotation

Date: Tuesday, 17 September 2024 at 15:31:00 GMT+01:00

From: Rachel Baugh

To: Prue Beaney

CC: Ted Beaney

Attachments: image005.png, image006.png, image008.png, image009.png, image010.png, image011.png, image012.png

Hi Prue,

Thanks for confirming all below.

We have spoken to Mark who said easier to catch up when he is on site as wasn't planned to be back up to you when we called. Have sent him over the drawings and believe Adrian is going to chat to him about drainage positions hopefully next week.

We have not currently quoted the decorative strips you mention in your penultimate bullet point below – is this something you want added?

Kind Regards

Rachel Baugh

Interior Design Advisor

rachel@cpiinteriors.ie



Unit 28, The Drive Plus Trading Estate
\$1,500/m²
Jusey
01556 76014 | www.cpiinteriors.ie



With our CP Price promise we will beat any quote by 5% .. On site for like products only.

From: Prue Beaney <p.beaney@vasartglobal.com>

Sent: 10 September 2024 11:03

To: Rachel Baugh <rachel@cpiinteriors.ie>

CC: Ted Beaney <tbeaney@hotmail.co.uk>; Prue Beaney <p.beaney@vasartglobal.com>

Subject: RE: Artares Louvered Roof Quotation

Hi Rachel

Thanks for the pictures.

We want to go ahead with these colours.

- the frame including fascia to be the dark grey (WT 29/1289)
- the fascia to have a plain design
- the louvered roof only to be Fir Green (RAL6009)
- the right strip to be dark grey
- and the blinds to be charcoal (7-210)

NOT having, not quoted, agreed ✓

Please can you arrange the order and confirming the timings in due course?

Also, did you manage to get hold of Mark?

Kind regards

Prue

From: Rachel Baugh <rachel@cpiinteriors.ie>

Sent: 07 September 2024 10:32

To: Prue Beaney <p.beaney@vasartglobal.com>

CC: Ted Beaney <tbeaney@hotmail.co.uk>

Subject: RE: Artares Louvered Roof Quotation

Hi Ted & Prue,

Unfortunately my program is struggling to enter the exact colours onto the screens on your house model and likewise the Weinor portal is making the whole thing look really dark, so I would say it is somewhere in between! Hopefully it should give you an idea though. I have attached a pic of the sample colours you have selected together.

The existing Renson measurements are 4.5m x 3m x 2.5m High





- Weinor Artares 7m x 3m
- Scratchproof, resistant RAL colours with an elegant textured look
- Low-noise, high-quality louvers, with intelligent sensors
- Automatic weather protection
- Retractable Mesh Fix Screens to 3 sides, with long side on front being split into 2.
- Optional RGB fascia lighting to all sides
- Optional LED lighting in Louvres x 3
- Optional Tempura Quadra Heaters
- Compatible with smart home, mobile, tablet and voice control devices



CP INTERIORS

SO15999 | Beaney | Castle Rock



Mr & Mrs. Ted & Pru Beaney

Castle Rock
Holmfild Drive
Route Des Genets
St Brelades

| | |
|---------------|------------|
| Date | 13-08-2024 |
| Reference | SO15999 |
| Your Contact | Adrian |
| Customer Ref. | |
| | |

Quote

*** NO PHONE NUMBER**

Our Price Promise to you
We are so confident our pricing is competitive, that we will beat any written quotation for equivalent product by 5%

Supply & Fit

| Location | Description | QTY | Price |
|----------|---|-----|-------------|
| | Bladed Roof Systems with support legs Artares louvered roof, attached to house. Powder coated in a RAL weather resistant and scratchproof trend colour TBC. Option to match or contrast louvres, somfy IO operating system including remote control. 7m x 3m. | 1 | £ 33,092.00 |
| | Optional Extras 4 no. Vertical sun screens in a serge fabric tbc. Electrically operated and integrated within unit. Root System Accessories Lighting RGB colour changing lighting complete to shorter sides Root System Accessories Lighting RGB colour changing lighting complete to longest sides, LED lighting in Louvres x 3 Root System Accessories 2 no. Tempura Quadra Heaters, somfy operated 'dimmmable' including Tempura connection integrated within unit Somfy Tahoma Switch smart home hub to operate unit by, mobile, tablet and voice controlled devices., Decking works and glass balustrade not included. Drawings for indicative purposes only. Excludes wiring and electrical works + shower room kitchen display + garden room/waterproof terrace missing | 4 | £ 10,473.00 |
| | Root System Accessories Lighting RGB colour changing lighting complete to shorter sides | 2 | £ 2,180.00 |
| | Root System Accessories Lighting RGB colour changing lighting complete to longest sides, LED lighting in Louvres x 3 | 2 | £ 2,951.00 |
| | Root System Accessories 2 no. Tempura Quadra Heaters, somfy operated 'dimmmable' including Tempura connection integrated within unit | 2 | £ 3,286.00 |
| | Somfy Tahoma Switch smart home hub to operate unit by, mobile, tablet and voice controlled devices., Decking works and glass balustrade not included. Drawings for indicative purposes only. Excludes wiring and electrical works | 1 | £ 275.00 |

Terms : 40% deposit due with order, 40% on delivery & final 20% on completion

| | |
|--|--|
| BACS Payment | |
| Bank: NatWest | Payment can be made in person or by phone. |
| Sort Code: 60 12 03 | If phone, please call us on 01534 768141 and have your card details ready. |
| Account No: 66577772 | Note, we do not accept American Express or |
| Carpet Protection (C.I) Ltd T/A CP Interiors | |

Phone and Card Payment
Payment can be made in person or by phone.
If phone, please call us on 01534 768141 and have your card details ready.
Note, we do not accept American Express or
Cheque payments.

£63k agreed in 5/25
*Prices are subject to GST**



Please note: This quotation is only valid for acceptance for 7 days. Our estimate does not include any electrical work or additional carpentry work to install the above unless otherwise specified. Please note there is a handling charge on customer own fabric of £5 per metre. Due to high costs of labour, pre-arranged missed fitting appointments will be charged on a time-wasted basis. Settlement is due on completion of works and an administration charge of £25 will be added per month if unpaid within 30 days. We reserve the right to charge for design, advice and liaison work carried out should an order not be placed. Goods remain the property of CP Interiors until full settlement is received. Should payment not be received we reserve the right to attend premises during working hours to remove goods and not be required to make good. Our full terms and conditions apply and are available on request.



CP INTERIORS

Mr & Mrs. Ted & Pru Beaney

Castle Rock
Holmfield Drive
Route Des Genets
St Brelades

| Date | Reference | Your Contact |
|----------------------|-----------|--------------|
| 03-09-2024 | SO15999 | Rachel |
| Customer Ref. | | |
| | | |

Quote

Our Price Promise to you
We are so confident our pricing is competitive, that we will beat any written quotation for equivalent product by 5%

Supply & Fit/Supply Only

| Location | Description | QTY | Price |
|----------|--|-----|-------|
| | Bladed Roof Systems, Artares louvred roof, attached to house, Powder coated in a RAL weather resistant and scratchproof trend colour TBC. Option to match or contrast lc a | 1 | |
| | <i>organise builder for next week with Adrian + send new vivat + send weinor tech drawings</i> | | |
| | oric tbc. Electrically | 4 | |
| | complete to longest | 2 | |
| | | 3 | |
| | on/off Heaters from | 2 | |
| | , tablet and voice | 1 | |
| | specs on poster. 4.5m x | 1 | |
| | | 1 | |
| | indicative purposes | | |

Terms : 40% deposit due with order, 40% on delivery & final 20% on completion

| | | | | |
|--|----------|--|--|-------------------------------|
| BACS Payment | | Phone and Card Payment | | Subtotal : £ 57,142.86 |
| Bank: | NatWest | Payment can be made in person or by phone. | | |
| Sort Code: | 60 12 03 | If phone, please call us on 01534 768141 and have your card details ready. | | |
| Account No: | 66577772 | Note, we do not accept American Express or Cheque payments. | | GST : £ 2,857.14 |
| Carpet Protection (C.I) Ltd T/A CP Interiors | | | | Total : £ 60,000.00 |

Please note: This quotation is only valid for acceptance for 7 days. Our estimate does not include any electrical work or additional carpentry work to install the above unless otherwise specified. Please note there is a handling charge on customer own fabric of £5 per metre. Due to high costs of labour, pre-arranged missed fitting appointments will be charged on a time-wasted basis. Settlement is due on completion of works and an administration charge of £25 will be added per month if unpaid within 30 days. We reserve the right to charge for design, advice and liaison work carried out should an order not be placed. Goods remain the property of CP Interiors until full settlement is received. Should payment not be received we reserve the right to attend premises during working hours to remove goods and not be required to make good. Our full terms and conditions apply and are available on request.