

NOTES

Figured dimensions only are to be taken from this drawing. All dimensions are to be checked on site before any work is put in hand. If in doubt, seek confirmation.

This drawing must be read in conjunction with all other architects detail drawings, schedules and specifications.

All drawings are to be read in conjunction with relevant drawings from other consultants. In the case of inconsistencies, seek confirmation.

This drawing must not be copied in whole or in part without the prior written permission of Axis Mason Ltd.

© Copyright Axis Mason Ltd

Rev	Description	Dwn	Ckd	Date
T1	General Arrangement Plan	BC	NW	28/02/24

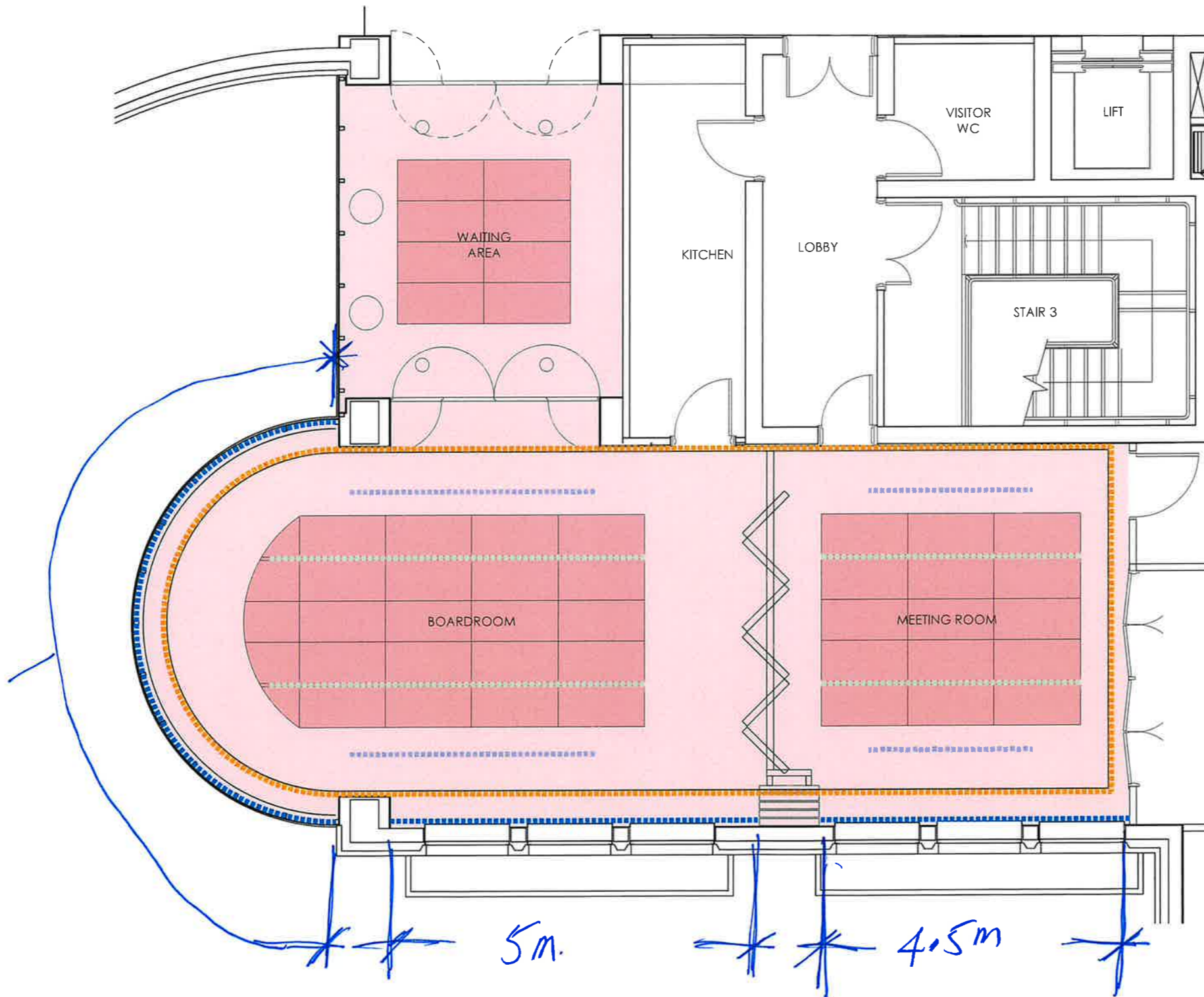

FINISHES KEY

- CT01 - PLASTERED CEILING.
- CT02 - SLATTED TIMBER 1265 X 600 CEILING PANELS.
- CT03 - CURTAIN RAILS.
- CT04 - M&E INDICATIVE VENT LOCATION.
- LT01 - TRACK LIGHTING.
- LT02 - L.E.D. STRIP LIGHT.
- LT03 - FEATURE PENDANT.
- LT04 - SPOTLIGHT.

AXIS MASON Sommerville House, Phillips Street
St. Helier, Jersey, JE2 4SW
01534 870 137 WWW.AXISMASON.COM

LONDON GLASGOW JERSEY GDANSK DURBAN

Client: Style Office - Natwest

Project: Natwest Jersey Boardroom
Bath Street
Jersey

Drawing Title: Reflected Ceiling Plan

Scale @ A2: 1:50 Date: FEBRUARY 2024
Project Issue: TENDER
Co-ordinator: NW

Job No:	Drawing No:	Revision:
4411	200	T1

F/C = 2.7m