

FLOOR 2

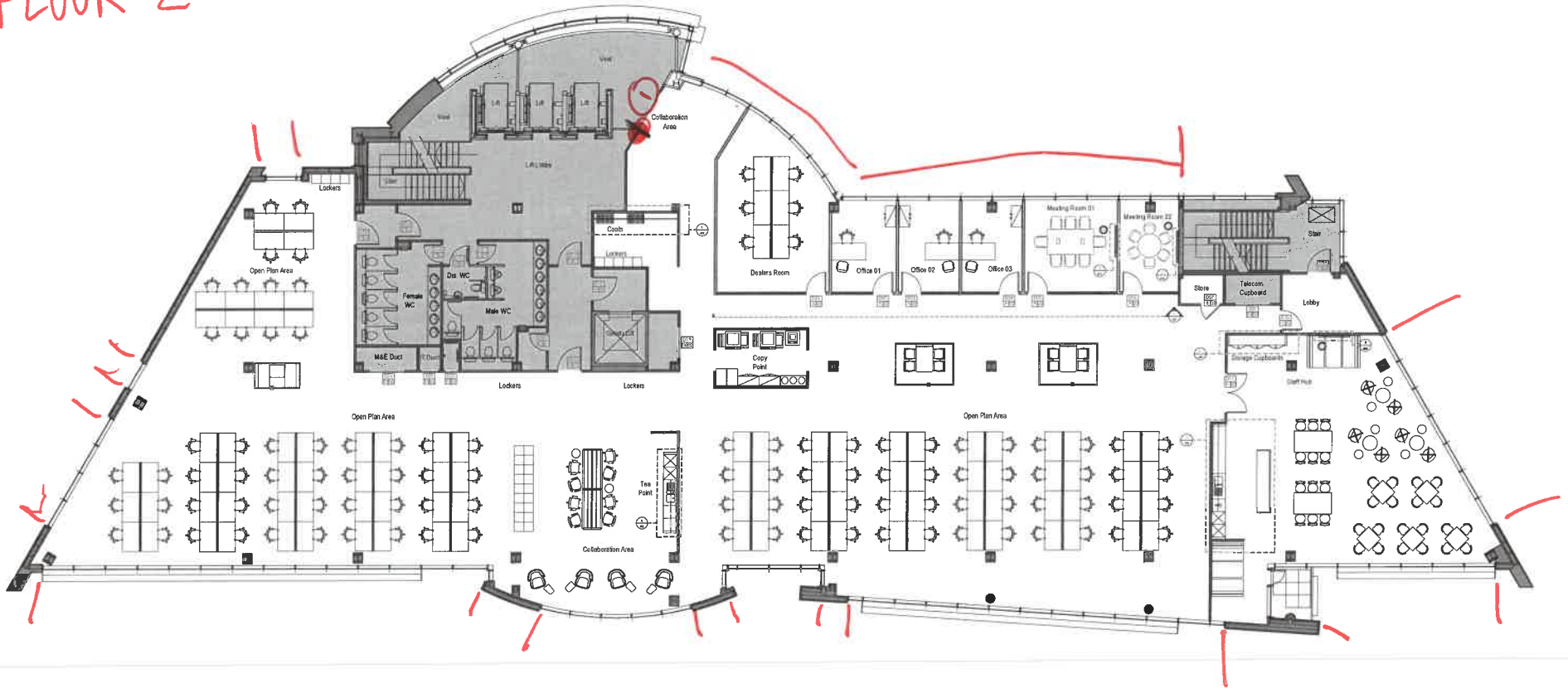

NOTES

1. Please do not alter any part of this drawing. All alterations are to be checked on site before any work is put in hand. If in doubt, seek our advice.

2. The drawings shall be read in conjunction with all other architectural drawings, schedules and specifications.

3. All drawings shall be read in conjunction with the contract documents, including the contract conditions of sale, and the contract documents.

4. The drawings shall not be copied or used in whole or in part without the prior written permission of Axis Mason Ltd.

© Copyright Axis Mason Ltd.

Rev	Description	Drawn	Checked	Date
C1	CONSTRUCTION ISSUE	DA	AMB	20/02/2024
C2	Revised Construction Issue	KC	AMB	12/02/2024

Client:	Butterfield Quay
Project:	Marble Court Admiral Park, St. Peter Port Guernsey
Drawing Title:	General Arrangement Plan Second Floor

AXIS MASON Commercial/Health/Pharma/Hotel
St. Peter, Jersey, JE2 4JH
CONTACT US: WWW.AXISMASON.COM

LONDON GLEAGOW JERSEY GDANSK DUBLIN

Scale @ A1: 1:100 Date: FEBRUARY 2024

Project: MC Issue: CONSTRUCTION

Co-ordinator: MG Status:

Job No:	Drawing No:	Revision:
4470	102	C2

LEGEND

	DOOR TAG
	DOOR NUMBER
	DOOR TYPE
	FLOOR NUMBER
	DETAIL TAG
	TV SYMBOL LOCATION
	AD DOTTING

Staff Name: Adrian

Work Diary

Order No: SO15620 Measurer or Fitter: Measurer Contact Address: Lothingingtons, Unit 7a, La Rue De Bechet, Trinity, JE3 5BE, 484448, nb@lothingingtons.com

Customer Ref: Butterfield, Martello Court, Guernsey

Date: 26-06-2024 Time: 11:00

Notes: 1 x Special 0 by 0, 85 x Roller blind 0 by 0

Location	Supplier	Blind Type /Description	Colour	Qty	Width	Drop	Fitting Height	Blind/Recess	Controls	Brackets	Surface	Unit Price
2nd Floor				1	1950	740		B/S	L/R	FACE		
				1	1220	2600			L	TOP		
				1	1140	2600			R			
				1	1150	2600			L			
				1	1210	2600			L			
				1	1190				L			
				1	1120				L			
				1	970				L			
				1	1070				L			
				1	1420				R			
				1	1420				L			
				1	1420				R			
				1	1360				L			
				1	1360				R			
				1	1420				L			
				1	1500				R			
				1	1420				R			

Comments:

①

Order Date

Customer Signature
 X
 I have checked and agree with the above choices

Target Fitting Date

Staff Name: Adrian

Work Diary

Order No Measurer or Fitter Contact Address

SO15620 Measurer Lothingingtons, Unit 7a , La Rue De Bechet , Trinity , , JE3 5BE, 484448,
nb@lothingingtons.com

Customer Ref
Butterfield, Martello Court, Guernsey

Date Time
26-06-2024 11:00

Notes : g
1 x . 0 by 0 , 1 x Special 0 by 0 , 85 x Roller blind 0 by 0

2600

Location	Supplier	Blind Type /Description	Colour	Qty	Width	Drop	Fitting Height	Blind/Recess	Controls	Brackets	Surface	Unit Price
2 nd F				1	1420	2300		B/P	L	TD		
				1	1300	2600			R			
				1	1420				L			
				5	1495				L			
				1	1430				L			
				1	1100				L			
				5	1495				L			
				1	1485				R			
				1	940				L			
				1	1250				R			
				1	630				R			
				1	1430				R			
				1	1500							
				10	1495							
				1	680							
				1	740							

Comments:
2

Order Date

Customer Signature

X
I have checked and agree with the above choices

Target Fitting Date

Staff Name: Adrian

Work Diary

Order No: SO15620 Measurer or Fitter: Measurer Contact Address: Lothingingtons, Unit 7a, La Rue De Bechet, Trinity, JE3 5BE, 484448, nb@lothingingtons.com

Customer Ref: Butterfield, Martello Court, Guernsey

Date: 26-06-2024

Time: 11:00

Notes: g
1 x . 0 by 0 , 1 x Special 0 by 0 , 85 x Roller blind 0 by 0

Location	Supplier	Blind Type /Description	Colour	Qty	Width	Drop	Fitting Height	Blind/Recess	Controls	Brackets	Surface	Unit Price
2nd Floor				1	885	2600		BS	R			
				81	1495							
				1	1930							
				1	580							
				1	650		#					
				3	1400							
				1	1380							
				4	1650							
				1	480							
				1	1590							
				12	1600							
				12	1495							
				1	1000							
				1	1440	750						
				1	1495	750						
				1	1495	750						
				1	1440	750						
				1	1380	2600						

Comments: * FY LAST IN ROW

3

79

1 1665

Order Date: X2600

Customer Signature: X
I have checked and agree with the above choices

Target Fitting Date: