

Helier Benest  
 ROK Construction Ltd.  
 Kirkella House  
 18 Val Plaisant  
 St Helier

JE2 4TA

Date	Reference	Your Contact
08-03-2024	SO15415Q2	Leeana
Customer Ref.		
Liberation House, Castle Street Stonehage		

## Quote

Our Price Promise to you

We are so confident our pricing is competitive, that we will beat any written quotation for equivalent product by 5%

### Supply & Fit

Location	Description	QTY	Price
Floor 3, Green Highlighter	Roller blind, manually operated in Quad Ebony 3% mesh (non silver back) fabric, silver side chain	33	£ 8,745.00
Floor 4, Boardroom, Meeting Room & Executive Offices, Blue Highlighter	Roller blind, electrically operated with a somfy sonesse motor, in Hyde blackout fabric	3	£ 1,695.00
Floor 4, Boardroom, Meeting Room & Executive Offices, Yellow Highlighter	Roller blind, electrically operated with a somfy sonesse motor, Quad 3% Ebony (non silver backed) fabric	6	£ 3,042.00
Floor 4, North + East Elevation, Orange Highlighter	Roller blind, manually operated in Quad Ebony 3% mesh (non silver back) fabric, silver side chain	11	£ 2,889.00
Floor 4, Reception, Purple Highlighter	Roller blind, manually operated in Quad 3% Ebony (non silver backed) mesh fabric, silver side chain	1	£ 271.00
	Situo 5 Remote controls,	3	£ 240.00
	. excludes wiring,		
	. We would highly recommend silver backing when installing black mesh to south elevations,		

**Terms :** 40% deposit due with order, 40% on delivery & final 20% on completion

BACS Payment	
Bank:	NatWest
Sort Code:	60 12 03
Account No:	66577772
Carpet Protection (C.I) Ltd T/A CP Interiors	

Phone and Card Payment
Payment can be made in person or by phone. If phone, please call us on 01534 768141 and have your card details ready.
Note, we do not accept American Express or Cheque payments.

<b>Subtotal :</b>	<b>£ 16,882.00</b>
<b>GST :</b>	<b>£ 844.10</b>
<b>Total :</b>	<b>£ 17,726.10</b>

Please note: This quotation is only valid for acceptance for 14 days. Our estimate does not include any electrical work or additional carpentry work to install the above unless otherwise specified. Please note there is a handling charge on customer own fabric of £7.50 per metre. Due to high costs of labour, pre-arranged missed fitting appointments will be charged on a time-wasted basis. Settlement is due on completion of works and an administration charge of £25 will be added per month if unpaid within 30 days. We reserve the right to charge for design, advice and liaison work carried out should an order not be placed. Goods remain the property of CP Interiors until full settlement is received. Should payment not be received we reserve the right to attend premises during working hours to remove goods and not be required to make good. Our full terms and conditions apply and are available on request.

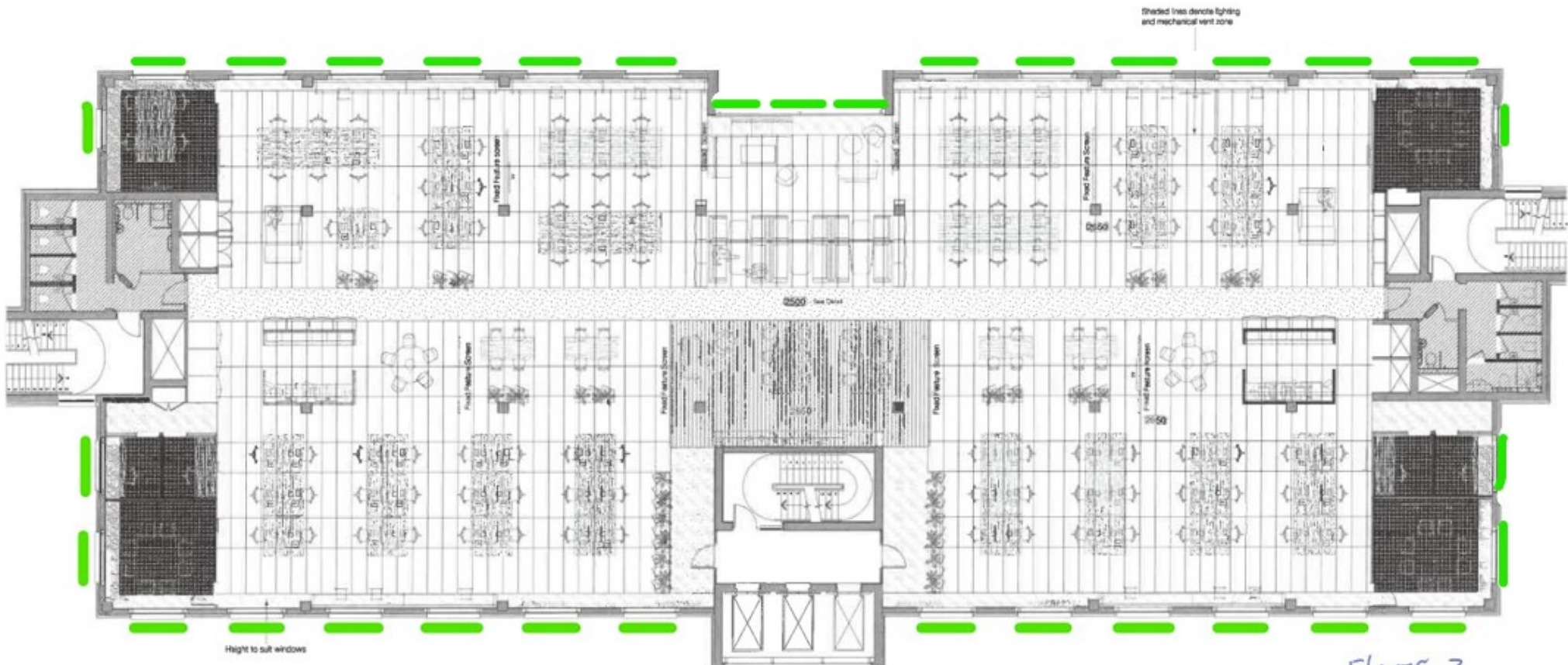



Floor 3

**GENERAL ARRANGEMENT PLAN**  
**Third Floor - Ceiling & Lighting - As Proposed**  
 Scale 1:75 @ A1 / 1:150 @ A3



**CEILING FINISH KEY**

-  Gyproc MF Plasterboard Ceiling Raft, height to be lower than main ceiling by approx. 150mm to allow for LED detail at edge. Mechanics installation sides - all to separate detail.
-  Ecophon Focus E Lay In Grid - Tigrular 1200x600 & 1800x600 Tiles with 25mm White Grid
-  Ecophon Focus E Black 600x600 with Black 15mm Grid

-  Gyproc MF Moisture Resistant Plasterboard Ceiling
-  Gyproc MF Plasterboard Ceiling - Height to Suit Windows
-  Laudescher Lines 2.8.8 Acoustic Solid Wood Suspended Ceiling Panels (65mm W) x 50mm D)

-  Black MDF ESW Hunter Douglas Slat Grill Ceiling - TBA
-  Timber Veneer Faced Acoustic Perforated Ceiling Tiles on a Concealed Grid
-  Ecophon Focus E White 600x600 Tigrular Tile with 15mm Grid
-  White Linear 1200x300 Metal Tiles With Lighting Feature in Between Every 2-3 Tiles. Metal Tiles to be Small Perforation Backed With Acoustic Pads

NB: Ceiling heights are estimated only to be double checked on site.  
 NB: Allow for 3no concealed circular 600mm diameter ceiling patches in lowered plasterboard left to suit mechanical ventilation requirements.

Check all dimensions on this plan against elevations only. The contractor is to report any discrepancies to designers prior to construction. If in doubt, ask. This drawing should be read in conjunction with all other Design team drawings, schedules and specifications. This drawing must not be used in whole or in part without the permission of Elliott Design Partnership. All contractors to comply with current building and fire regulations. No structural works to be carried out without structural engineer's consent.  
 Shading and omitted contractors to advise on details and ensure stability and strength of construction and suitability of materials. Shading contractors to provide setting out and cut drawings / services for approval prior to construction.

**NOTE:**  
 Drawing to be read in conjunction with the stamped approved Bye Laws Specification Document ref 1625-Spec-23  
 It is the contractor's responsibility to ensure that both documents are obtained from the designer

Revision	Date	Description	Checked
A	17/11/23	WD's Unlocked & Shower Added within, Quiet Rooms Removed for Additional Breakfast Area	TC
B	4/1/24	Ceiling Plan updated	TC

In Plan Scale: 1:75 @ A1 / 1:150 @ A3  
 Drawing Title: Third Floor - Ceiling & Lighting - As Proposed  
 Date: 04/01/2024  
 Drawing No: 1625\_L\_36  
 Revision: B  
 Email: d.p@elliottdesignpartnership.co.uk





FLOOR 4

**GENERAL ARRANGEMENT PLAN**  
**Fourth Floor - Ceiling & Lighting - As Proposed**  
 Scale 1:75 @ A1 / 1:150 @ A3



**CEILING FINISH KEY**

- Gyproc MF Plasterboard Ceiling Raft, height to be lower than main ceiling by approx. 150mm to allow for LED detail at edge. Mechanical installation sides - all to separate detail.
- Ecophon Focus E Lay In Grid - Tegular 1200x600 & 1800x600 Tile with 25mm White Grid
- Ecophon Focus E Black 600x600 with Black 15mm Grid

- Gyproc MF Moisture Resistant Plasterboard Ceiling
- Gyproc MF Plasterboard Ceiling - Height to Suit Windows
- Laudescher Lines 2.5.6 Acoustic Solid Wood Suspended Ceiling Panels - 65mm (W) x 50mm (D)

- Black MDF ESW Hunter Douglas Slat Grill Ceiling - TBA
- Timber Veneer Faced Acoustic Perforated Ceiling Tiles on a Concealed Grid
- Ecophon Focus E White 600x600 Tegular Tile with 15mm Grid
- White Linear 1200x300 Metal Tiles With Lighting Feature In Between Every 2-3 Tiles. Metal Tiles to be Small Perforation Backed With Acoustic Pads

NB: Ceiling heights are estimated only. To be double checked on site

NB: Allow for 3no concealed circular 600mm diameter ceiling hatches in lowered plasterboard raft to suit mechanical ventilation requirements.

Check all dimensions on site. Use figured dimensions only. The contractor is to report any discrepancies to designers prior to construction. If in doubt, ask. The drawing should be read in conjunction with all other Designers detail drawings, schedules and specifications. This drawing must not be copied in whole or in part without the permission of Elliot Design Partnership. All construction to comply with current building and fire regulations. No structural works to be carried out without structural engineer's detail.

Structuring and specialist contractors to advise on details and ensure exactly and strength of construction and suitability of materials. Shifting contractors to ensure setting out and not drawings / services for approval prior to construction.

Notes

**NOTE:**  
 Drawing to be read in conjunction with the stamped approved Bye Laws Specification Document ref: 1005-Spec-23  
 It is the contractors responsibility to ensure that both documents are obtained from the designer

Revision	Date	Description	Checked
A	17/11/23	WC's Unlocked and Shower Added With. Shower Room Removed & Converted to IT Store	TC
B	4/1/24	Common Room & IT Store Room Unlocked. Ceiling Plan Unlocked	TC
C	25/1/24	Client Suite ceiling & lights updated.	GE

Not For Build  
 Sign off issue  
 to inform client  
 in order  
 to allow  
 23rd Feb.



Sheet: Storage  
 Project Title: Education House Date: Jul. 2023  
 Drawing No: 1005\_L\_14 Revision: 0  
 Tel: (01534) 630001  
 Drawing Title: Fourth Floor - Ceiling & Lighting - As Proposed Status: As Shown  
 Email: david@edpdesignpartnership.com