

PREMIER CHOICE

14300

Pearl Way SO 14949

Arrived 7/2/24

Remake

fee

RECEIVED

07 FEB 2024

SCANNED

Bed 2

From:

Rachel Baugh

Sent:

Tuesday, 9 January 2024 08:59

To:

Scott Ruderham

Subject:

RE: SO14949 Wou - Damage on Arrival Curtain Bedroom 2

Follow Up Flag:

Follow up

Flag Status:

Completed

Its being made at the mo

Kind Regards

Rachel Baugh

Interior Design Advisor

rachel@cpiinteriors.ie



Unit 28 Rue Des Pres Trading Estate

St Savour

Jersey

JE2 7QN

01534 768141 | www.cpiinteriors.ie

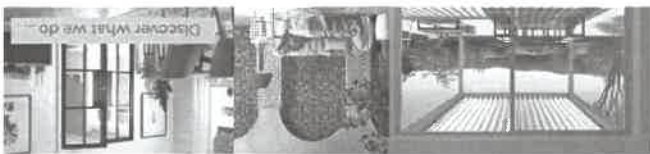

With our CP Price promise, we will beat any quote by 5% **
** On like for like products only

From: Scott Ruderham <scott@cpiinteriors.ie>

Sent: Tuesday, January 9, 2024 8:55 AM

To: Rachel Baugh <rachel@cpiinteriors.ie>

Subject: RE: SO14949 Wou - Damage on Arrival Curtain Bedroom 2

YO

I have the red file here would you mind chasing Donna please to save me jumping in as everything else is done for Mrs Wou

thanks

From: Rachel Baugh <rachel@cpiinteriors.ie>

Sent: Thursday, 4 January 2024 13:26

To: Donna Coleman <DonnaC@premierchoice.co.uk>

Cc: Scott Ruderham <scott@cpiinteriors.ie>

Subject: RE: SO14949 Wou - Damage on Arrival Curtain Bedroom 2

Hi Donna,

They are quite high end clients so would like them to be remade please. If you can confirm you will credit the fabric, I will get this ordered today.

Kind Regards

Rachel
Baugh

Interior Design Advisor
rachel@cpinteriors.ie



Unit 28 Rue Des Pres Trading Estate
St Saviour
Jersey
JE2 7QN
01534 768141 | www.cpinteriors.ie



Warm Regards,
Donna

Donna Withers

Customer Service



PREMIER CHOICE

CUSTOM MADE CURTAINS AND BLINDS

Confidentiality Notice: This message is prepared for the addressee only, and may contain information which is confidential or otherwise exempt from disclosure. If you are not the addressee, you should not read, copy, disseminate, or otherwise use this message, except for the purpose of delivering it to the addressee. Any opinions or advice contained in this message are subject to our standard terms and conditions.

☎ 01945 589558
✉ donna@premierchoice.co.uk
🌐 www.premierchoice.co.uk
📍 3-5 Algiotes Way, Wisbech PE13 2TQ

Hi Rachel
We will require 7.5mts fabric or will the customer except a discount?

From: Donna Coleman <DonnaC@premierchoice.co.uk>
Sent: Thursday, January 4, 2024 11:07 AM
To: Rachel Baugh <rachel@cpinteriors.ie>
Subject: RE: SO14949 Wou - Damage on Arrival Curtain Bedroom 2

From: Rachel Allo <rachel@cpinteriors.ie>
Sent: Thursday, January 4, 2024 8:35 AM
To: Donna Coleman <DonnaC@premierchoice.co.uk>
Subject: RE: SO14949 Wou - Damage on Arrival Curtain Bedroom 2

Hi Donna,

Do you have an update this please, do I need to order the fabric?

Kind Regards

Rachel
Baugh

Interior Design Advisor
rachel@cpiinteriors.ie



Unit 28 Rue Des Pres Trading Estate
St Savour
Jersey
JE2 7QN
01534 768141 | www.cpiinteriors.ie



** On like for like products only

With our CP Price promise, we will beat any quote by 5% **



Kind Regards

Rachel
Baugh

Interior Design Advisor
rachel@cpiinteriors.ie



Unit 28 Rue Des Pres Trading Estate
St Savour
Jersey
JE2 7QN
01534 768141 | www.cpiinteriors.ie



** On like for like products only

With our CP Price promise, we will beat any quote by 5% **

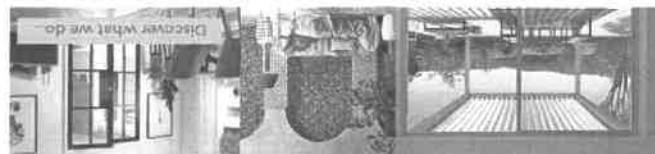

The trade on this fabric is £30p/m and is wide width.
Let me know how much is required and we can get on order.

Hi Donna,

From: Rachel Allo <rachel@cpiinteriors.ie>
Sent: Tuesday, 19 December 2023 16:05
To: Scott Ruderham <scott@cpiinteriors.ie>; Donna Coleman <DonnaC@premierchoice.co.uk>
Cc: Leanaa Taft <leanaa@cpiinteriors.ie>
Subject: RE: SO14949 Wou - Damage on Arrival Curtain Bedroom 2

Please note, our office will be closed for the Christmas break from Friday 22nd December, returning on Wednesday 3rd January 🗓️
Wishing you all a very Merry Christmas, and A Happy New Year!

From: Scott Ruderham <scott@cpiinteriors.ie>
Sent: Tuesday, December 19, 2023 12:00 PM

To: Donna Coleman <DonnaC@premierchoice.co.uk>
Cc: Leanaa Taft <Leanaa@cpiinteriors.ie>; Rachel Allo <rachel@cpiinteriors.ie>
Subject: RE: SO14949 Wou - Damage on Arrival Curtain Bedroom 2

Thank you Donna

My colleague Rachel will assist with this

Cheers

Scotty

From: Donna Coleman <DonnaC@premierchoice.co.uk>
Sent: Tuesday, 19 December 2023 11:58
To: Scott Ruderham <scott@cpiinteriors.ie>
Subject: RE: SO14949 Wou - Damage on Arrival Curtain Bedroom 2

Hi Scott

Can you please send me the costings for the fabric as I think we will have to remake .

Warm Regards,

Donna

We are pleased to inform you that our cut off dates for this year's pre Christmas deliveries will be as follows:-

Curtains Monday 13th November
Blinds Monday 20th November.

As with previous years, could you kindly ensure that we have received both your order details and the corresponding fabrics by these dates.

Donna Withers

Customer Service



PREMIER CHOICE

CUSTOM MADE CURTAINS AND BLINDS

Copyright Notice: This message is made for the addressee only, and may contain confidential information. If you are not the addressee, you should not read, copy, disseminate, or otherwise use the message, except for the purpose of delivering it to the addressee. Any copying or other use of any information contained in this message is strictly prohibited, and may be unlawful, if you are not the addressee.

From: Scott Ruderham <scott@cpiinteriors.ie>
Sent: Tuesday, December 19, 2023 11:48 AM

To: Donna Coleman <DonnaC@premierchoice.co.uk>
Cc: orders <orders@premierchoice.co.uk>; Leanaa Taft <Leanaa@cpiinteriors.ie>
Subject: RE: SO14949 Wou - Damage on Arrival Curtain Bedroom 2

Hi Donna

Have we got any further news please?

Few days left here and want to know all is in hands before we break up for 10 days

Many thanks
Scotty

From: Scott Ruderham
Sent: Thursday, 14 December 2023 09:27
To: Donna Coleman <DonnaC@premierchoice.co.uk>
Cc: orders <orders@premierchoice.co.uk>; Leanaa Taft <Leanaa@cpinteriors.ie>
Subject: RE: S014949 Wou - Damage on Arrival Curtain Bedroom 2

Hi Donna

Thank you, look forward to hearing back
Scotty

From: Donna Coleman <DonnaC@premierchoice.co.uk>
Sent: Thursday, 14 December 2023 09:21
To: Scott Ruderham <scott@cpinteriors.ie>
Cc: orders <orders@premierchoice.co.uk>; Leanaa Taft <Leanaa@cpinteriors.ie>
Subject: RE: S014949 Wou - Damage on Arrival Curtain Bedroom 2

Hi Scott

My apologies on the below I will have a look at the order, and we may have to remake the curtain as it is highly unlikely we will be able to repair.

I will grab the order and get back to you.

Warm Regards,
Donna

We are pleased to inform you that our cut off dates for this year's pre Christmas deliveries will be as follows:-

Curtains Monday 13th November
Blinds Monday 20th November.

As with previous years, could you kindly ensure that we have received both your order details and the corresponding fabrics by these dates.

Donna Withers

Customer Service



PREMIER CHOICE CUSTOM MADE CURTAINS AND BLINDS

☎ 01945 589558
✉ donna@premierchoice.co.uk
🌐 www.premierchoice.co.uk
📍 3-5 Algres Way, Wisbech PE13 2TQ

Confidentiality Notice: This message is intended for the addressee only, and may contain information that is confidential, privileged, unauthorised or otherwise subject to legal or other restrictions. If you are not the addressee, you should not read, copy, disseminate, distribute or otherwise use the message. If you are not the addressee, you should not read, copy, disseminate, distribute or otherwise use the message. Any copying or other use of this message is subject to our standard terms and conditions.

From: Scott Ruderham <scott@cpinteriors.ie>

Sent: Thursday, December 14, 2023 7:44 AM

To: orders <orders@premierchoice.co.uk>

Cc: Leanaa Taft <Leanaa@cpinteriors.ie>; Donna Coleman <DonnaC@premierchoice.co.uk>

Subject: RE: SO14949 Wou - Damage on Arrival Curtain Bedroom 2

Good Morning Premier

Can someone please get back to me regarding the below so I can update my client?

Many Thanks
Scotty

From: Scott Ruderham

Sent: Monday, 11 December 2023 09:09

To: orders <orders@premierchoice.co.uk>

Cc: Leanaa Taft <Leanaa@cpinteriors.ie>

Subject: SO14949 Wou - Damage on Arrival Curtain Bedroom 2

Dear Premier

Please can you review the attached photo from Order SO14949 WOU

We have fitted the order but when opening the box we have discovered the curtain for Bedroom 2 – is damaged. It appears the hooks have damaged the fabric as to how folded when packaged. Please can you review the image attached?

SO14949 BED 2 898874

LINED PINCH PLEAT TO 2.5M DROP-6W

SURCHARGE

BLACKOUT LINING PER METRE

Kind regards,

Ruderham

Logistics/Custom Care
scott@cpinteriors.ie



Unit 28 Rue Des Pres Trading Estate

St Savour

Jersey

JE2 7QN

01534 768141 | www.cpinteriors.ie

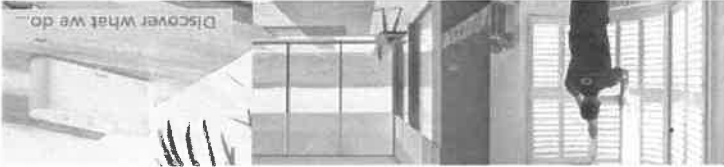

** On like for like products only
With our CP Price promise, we will beat any quote by 5% **

Discover what we do...

From: Rachel Allo
Sent: Tuesday, 19 December 2023 16:05
To: Scott Ruderham; Donna Coleman
Cc: Leana Taft
Subject: RE: SO14949 Wou - Damage on Arrival Curtain Bedroom 2

Follow Up Flag: Follow up
Flag Status: Completed

Hi Donna,

The trade on this fabric is £30p/m and is wide width.
Let me know how much is required and we can get on order.

Kind Regards

Rachel
Baugh

Interior Design Advisor
rachel@cinteriors.ie

Please note, our office will be closed for the Christmas break from Friday 22nd December, returning on Wednesday 3rd January 🎄🎅
Wishing you all a very Merry Christmas, and A Happy New Year!



Unit 28 Rue Des Pres Trading Estate
St Savour
Jersey
JE2 7QN
01534 768141 | www.cinteriors.ie

CP INTERIORS

With our CP Price promise, we will beat any quote by 5% **
** On like for like products only



From: Scott Ruderham <scott@cinteriors.ie>
Sent: Tuesday, December 19, 2023 12:00 PM
To: Donna Coleman <DonnaC@premierchoice.co.uk>
Cc: Leana Taft <LeanaTaft@cinteriors.ie>; Rachel Allo <rachel@cinteriors.ie>
Subject: RE: SO14949 Wou - Damage on Arrival Curtain Bedroom 2

Thank you Donna

My colleague Rachel will assist with this

Cheers
Scotty

From: Donna Coleman <DonnaC@premierchoice.co.uk>
Sent: Tuesday, 19 December 2023 11:58

Scott Ruderham

From: Donna Coleman <DonnaC@premierchoice.co.uk>
Sent: Thursday, 14 December 2023 09:21
To: Scott Ruderham
Cc: orders; Leana Taft
Subject: RE: SO14949 Wou - Damage on Arrival Curtain Bedroom 2

Follow Up Flag: Follow up
Flag Status: Completed

Hi! Scott

My apologies on the below I will have a look at the order, and we may have to remake the curtain as it is highly unlikely we will be able to repair.

I will grab the order and get back to you.

Warm Regards,
Donna

We are pleased to inform you that our cut off dates for this year's pre Christmas deliveries will be as follows:-

Curtains Monday 13th November
Blinds Monday 20th November.

As with previous years, could you kindly ensure that we have received both your order details and the corresponding fabrics by these dates.

Donna Withers

Customer Service



PREMIER CHOICE CUSTOM MADE CURTAINS AND BLINDS

Confidentially: Note: This message is intended for the addressee only. It may contain information which is confidential or otherwise subject to legal privilege. If you are not the addressee, you should not read, copy, disseminate, or otherwise use this message, except for the purpose of delivering it to the addressee. Any opinions or advice contained in this message are subject to our standard disclaimer.

☎ 01945 589558
✉ donna@premierchoice.co.uk
🌐 www.premierchoice.co.uk
📍 3-5 Algres Way, Wisbech PE13 2TQ

From: Scott Ruderham <scott@cpiinteriors.je>
Sent: Thursday, December 14, 2023 7:44 AM
To: orders <orders@premierchoice.co.uk>
Cc: Leana Taft <leana@cpiinteriors.je>; Donna Coleman <DonnaC@premierchoice.co.uk>
Subject: RE: SO14949 Wou - Damage on Arrival Curtain Bedroom 2

Good Morning Premier

Can someone please get back to me regarding the below so I can update my client?

From:

Scott Ruderham

Sent:

Monday, 11 December 2023 09:09

To:

orders

Cc:

Leeana Taft

Subject:

SO14949 Wou - Damage on Arrival Curtain Bedroom 2

Attachments:

Wou 1.jpeg: 0023298 13-11-23 SO14949 Wou.pdf

Dear Premier

Please can you review the attached photo from Order SO14949 WOU

We have fitted the order but when opening the box we have discovered the curtain for Bedroom 2 – is damaged. It appears the hooks have damaged the fabric as to how folded when packaged. Please can you review the image attached?

SO14949 BED 2 896674
LINED PINCH PLEAT TO 2.5M DROP-6W
SURCHARGE
BLACKOUT LINING PER METRE

Kind regards,

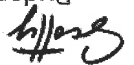

Ruderham

Logistics/Customer Care
scott@cpiinteriors.ie



Unit 28 Rue Des Pres Trading Estate
St Savour
Jersey
JE2 7QN
01534 768141 | www.cpiinteriors.ie

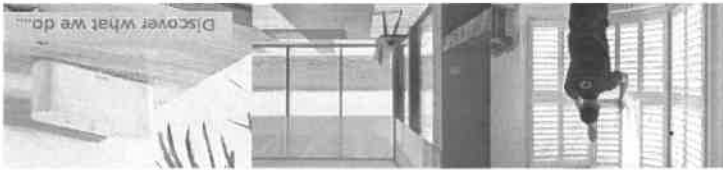

With our CP Price promise, we will beat any quote by 5% **
** On like for like products only

Discover what we do...