

**Tropical Blinds Ltd**

Unit 6 and 7 Five Arches Business Est  
off Maidstone Road  
Sidcup  
Kent DA14 5AE  
T: 020 8269 6400  
F: 020 8269 6401

**Order Acknowledgement**

Cust Order No : SO14839 CARA LAINE  
Order Date : 13/09/2023  
Order No : 848511  
Account Ref : CPS007  
Despatch method : DHL Economy  
Delivery Date : 17/10/2023  
Carriage Type : DHL Economy Select 2

**Order to :**

C.P Interiors  
Rue Des Pres Trading Estate  
St. Saviour  
Jersey  
Channel Islands  
JE2 7QN

**Deliver to :**

C.P Interiors 2  
Rue Des Pres Trading Estate  
St Saviour  
Jersey  
Channel Islands  
JE2 7QN

Type	Colour	Width	Drop	Quantity	Unit Price	Disc %	Net
Customers Own Roman	Customer's Own Fabric	1650	1380	1	148.42	10	166.90
Waterfall (Standard), Lining - Bonded BLACKOUT (with Fleece 400g EB), Pelmet Required, Left Hand Control, Continuous					37.02		
Metal Chain Chrome, Not Required, Roman Breakaway Chain Mechanism							
No Power Supply Required					0.00		
Measurement:Blind Size Spec. Ins: Face fix, 5m of Andrew Martin Theatre Denim fabric. Vertical repeat of 95.6cm							
Install Height: Not Specified Location: Ground floor Bedroom							

If a Premium carriage service is requested (Pre Noon, Pre 10.30, Saturday or Saturday Pre Noon) the relevant charge will be applied to your invoice. Goods delivered to the following areas: Cornwall, Dyfed, Powys, Anglesey, Gwynedd, Scotland, Isle of Wight, Isle of Man, Isle of Scilly, Channel Isles, Northern Ireland and Republic of Ireland will be subject to a carriage charge as detailed on Page 2 of our trade price list. These carriage charges may not appear on your order acknowledgement but will be applied to your invoice

Net Price :	£166.90
VAT :	£0.00
<b>Total :</b>	<b>£166.90</b>



**Tropical Blinds Ltd**

**Quotation**  
Customer Copy

Unit 6 and 7 Five Arches Business Est  
off Maidstone Road  
Sidcup  
Kent  
DA14 5AE  
Tel: 020 8269 6400 Fax: 020 8269 6401

**Vat No:** 324 0532 02  
**Cust Order No:** SO14839 CARA LAINE  
**Order Date:** 12/09/2023  
**Order No:** 3576658  
**Cust Ref:**  
**Account Ref:** CPS007  
**Despatch Method:**DHL Domestic

**Order To:**  
C.P Interiors  
Rue Des Pres Trading Estate  
St Saviour  
Jersey  
Channel Islands  
JE2 7QN

**Deliver To:**  
C.P Interiors 2  
Rue Des Pres Trading Estate  
St Saviour  
Jersey  
Channel Islands  
JE2 7QN

Type	Colour	Width	Drop	Quantity	Unit Price	Disc %	Net
Customers Own Roman	Customer's Own Fabric	1650	1380	1	148.42	10	166.90
Waterfall (Standard), Lining: Bonded BLACKOUT (with Fleece 400g EB), Pelmet Required, Left Hand Control, Continuous Metal Chain Chrome, N/A, None Required, No Handset Required, No Power Supply Required, Not Required, Roman Breakaway Chain Mechanism							37.02
Measurement: Blind Size				Spec. ins: Face fix, 5m of Andrew Martin Theatre Denim fabric.		Chain Length: 900	
Location: Ground floor Bedroom				Fitting ins: <b>(VERTICAL REPEAT 95.6cm)</b>			

Net Total: 166.90  
VAT: 0.00  
Total: 166.90

*RA checked ✓  
12-09*

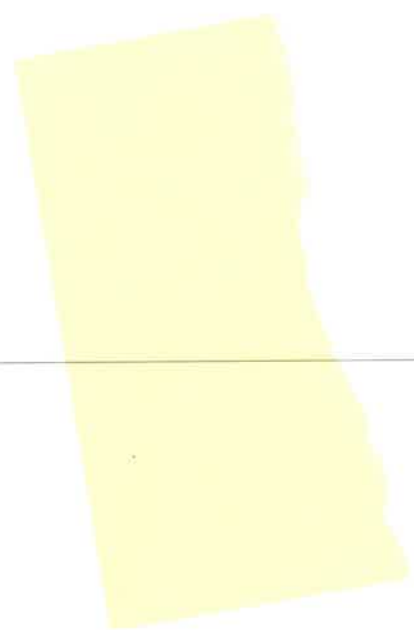

Mrs. Cara Laine  
Marissa  
Le Rue De La Valeuse  
St Brelade

JE3 8EE

Date	Reference	Your Contact
10-08-2023	SO14839	Alex Farry

Customer Ref.
Ground Floor Bedroom

## Quote

Our Price Promise to you

We are so confident our pricing is competitive, that we will beat any written quotation for equivalent product by 5%

### To Supply and Fit:

Location	Description	QTY	Price
Ground Floor Bedroom	Roman blind, with a pelmet flap and bonded blackout lining. Manually operated with a left hand side silver chain	1	£ 417.00
	Fabric, 5m of Andrew Martin Theatre Denim @£80 per metre,	1	£ 320.00

Terms : 50% due with order & final 50% on completion.

BACS Payment	
Bank:	NatWest
Sort Code:	60 12 03
Account No:	66577772
Carpet Protection (C.I) Ltd T/A CP Interiors	

Phone and Card Payment
Payment can be made in person or by phone. If phone, please call us on 01534 768141 and have your card details ready.
Note, we do not accept American Express or Cheque payments.

<b>Subtotal :</b>	<b>£ 737.00</b>
<b>GST :</b>	<b>£ 36.85</b>
<b>Total :</b>	<b>£ 773.85</b>

Please note: This quotation is only valid for acceptance for 14 days. Our estimate does not include any electrical work or additional carpentry work to install the above unless otherwise specified. Please note there is a handling charge on customer own fabric of £7.50 per metre. Due to high costs of labour, pre-arranged missed fitting appointments will be charged on a time-wasted basis. Settlement is due on completion of works and an administration charge of £25 will be added per month if unpaid within 30 days. We reserve the right to charge for design, advice and liaison work carried out should an order not be placed. Goods remain the property of CP Interiors until full settlement is received. Should payment not be received we reserve the right to attend premises during working hours to remove goods and not be required to make good. Our full terms and conditions apply and are available on request.





# CP INTERIORS

*re*

July 26, 2023

REF: SO14839

Mrs. Cara Laine  
Marissa  
Le Rue De La Valeuse  
St Brelade  
JE38EE

*Just top roman  
has samples, coming  
back tomorrow.*

Dear Mrs. Cara Laine

As requested, we have pleasure in submitting our quotation for the following.

*Discontinued 14.4m or 1.7m @ £80 p/m*  
Description Andrew Martin Theatre Denim  
137.2cm 95.6cm ↑

**Ground Floor Bedroom,**

To Supply and Fit ,Roman blind, with a pelmet flap and bonded blackout lining. Manually operated with a left hand side silver chain

1 £ 417.00

**Erica's Bedroom,**

To Supply and Fit ,Roman blind, with a pelmet flap and bonded blackout lining. Manually operated with a left hand side silver chain

1 £ 313.00

**Erin's Bedroom,**

To Supply and Fit ,Roman blind, with a pelmet flap and bonded blackout lining. Manually operated with a right hand side silver chain

1 £ 417.00

Fabric, 10m of a plain single width fabric of your choice. Price guide based on Villa Nova Lucerne @£36 per metre.

1 £ 360.00

If a patterned fabric is chosen, the amount of fabric needed will be reviewed..

Subtotal : £ 1,507.00

GST : £ 75.35

Total : £ 1,582.35

As with all our custom orders, we will require a deposit of 50%. All prices are subject to GST.

Thank you for your enquiry and we hope you will find this quotation acceptable. Should you require any further information, please contact us.

Yours sincerely  
Tamara

To accept the above quotation, please indicate which option is required, sign below and return this letter together with your deposit. Please note extract of our terms and conditions below.

.....  
SIGNATURE

.....  
DATE

Please note: This quotation is only valid for acceptance for 14 days. Our estimate does not include any electrical work or additional carpentry work to install the above unless otherwise specified. Please note there is a handling charge on customer order fabric of £5 per metre. Due to high costs of labour, pre-arranged missed fitting appointments will be charged on a time-wasted basis. Settlement is due on completion of works and an administration charge of £25 will be added per month if unpaid within 30 days. We reserve the right to charge for design, advice and liaison work carried out should an order not be placed. Goods remain the property of CP Interiors until full settlement is received. Should payment not be received we reserve the right to attend premises during working hours to remove goods and not be required to make good. Our full terms and conditions apply and are available on request.

As we no longer accept cheques, please do:

- Call us and pay by Card, we accept card transactions over the telephone and we will not charge you a handling fee.
- Bank details: Natwest, Sort Code 60-12-03, Account No 66577772 Carpet Protection (C.I) Ltd T/A CP Interiors

If you pay your deposit by BACS payment, please confirm the details of your order by returning a signed copy of this letter

Tel : (01534) 768141

[www.cpinteriors.je](http://www.cpinteriors.je)

Rue des Pres Trading Estate, St Saviour, Jersey, JE2 7QN

Blinds | Curtains | Awnings | Shutters | Furnishings | Interior Design | Project Management

**Tropical Blinds Ltd**

**Quotation**  
Customer Copy

Unit 6 and 7 Five Arches Business Est  
off Maidstone Road  
Sidcup  
Kent  
DA14 5AE  
Tel: 020 8269 6400 Fax: 020 8269 6401

**Vat No:** 324 0532 02  
**Cust Order No:** SO14839 CARA LAINE  
**Order Date:** 26/07/2023  
**Order No:** 3576658  
**Cust Ref:**  
**Account Ref:** CPS007  
**Despatch Method:** DHL Carrier 2 NEW

*10m of fabric  
m total*

**Order To:**  
C.P Interiors 2  
Rue Des Pres Trading Estate  
St Saviour  
Jersey  
Channel Islands  
JE2 7QN

**Deliver To:**  
C.P Interiors 2  
Rue Des Pres Trading Estate  
St Saviour  
Jersey  
Channel Islands  
JE2 7QN

Type	Colour	Width	Drop	Quantity	Unit Price	Disc %	Net
Customers Own Roman	Customer`s Own Fabric	1650	1380	1	148.42	10	166.90
Waterfall (Standard), Lining - Bonded BLACKOUT (with Fleece 400g EB), Pelmet Required, Left Hand Control, Continuous Metal Chain Chrome, N/A, None Required, No Handset Required, No Power Supply Required, Not Required, Roman Breakaway Chain Mechanism							37.02
Measurement: Blind Size Spec. ins: Face fix Chain Length: 900							<i>£417</i>
Location: Ground floor Bedroom Fitting ins:							
Customers Own Roman	Customer`s Own Fabric	1020	1300	1	111.30	10	125.39
Waterfall (Standard), Lining - Bonded BLACKOUT (with Fleece 400g EB), Pelmet Required, Left Hand Control, Continuous Metal Chain Chrome, N/A, None Required, No Handset Required, No Power Supply Required, Not Required, Roman Breakaway Chain Mechanism							28.02
Measurement: Blind Size Spec. ins: Top fix Chain Length: 800							<i>£313</i>
Location: Bedroom Fitting ins:							
<i>Erin's</i>							
Customers Own Roman	Customer`s Own Fabric	1490	1300	1	148.42	10	166.90
Waterfall (Standard), Lining - Bonded BLACKOUT (with Fleece 400g EB), Pelmet Required, Right Hand Control, Continuous Metal Chain Chrome, N/A, None Required, No Handset Required, No Power Supply Required, Not Required, Roman Breakaway Chain Mechanism							37.02
Measurement: Blind Size Spec. ins: Top fix Chain Length: 800							<i>£417</i>
Location: Erin's Bedroom Fitting ins:							

Net Total: 459.19

VAT: 0.00

Total: 459.19

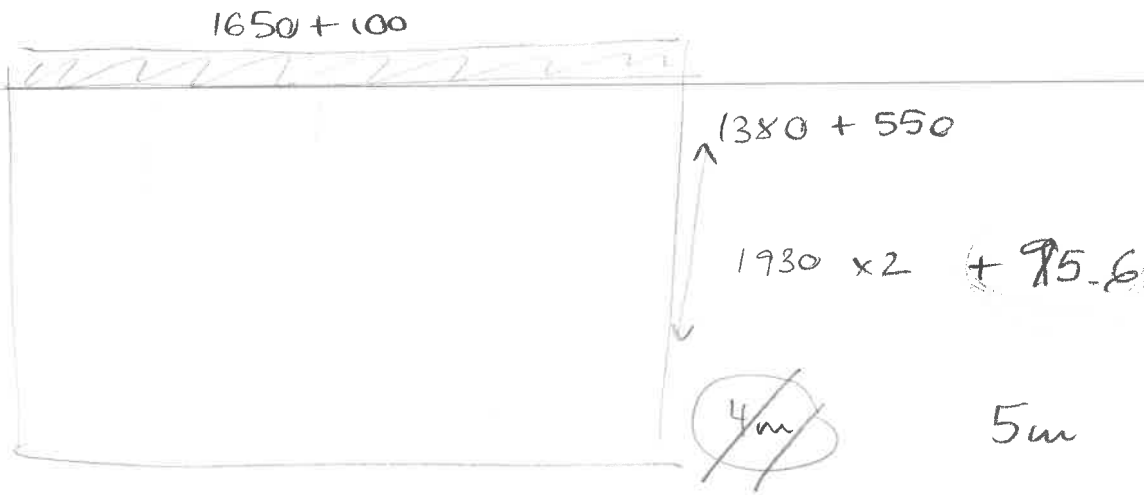

# PREMIERCHOICE

MANUFACTURERS OF QUALITY CUSTOM MADE CURTAINS, PELMETS AND BLINDS

CP INTERIORS JERSEY  
CP INTERIORS  
RUE DES PRES TRADING ESTATE  
ST SAVIOUR  
JERSEY  
JE2 7QN

Re: 2724 / 1 - SO14839 CARA LAINE

26 July 2023

Dear Customer,

THIS IS AN ESTIMATE ONLY. SHOULD YOU WISH TO PLACE AN ORDER KINDLY SEND A DETAILED WORKSHEET WHERE POSSIBLE USING THE PREMIER CHOICE ORDER FORM TO [orders@premierchoice.co.uk](mailto:orders@premierchoice.co.uk)

We thank you for your enquiry and we have the pleasure in estimating you as follows:

## GROUND FLOOR BEDROOM OPTION 1

1 Blind Bespoke , Hand Finished Bonded Blackout Lining

Rail size of 165cm, Drop of 138cm, Overall rail size: 165cm, 2 Widths in each

Making:	1	@	£269.45	=	£269.45
Fabric: 0.0	3.2	mts @	£0.00	=	£0.00
Lining: Premierchoice to Supply	3.2	mts @	£0.00	=	£0.00
Cassette System					

£ 269.45

BASED ON FABRIC DETAILS SUPPLIED IN EMAIL.

## GROUND FLOOR BEDROOM OPTION 2

1 Blind Bespoke , Hand Finished Bonded Blackout Lining

Rail size of 165cm, Drop of 138cm, Overall rail size: 165cm, 1.8 Mts in each

Making:	1	@	£269.45	=	£269.45
Fabric: 0.0	1.8	mts @	£0.00	=	£0.00
Lining: Premierchoice to Supply	3.2	mts @	£0.00	=	£0.00
Cassette System					

£ 269.45

BASED ON FABRIC DETAILS SUPPLIED IN EMAIL.

## BEDROOM 2 OPTION 1

1 Blind Bespoke , Hand Finished Bonded Blackout Lining

Rail size of 102cm, Drop of 130cm, Overall rail size: 102cm, 1 Widths in each

Making:	1	@	£184.19	=	£184.19
Fabric: 0.0	1.5	mts @	£0.00	=	£0.00
Lining: Premierchoice to Supply	1.5	mts @	£0.00	=	£0.00
Cassette System					

£ 184.19

BASED ON FABRIC DETAILS SUPPLIED IN EMAIL.