

2 Blindbox Level 01 Curtain Wall Layout
1:25

NOTE - Installed suspended ceiling to be cut to suit additional cross-corridor partitions.

- Note:**
- Roller blinds:** Roller blind dimensions to be site sized before procurement.
 - All curtain wall blind boxes to be continuous unless split by a partition wall. Drawing to be read in conjunction with the following:
 - (35) Curtain wall & Window Roller Blind Schedule Drawing: OAP-AXM-XX-ZZ-DR-A-3520
 - (35) Series Blind box Details.
 - (31) Series Curtain wall / Window Jamb
 - Ceiling heights / plasterboard perimeters:**
 - Ground floor +3.000m unless stated on drawing
 - Upper levels - All ceilings heights at +2.700m unless stated on drawing
 - Level 06 - Dormer +2.800m
 - Ceiling grid setting-out: Meeting rooms / private rooms**
 - Setting-out of grid ceilings to be centred on room as per GA plans unless otherwise annotated.
 - Spotlight / sprinkler head / access hatch setting-out:**
 - Refer to callouts for setting-out of spotlights / sprinkler heads / access hatches at plasterboard zones.
 - All sprinkler heads to be centred on ceiling tile within ceiling grid locations.
 - Refer to setting-out dimensions for sprinkler heads within plasterboard perimeter.
 - Setting-out of sprinklers to be confirmed with specialist designer.

In abeyance - Extended plasterboard area. AM request spotlights to plasterboard extent.

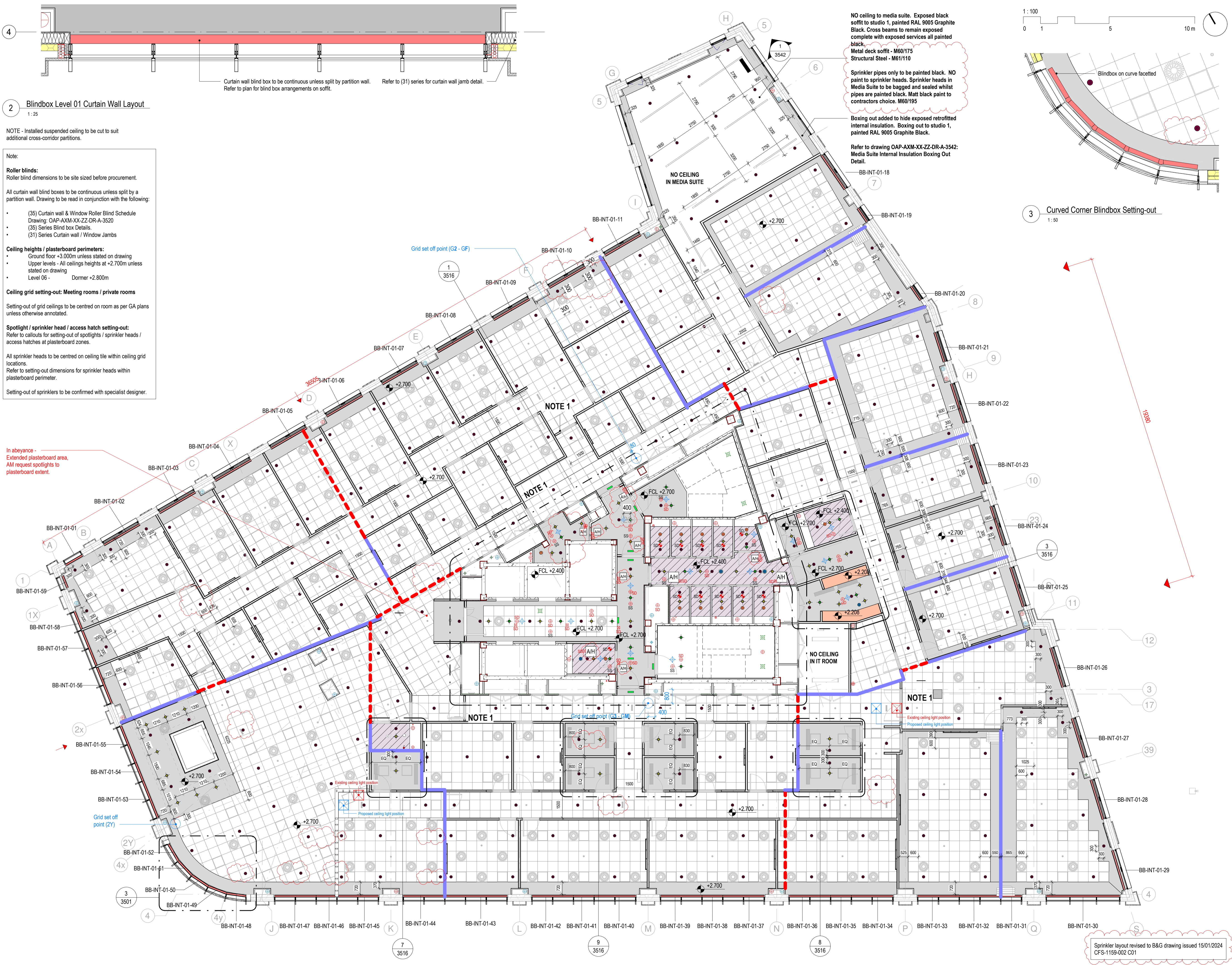

NO ceiling to media suite. Exposed black soffit to studio 1, painted RAL 9005 Graphite Black. Cross beams to remain exposed complete with exposed services all painted black.
Metal deck soffit - M60/175
Structural Steel - M61/110

Sprinkler pipes only to be painted black. NO paint to sprinkler heads. Sprinkler heads in Media Suite to be bagged and sealed whilst pipes are painted black. Matt black paint to contractors choice. M60/195

Boxing out added to hide exposed retrofitted internal insulation. Boxing out to studio 1, painted RAL 9005 Graphite Black.

Refer to drawing OAP-AXM-XX-ZZ-DR-A-3542: Media Suite Internal Insulation Boxing Out Detail.

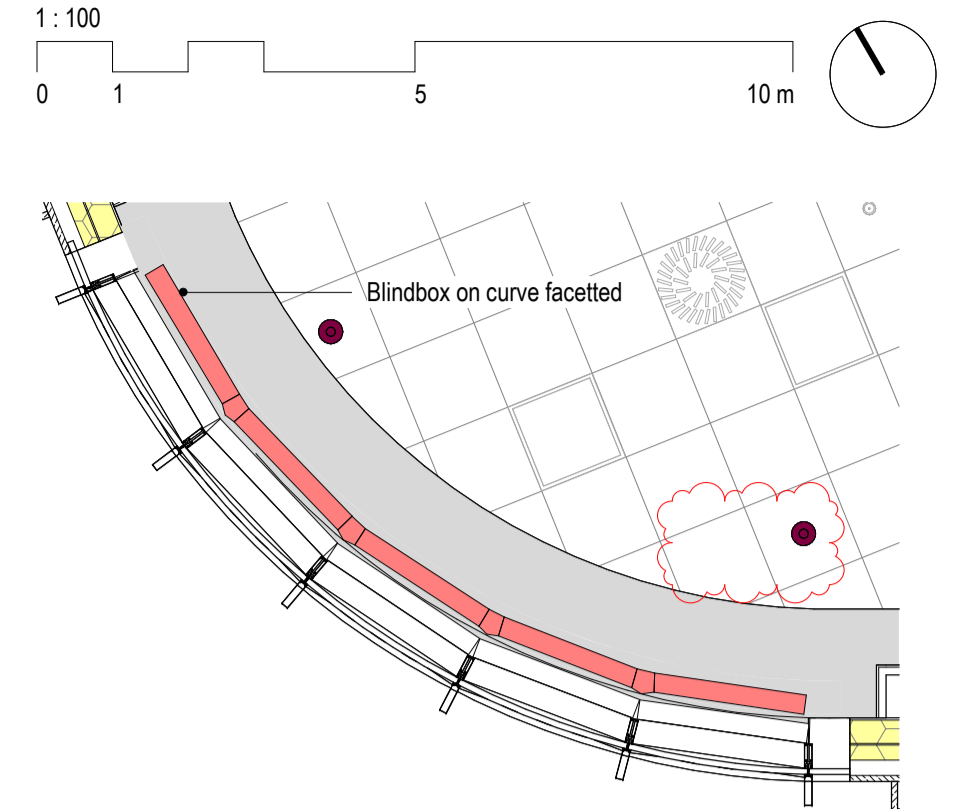

3 Curved Corner Blindbox Setting-out
1:50

NOTES

Figured dimensions only are to be taken from this drawing. All dimensions are to be checked on site before any work is put in hand. If in doubt, seek confirmation.

This drawing must be read in conjunction with all other architects detail drawings, schedules and specifications.

All drawings are to be read in conjunction with relevant drawings from other consultants. In case of inconsistencies, seek confirmation.

This drawing must not be copied in whole or in part without the prior written permission of Axis Mason Ltd.

© Copyright Axis Mason Ltd

| Rev | Description | Dwn | Ckd | Date |
|-----|--|-----|-----|----------|
| 1 | Ceiling Design Issue for Consultant Coordination | GP | CvD | 13.09.21 |
| 2 | Ceiling perimeter adjusted to suit M&E comments | KM | CvD | 28.09.21 |
| 3 | Tender Issue with MEP Overlay | CS | CvD | 27.01.22 |
| 4 | Layouts revised to include VR 029 for MEP Co-ordination | CS | KM | 22.04.22 |
| 5 | Ceilings updated to include VR038 bulkheads. Plasterboard perimeters adjusted to suit MEP layouts. Ceiling to media suite removed as per VR033 | CS | KM | 29.06.22 |
| 6 | Ceilings revised to suit M&E comments | CS | CvD | 04.07.22 |
| 7 | Ceiling layouts updated in line with VR39 & RF123, for MEP co-ordination | CS | KM | 30.09.22 |
| 8 | Issue to dandara for coating - VR33 | CS | KM | 15.03.23 |
| 9 | VR33 Media suite design changes made, MEP in abeyance | CS | KM | 25.04.23 |
| 10 | Construction Issue. Ceilings updated in line with VR 59, VR 64, VR 33, VR 53, RF1.41 & RF1.45. Increased plasterboard area to foyer, media suite ceiling removed, plasterboard added to core area, FF&E layouts updated. MEP layouts overlaid for co-ordination. | KM | - | 30.06.23 |
| 11 | RCP co-ordinated to VR 59 MEP design and issued for construction | AE | KM | 21.08.23 |
| 12 | Construction Issue - Additional cross-corridor partition and doors added Level 01. R&B-RCP-door schedules updated to suit. Door key scheduling requirements added to door schedule. Glazed partitions C-INT-01-01 - C-INT-05-15 elevation / setting-out added. | AE | KM | 07.11.23 |
| 13 | Construction Issue - Level 01 cross-corridor partition setting-out updated | CvD | AE | 10.11.23 |
| 14 | Colour to Media Suite exposed soffit / structural beams updated to RAL 9005 graphite black in accordance with VR 33. All revisions have been included in red. | AMc | KM | 08.01.24 |
| 15 | Sprinkler layout revised to B&G layout. Ceiling access hatches added to drawing. All revisions included in red. | AMc | CvD | 07.02.24 |

CEILING FINISHES

All ceiling details/trims refer to OAP-AXM-XX-DR-A-3507

- Ceiling Blindbox
- Plasterboard Bulkhead
- K40/115 - Compound Ceiling - Generic Grid (600x600mm) - White finish
- K10/220 - Plasterboard
- K10/220 - Moisture Resistant Plasterboard
- P10/185 - Insulated Soffit Board
- Ceiling Cavity Barrier
- Full height partition from slab to underside of soffit minimum FR30 to create fire barrier
- Sprinkler head
- Proposed location of spot light
- Ceiling mounted CCTV Dome 4K to MEP design & specification

OFFICIAL SENSITIVE

AXIS MASON
LONDON GLASGOW JERSEY GDANSK DURBAN

Client: Dandara Jersey Ltd

Project: Cyril Le Marquand House Office Accommodation Project

Drawing title: Reflected Ceiling Plan - Level 01

Scale @ A1: As indicated | Date: MAR 2023
Project Co-ordinator: CvD | Issue Status: CONSTRUCTION

Job No.: 3979 | Drawing No.: OAP-AXM-XX-01-DR-A-3501 | Revision: 15

Sprinkler layout revised to B&G drawing issued 15/01/2024 CFS-1159-002 C01