



CP INTERIORS

July 18, 2023

REF : SO14780

Mr & Mrs. David King
14 Brookhall
La Rue des Pres
St Saviour
JE2 7QL

CUS. REF : Curtains with no contrast edges

Dear Mr & Mrs. David King

As requested, we have pleasure in submitting our quotation for the following.

*Please return
any fabric left
to customer*

Description	QTY	Price
Dining Room W1, To Supply and Fit ,Curtain, Hand finished pair of curtains, with a double pleat header, cut out on left side and a 70mm leading edge (no contrast), synthetic interlining and standard lining.	1	£ 1,481.00
Dining Room W2, To Supply and Fit ,Curtain, Hand finished pair of curtains, with a double pleat header, a 70mm leading and trailing edge (no contrast), synthetic interlining and standard lining.	1	£ 1,019.00
Dining Room Main Fabric, Fabric, 29m of JAB Cocoon @£54.90 per metre., <i>7063-070 (white leaves and beige background)</i>		£ 1,592.10
Living Room W1, To Supply and Fit ,Curtain, Hand finished pair of curtains, with a double pleat header, a 70mm leading and trailing edge (no contrast), synthetic interlining and standard lining.	1	£ 672.00
Living Room Door, To Supply and Fit ,Curtain, Hand finished pair of curtains, with a double pleat header, a 70mm leading and trailing edge (no contrast), synthetic interlining and standard lining.	1	£ 1,071.00
Living Room W2, To Supply and Fit ,Curtain, Hand finished pair of curtains, with a double pleat header, a 70mm leading and trailing edge (no contrast), synthetic interlining and standard lining.	1	£ 672.00
Living Room Main Fabric, Fabric, 26m of Romo Mikado Silver Birch 7792/01 @£58.50 per metre,	1	£ 1,521.00

Curtains to be hung on existing poles and rings.

*How many ☺
for your records + premier.*

Subtotal : £ 8,028.10
GST : £ 401.41
Total : £ 8,429.51

As with all our custom orders, we will require a deposit of 50%. All prices are subject to GST.

Thank you for your enquiry and we hope you will find this quotation acceptable. Should you require any further information, please contact us.

*50% deposit paid
by card
on 21/07*

Yours sincerely
Tamara

To accept the above quotation, please indicate which option is required, sign below and return this letter together with your deposit. Please note extract of our terms and conditions below.

.....
SIGNATURE

Tamara

.....
DATE

Tel : (01534) 768141

www.cpinteriors.je

Rue des Pres Trading Estate, St Saviour, Jersey, JE2 7QN

Blinds | Curtains | Awnings | Shutters | Furnishings | Interior Design | Project Management

Please note: This quotation is only valid for acceptance for 14 days. Our estimate does not include any electrical work or additional carpentry work to install the above unless otherwise specified. Please note there is a handling charge on customer own fabric of £5 per metre. Due to high costs of labour, pre-arranged missed fitting appointments will be charged on a time-wasted basis. Settlement is due on completion of works and an administration charge of £25 will be added per month if unpaid within 30 days. We reserve the right to charge for design, advice and liaison work carried out should an order not be placed. Goods remain the property of CP Interiors until full settlement is received. Should payment not be received we reserve the right to attend premises during working hours to remove goods and not be required to make good. Our full terms and conditions apply and are available on request.

As we no longer accept cheques, please do:

- Call us and pay by Card, we accept card transactions over the telephone and we will not charge you a handling fee.
- Bank details: Natwest, Sort Code 60-12-03, Account No 66577772 Carpet Protection (C.I) Ltd T/A CP Interiors

If you pay your deposit by BACS payment, please confirm the details of your order by returning a signed copy of this letter

Tel : (01534) 768141

www.cpinteriors.je

Rue des Pres Trading Estate, St Saviour, Jersey, JE2 7QN

Blinds | Curtains | Awnings | Shutters | Furnishings | Interior Design | Project Management

CURTAIN ORDER FORM WEBSITE

COMPANY CP Interiors	CUSTOMER: King	ORDER REF: S014780	CONTACT NAME: Tamara
--------------------------------	--------------------------	------------------------------	--------------------------------

FABRIC DETAILS: JAB Cocoon 7063-070 (white leaves and beige background)	FABRIC WIDTH: 140cm	FABRIC REPEAT: 67cm	QUANTITY: 29m	RAILROAD:
---	-------------------------------	-------------------------------	-------------------------	------------------

COLOUR OF LINING IVORY OR ALMOND

DATE : 25/07/23	PC PREMIUM LINING:	PC STANDARD LINING: YES	PC BLACKOUT LINING:	PC INTERLINING: Synthetic Interlining	PC SATIN FLEECE LINING:
---------------------------	---------------------------	-----------------------------------	----------------------------	---	--------------------------------

TRIM/BRAID /BORDER :	BORDER SIZE:	TOP:	BOTTOM:	LEADING EDGE: See notes	RTN EDGE: See notes
-----------------------------	---------------------	-------------	----------------	-----------------------------------	-------------------------------

ALL MEASUREMENTS MUST BE IN METRIC		PAIR 1	PAIR 2	PAIR 3
PAIR		Dining Room Doors Pair with cut out	Dining Room Window Pair	
SINGLE				
WIDTHS PER CURTAIN				
OVERALL DROP		2120mm (see notes and attachment for cut out)	1320mm	
HOOK HEIGHT EYE DROP				
TRACK SIZE		3400mm	2500mm	
OVERLAPS & RETURNS		70mm leading edge (no contrast)	70mm leading and trailing edge (no contrast)	

ADDITIONAL INFORMATION:
29m of JAB Cocoon 7063-070 (white leaves and beige background on front of curtains). Dining Room Doors Pair has a cut out on left hand side (please refer to drawing attached) and 70mm leading edge. Dining Room Window Pair with 70mm leading and trailing edges. Please note customer has 34 rings for Dining Room Doors pair and 24 rings for the Window pair, plus 4 spare rings if needed, so please keep this in mind when calculating pleats. Please return any fabric leftovers.

INTERLINED - HANDSEWN	YES	YES	
LINED - HANDSEWN	YES	YES	
LINED - MACHINE			
HEADING PENCIL			
HEADING TRIPLE PINCH			
HEADING DOUBLE PINCH	YES	YES	

DEPTH OF BUCKRAM:

SINGLE PLEAT & CARTRIDGE PLEAT(CIRCUMFERENCE OF PLEAT IN CM)

CARTRIDGE FILLED OR UNFILLED

HEADING WAVE

INVISIBLE WAVE

THIS ORDER INCLUDES ON A SEPARATE SHEET (PLEASE TICK APPROPRIATE BOX)	CURTAINS
--	----------

RA

CURTAIN ORDER FORM WEBSITE

COMPANY CP Interior	CUSTOMER: King	ORDER REF: SO14780	CONTACT NAME: Tamara
-------------------------------	--------------------------	------------------------------	--------------------------------

FABRIC DETAILS: Romo Mikado Silver Birch 7792/01	FABRIC WIDTH: 136cm	FABRIC REPEAT: 80cm vertical repeat 68cm horizontal repeat	QUANTITY: 26m	RAILROAD:
--	-------------------------------	--	-------------------------	------------------

COLOUR OF LINING IVORY OR ALMOND			
---	--	--	--

DATE : 26/07/23	PC PREMIUM LINING:	PC STANDARD LINING: YES	PC BLACKOUT LINING:	PC INTERLINING: Synthetic	PC SATIN FLEECE LINING:
---------------------------	---------------------------	-----------------------------------	----------------------------	-------------------------------------	--------------------------------

TRIM/BRAID /BORDER :	BORDER SIZE:	TOP:	BOTTOM:	LEADING EDGE: See notes	RTN EDGE: See notes
-----------------------------	---------------------	-------------	----------------	-----------------------------------	-------------------------------

ALL MEASUREMENTS MUST BE IN METRIC	PAIR 1	PAIR 2	PAIR 3
PAIR	Living Room Pair 1	Living Room Pair 2	Living Room Pair 3
SINGLE			
WIDTHS PER CURTAIN			
OVERALL DROP	1300mm ✓	2115mm ✓	1300mm ✓
HOOK HEIGHT EYE DROP			
TRACK SIZE	1400mm ✓	2600mm ✓	1400mm ✓
OVERLAPS & RETURNS	70mm leading and trailing edge (no contrast) ✓	70mm leading and trailing edge (no contrast) ✓	70mm leading and trailing edge (no contrast) ✓

ADDITIONAL INFORMATION:
26m or Romo Mikado Silver Birch 7792/01. All curtains to have a 70mm leading and trailing edge with no contrast. Please note customer has got 14 rings for Pair 1, 26 rings for Pair 2 and 14 rings for Pair 3, please keep this in mind when calculating pleats. Please return any fabric leftovers.

INTERLINED - HANDSEWN	YES ✓	YES ✓	YES ✓
LINED - HANDSEWN	YES ✓	YES ✓	YES ✓
LINED - MACHINE			
HEADING PENCIL			
HEADING TRIPLE PINCH			
HEADING DOUBLE PINCH	YES ✓	YES ✓	YES ✓

DEPTH OF BUCKRAM:

SINGLE PLEAT & CARTRIDGE PLEAT(CIRCUMFERENCE OF PLEAT IN CM)

CARTRIDGE FILLED OR UNFILLED

HEADING WAVE

INVISIBLE WAVE

THIS ORDER INCLUDES ON A SEPARATE SHEET (PLEASE TICK APPROPRIATE BOX)	CURTAINS
--	----------

PREMIERCHOICE

MANUFACTURERS OF QUALITY CUSTOM MADE CURTAINS, PELMETS AND BLINDS

CP INTERIORS JERSEY
CP INTERIORS
RUE DES PRES TRADING ESTATE
ST SAVIOUR
JERSEY
JE2 7QN

Re: 2544 / 3 - SO14780 DAVID KING

18 July 2023

Dear Customer,

THIS IS AN ESTIMATE ONLY. SHOULD YOU WISH TO PLACE AN ORDER KINDLY SEND A DETAILED WORKSHEET WHERE POSSIBLE USING THE PREMIER CHOICE ORDER FORM TO orders@premierchoice.co.uk

We thank you for your enquiry and we have the pleasure in estimating you as follows:

DINING ROOM PAIR 1

1 Pair of Curtains Double Pinch Pleat, Hand Finished Interlined

Rail size of 340cm, Drop of 212cm, Overall rail size: 340cm, 3.5 Widths in each

Making:	8	Widths	@	£60.99	=	£487.92
Fabric: 67cm pattern repeat	18.8	mts	@	£0.00	=	£0.00
Lining: Standard Lining	17	mts	@	£2.45	=	£41.65
Interlining: Interlining Synthetic	17	mts	@	£2.70	=	£45.90
Cut Out to Item						£16.79

£ 592.26

DINING ROOM PAIR 2

1 Pair of Curtains Double Pinch Pleat, Hand Finished Interlined

Rail size of 250cm, Drop of 132cm, Overall rail size: 250cm, 2.5 Widths in each

Making:	6	Widths	@	£60.99	=	£365.94
Fabric: 67cm pattern repeat	10.1	mts	@	£0.00	=	£0.00
Lining: Standard Lining	8.1	mts	@	£2.45	=	£19.85
Interlining: Interlining Synthetic	8.1	mts	@	£2.70	=	£21.87

£ 407.66

LIVING ROOM PAIR 1

1 Pair of Curtains Double Pinch Pleat, Hand Finished Interlined

Rail size of 140cm, Drop of 130cm, Overall rail size: 140cm, 1.5 Widths in each

Making:	4	Widths	@	£60.99	=	£243.96
Fabric: 80cm pattern repeat	4.8	mts	@	£0.00	=	£0.00
Lining: Standard Lining	4.8	mts	@	£2.45	=	£11.76
Interlining: Interlining Synthetic	4.8	mts	@	£2.70	=	£12.96

£ 268.68

£672

LIVING ROOM PAIR 2

1 Pair of Curtains Double Pinch Pleat, Hand Finished Interlined

Rail size of 260cm, Drop of 211.5cm, Overall rail size: 260cm, 2.5 Widths in each

Making:	6	Widths	@	£60.99	=	£365.94
Fabric: 80cm pattern repeat	16	mts	@	£0.00	=	£0.00
Lining: Standard Lining	12.1	mts	@	£2.45	=	£29.65
Interlining: Interlining Synthetic	12.1	mts	@	£2.70	=	£32.67
						<hr/>
				£		428.26

29

LIVING ROOM PAIR 3

1 Pair of Curtains Double Pinch Pleat, Hand Finished Interlined

Rail size of 140cm, Drop of 130cm, Overall rail size: 140cm, 1.5 Widths in each

Making:	4	Widths	@	£60.99	=	£243.96
Fabric: 80cm pattern repeat	4.8	mts	@	£0.00	=	£0.00
Lining: Standard Lining	4.8	mts	@	£2.45	=	£11.76
Interlining: Interlining Synthetic	4.8	mts	@	£2.70	=	£12.96
						<hr/>
				£		268.68

£1071

19

260cm

£672

Others Subtotal: £ 1,965.54

Net: £ 1,965.54

VAT@ 20% : £ 393.11

Total: £ 2,358.65

Any additional work, not mentioned in the above estimate, will be invoiced for.

THIS IS AN ESTIMATE ONLY.

SHOULD YOU WISH TO PLACE AN ORDER KINDLY SEND A DETAILED WORKSHEET WHERE POSSIBLE USING THE PREMIERCHOICE ORDER FORM.

ALL EMAILED ORDERS PLEASE EMAIL TO ORDERS@PREMIERCHOICE.CO.UK
PLEASE QUOTE ESTIMATE NUMBER SUPPLIED.

Lead Times are subject to availability.

Assuring you of our best attention at all times.

E. & O.E

Yours Faithfully
SallyWaddilove
Premierchoice Ltd

THE ROMO GROUP

Romo Ltd.
Oddicroft Lane
Sutton-in-Ashfield
Nottingham NG17 5FB

EORI No. GB116619866000
VAT Reg No. 116619866
Tel No. 00 44 1623 727016

ORDER CONFIRMATION

Invoice Address

CARPET PROTECTION (CI) LIMITED
T/A CP INTERIORS
RUE DES PRES TRADING ESTATE
ST SAVIOUR
JERSEY
JE2 7QN

Delivery Address

PREMIER CHOICE
3-5 ALGOES WAY
WEASENHAM LANE
WISBECH CAMBS
PE13 2TQ

PAGE 1

Account	Invoice Date	Order No.	Carrier	Parcels	Your Order No.	Currency
57744	26/07/23	EX124425	UPS UK Standard		SO14780 KING	STERLING

Quantity	Description	Price	%	Value
26.0	<p>METRES RF 7792/01 MIKADO SILVER BIRCH Commodity Code: 5212251099 63% Cotton 37% Linen In One Length</p> <p>We note these goods are being sent to an address that differs from the accounting address. It is particularly important you check visually that the goods physically correspond with the sample from which the order was placed. i.e. correct design, colour, shade etc.</p> <p>All supplies are made subject to the Romo Terms and Conditions of Sale (as amended), copies of which are available on request in our Trade Price List or on the trade section of our website at www.romo.com.</p>	29.25		760.50

THIS IS AN ORDER CONFIRMATION
PLEASE DO NOT PAY. A VAT INVOICE WILL FOLLOW.

VAT Summary		
Code	Goods	VAT
S 20.00%		152.10

Goods	760.50
VAT	152.10
Total	912.60

Tamara Lopez-Dominguez

From: Kirstie Lundgaard <Kirstie.Lundgaard@jab-uk.co.uk>
Sent: 26 July 2023 12:51
To: Home
Subject: RE: SO14780 King - A/C no: 953051 / Reservation no: 21264740 / Order no: 36511121

Hi Tamara,

Sure – I can confirm that your order has been placed and will be delivered in approx. 5-7 working days.

Speak soon,
Kirstie

From: Home <home@cpinteriors.je>
Sent: 26 July 2023 09:11
To: Kirstie Lundgaard <Kirstie.Lundgaard@jab-uk.co.uk>
Subject: RE: SO14780 King - A/C no: 953051 / Reservation no: 21264740

Good morning Kirstie,

Could we please order the **29m of Cocoon 7063/070** to be sent to the following address:

**Premier Choice
3-5 Algores Way
Wisbech
PE132TQ**

Please include our reference in your order confirmation and invoice. Many thanks.

Kind Regards

Tamara
Lopez-Dominguez

Interior Design Advisor
tamara@cpinteriors.je



Unit 28 Rue Des Pres Trading Estate
St Saviour
Jersey
JE2 7QN
01534 768141 | www.cpinteriors.je
 

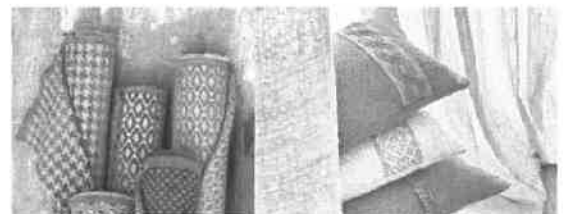

With our CP Price promise, we will beat any
** On like for like products only

From: Kirstie Lundgaard <Kirstie.Lundgaard@jab-uk.co.uk>
Sent: Tuesday, July 18, 2023 2:14 PM

Tamara Lopez-Dominguez

From: David & Nicola King <brookhall_shop@yahoo.co.uk>
Sent: 19 July 2023 11:29
To: Home
Subject: Re: CP Interiors - SO14780

116 rings in total

Follow Up Flag: Follow up
Flag Status: Flagged

Hello Tamara,
Thank you for your email.

Curtain rings as follows:

Lounge small windows (x2): 7 rings each curtain. Total 14 per window.
Lounge sliding door: 13 rings each curtain. Total 26.

Dining room window: 12 rings each curtain. Total 24.
Dining room door: 17 each side. Total 34.

I also have 4 spare rings if it is advisable to increase the number for any curtain.

Hope this makes sense,
Regards,
David.

* * * * *

*David & Nicola King
14 Brookhall | St Saviour | Jersey | JE2 7QL
Tel #: +44 (0)1534 727032
E-mail: brookhall_shop@yahoo.co.uk
This e-mail address, and any recipient's e-mail address,
is to be used regarding this communication only,
and must not be used for any other purpose (including marketing).*

On 19/07/2023 10:10, Home wrote:

Dear David and Nicola,

I hope you are well.

I have prepared the final quote, as requested, but before I send it, could you please confirm how many rings you have per pair of curtains? The reason for this, is that the curtain makers allow one double pleat per ring, and we want to make sure you will have enough rings, or that they will make enough pleats for your rings. They can always adjust the space between pleats.

As soon as I have this information, I will check with them and will send the quote through. Many thanks.

Kind Regards

S014780 KING

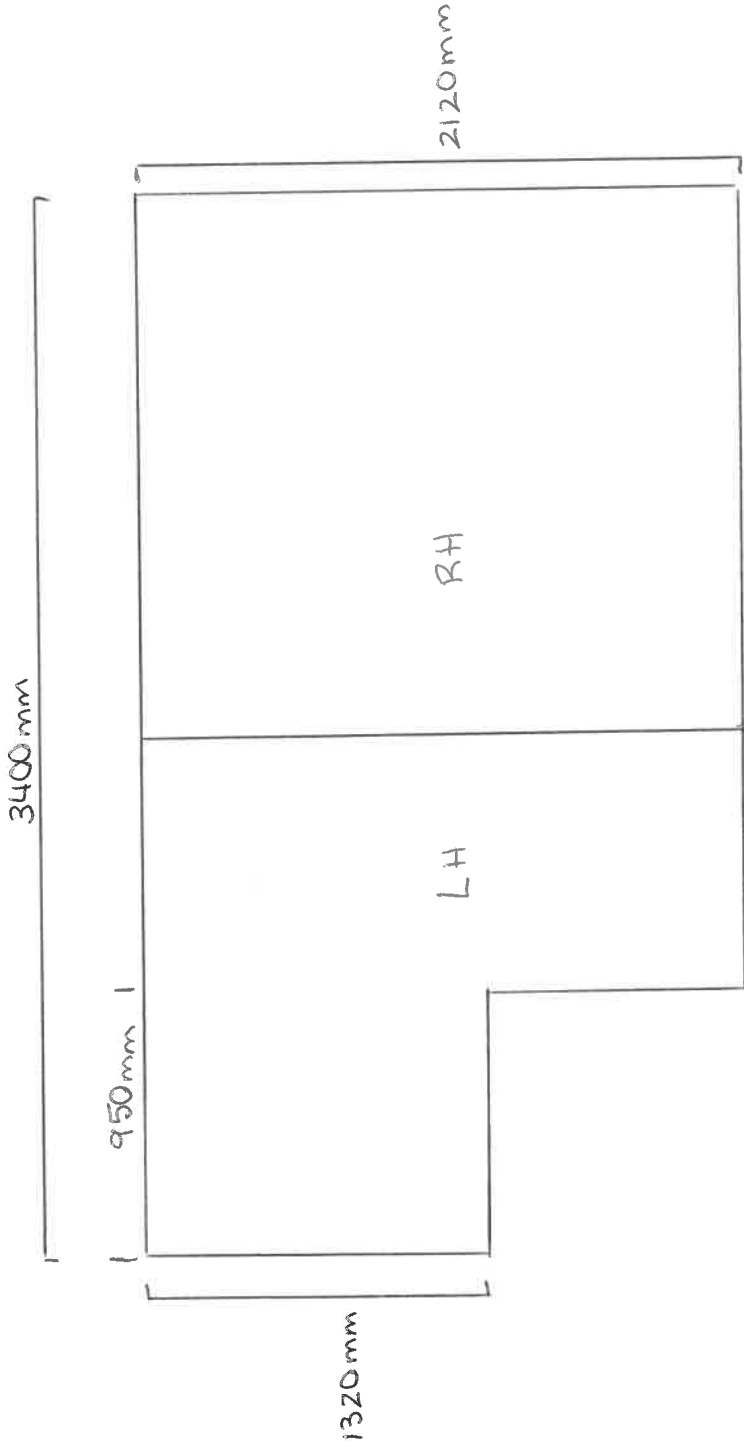

DINING ROOM DOORS PAIR

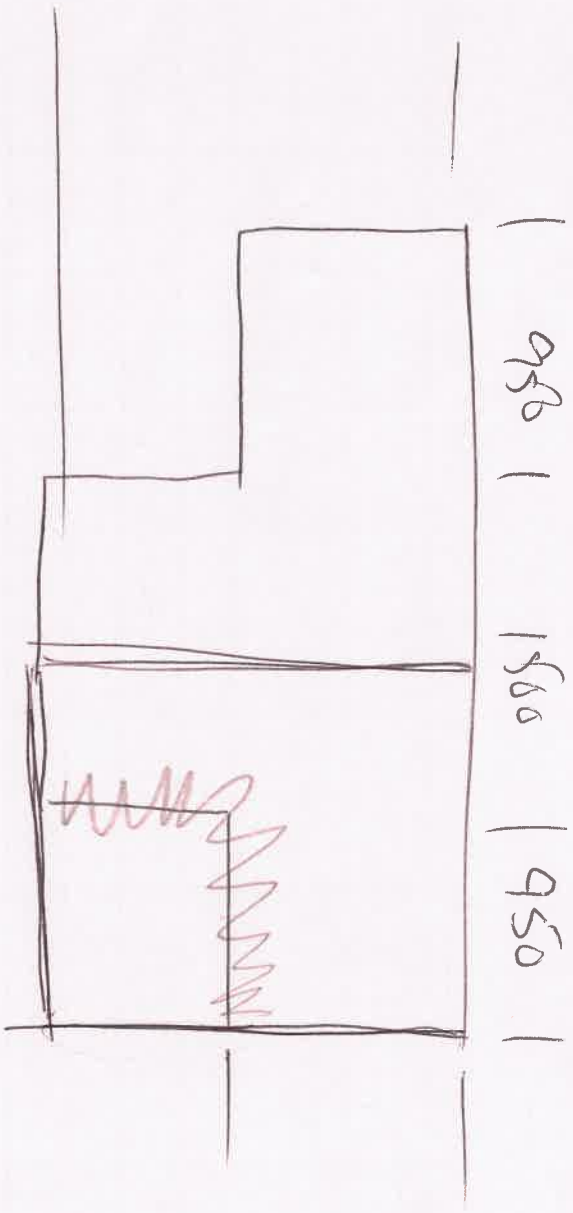

PREMIERCHOICE

MANUFACTURERS OF QUALITY CUSTOM MADE CURTAINS, PELMETS AND BLINDS

CP INTERIORS JERSEY
 CP INTERIORS
 RUE DES PRES TRADING ESTATE
 ST SAVIOUR
 JERSEY
 JE2 7QN

Re: 2544 / 2 - SO14780 DAVID KING

Dear Customer,

THIS IS AN ESTIMATE ONLY. SHOULD YOU WISH TO PLACE AN ORDER KINDLY SEND A DETAILED WORKSHEET WHERE POSSIBLE USING THE PREMIER CHOICE ORDER FORM TO orders@premierchoice.co.uk

We thank you for your enquiry and we have the pleasure in estimating you as follows:

DINING ROOM PAIR 1

1 Pair of Curtains Double Pinch Pleat, Hand Finished Interlined £ 656.76

Rail size of 340cm, Drop of 212cm, Overall rail size: 340cm, 3.5 Widths in each

Making:	8	Widths	
Fabric: 67cm pattern repeat	18.8	mts	£1642
Lining: Standard Lining	17	mts	
Interlining: Interlining Synthetic	17	mts	

Cut Out to Item

Border to Leading Edge (Leading Edge)

Fabric: 00cm pattern repeat ,137.00cm

2.5 mts for both pairs

↪ 40cm wide for each

DINING ROOM PAIR 2

1 Pair of Curtains Double Pinch Pleat, Hand Finished Interlined £ 448.16

Rail size of 250cm, Drop of 132cm, Overall rail size: 250cm, 2.5 Widths in each

Making:	6	Widths	
Fabric: 67cm pattern repeat	10.1	mts	£1120
Lining: Standard Lining	8.1	mts	
Interlining: Interlining Synthetic	8.1	mts	

Border to Leading Edge (Leading Edge)

Fabric: 00cm pattern repeat ,137.00cm

1.7 mts

LIVING ROOM PAIR 1

1 Pair of Curtains Double Pinch Pleat, Hand Finished Interlined £ 346.68

Rail size of 140cm, Drop of 130cm, Overall rail size: 140cm, 1.5 Widths in each

Making:	4	Widths	
Fabric: 80cm pattern repeat	4.8	mts	£807
Lining: Standard Lining	4.8	mts	
Interlining: Interlining Synthetic	4.8	mts	

Border to Leading/Return Edge (Trailing Edge, Leading Edge)

Fabric: 00cm pattern repeat ,137.00cm

1.6 mts

20cm

Fabric for Dining: Jab Cocoon @ £54.90 p/m
 Border for Dining: Warwick Splash Papyrus @ £30 p/m

Fabric for Living Room: Romo Mikado Silver Bird 7792.01 @ £58.50p

Border for LR: Villa Nova Lucerne Hydro 14 July 2023
 V3244/04 @ £36 p/m

LIVING ROOM PAIR 2

1 Pair of Curtains Double Pinch Pleat, Hand Finished Interlined

£ 555.76

Rail size of 260cm, Drop of 211.5cm, Overall rail size: 260cm, 2.5 Widths in each

Making:	6	Widths	
Fabric: 80cm pattern repeat	16	mts	£1389
Lining: Standard Lining	12.1	mts	
Interlining: Interlining Synthetic	12.1	mts	
Border to Leading/Return Edge (Trailing Edge, Leading Edge)			
Fabric: 00cm pattern repeat ,137.00cm	2.5	mts	

LIVING ROOM PAIR 3

1 Pair of Curtains Double Pinch Pleat, Hand Finished Interlined

£ 346.68

Rail size of 140cm, Drop of 130cm, Overall rail size: 140cm, 1.5 Widths in each

Making:	4	Widths	
Fabric: 80cm pattern repeat	4.8	mts	£267
Lining: Standard Lining	4.8	mts	
Interlining: Interlining Synthetic	4.8	mts	
Border to Leading/Return Edge (Trailing Edge, Leading Edge)			
Fabric: 00cm pattern repeat ,137.00cm	1.6	mts	

Others Subtotal: £ 2,354.04

Total: £ 2,354.04

Any additional work, not mentioned in the above estimate, will be invoiced for.

THIS IS AN ESTIMATE ONLY.

SHOULD YOU WISH TO PLACE AN ORDER KINDLY SEND A DETAILED WORKSHEET WHERE POSSIBLE USING THE PREMIERCHOICE ORDER FORM.

ALL EMAILED ORDERS PLEASE EMAIL TO ORDERS@PREMIERCHOICE.CO.UK
PLEASE QUOTE ESTIMATE NUMBER SUPPLIED.

Lead Times are subject to availability.

Assuring you of our best attention at all times.

E. & O.E

Yours Faithfully
SallyWaddilove
Premierchoice Ltd



CP INTERIORS

July 11, 2023

REF : SO14780

Mr & Mrs. David King
14 Brookhall
La Rue des Pres
St Saviour
JE2 7QL

Dear Mr & Mrs. David King

As requested, we have pleasure in submitting our quotation for the following.

Description	QTY	Price
Dining Room W1, To Supply and Fit ,Curtain, Hand finished pair of curtains, with a double pleat header, cut out on both sides and a 70mm leading and trailing edge, synthetic interlining and standard lining.	1	£ 1,841.00
Dining Room W2, To Supply and Fit ,Curtain, Hand finished pair of curtains, with a double pleat header, a 70mm leading and trailing edge, synthetic interlining and standard lining.	1	£ 1,218.00
Living Room W1, To Supply and Fit ,Curtain, Hand finished pair of curtains, with a double pleat header, a 70mm leading and trailing edge, synthetic interlining and standard lining.	1	£ 867.00
Living Room Door, To Supply and Fit ,Curtain, Hand finished pair of curtains, with a double pleat header, a 70mm leading and trailing edge, synthetic interlining and standard lining.	1	£ 1,389.00
Living Room W2, To Supply and Fit ,Curtain, Hand finished pair of curtains, with a double pleat header, a 70mm leading and trailing edge, synthetic interlining and standard lining.	1	£ 867.00
Curtains fabric, Fabric, 56m of a fabric of your choice. Price guide and amount of fabric based on JAB Cocoon @£54.90 per metre.	1	£ 3,074.40
Should a different be chosen, these amounts will have to be reviewed.,		
Curtain leading and trailing borders fabric, Fabric, 4.5m of a plain single width fabric of your choice. Price guide based on Villa Nova Lucerne @£36 per metre,	1	£ 162.00
Curtains to be hung on existing poles and rings.		
Subtotal :		£ 9,418.40
GST :		£ 470.92
Total :		£ 9,889.32

As with all our custom orders, we will require a deposit of 50%. All prices are subject to GST.

Thank you for your enquiry and we hope you will find this quotation acceptable. Should you require any further information, please contact us.

Yours sincerely
Tamara

To accept the above quotation, please indicate which option is required, sign below and return this letter together with your deposit. Please note extract of our terms and conditions below.

.....
SIGNATURE

.....
DATE

Tel : (01534) 768141

www.cpinteriors.je

Rue des Pres Trading Estate, St Saviour, Jersey, JE2 7QN

Blinds | Curtains | Awnings | Shutters | Furnishings | Interior Design | Project Management

Please note: This quotation is only valid for acceptance for 14 days. Our estimate does not include any electrical work or additional carpentry work to install the above unless otherwise specified. Please note there is a handling charge on customer own fabric of £5 per metre. Due to high costs of labour, pre-arranged missed fitting appointments will be charged on a time-wasted basis. Settlement is due on completion of works and an administration charge of £25 will be added per month if unpaid within 30 days. We reserve the right to charge for design, advice and liaison work carried out should an order not be placed. Goods remain the property of CP Interiors until full settlement is received. Should payment not be received we reserve the right to attend premises during working hours to remove goods and not be required to make good. Our full terms and conditions apply and are available on request.

As we no longer accept cheques, please do:

- Call us and pay by Card, we accept card transactions over the telephone and we will not charge you a handling fee.
- Bank details: Natwest, Sort Code 60-12-03, Account No 66577772 Carpet Protection (C.I) Ltd T/A CP Interiors

If you pay your deposit by BACS payment, please confirm the details of your order by returning a signed copy of this letter

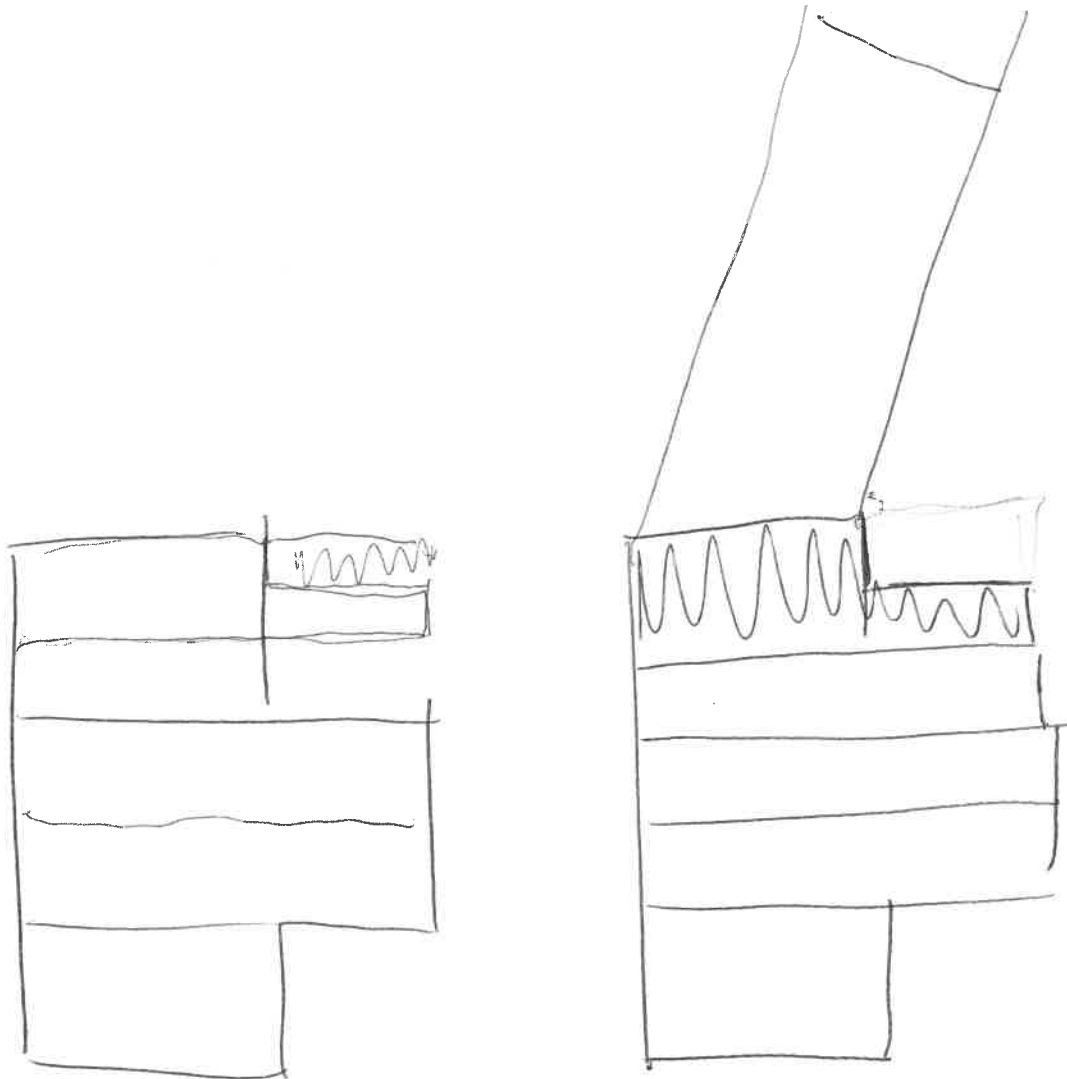

Tel : (01534) 768141

www.cpinteriors.ie

Rue des Pres Trading Estate, St Saviour, Jersey, JE2 7QN

PREMIERCHOICE

MANUFACTURERS OF QUALITY CUSTOM MADE CURTAINS, PELMETS AND BLINDS

CP INTERIORS JERSEY
 CP INTERIORS
 RUE DES PRES TRADING ESTATE
 ST SAVIOUR
 JERSEY
 JE2 7QN

11 July 2023

Re: 2544 / 1 - SO14780 DAVID KING

Dear Customer,

THIS IS AN ESTIMATE ONLY. SHOULD YOU WISH TO PLACE AN ORDER KINDLY SEND A DETAILED WORKSHEET WHERE POSSIBLE USING THE PREMIER CHOICE ORDER FORM TO orders@premierchoice.co.uk

We thank you for your enquiry and we have the pleasure in estimating you as follows:

DINING ROOM PAIR 1

1 Pair of Curtains Double Pinch Pleat, Hand Finished Interlined £ 736.55

Rail size of 340cm, Drop of 212cm, Overall rail size: 340cm, 3.5 Widths in each

Making:	8	Widths	
Fabric: 67cm pattern repeat	18.8	mts	
Lining: Standard Lining	17	mts	
Interlining: Interlining Synthetic	17	mts	

Cut Out to Item

Border to Leading/Return Edge (Trailing Edge, Leading Edge)

Fabric: 00cm pattern repeat ,137.00cm

(2.5) mts

→ 20cm wide per curtain

£1841

DINING ROOM PAIR 2

1 Pair of Curtains Double Pinch Pleat, Hand Finished Interlined £ 487.16

Rail size of 250cm, Drop of 132cm, Overall rail size: 250cm, 2.5 Widths in each

Making:	6	Widths	
Fabric: 67cm pattern repeat	10.1	mts	
Lining: Standard Lining	8.1	mts	
Interlining: Interlining Synthetic	8.1	mts	

Border to Leading/Return Edge (Trailing Edge, Leading Edge)

Fabric: 00cm pattern repeat ,137.00cm

DR
 ↳ Pair 1, LV P1, DR P2

£1218

LIVING ROOM PAIR 1

1 Pair of Curtains Double Pinch Pleat, Hand Finished Interlined £ 346.68

Rail size of 140cm, Drop of 130cm, Overall rail size: 140cm, 1.5 Widths in each

Making:	4	Widths	
Fabric: 67cm pattern repeat	6.1	mts	
Lining: Standard Lining	4.8	mts	
Interlining: Interlining Synthetic	4.8	mts	

Border to Leading/Return Edge (Trailing Edge, Leading Edge)

Fabric: 00cm pattern repeat ,137.00cm

1.6 mts

£867

2m LV P1, LV P3

LIVING ROOM PAIR 2

1 Pair of Curtains Double Pinch Pleat, Hand Finished Interlined £ 555.76

Rail size of 260cm, Drop of 211.5cm, Overall rail size: 260cm, 2.5 Widths in each

Making:	6	Widths	
Fabric: 67cm pattern repeat	13.4	mts	£1389
Lining: Standard Lining	12.1	mts	
Interlining: Interlining Synthetic	12.1	mts	
Border to Leading/Return Edge (Trailing Edge, Leading Edge)			
Fabric: 00cm pattern repeat ,137.00cm	2.5	mts	

LIVING ROOM PAIR 3

1 Pair of Curtains Double Pinch Pleat, Hand Finished Interlined £ 346.68

Rail size of 140cm, Drop of 130cm, Overall rail size: 140cm, 1.5 Widths in each

Making:	4	Widths	
Fabric: 67cm pattern repeat	6.1	mts	£867
Lining: Standard Lining	4.8	mts	
Interlining: Interlining Synthetic	4.8	mts	
Border to Leading/Return Edge (Trailing Edge, Leading Edge)			
Fabric: 00cm pattern repeat ,137.00cm	1.6	mts	

Others Subtotal: £ 2,472.83

Total: £ 2,472.83

Any additional work, not mentioned in the above estimate, will be invoiced for.

THIS IS AN ESTIMATE ONLY.

SHOULD YOU WISH TO PLACE AN ORDER KINDLY SEND A DETAILED WORKSHEET WHERE POSSIBLE USING THE PREMIERCHOICE ORDER FORM.

ALL EMAILED ORDERS PLEASE EMAIL TO ORDERS@PREMIERCHOICE.CO.UK
PLEASE QUOTE ESTIMATE NUMBER SUPPLIED.

Lead Times are subject to availability.

Assuring you of our best attention at all times.

E. & O.E

Yours Faithfully
SallyWaddilove
Premierchoice Ltd

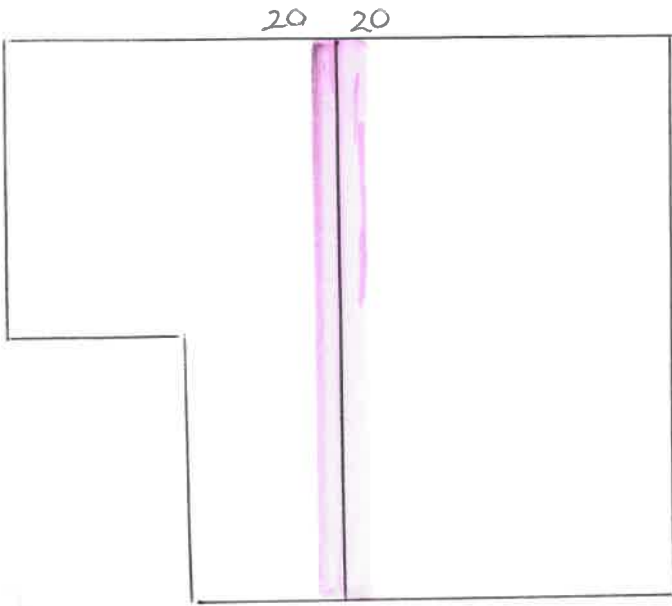

dining Room pair 1

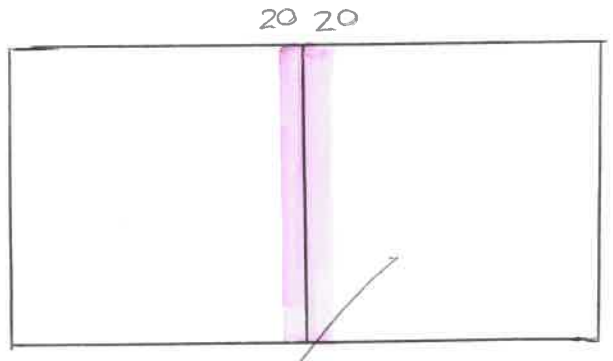

80 cm x 2.5 m for both
Warwick Splash Papyrus

dining room pair 2

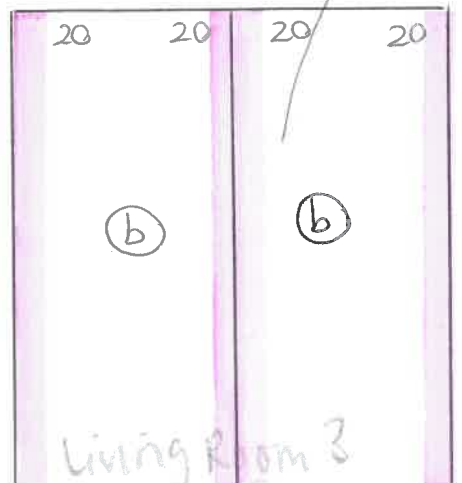
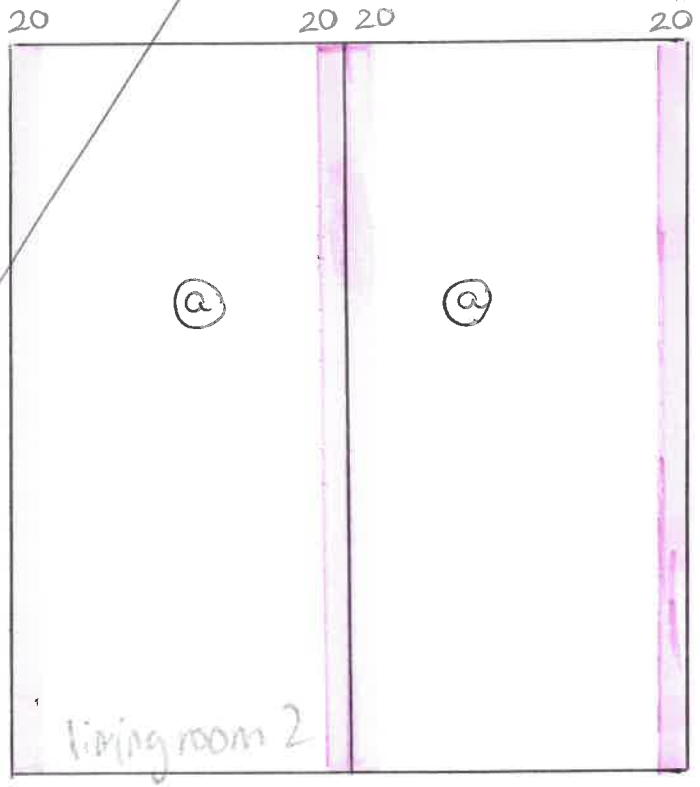
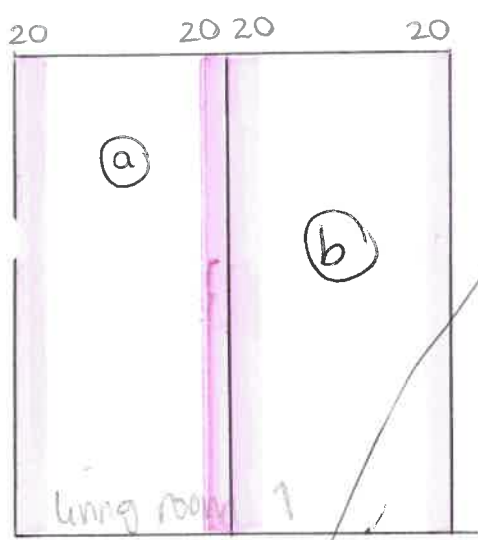

- a) 120 cm x 2.5m
- b) 80 cm x 1.6m

Villa Nova Lucerne Hydro

CP INTERIORS

July 14, 2023

REF : SO14780

Mr & Mrs. David King
 14 Brookhall
 La Rue des Pres
 St Saviour
 JE2 7QL

No borders →

Dear Mr & Mrs. David King

As requested, we have pleasure in submitting our quotation for the following.

*LARGE and
 with track
 as well, no
 contrast*

Description	QTY	Price
Dining Room W1, To Supply and Fit ,Curtain, Hand finished pair of curtains, with a double pleat header, cut out on left side and a 70mm leading edge, synthetic interlining and standard lining.	1	£ 1,642.00
Dining Room W2, To Supply and Fit ,Curtain, Hand finished pair of curtains, with a double pleat header, a 70mm leading edge, synthetic interlining and standard lining.	1	£ 1,120.00
Dining Room Main Fabric, Fabric, 29.5m of JAB Cocoon @£54.90 per metre., <i>White leaves and beige background</i>	1	£ 1,619.55
Dining Room Border Fabric, Fabric 2.5m of Waverick Spiced Papyrus @£30 per metre	1	£ 75.00
Living Room W1, To Supply and Fit ,Curtain, Hand finished pair of curtains, with a double pleat header, a 70mm leading and trailing edge, synthetic interlining and standard lining.	1	£ 867.00
Living Room Door, To Supply and Fit ,Curtain, Hand finished pair of curtains, with a double pleat header, a 70mm leading and trailing edge, synthetic interlining and standard lining.	1	£ 1,389.00
Living Room W2, To Supply and Fit ,Curtain, Hand finished pair of curtains, with a double pleat header, a 70mm leading and trailing edge, synthetic interlining and standard lining.	1	£ 867.00
Living Room Main Fabric, Fabric, 26m of Romo Mikado Silver Birch 7792/01 @£58.50 per metre,	1	£ 1,521.00
Living Room Border Fabric, Fabric 4.5m of Villa Nova Lucerne Hydro @£36 per metre,	1	£ 162.00

*All with
 leading and
 trailing
 edge*

Curtains to be hung on existing poles and rings.

*- check how many rings
 to tell premier how
 many pleats*

Subtotal : £ 9,262.55

GST : £ 463.13

Total : £ 9,725.68

As with all our custom orders, we will require a deposit of 50%. All prices are subject to GST. Thank you for your enquiry and we hope you will find this quotation acceptable. Should you require any further information, please contact us.

Yours sincerely
 Tamara

To accept the above quotation, please indicate which option is required, sign below and return this letter together with your deposit. Please note extract of our terms and conditions below.

.....
 SIGNATURE *Tamara*

.....
 DATE

Tel : (01534) 768141

www.cpinteriors.ie

Rue des Pres Trading Estate, St Saviour, Jersey, JE2 7QN

Blinds | Curtains | Awnings | Shutters | Furnishings | Interior Design | Project Management

Please note: This quotation is only valid for acceptance for 14 days. Our estimate does not include any electrical work or additional carpentry work to install the above unless otherwise specified. Please note there is a handling charge on customer own fabric of £5 per metre. Due to high costs of labour, pre-arranged missed fitting appointments will be charged on a time-wasted basis. Settlement is due on completion of works and an administration charge of £25 will be added per month if unpaid within 30 days. We reserve the right to charge for design, advice and liaison work carried out should an order not be placed. Goods remain the property of CP Interiors until full settlement is received. Should payment not be received we reserve the right to attend premises during working hours to remove goods and not be required to make good. Our full terms and conditions apply and are available on request.

As we no longer accept cheques, please do:

- Call us and pay by Card, we accept card transactions over the telephone and we will not charge you a handling fee.
- Bank details: Natwest, Sort Code 60-12-03, Account No 66577772 Carpet Protection (C.I) Ltd T/A CP Interiors

If you pay your deposit by BACS payment, please confirm the details of your order by returning a signed copy of this letter

Tel : (01534) 768141

www.cpinteriors.je

Rue des Pres Trading Estate, St Saviour, Jersey, JE2 7QN

Blinds | Curtains | Awnings | Shutters | Furnishings | Interior Design | Project Management