

5 MW x 5.5

27 sq metres

~~5 MW~~

underlay

gripes

TL - 8ft 10inch
x
4ft 5inch ↓

Steps - 2ft 8inch
x
#18inch ↓

BL - 2ft 10inch
x
3ft 7inch ↓

step - 3ft 2inch
x
1ft 6inch ↓

51 =

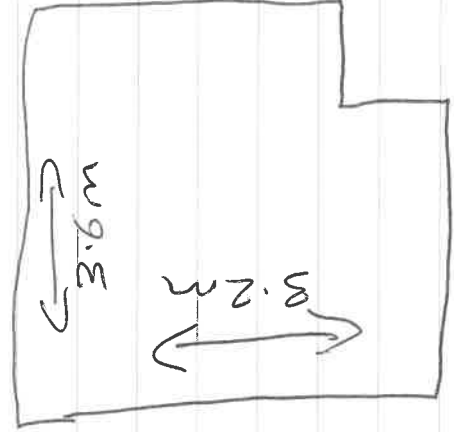
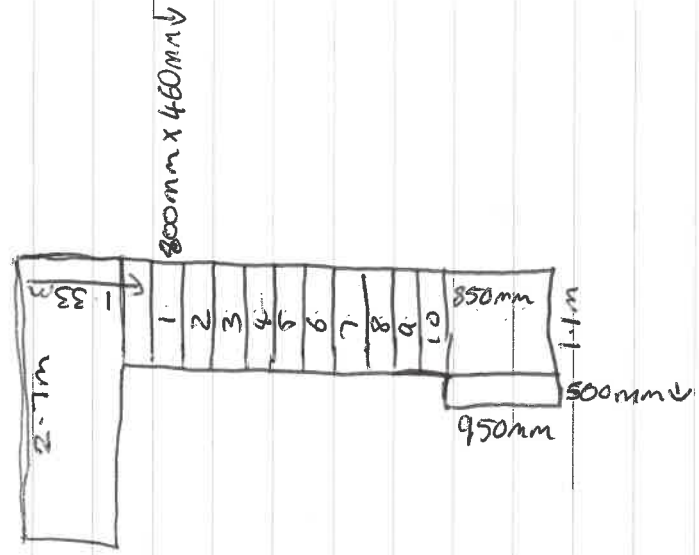

Ben Becker

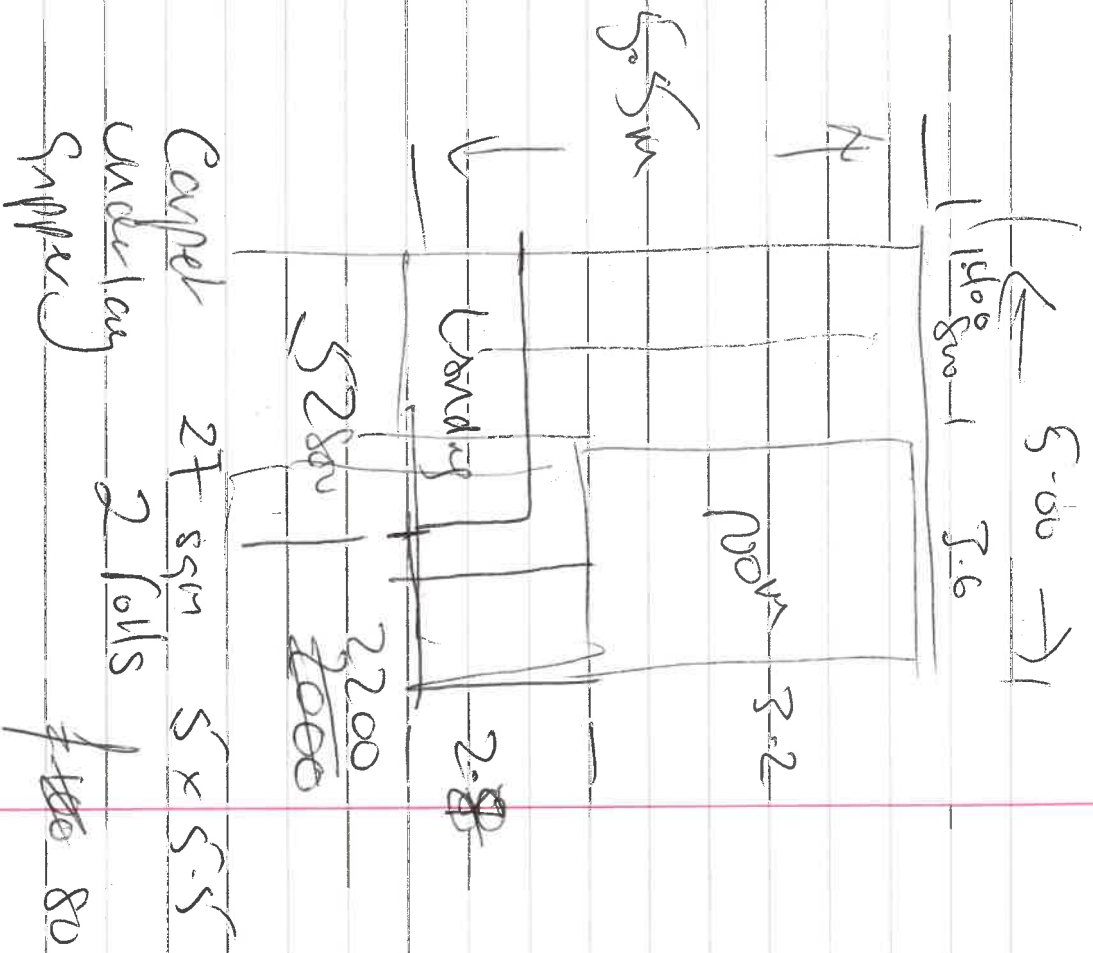

Prime Ultra (copper) Bamboo.