

STOWER SO14133

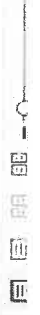

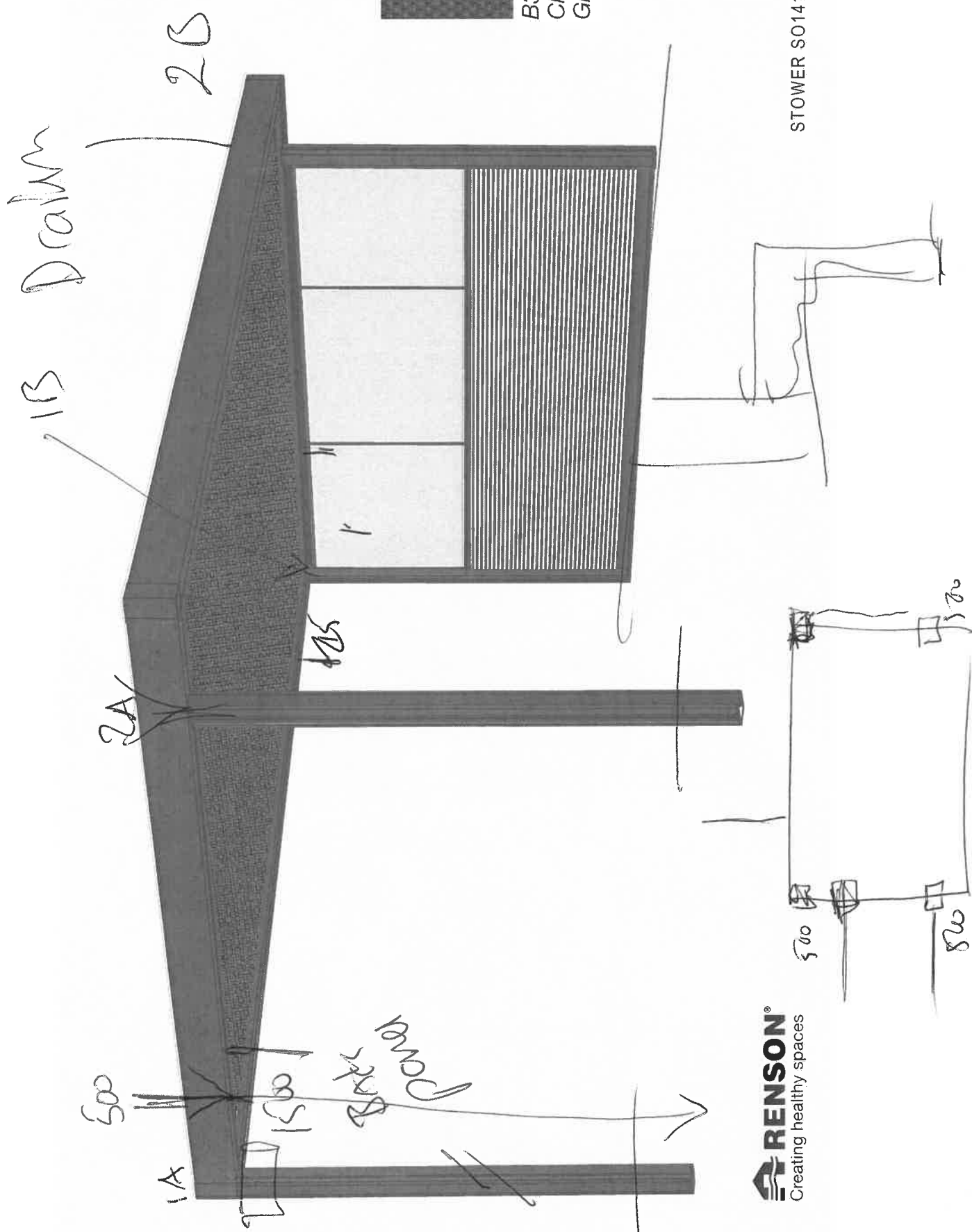

ALGARVE
CANVAS

RAL 7016

B3-3001
Charcoal
Grey



CP INTERIORS

January 24, 2023

REF : SO14133

Mrs. Nicole Stower
The Willows
10 Haut Mont Estate
St Helier
JE2 4RG

Dear Mrs. Nicole Stower

As requested, we have pleasure in submitting our quotation for the following.

Description	QTY	Price
Front of House, To Supply and Fit ,Bladed Roof Systems, Renson Algarve Canvas Carport. Frame (RAL) and canvas colours to be confirmed. Reinforced mounting bases. 3 posts with one corner on span side attached to house <i>6m span x 5.5m pivot x 2.6m full height.</i>	1	£ 24,561.00
.. OPTIONAL,		
To Supply, Linus wall half height railing with horizontal louvres across full pivot side (P2) in same colour as framework and columns,	1	£ 7,143.00
To Supply, <u>Additional column</u> as Linus wall is required across span or pivot sides as needs to be fixed to a post.	1	£ 689.00
To Supply, Glass top in 3 panels, toughened 8mm glass fixed to top of linus wall including flashing and gap seals. Channels powder coated in RAL colour to match main frame,	1	£ 2,834.00
To Supply, Warm white LED up Lighting to left side of roof part 1 and right side of roof part 2,	1	£ 2,672.00
Subtotal :		£ 37,899.00
	GST :	£ 1,894.95
	Total :	£ 39,793.95

Please note these structure are designed as garden rooms and as such may not be completely water tight. As with all our custom orders, we require a deposit of 40% at the time of placing your order, 40% on delivery to the Island and 20% balance on completion. All prices are subject to GST.

Our Price Promise to you, we will beat any written quotation by 5% (on equivalent specification).

Thank you for your enquiry and we hope you will find this quotation acceptable. Should you require any further information, please contact us.

Yours sincerely
Rachel

To accept the above quotation, please indicate which option is required, sign below and return this letter together with your deposit. Please note extract of our terms and conditions below.

.....
SIGNATURE **DATE**

Please note: This quotation is only valid for acceptance for 7 days. Our estimate does not include any electrical work or additional carpentry work to install the above unless otherwise specified. Please note there is a handling charge on customer own fabric of £5 per metre. Due to high costs of labour, pre-arranged missed fitting appointments will be charged on a time-wasted basis. Settlement is due on completion of works and an administration charge of £25 will be added per month if unpaid within 30 days. We reserve the right to charge for design, advice and liaison work carried out should an order not be placed. Goods remain the property of CP Interiors until full settlement is received. Should payment not be received we reserve the right to attend premises during working hours to remove goods and not be required to make good. Our full terms and conditions apply and are available on request.

As we no longer accept cheques, please do:

- Call us and pay by Card, we accept card transactions over the telephone and we will not charge you a handling fee.
- Bank details: Natwest, Sort Code 60-12-03, Account No 66577772 Carpet Protection (C.I) Ltd T/A CP Interiors

Tel : (01534) 768141

www.cpinteriors.ie

Rue des Pres Trading Estate, St Saviour, Jersey, JE2 7QN

in the order drawings integrate as much as possible any remarks and/or attachments. Remarks or attachments that can not be integrated in the order drawing will be considered when your order goes in production.

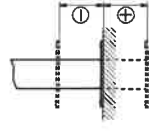
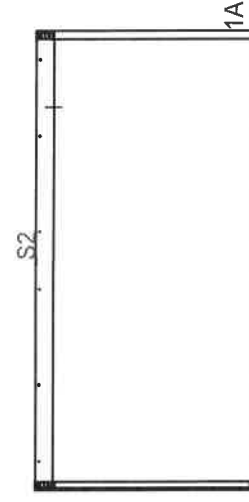
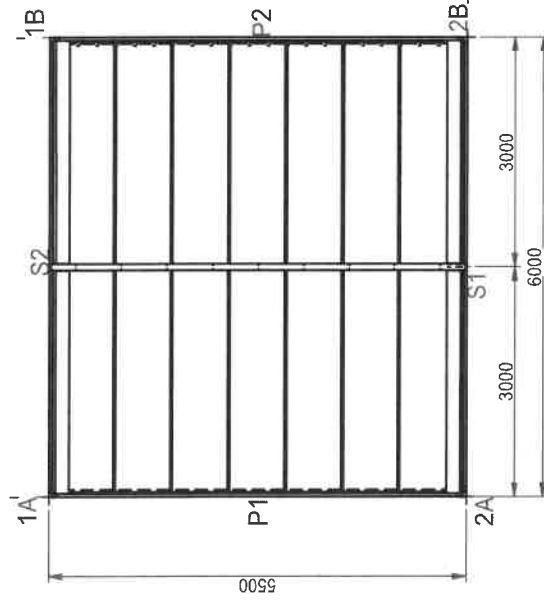
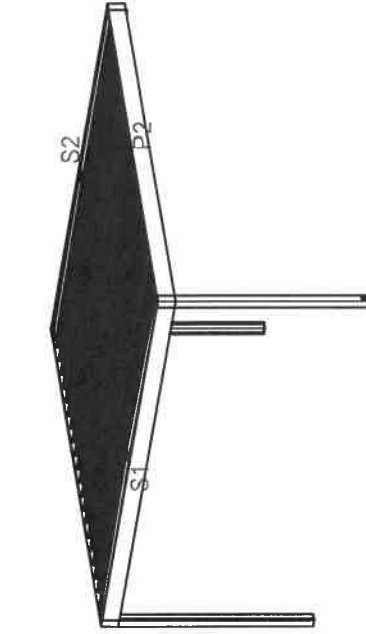
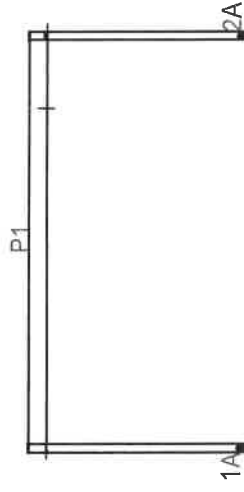
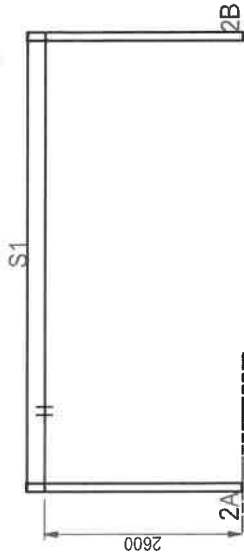
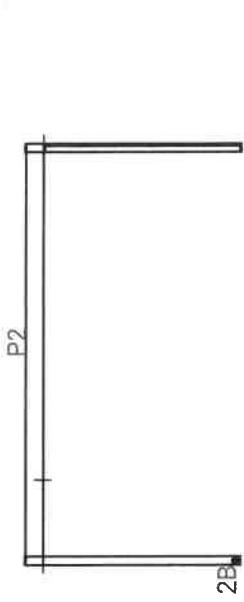

- 1A = 0
- 2A = 0
- 1B = 0
- 2B = 0
- P1 = 0
- P2 = 0
- S1 = 0
- S2 = 0

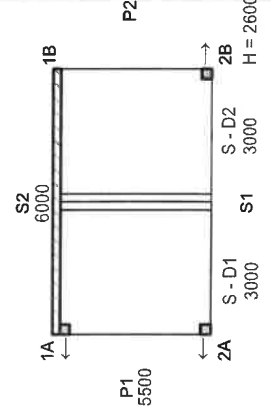
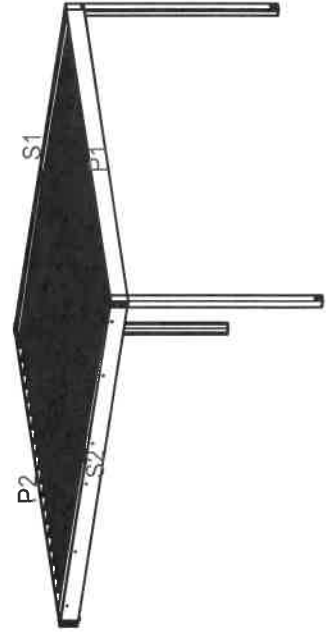

RENSON®
 Creating healthy spaces
 www.renson.eu - 8790 Waregem (Belgium)
 This drawing is owned by RENSON and may not be copied or shown to third parties without written permission.

Client Reference :	Sheet : 1 / 1
Orderline ref. : 20058314001000.126579	Scale : 1 : 1
Client :	Drawn : autoh0c10
Creation date : 17/01/2023 - 12:45:06	Size : A3
Color :	units in mm

+ £1000 for channels
& flashing.
+ glass.

January 19, 2023

REF : SO14133

Mrs. Nicole Stower
The Willows
10 Haut Mont Estate
St Helier
JE2 4RG

Dear Mrs. Nicole Stower

As requested, we have pleasure in submitting our quotation for the following.

Description	QTY	Price
Front of House, To Supply and Fit ,Bladed Roof Systems, Renson Algarve Canvas Carport. Frame (RAL) and canvas colours to be confirmed. Reinforced mounting bases. 3 posts with one corner on span side attached to house <i>6055 x 5500 mm</i>	1	£ 24,561.00
.. OPTIONAL,		
To Supply, Linus wall half height railing across full span side against house (S2) in same colour as framework and columns,	1	£ 7,668.00
To Supply, Linus wall half height railing across full pivot side (P2) in same colour as framework and columns,	1	£ 7,143.00
To Supply, Additional column if Linus wall is required across span or pivot sides as needs to be fixed to a post.,	1	£ 689.00
To Supply, Warm white LED up Lighting to left side of roof part 1 and right side of roof part 2,	1	£ 2,672.00
Subtotal :		£ 42,733.00
GST :		£ 2,136.65
Total :		£ 44,869.65

Please note these structure are designed as garden rooms and as such may not be completely water tight. As with all our custom orders, we require a deposit of 40% at the time of placing your order, 40% on delivery to the Island and 20% balance on completion. All prices are subject to GST.

Our Price Promise to you, we will beat any written quotation by 5% (on equivalent specification).

Thank you for your enquiry and we hope you will find this quotation acceptable. Should you require any further information, please contact us.

Yours sincerely

Rachel

To accept the above quotation, please indicate which option is required, sign below and return this letter together with your deposit. Please note extract of our terms and conditions below.

.....
SIGNATURE **DATE**

Please note: This quotation is only valid for acceptance for 7 days. Our estimate does not include any electrical work or additional carpentry work to install the above unless otherwise specified. Please note there is a handling charge on customer own fabric of £5 per metre. Due to high costs of labour, pre-arranged missed fitting appointments will be charged on a time-wasted basis. Settlement is due on completion of works and an administration charge of £25 will be added per month if unpaid within 30 days. We reserve the right to charge for design, advice and liaison work carried out should an order not be placed. Goods remain the property of CP Interiors until full settlement is received. Should payment not be received we reserve the right to attend premises during working hours to remove goods and not be required to make good. Our full terms and conditions apply and are available on request.

As we no longer accept cheques, please do:

- Call us and pay by Card, we accept card transactions over the telephone and we will not charge you a handling fee.
- Bank details: Natwest, Sort Code 60-12-03, Account No 66577772 Carpet Protection (C.I) Ltd T/A CP Interiors

Tel : (01534) 768141

www.cpinteriors.je

Rue des Pres Trading Estate, St Saviour, Jersey, JE2 7QN

Quotation

20058314

17.01.2023

Detail

Item	Material	Unit price	Quantity	Gross amount	Discount %	Net amount
001000	ALG3CAN ALGARVE CANVAS		1,00 PC	16.374,00		9.824,40
	Commodity code	94069090				
	Algarve Canvas	7.497,00 GBP /	1 PC x 2,00	14.994,00		
	Algarve Line column	261,00 GBP /	1 PC x 3,00	783,00		
	Algarve Line reinforced mounting base	199,00 GBP /	1 PC x 3,00	597,00		
				16.374,00	40	9.824,40

Configuration

Structure

Type

Central beam	Single with intermediate beam
Roof type: roof part 1	Canvas (fixed roof)
Roof type: roof part 2	Canvas (fixed roof)

Location

Location	Normal wind loads (standard)
Country of installation	United Kingdom

Construction

Dimensions

Span	6.000 mm
Symmetric roof parts	Asymmetry
Position central beam	3.000 mm
Pivot	5.500 mm
Passage height	2.600 mm

Construction method

Span 1	Freestanding
Span 2	Full wall
Pivot 1	Freestanding
Pivot 2	Freestanding

Columns

Column type 1A	Corner column
Column type 2A	Corner column
Column type 2B	Corner column

Comfort

Automation

Voltage motor	230V
Electrical certification	CE (Standard)

Styling

Design

Design	Standard design
--------	-----------------

Colors

Color steel plate	RAL 9002
-------------------	----------

Type of fabrics

Fabric code Canvas	CANVAS FABRIC 3% 3030 CHARCOAL
--------------------	--------------------------------

Technical specs

General

Drainage blade	To side P1 & P2
Wall mounting holes	Yes

Columns

Mounting base 1A	Invisible reinforced
------------------	----------------------

solid aluminium sandwich panels.

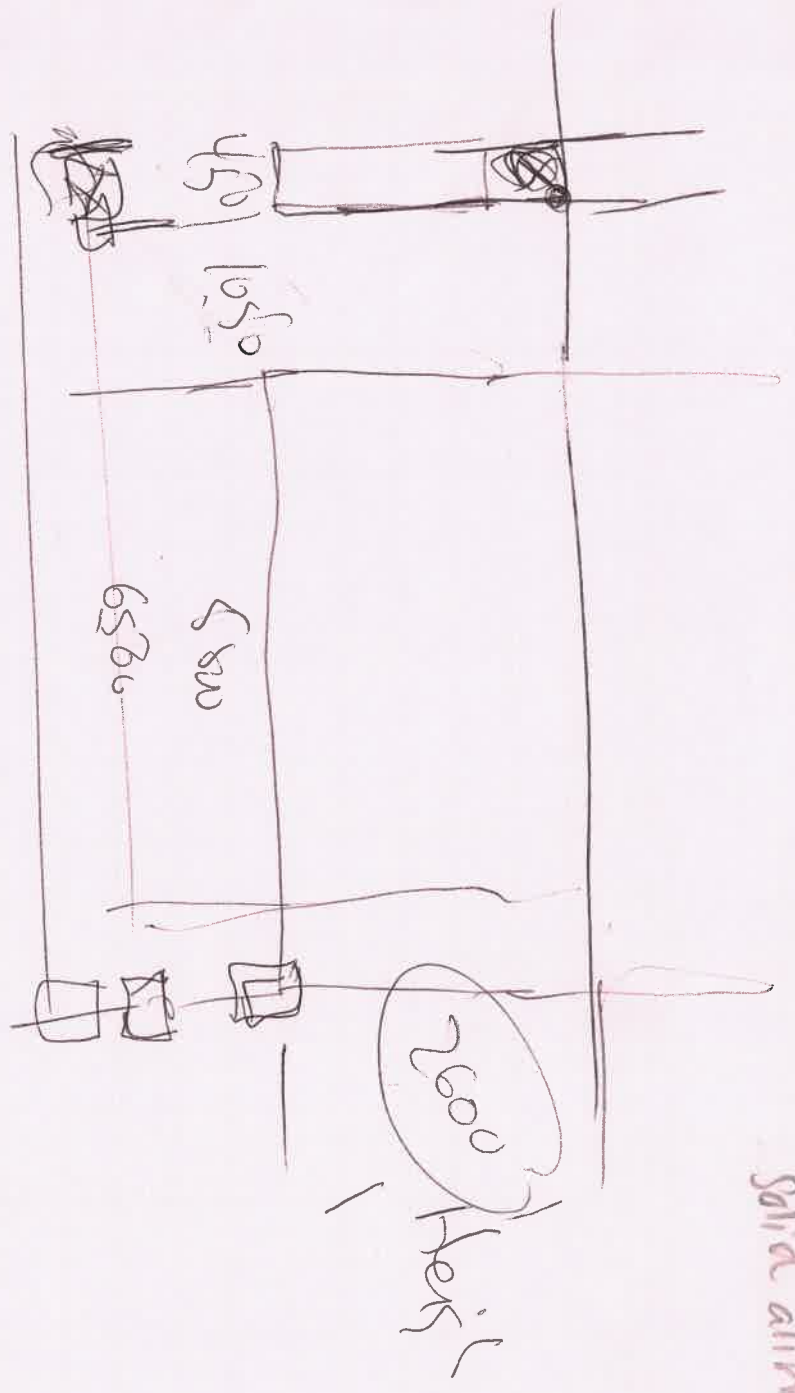

4
4566



Rachel Allo

From: Chris Gazey <chris@dorsetglass.co.uk>
Sent: 24 January 2023 07:17
To: Rachel Allo
Subject: RE: STOWER SO14133

Hi Rachel

Price as requested

8mm TGH PAR £162.13 each
Delivery to Profreight £125.00

Regards

Chris

From: Rachel Allo <rachel@cpinteriors.je>
Sent: 23 January 2023 15:53
To: Chris Gazey <chris@dorsetglass.co.uk>
Subject: STOWER SO14133

Please can you quote for 3 pieces of glass toughened 8mm

3 no 1950mm x 1200mm

Kind regards

Rachel

Rachel Allo
Interior Design Advisor
rachel@cpinteriors.je



Tel: (01534) 768141 www.cpinteriors.je
Rue Des Pres Trading Estate, St Saviour, Jersey, JE2 7QP

Blinds | Curtains | Awnings | Shutters | Furnishings |
Interior Design | Project Management



CP INTERIORS

January 31, 2023

REF : SO14133

Mrs. Nicole Stower
The Willows
10 Haut Mont Estate
St Helier
JE2 4RG

*40% deposit
received 01-02*

Dear Mrs. Nicole Stower

As requested, we have pleasure in submitting our quotation for the following.

Description	QTY	Price
Front of House,		
To Supply and Fit ,Bladed Roof Systems, Renson Algarve Canvas Carport. Frame (RAL) 7016 to match Door and canvas colour B3-3001 Charcoal Grey. Reinforced mounting bases. 4 posts with two front posts inset by 500mm. 6m span x 5.5m pivot x 2.6m full height	1	£ 25,251.00
To Supply, Linus wall half height railing with horizontal louvres across full pivot side (P2) in same colour as framework and columns,	1	£ 6,620.00
To Supply, Glass top in 3 panels, toughened 8mm glass fixed to top of linus wall including flashing and gap seals. Channels powder coated in RAL colour to match main frame,	1	£ 2,834.00
	Subtotal :	£ 34,705.00
	GST :	£ 1,735.25
	Total :	£ 36,440.25

Please note these structure are designed as garden rooms and as such may not be completely water tight. As with all our custom orders, we require a deposit of 40% at the time of placing your order, 40% on delivery to the Island and 20% balance on completion. All prices are subject to GST.

Our Price Promise to you, we will beat any written quotation by 5% (on equivalent specification).

Thank you for your enquiry and we hope you will find this quotation acceptable. Should you require any further information, please contact us.

Yours sincerely
Rachel



To accept the above quotation, please indicate which option is required, sign below and return this letter together with your deposit. Please note extract of our terms and conditions below.

.....
SIGNATURE **DATE**

Please note: This quotation is only valid for acceptance for 7 days. Our estimate does not include any electrical work or additional carpentry work to install the above unless otherwise specified. Please note there is a handling charge on customer own fabric of £5 per metre. Due to high costs of labour, pre-arranged missed fitting appointments will be charged on a time-wasted basis. Settlement is due on completion of works and an administration charge of £25 will be added per month if unpaid within 30 days. We reserve the right to charge for design, advice and liaison work carried out should an order not be placed. Goods remain the property of CP Interiors until full settlement is received. Should payment not be received we reserve the right to attend premises during working hours to remove goods and not be required to make good. Our full terms and conditions apply and are available on request.

As we no longer accept cheques, please do:

- Call us and pay by Card, we accept card transactions over the telephone and we will not charge you a handling fee.
- Bank details: Natwest, Sort Code 60-12-03, Account No 66577772 Carpet Protection (C.I) Ltd T/A CP Interiors

If you pay your deposit by BACS payment, please confirm the details of your order by returning a signed copy of this letter

