



CP INTERIORS

Mrs. Michelle O'Connell
Hillside
La Cheve Rue
St Mary
JE3 3EN

Date	Reference	Your Contact
30-08-2023	SO14041	Tamara

Customer Ref.
Roman Blinds in Living Room and Study

Quote

Our Price Promise to you
We are so confident our pricing is competitive, that we will beat any written quotation for equivalent product by 5%

Supply & Fit

Location	Description	QTY	Price
Living Room W1	Roman blind, with bonded blackout lining, in customer's own fabric. Manually operated with a left hand side silver chain	1	£ 318.00
Living Room W2	Roman blind, with bonded blackout lining, in customers own yellow fabric. Manually operated with a right hand side silver chain	1	£ 318.00
Living Room W3	Roman blind, with bonded blackout lining, in customers own yellow fabric. Manually operated with a right hand side silver chain	1	£ 318.00
Living Room W4	Roman blind, with bonded blackout lining, in customers own yellow fabric. Manually operated with a right hand side silver chain	1	£ 318.00
Living Room	Fabric, Customer's own fabric handling fee @£7.5 per metre. Based on Christopher Farr Fleurs Etoiles fabric,	8	£ 60.00
Study W1	Roman blind, with bonded blackout lining, in a fabric of your choice. Manually operated with a left hand side silver chain	1	£ 319.00
Study W2	Roman blind, with bonded blackout lining, in a fabric of your choice. Manually operated with a right hand side silver chain	1	£ 319.00
Study W3	Roman blind, with bonded blackout lining, in a fabric of your choice. Manually operated with a right hand side silver chain	1	£ 297.00
Living Room	Fabric, Customer's own fabric handling fee @£7.5 per metre. Based on Christopher Farr Belle-du-Nuit. Please note the piece of fabric supplied by customer is 5960mm long,	6	£ 45.00

Terms : 50% deposit due with order, 50% on completion

BACS Payment	
Bank:	NatWest
Sort Code:	60 12 03
Account No:	66577772
Carpet Protection (C.I) Ltd T/A CP Interiors	

Phone and Card Payment
Payment can be made in person or by phone. If phone, please call us on 01534 768141 and have your card details ready. Note, we do not accept American Express or Cheque payments.

Subtotal :	£ 2,312.00
GST :	£ 0.00
Total :	£ 2,312.00

Please note: This quotation is only valid for acceptance for 14 days. Our estimate does not include any electrical work or additional carpentry work to install the above unless otherwise specified. Please note there is a handling charge on customer own fabric of £7.50 per metre. Due to high costs of labour, pre-arranged missed fitting appointments will be charged on a time-wasted basis. Settlement is due on completion of works and an administration charge of £25 will be added per month if unpaid within 30 days. We reserve the right to charge for design, advice and liaison work carried out should an order not be placed. Goods remain the property of CP Interiors until full settlement is received. Should payment not be received we reserve the right to attend premises during working hours to remove goods and not be required to make good. Our full terms and conditions apply and are available on request.



Tropical Blinds Ltd

Unit 6 and 7 Five Arches Business Est
off Maidstone Road
Sidcup
Kent DA14 5AE
T: 020 8269 6400
F: 020 8269 6401



tropical
blinds

Order Acknowledgement

Cust Order No : SO14041 O'CONNELL
Order Date : 04/09/2023
Order No : 846757
Account Ref : CPS007
Despatch method : DHL Economy
Delivery Date : 10/10/2023
Carriage Type : DHL Economy Select 2

Order to :

C.P Interiors
Rue Des Pres Trading Estate
St. Saviour
Jersey
Channel Islands
JE2 7QN

Deliver to :

C.P Interiors 2
Rue Des Pres Trading Estate
St Saviour
Jersey
Channel Islands
JE2 7QN

Type	Colour	Width	Drop	Quantity	Unit Price	Disc %	Net	
Customers Own Roman	Customer's Own Fabric	690	1310	1	111.30	10	119.26	
Waterfall (Standard), Lining - Bonded BLACKOUT (with Fleece 400g EB), No Pelmet Req, Left Hand Control, Continuous					21.21			
Metal Chain Chrome, Not Required, Roman Breakaway Chain Mechanism								
No Power Supply Required					0.00			
Measurement:Blind Size	Spec. Ins: 8m of Christopher Farr Fleurs Etoiles for the 4 blinds in the Living Room. Please pattern match all the blinds. Face fix							
Install Height: Not Specified Location: Living room W1								
Customers Own Roman	Customer's Own Fabric	690	1310	1	111.30	10	119.26	
Waterfall (Standard), Lining - Bonded BLACKOUT (with Fleece 400g EB), No Pelmet Req, Right Hand Control, Continuous					21.21			
Metal Chain Chrome, Not Required, Roman Breakaway Chain Mechanism								
No Power Supply Required					0.00			
Measurement:Blind Size	Spec. Ins: 8m of Christopher Farr Fleurs Etoiles for the 4 blinds in the Living Room. Please pattern match all the blinds. Face fix							
Install Height: Not Specified Location: Living room W2								
Customers Own Roman	Customer's Own Fabric	780	1440	1	111.30	10	119.26	
Waterfall (Standard), Lining - Bonded BLACKOUT (with Fleece 400g EB), No Pelmet Req, Left Hand Control, Continuous					21.21			
Metal Chain Chrome, Not Required, Roman Breakaway Chain Mechanism								
No Power Supply Required					0.00			
Measurement:Blind Size	Spec. Ins: 8m of Christopher Farr Fleurs Etoiles for the 4 blinds in the Living Room. Please pattern match all the blinds. Face fix							
Install Height: Not Specified Location: Living room W3								
Customers Own Roman	Customer's Own Fabric	790	1440	1	111.30	10	119.26	
Waterfall (Standard), Lining - Bonded BLACKOUT (with Fleece 400g EB), No Pelmet Req, Right Hand Control, Continuous					21.21			
Metal Chain Chrome, Not Required, Roman Breakaway Chain Mechanism								
No Power Supply Required					0.00			
Measurement:Blind Size	Spec. Ins: 8m of Christopher Farr Fleurs Etoiles for the 4 blinds in the Living Room. Please pattern match all the blinds. Face fix							
Install Height: Not Specified Location: Living room W4								

Customers Own Roman	Customer's Own Fabric	860	1600	1	120.60	10	127.63	
Waterfall (Standard), Lining - Bonded BLACKOUT (with Fleece 400g EB), No Pelmet Req, Left Hand Control, Continuous					21.21			
Metal Chain Chrome, Not Required, Roman Breakaway Chain Mechanism								
No Power Supply Required					0.00			
Measurement:Blind Size	Spec. Ins: 6m of Christopher Farr belle-du-Nuit fabric for the three blinds in the study. Please pattern match them (using a half drop pattern repeat). Face fix							

Install Height: Not Specified Location: Study W1

Customers Own Roman	Customer's Own Fabric	860	1600	1	120.60	10	127.63	
Waterfall (Standard), Lining - Bonded BLACKOUT (with Fleece 400g EB), No Pelmet Req, Right Hand Control, Continuous					21.21			
Metal Chain Chrome, Not Required, Roman Breakaway Chain Mechanism								
No Power Supply Required					0.00			
Measurement:Blind Size	Spec. Ins: 6m of Christopher Farr belle-du-Nuit fabric for the three blinds in the study. Please pattern match them (using a half drop pattern repeat). Face fix							

Install Height: Not Specified Location: Study W2

Customers Own Roman	Customer's Own Fabric	670	1000	1	102.04	10	110.93	
Waterfall (Standard), Lining - Bonded BLACKOUT (with Fleece 400g EB), No Pelmet Req, Right Hand Control, Continuous					21.21			
Metal Chain Chrome, Not Required, Roman Breakaway Chain Mechanism								
No Power Supply Required					0.00			
Measurement:Blind Size	Spec. Ins: 6m of Christopher Farr belle-du-Nuit fabric for the three blinds in the study. Please pattern match them (using a half drop pattern repeat). Face fix							

Install Height: Not Specified Location: Study W3

If a Premium carriage service is requested (Pre Noon, Pre 10.30, Saturday or Saturday Pre Noon) the relevant charge will be applied to your invoice. Goods delivered to the following areas: Cornwall, Dyfed, Powys, Anglesey, Gwynedd, Scotland, Isle of Wight, Isle of Man, Isle of Scilly, Channel Isles, Northern Ireland and Republic of Ireland will be subject to a carriage charge as detailed on Page 2 of our trade price list. These carriage charges may not appear on your order acknowledgement but will be applied to your invoice

Net Price :	£843.23
VAT :	£0.00
Total :	£843.23

Tropical Blinds Ltd

Unit 6 and 7 Five Arches Business Est
off Maidstone Road
Sidcup
Kent
DA14 5AE
Tel: 020 8269 6400 Fax: 020 8269 6401

Vat No: 324 0532 02
Cust Order No: SO14041 O'CONNELL
Order Date: 04/09/2023
Order No: 3610017
Cust Ref:
Account Ref: CPS007
Despatch Method:DHL Carrier 2 NEW

Order To:
C.P Interiors 2
Rue Des Pres Trading Estate
St Saviour
Jersey
Channel Islands
JE2 7QN

Deliver To:
C.P Interiors 2
Rue Des Pres Trading Estate
St Saviour
Jersey
Channel Islands
JE2 7QN

Type	Colour	Width	Drop	Qua
Customers Own Roman	Customer's Own Fabric	690	1310	
Waterfall (Standard), Lining - Bonded BLACKOUT (with Fleece 400g EB), No Pelmet Req, Left Hand Control, Continuous Metal Chain Chrome, N/A, None Required, No Handset Required, No Power Supply Required, Not Required, Roman Breakaway Chain Mechanism				
Measurement: Blind Size ✓ Spec. ins: 8m of Christopher Farr Fleurs Etoiles for the 4 blinds in the Living Room. Please pattern match all the blinds. Face fix ✓				
Location: Living room W1 ✓ Fitting ins:				
Customers Own Roman	Customer's Own Fabric	690	1310	
Waterfall (Standard), Lining - Bonded BLACKOUT (with Fleece 400g EB), No Pelmet Req, Right Hand Control, Continuous Metal Chain Chrome, N/A, None Required, No Handset Required, No Power Supply Required, Not Required, Roman Breakaway Chain Mechanism				
Measurement: Blind Size ✓ Spec. ins: 8m of Christopher Farr Fleurs Etoiles for the 4 blinds in the Living Room. Please pattern match all the blinds. Face fix ✓				
Location: Living room W2 ✓ Fitting ins:				
Customers Own Roman	Customer's Own Fabric	780	1440	
Waterfall (Standard), Lining - Bonded BLACKOUT (with Fleece 400g EB), No Pelmet Req, Left Hand Control, Continuous Metal Chain Chrome, N/A, None Required, No Handset Required, No Power Supply Required, Not Required, Roman Breakaway Chain Mechanism				
Measurement: Blind Size ✓ Spec. ins: 8m of Christopher Farr Fleurs Etoiles for the 4 blinds in the Living Room. Please pattern match all the blinds. Face fix ✓				
Location: Living room W3 ✓ Fitting ins:				
Customers Own Roman	Customer's Own Fabric	790	1440	
Waterfall (Standard), Lining - Bonded BLACKOUT (with Fleece 400g EB), No Pelmet Req, Right Hand Control, Continuous Metal Chain Chrome, N/A, None Required, No Handset Required, No Power Supply Required, Not Required, Roman Breakaway Chain Mechanism				
Measurement: Blind Size ✓ Spec. ins: 8m of Christopher Farr Fleurs Etoiles for the 4 blinds in the Living Room. Please pattern match all the blinds. Face fix ✓				
Location: Living room W4 ✓ Fitting ins:				
Customers Own Roman	Customer's Own Fabric	860	1600	
Waterfall (Standard), Lining - Bonded BLACKOUT (with Fleece 400g EB), No Pelmet Req, Left Hand Control, Continuous Metal Chain Chrome, N/A, None Required, No Handset Required, No Power Supply Required, Not Required, Roman Breakaway Chain Mechanism				
Measurement: Blind Size ✓ Spec. ins: 6m of Christopher Farr belle-du-Nuit fabric for the three blinds in the study. Please pattern match them (using a half drop pattern repeat). Face fix ✓				
Location: Study W1 ✓ Fitting ins:				
Customers Own Roman	Customer's Own Fabric	860	1600	
Waterfall (Standard), Lining - Bonded BLACKOUT (with Fleece 400g EB), No Pelmet Req, Right Hand Control, Continuous Metal Chain Chrome, N/A, None Required, No Handset Required, No Power Supply Required, Not Required, Roman Breakaway Chain Mechanism				
Measurement: Blind Size ✓ Spec. ins: 6m of Christopher Farr belle-du-Nuit fabric for the three blinds in the study. Please pattern match them (using a half drop pattern repeat). Face fix ✓				
Location: Study W2 ✓ Fitting ins:				
Customers Own Roman	Customer's Own Fabric	670	1000	
Waterfall (Standard), Lining - Bonded BLACKOUT (with Fleece 400g EB), No Pelmet Req, Right Hand Control, Continuous Metal Chain Chrome, N/A, None Required, No Handset Required, No Power Supply Required, Not Required, Roman Breakaway Chain Mechanism				
Measurement: Blind Size ✓ Spec. ins: 6m of Christopher Farr belle-du-Nuit fabric for the three blinds in the study. Please pattern match them (using a half drop pattern repeat). Face fix ✓				
Location: Study W3 ✓ Fitting ins:				

AF checked 04/09

Fabric is 130 cm wide \downarrow 33 cm \leftrightarrow 47.6 cm

W1

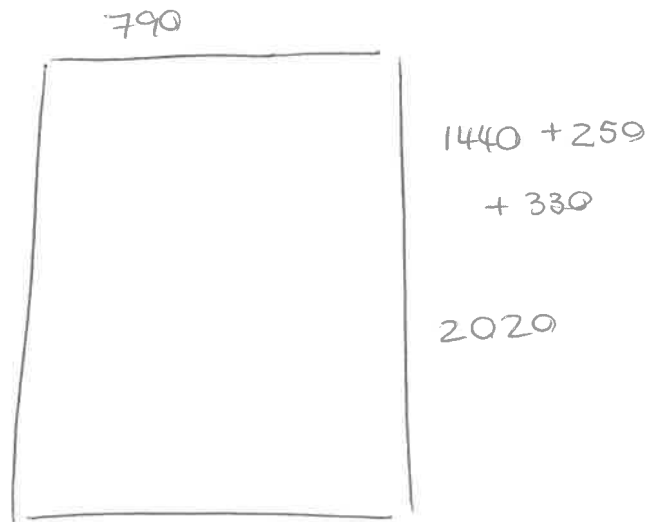
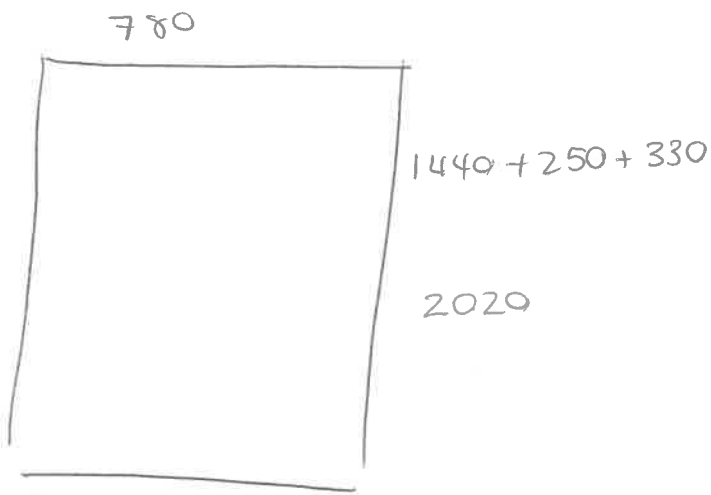
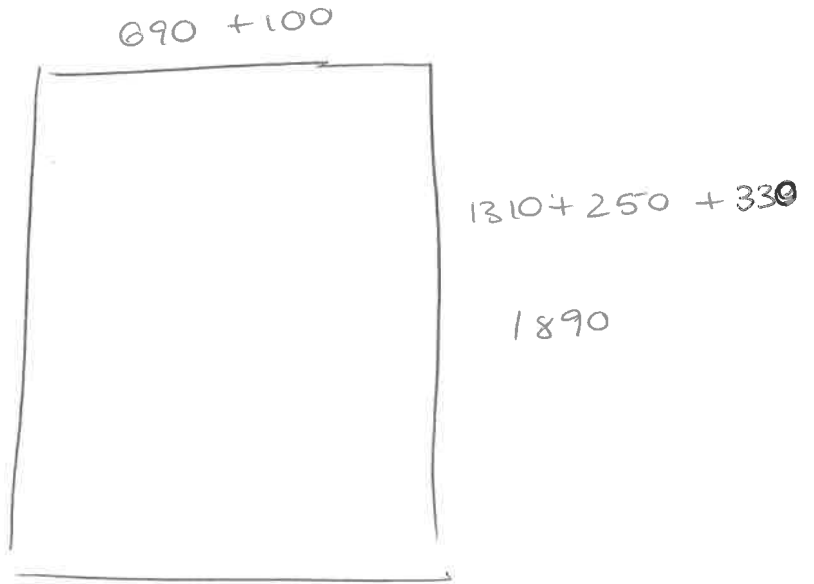
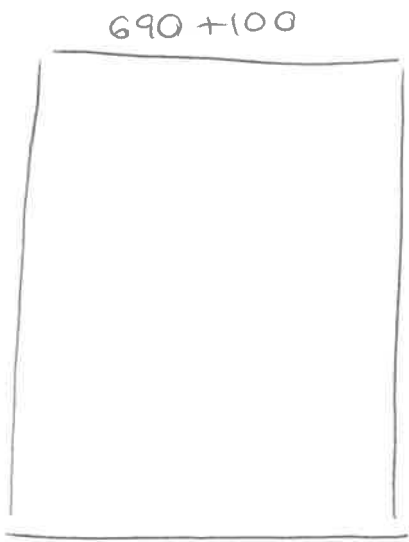

STUDIO

Christopher Farr Belle - de - Nuit 131 cm wide

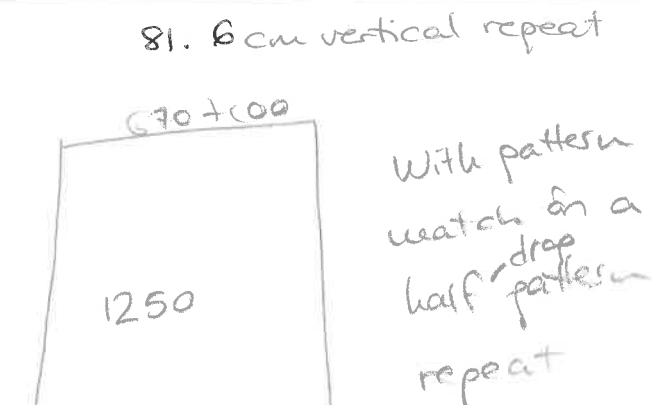
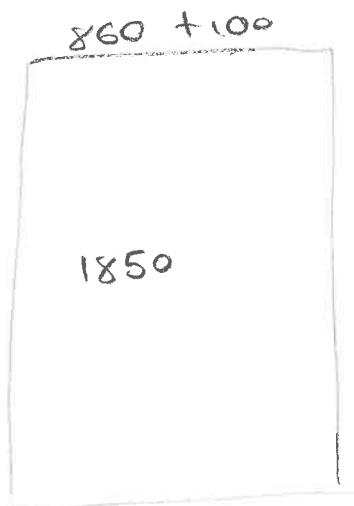

Belle du Nuit
Blue Fabric

Fabric length: 5960

Fleurs Ftouches
green Fabric

Fabric length: 8250

Staff Name Adrian

Work Diary

Order No SO13805

Measurer or Fitter Measurer

Contact Address Mrs. Michelle O'Connell, Hillside, La Cheve Rue, St Mary, JE3 3EN, 07829 777707, michmasho@googlemail.com

Customer Ref

Date 29-09-2022

Time 11:30

Notes : 0 To take measurements for 7 Roman blinds

Location	Supplier	Blind Type /Description	Colour	Qty	Width	Drop	Fitting Height	Blind/Recess	Controls	Brackets	Surface	Unit Price
12/14/20		Roman	C-OF	2	725	1310		RS	L/R	FAIR		
"		"		2	840 835	1460		"	R/R	-		
"		Window Seat curtain 50mm Foam with diff panel	"	4	846	330	approx templates required					
LN		Roman	TRA	2	690	1316		"	L+R	FAIR		
				1	780	1440		"	L/R	FAIR		
		Window Seat AP above		1	790	1440		"	R	"		
		Window Seat Roman	TRA	4	860	370						
office			TRA	1	865	1595		"	L+R	FAIR		

Comments:

Order Date

Customer Signature

X I have checked and agree with the above choices

Target Fitting Date

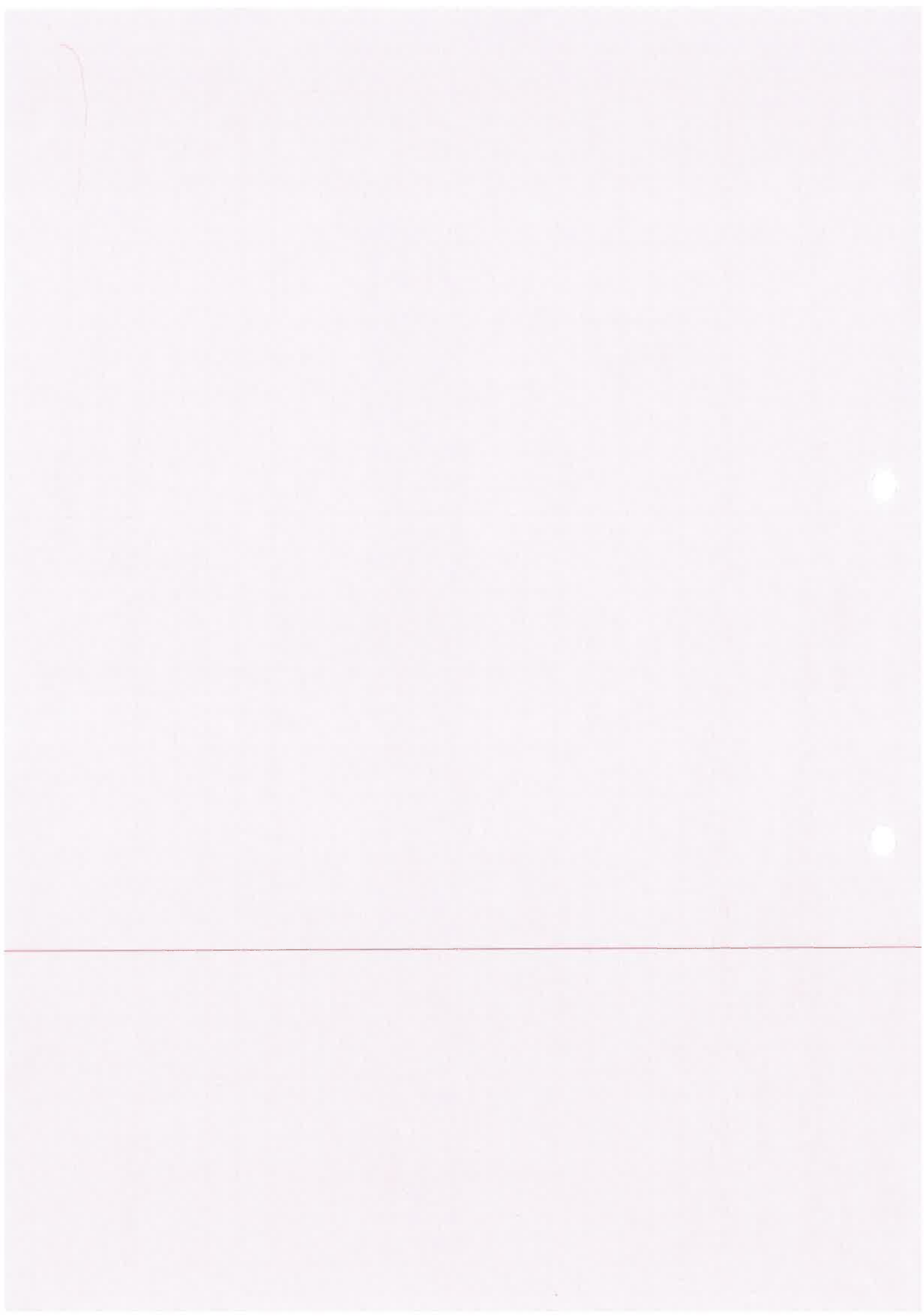

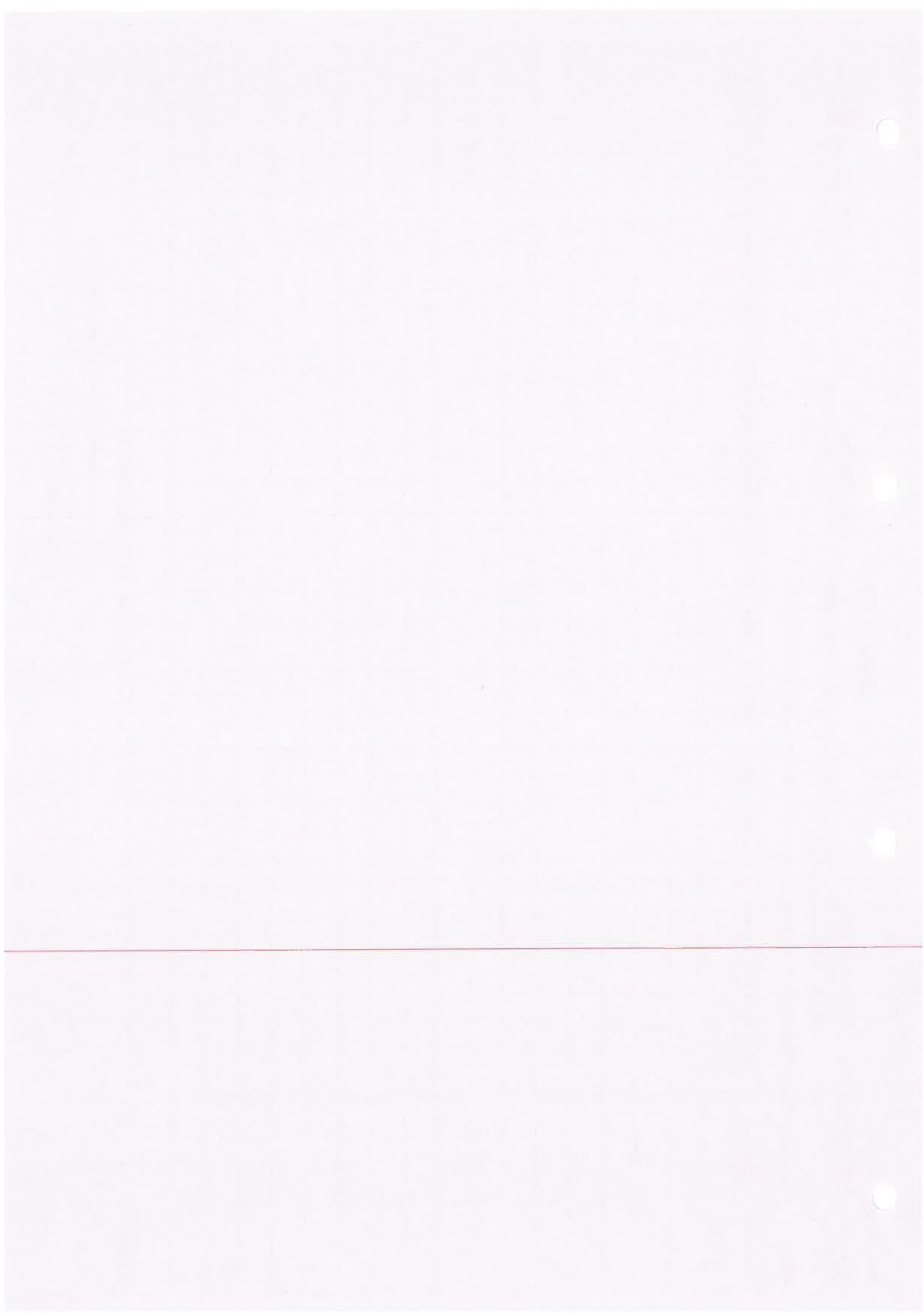



CP INTERIORS

Mrs. Michelle O'Connell
Hillside
La Cheve Rue
St Mary
JE3 3EN

Date	Reference	Your Contact
11-08-2023	SO14041	Tamara Lopez-Dominguez

Customer Ref.
Roman Blinds in Lounge and Office

Quote

Our Price Promise to you
We are so confident our pricing is competitive, that we will beat any written quotation for equivalent product by 5%

To Supply and Fit:

Location	Description	QTY	Price
Living Room W1	Roman blind, with bonded blackout lining, in customer's own fabric. Manually operated with a left hand side silver chain	1	£ 318.00
Living Room W2	Roman blind, with bonded blackout lining, in customers own yellow fabric. Manually operated with a right hand side silver chain	1	£ 318.00
Living Room W3	Roman blind, with bonded blackout lining, in customers own yellow fabric. Manually operated with a right hand side silver chain	1	£ 318.00
Living Room W4	Roman blind, with bonded blackout lining, in customers own yellow fabric. Manually operated with a right hand side silver chain	1	£ 318.00
Living Room	Fabric, Customer's own fabric handling fee @£7.5 per metre. Based on Christopher Farr Fleurs Etoiles fabric,	8	£ 60.00

Terms : 50% due with order & final 50% on completion.

BACS Payment	
Bank:	NatWest
Sort Code:	60 12 03
Account No:	66577772
Carpet Protection (C.I) Ltd T/A CP Interiors	

Phone and Card Payment
Payment can be made in person or by phone. If phone, please call us on 01534 768141 and have your card details ready. Note, we do not accept American Express or Cheque payments.

Subtotal :	£ 1,332.00
GST :	£ 0.00
Total :	£ 1,332.00

Please note: This quotation is only valid for acceptance for 14 days. Our estimate does not include any electrical work or additional carpentry work to install the above unless otherwise specified. Please note there is a handling charge on customer own fabric of £7.50 per metre. Due to high costs of labour, pre-arranged missed fitting appointments will be charged on a time-wasted basis. Settlement is due on completion of works and an administration charge of £25 will be added per month if unpaid within 30 days. We reserve the right to charge for design, advice and liaison work carried out should an order not be placed. Goods remain the property of CP Interiors until full settlement is received. Should payment not be received we reserve the right to attend premises during working hours to remove goods and not be required to make good. Our full terms and conditions apply and are available on request.

Christopher Farr | cloth

Flours Etoiles Technical Sheet



Flours Etoiles Green linen headboard, Interiors by Firmdale Hotels

Composition	100% Linen / 100% Non Woven Wallpaper
Width	51.2" / 130CM
Pattern Repeat	Horizontal Repeat 13" / 33CM Vertical Repeat 18.7" / 47.6CM (Straight Match)
Linen Martindale	25,000 Rubs
Roll Length	Max size 50M / 45 yard rolls (sold by linear metre / yard)
Weight	Linen 510 g/m2 Wallpaper 147 g/m2
Minimum order	1M / 3 Yards
Fabric Maintenance	Weekly light vacuuming is desirable to remove dirt and dust particles and greatly extends the life of the fabric. Most of our prints have good resistance to being dry-cleaned in Perchloroethylene, but a spot test is recommended to ascertain temperature and purity values beforehand. Custom print on performance polyester for a more washable product.
Fabric FR Rating	All printed linens are supplied untreated and untested. Fabrics made of at least 75% natural fibres can be Cigarette tested upon request to comply with Domestic Upholstery regulations when covered with a barrier cloth (schedule 3 interliner)
Wallpaper Maintenance	We do not recommend cleaning our delicate hand printed wallpapers but if necessary, please wipe the area gently with a non-abrasive cloth to remove dirt. Custom print on vinyl for a more washable product.
Wallpaper Fire Rating	EN 13501-1:2002 Class B, s1, d0
Commodity Code	Linen 5309111000 Wallpaper 48021000
Country of Origin	UK

Inquire for custom projects No minimum order on standard wallpaper, vinyl, linen, cotton or Trevira.

Custom lead time 2-3 weeks sampling, 4-8 weeks production from receipt of 50% deposit.

Inquire for contract projects 40 Metre minimums for Performance Polyester FR, 100 Metre minimums for ASTM Vinyl.

Contract lead time 6-8 weeks sampling, 8-10 weeks production from receipt of 50% deposit and confirmed order.

Flours Etoillees Technical Sheet

Custom Submittal Form

We thrive on creative conversations and love to be challenged, this combined with our intimate knowledge of colour, printing and weaving allows us to tackle almost any customisation project. With simple instruction on colour we can adapt the palette of a design to match any interior scheme.

Colours

We can easily alter the colours of our prints to adapt them for a particular scheme. We require guidance on colour from any source, such as fabric cutting, pantone or paint swatch references.

Base Qualities

We can alter the composition of our fabrics to make them more suitable for a given use. Whether we are printing onto a more durable ground for upholstery, Trevira or vinyl for flame retardancy, polyester for outdoor use, we apply the same care and attention.



Flours Etoillees Design

THIS FORM MUST BE SUBMITTED WITH HARD COLOUR REFERENCES TO YOUR SHOWROOM WHO WILL PROVIDE A FORMAL QUOTE BASED ON INFORMATION PROVIDED.

● *Colour 1*

Ground Colour

Print to standard

Client to submit

Design Notes (scale change / motif adjustments) -----

Quantity Required -----

Ground Options (please tick box that applies)

<input type="checkbox"/> Non-Woven Wallpaper (White or Ivory)	<input type="checkbox"/> Raffia Wallpaper (50 M/YD Minimums apply)
<input type="checkbox"/> Vinyl Wallpaper (Flat or Linen Emboss)	<input type="checkbox"/> Cotton (several options available)
<input type="checkbox"/> Trevira Polyester FR (several options available)	<input type="checkbox"/> Outdoor Performance Polyester FR (40 M/YD Minimums apply)
<input type="checkbox"/> Light Linen (Ecru or Natural)	<input type="checkbox"/> Other - please specify:
<input type="checkbox"/> Heavy Linen (Ecru or Natural)	

Custom print on contract vinyl to meet EN 13501 B-s2, d0 + ASTM E84 Class A standards.
 Custom print on Performance Polyester FR to meet class 1 anti-flame according to UNI 9176, B1 in Germany and M1 in France, NFPA 701-10, NFPA 260 and UFAC in Class 1.