

RENSON

1 x Box

508178. WA COUPE.

Arrived 11-1-24

RECEIVED

11/1/24

SCANNED

2013719

Mackie



Creating healthy spaces  
NV RENSON® Sunprotection-Screens SA

## Service confirmation

<b>Confirmation date</b>	04.12.2023	CP Interiors
<b>Order number</b>	29385	St. Saviour
<b>Notification number</b>	300011462	28 Rue des Pres. Tr. Est.
<b>Customer number</b>	1001334	JE2 7QN JERSEY
<b>Your VAT number</b>		JERSEY
<b>Currency</b>	GBP	
<b>Order reference</b>	SO8178 La Coupe UK.60/08617	<i>SO13719 Maekie</i>

**Incoterms** DDP  
Jersey

### Delivery address

CP Interiors  
St. Saviour  
28 Rue des Pres. Tr. Est.  
JE2 7QN JERSEY  
JERSEY

## Overview

Material	Quantity	Net amount	VAT %
001000 5017 STOPPER RAILS BOTTOM (209902-0000)		82,17	
<b>Total before VAT</b>		<b>82,17</b>	
<b>VAT</b>		<b>0,00</b>	
<b>Total incl. VAT</b>		<b>82,17</b>	

Free of VAT, export

For questions or remarks regarding this document, please send an email to [outdoor-uk@renson.be](mailto:outdoor-uk@renson.be)

The General Terms and Conditions of Sale are integral part of our agreement. See Professional Portal at <http://www.renson.eu/>



Creating healthy spaces  
NV RENSON® Sunprotection-Screens SA

## Service confirmation

29385

04.12.2023

### Detail

Item	Material	Unit price	Quantity	Gross amount	Discount %	Net amount
001000	5017 STOPPER RAILS BOTTOM (209902-0000)					82,17
	Commodity code 39259010		Plastic parts of windows, doors			
	Price material(C+)					82,17

## Scott Ruderham

---

**From:** Scott Ruderham  
**Sent:** Wednesday, 29 November 2023 10:09  
**To:** Outdoor UK  
**Cc:** Adrian Colston-Weeks; Ben Reed  
**Subject:** RE: Parts / Technical Drawings for Glass Doors Ref; Mackie

Hi Tina

Brilliant thanks!  
Ben has confirmed yes x 68 as we need 2 for each door

The original order number is SO8178 La Coupe

We also require as advised below

**SO8178 La Coupe** | UK.60/08617  
1171522 | CP Interiors

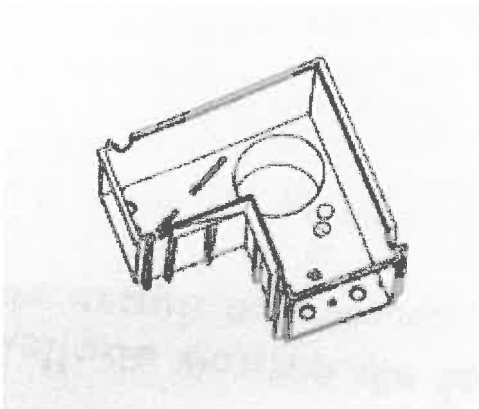

x 8 of these gutter corner pieces (x 4 with outlets, x 4 without outlets)

Can you please get these all ordered for me asap?

The 68 x glass door locks/fix blocks  
8 total (4 x left, 4 x right) of the gutter corner pieces

I will look forward to receiving official order conf

Many Thanks  
Scotty

**From:** Outdoor UK <outdoor-uk@renson.be>  
**Sent:** Wednesday, 29 November 2023 09:55

**To:** Scott Ruderham <scott@cpinteriors.je>  
**Cc:** Adrian Colston-Weeks <Adrian@cpinteriors.je>; Ben Reed <Ben@cpinteriors.je>  
**Subject:** RE: Parts / Technical Drawings for Glass Doors Ref; Mackie

Hi Scott,

they can be supplied, but I need to order then through a service request. Therefore I will need to original order no.

Also, you are requesting 68 pcs, is this correct?

**Tina Mott** | Internal Account Representative Nordics

tina.mott@renson.net  
Mob: +45 3027 7480



**Renson® Headquarters**  
Industriezone 2 Vijverdam - Maalbeekstraat 10 - B-8790 Waregem  
Tel: +32 56 30 30 00 - www.renson.eu



Too warm? Start with sun protection!

[FIND OUT HERE](#)



This e-mail may contain confidential and/or privileged information. If you are not the intended recipient (or have received this e-mail in error) please notify the sender immediately and destroy this e-mail. Any unauthorised copying, disclosure or distribution of the material in this e-mail is strictly forbidden. Warning: Although the company has taken reasonable precautions to ensure no viruses are present in this email, the company cannot accept responsibility for any loss or damage arising from the use of this email or attachments.

**From:** Scott Ruderham <scott@cpinteriors.je>  
**Sent:** 27. november 2023 15:52  
**To:** Outdoor UK <outdoor-uk@renson.be>  
**Cc:** Adrian Colston-Weeks <Adrian@cpinteriors.je>; Ben Reed <Ben@cpinteriors.je>  
**Subject:** RE: Parts / Technical Drawings for Glass Doors Ref; Mackie

Hi Tina

Ben has said it is relating to the model of unit we had.  
We dismantled and will be re constructing around April/May so will require the identical parts as damaged during dismantle process as per the drawing

Please can you advise if these can be sent?

Thanks  
Scotty

**From:** Outdoor UK <outdoor-uk@renson.be>  
**Sent:** Monday, 27 November 2023 12:11  
**To:** Scott Ruderham <scott@cpinteriors.je>  
**Cc:** Adrian Colston-Weeks <Adrian@cpinteriors.je>; Ben Reed <Ben@cpinteriors.je>  
**Subject:** RE: Parts / Technical Drawings for Glass Doors Ref; Mackie

Hi Scott,

it seems the drawing you sent me is not the updated version. The stoppers are not placed on the top instead.

KR,

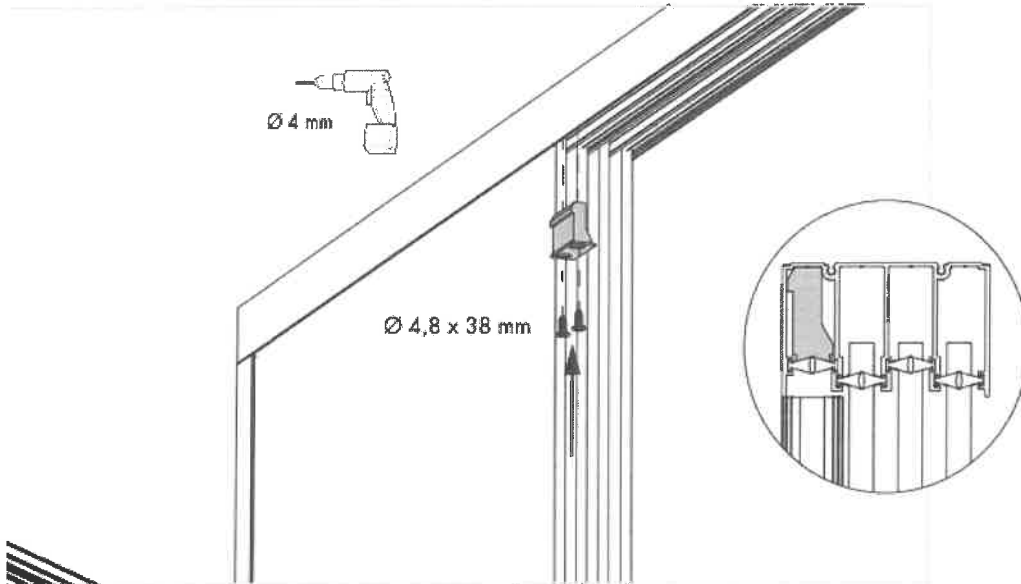

RENSON

**Tina Mott** | Internal Account Representative Nordics

tina.mott@renson.net  
Mob: +45 3027 7480

**RenSON® Headquarters**  
Industriezone 2 Vijverdam - Maalbeekstraat 10 - B-8790 Waregem  
Tel: +32 56 30 30 00 - www.renson.eu

**RENSON®**  
Creating healthy spaces



Too warm? Start with sun protection!

**FIND OUT HERE**



This e-mail may contain confidential and/or privileged information. If you are not the intended recipient (or have received this e-mail in error) please notify the sender immediately and destroy this e-mail. Any unauthorised copying, disclosure or distribution of the material in this e-mail is strictly forbidden. Warning: Although the company has taken reasonable precautions to ensure no viruses are present in this email, the company cannot accept responsibility for any loss or damage arising from the use of this email or attachments.

**From:** Scott Ruderham <scott@cpinteriors.ie>

**Sent:** 24. november 2023 11:38

**To:** Outdoor UK <outdoor-uk@renson.be>

**Cc:** Adrian Colston-Weeks <Adrian@cpinteriors.ie>; Ben Reed <Ben@cpinteriors.ie>

**Subject:** Re: Parts / Technical Drawings for Glass Doors Ref; Mackie

Hi Tina

thank you for your help  
yes that would be great if we can get asap

many thanks  
scotty

**From:** Outdoor UK <[outdoor-uk@renson.be](mailto:outdoor-uk@renson.be)>  
**Sent:** Friday, November 24, 2023 10:36 AM  
**To:** Scott Ruderham <[scott@cpinteriors.ie](mailto:scott@cpinteriors.ie)>  
**Cc:** Adrian Colston-Weeks <[Adrian@cpinteriors.ie](mailto:Adrian@cpinteriors.ie)>; Ben Reed <[Ben@cpinteriors.ie](mailto:Ben@cpinteriors.ie)>  
**Subject:** RE: Parts / Technical Drawings for Glass Doors Ref; Mackie

Hi Scott,

I have requested the parts from technical sales. Due to an unusual workload, we are experiencing a bit longer response time.  
I'll send you quote no. when I have all information.

Kind regards,

**Tina Mott** | Internal Account Representative Nordics

tina.mott@renson.net  
Mob: +45 3027 7480



**Renson® Headquarters**  
Industriezone 2 Vijverdam - Maalbeekstraat 10 - B-8790 Waregem  
Tel: +32 56 30 30 00 - [www.renson.eu](http://www.renson.eu)



Too warm? Start with sun protection!

[FIND OUT HERE](#)



This e-mail may contain confidential and/or privileged information. If you are not the intended recipient (or have received this e-mail in error) please notify the sender immediately and destroy this e-mail. Any unauthorised copying, disclosure or distribution of the material in this e-mail is strictly forbidden. Warning: Although the company has taken reasonable precautions to ensure no viruses are present in this email, the company cannot accept responsibility for any loss or damage arising from the use of this email or attachments.

**From:** Scott Ruderham <[scott@cpinteriors.ie](mailto:scott@cpinteriors.ie)>  
**Sent:** 22. november 2023 16:02  
**To:** Outdoor UK <[outdoor-uk@renson.be](mailto:outdoor-uk@renson.be)>  
**Cc:** Adrian Colston-Weeks <[Adrian@cpinteriors.ie](mailto:Adrian@cpinteriors.ie)>; Ben Reed <[Ben@cpinteriors.ie](mailto:Ben@cpinteriors.ie)>  
**Subject:** RE: Parts / Technical Drawings for Glass Doors Ref; Mackie

Hi Tina

Thanks – we have reviewed all of the drawings and also in the catalogue, there are no part nos .. we have tried finding on Rio but we have the photos of the pieces we require from the catalogue (there were no part nos labelled) It is for the Algarve

Please see below the photos we require with a description of what it is and how many we require, if you can please find part nos to advise for RIO and or order on our behalf that would be great please.

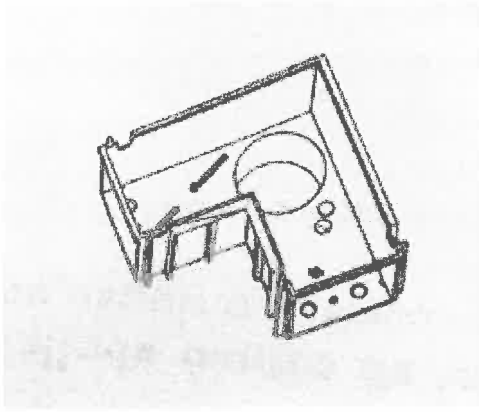

x 8 of these gutter corner pieces (x 4 with outlets, x 4 without outlets)

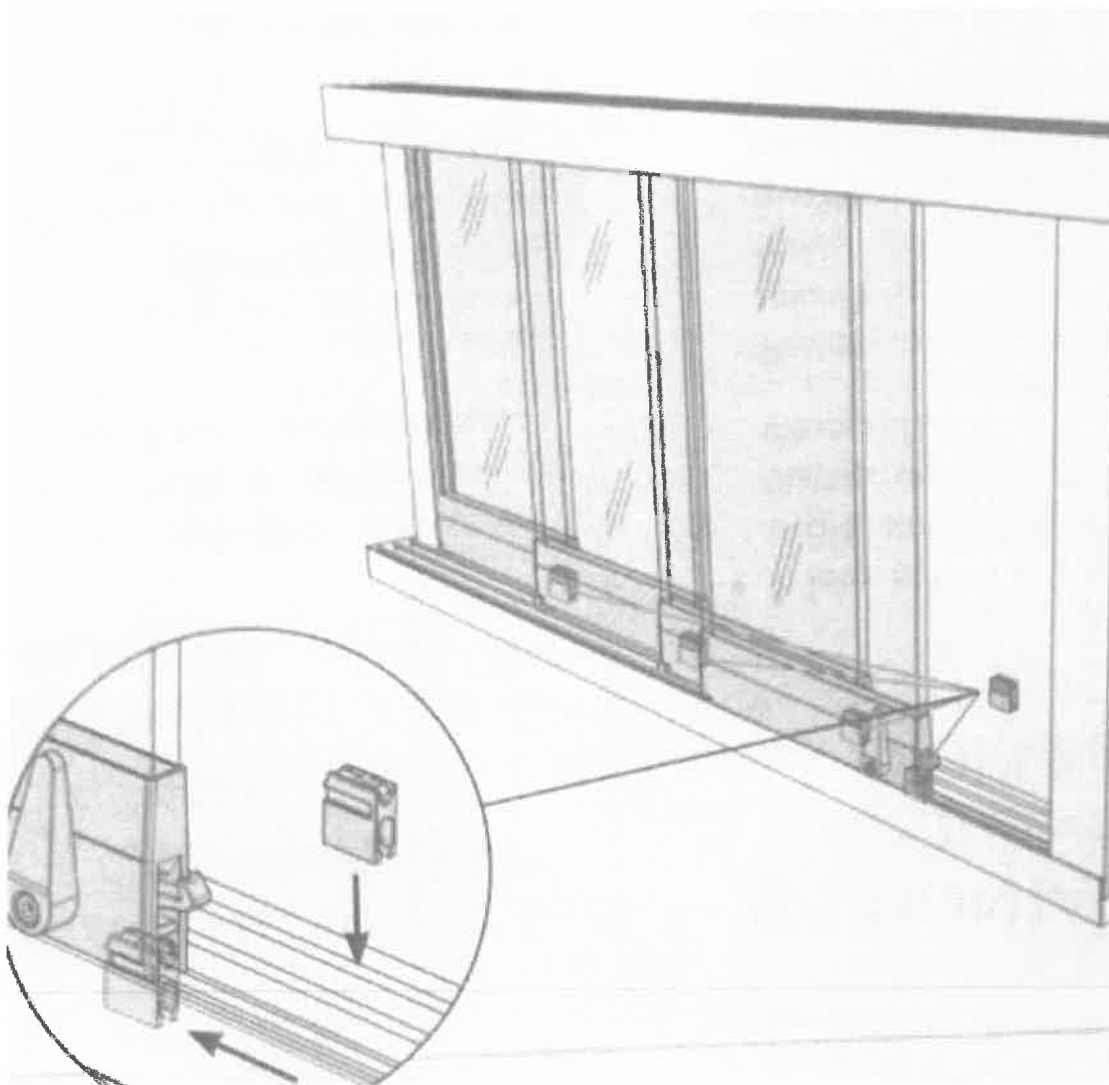

X 68 of these pieces – we think they are called glass door fix blocks, for the bottom rail

Please can you help with this?

Thanks  
Scotty

**From:** Outdoor UK <[outdoor-uk@renson.be](mailto:outdoor-uk@renson.be)>  
**Sent:** Wednesday, 22 November 2023 14:24  
**To:** Scott Ruderham <[scott@cpinteriors.je](mailto:scott@cpinteriors.je)>  
**Cc:** Adrian Colston-Weeks <[Adrian@cpinteriors.je](mailto:Adrian@cpinteriors.je)>  
**Subject:** RE: Parts / Technical Drawings for Glass Doors Ref; Mackie

Attached, please find parts and profiles.

For complete sets of hardware, it can be configured in RIO under Glass Sliding Panels. For replacement parts for already delivered items, they can be ordered as service parts via Service Request in RIO.

If not all item numbers are available in RIO, kindly send me an email with the required part no. and quantity, and I will make a quote for you.

Kind regards,

**Tina Mott** | Internal Account Representative Nordics

[tina.mott@renson.net](mailto:tina.mott@renson.net)  
Mob: +45 3027 7480

**Renson® Headquarters**  
Industriezone 2 Vijverdam - Maalbeekstraat 10 - B-8790 Waregem  
Tel: +32 56 30 30 00 - [www.renson.eu](http://www.renson.eu)



Too warm? Start with sun protection!

[FIND OUT HERE](#)



This e-mail may contain confidential and/or privileged information. If you are not the intended recipient (or have received this e-mail in error) please notify the sender immediately and destroy this e-mail. Any unauthorised copying, disclosure or distribution of the material in this e-mail is strictly forbidden. Warning: Although the company has taken reasonable precautions to ensure no viruses are present in this email, the company cannot accept responsibility for any loss or damage arising from the use of this email or attachments.

**From:** Scott Ruderham <[scott@cpinteriors.je](mailto:scott@cpinteriors.je)>  
**Sent:** 22. november 2023 14:49  
**To:** Outdoor UK <[outdoor-uk@renson.be](mailto:outdoor-uk@renson.be)>; Service Outdoor <[service-outdoor@renson.be](mailto:service-outdoor@renson.be)>  
**Cc:** Adrian Colston-Weeks <[Adrian@cpinteriors.je](mailto:Adrian@cpinteriors.je)>  
**Subject:** Parts / Technical Drawings for Glass Doors Ref; Mackie

Hi Renson

I require some technical drawings with part nos please for glass doors so I can identify the parts required and place an order online.

Can you send me all you have asap please?

Kind regards,

*Scotty*

Ruderham

Logistics/Customer Care  
scott@cpinteriors.je



Unit 28 Rue Des Pres Trading Estate  
St Saviour  
Jersey  
JE2 7QN

01534 768141 | [www.cpinteriors.je](http://www.cpinteriors.je)



With our CP Price promise, we will beat any quote by 5% \*\*  
\*\* On like for like products only

DELIVERY ADDRESS

As invoice address

CP INTERIORS  
 RUE DES PRES. TRADING ESTATE  
 ST. SAVIOUR  
 JE2 7QN JERSEY  
 JERSEY

**ORDER CONFIRMATION : UK-60/08617**

Customer	Date confirm.	Prod.nr.	TAX	Page	eReps1171522		
134872	11.04.19	616646	0,00%	1	EXPECTED SHIPPING DATE 29/5/2019		

Order details		Sizes Length	Ordered	Unit Price	%	Net	GBP
RF01 S08178 La Coupe							
616646- Algarve Line		4500x4200mm	1	18.832,10	40,00	11.299,26	
- Seaside Quality A							
- Colour blades: STR 0088 Frame : STR 0088							
- STR 0088 - AE03057702120 - Fine Texture RAL 7021 BLACK GR							
- Passage height 2400 mm							
- Adapter profile Adapter profile							
- UpDown Span : .							
- Design : Algarve							
- Motorposition : P2							
- Blade rotation : Sunprotection							
- Drainage blade : Non-motor side							
- Roof type 1 : Blades							
- 1A Corner : Column as repositioned col							
- Position : 840 mm							
- Overlength : 150 mm							
- Mounting base : Visible mounting base							
- Fixation holes : WITH mounting holes							
- 1B Corner : Column as repositioned col							
- Position : 840 mm							
- Overlength : 150 mm							
- Mounting base : Visible mounting base							
- Fixation holes : WITH mounting holes							
- 2A Corner : Column at the corner							
- Overlength : 150 mm							
- Mounting base : Visible mounting base							
- Water drainage : Pivot							
- Height water drainage : Drainage tube at 60 mm abo							
- Fixation holes : WITH mounting holes							
- 2B Corner : Column at the corner							
- Overlength : 150 mm							
- Mounting base : Visible mounting base							
- Water drainage : Pivot							
- Height water drainage : Drainage tube at 60 mm abo							

**RENSON® Fabrications LTD**

Fairfax Units 1-5 • Bircholt Road • Parkwood Industrial Estate • Maidstone • Kent ME15 9SF  
 Tel: +44 (0) 1622/754123 • Fax: +44 (0)1622/689478 • Fax: + 44 (0)1622/689479 • info@rensonuk.net • www.renson.eu  
 Company Reg. No. 2993317 • Registered Office Maidstone • VAT Reg. No. GB 619 474 809

DELIVERY ADDRESS  
 -----

As invoice address

CP INTERIORS  
 RUE DES PRES. TRADING ESTATE  
 ST. SAVIOUR  
 JE2 7QN JERSEY  
 JERSEY

**ORDER CONFIRMATION : UK-60/08617**

Customer	Date confirm.	Prod.nr.	TAX	Page		eReps1171522
134872	11.04.19	616646	0,00%	2	EXPECTED SHIPPING DATE 29/5/2019	

Order details		Sizes Length	Ordered	Unit Price	%	Net	GBP
616646- Algarve Line							
-	Fixation holes	: WITH mounting holes					
-	P1 Construction situation	: Freestanding					
-	P2 Construction situation	: Freestanding					
-	S1 Construction situation	: Freestanding					
-	S2 Construction situation	: Freestanding					
-	D1 Lineo LED	: 3					
-	Lineo LED Colour of light	: Warm white light 3000K					
-	D1 S1 Light Up	: RGB					
-	D1 S2 Light Up	: RGB					
-	P1 Beam Heat/Sound	: 1 Beam with 1 Heat					
-	P2 Beam Heat/Sound	: 1 Beam with 1 Heat					
-	Beam Heat/Sound Receiver	: 1 Beam Heat/Sound receiver					
-	Handheld transmitter	: G6002774 Telis 16 RTS Pure					
-	Exhibition model	: No					
-	Seaside Quality A						
\$\$	616647- Algarve Line	4500x4200mm	1	18.636,53	40,00	11.181,92	
-	Seaside Quality A	'-> ** REF.: Algarve left side					
-	Colour blades: STR 0088 Frame	: STR 0088					
-	STR 0088 - AE03057702120 - Fine Texture RAL 7021 BLACK GR						
-	Passage height 2400 mm						
-	Adapter profile Adapter profile						
-	UpDown Span	: .					
-	Design	: Algarve					
-	Motorposition	: P2					
-	Blade rotation	: Sunprotection					
-	Drainage blade	: Non-motor side					
-	Roof type 1	: Blades					
-	1A Corner	: Column at the corner					
-	Overlength	: 150 mm					
-	Mounting base	: Visible mounting base					
-	Water drainage	: Pivot					
-	Height water drainage	: Drainage tube at 60 mm abo					
-	Fixation holes	: WITH mounting holes					
-	1B Corner	: Column at the corner					
-	Overlength	: 150 mm					
-	Mounting base	: Visible mounting base					

**RENSON® Fabrications LTD**

Fairfax Units 1-5 • Bircholt Road • Parkwood Industrial Estate • Maidstone • Kent ME15 9SF  
 Tel: +44 (0) 1622/754123 • Fax: +44 (0)1622/689478 • Fax: + 44 (0)1622/689479 • info@rensonuk.net • www.renson.eu  
 Company Reg. No. 2993317 • Registered Office Maidstone • VAT Reg. No. GB 619 474 809

DELIVERY ADDRESS

As invoice address

CP INTERIORS  
 RUE DES PRES. TRADING ESTATE  
 ST. SAVIOUR  
 JE2 7QN JERSEY  
 JERSEY

**ORDER CONFIRMATION : UK-60/08617**

Customer	Date confirm.	Prod.nr.	TAX	Page	eReps1171522
134872	11.04.19	616646	0,00%	3	EXPECTED SHIPPING DATE 29/5/2019

Order details	Sizes		Unit Price	%	Net	GBP
	Length	Ordered				
616647- Algarve Line						
- Water drainage	: Pivot					
- Height water drainage	: Drainage tube at 60 mm abo					
- Fixation holes	: WITH mounting holes					
- 2A Corner	: Column as repositioned col					
- Position	: 840 mm					
- Overlength	: 150 mm					
- Mounting base	: Visible mounting base					
- Fixation holes	: WITH mounting holes					
- 2B Corner	: Column as repositioned col					
- Position	: 840 mm					
- Overlength	: 150 mm					
- Mounting base	: Visible mounting base					
- Fixation holes	: WITH mounting holes					
- P1 Construction situation	: Freestanding					
- P2 Construction situation	: Freestanding					
- S1 Construction situation	: Freestanding					
- S2 Construction situation	: Freestanding					
- D1 Lineo LED	: 3					
- Lineo LED Colour of light	: Warm white light 3000K					
- D1 S1 Light Up	: RGB					
- D1 S2 Light Up	: RGB					
- P1 Beam Heat/Sound	: 1 Beam with 1 Heat					
- P2 Beam Heat/Sound	: 1 Beam with 1 Heat					
- Beam Heat/Sound Receiver	: 1 Beam Heat/Sound receiver					
- Exhibition model	: No					
- Seaside Quality A						
- Labelling						
\$\$ Glass panels Span 1 A1		1	4.007,00	40,00	2.404,20	
\$ Glass panels Span 2 A2		1	4.007,00	40,00	2.404,20	
\$. Glass panels Pivot 1 A1		1	2.875,00	40,00	1.725,00	
\$\$ Glass panels Pivot 2 A1		1	2.875,00	40,00	1.725,00	
\$\$ Glass panels Pivot 1 A2		1	2.875,00	40,00	1.725,00	
\$\$ Glass panels Pivot 2 A2		1	2.875,00	40,00	1.725,00	
\$\$ Glass panel between A1&A2 P1		1	1.623,00	40,00	973,80	
\$\$ Glass panel between A1&A2 P2		1	1.623,00	40,00	973,80	

**RENSON® Fabrications LTD**

Fairfax Units 1-5 • Bircholt Road • Parkwood Industrial Estate • Maidstone • Kent ME15 9SF  
 Tel: +44 (0) 1622/754123 • Fax: +44 (0)1622/689478 • Fax: + 44 (0)1622/689479 • info@rensonuk.net • www.renson.eu  
 Company Reg. No. 2993317 • Registered Office Maidstone • VAT Reg. No. GB 619 474 809

DELIVERY ADDRESS

As invoice address

CP INTERIORS  
 RUE DES PRES. TRADING ESTATE  
 ST. SAVIOUR  
 JE2 7QN JERSEY  
 JERSEY

**ORDER CONFIRMATION : UK-60/08617**

Customer	Date confirm.	Prod.nr.	TAX	Page	eReps1171522
134872	11.04.19	616646	0,00%	4	EXPECTED SHIPPING DATE 29/5/2019

Order details	Size	Ordered	Unit Price		Net	GBP
	Length			%		
A1: Lock Pivot 1&2 Type E						
\$\$ A1: Lock Pivot 1&2 Type E		2	71,47	40,00	85,76	
\$\$ A2: Lock Pivot 1&2 Type E		2	71,47	40,00	85,76	
\$\$ A1: Span 1: Lock A		1	71,47	40,00	42,88	
\$\$ A2: Span 2: Lock A		1	71,47	40,00	42,88	
\$\$ Between A1&A2 P1&P2: Lock C		2	164,06	40,00	196,87	
\$\$ Profile for glass for Algarve		1	723,16	40,00	433,90	

The delivery and payment terms are an integral part of our contract. See next page or visit [www.rensonuk.net/terms-and-conditions.html](http://www.rensonuk.net/terms-and-conditions.html)

CO=COLOUR - RAL = +- RAL

**TOTAL AMOUNT TAX EXCL. 37.025,23 GBP**

If this confirmation does not correspond to what you have ordered, please let us know immediately. In case you change or cancel your order, it will incur costs as fabrication has already started.