

Judy & Duncan Baxter SO12949

Please note, these units will be coupled as 1 full unit, the sketch programme just does not allow it at this stage, as is only very basic. Where part 2 on these visuals is connected to the wall on the left hand side of the diagram (with no posts), will actually be connected to the right hand side of part 1, back wall will be fixed to the house as with part 1.

Part 1

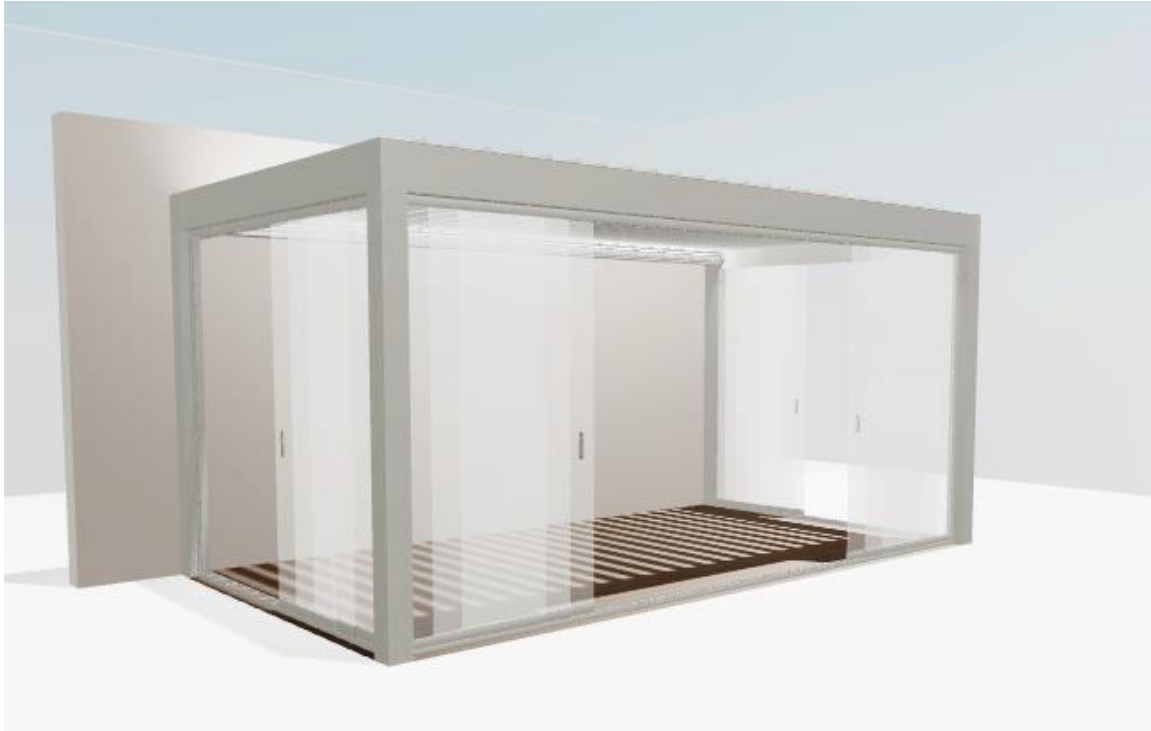

Part 2

