

1/ Foundation is subject to a later design by structural engineer.
 2/ Basement construction to BS 8102:2009 (clause 6.1) to achieve a Grade 3 environment using a type A (membrane) and Type B (Structural integral protection) construction methods.
 3/ Full radon protection will also be required.
 4/ Wall stability subject to a later calculation by Structural Engineer
 5/ Floor design is subject to a later design by structural engineer
 6/ Roof construction subject to a later design by structural engineer
 7/ The dwelling will be fitted throughout with a sprinkler system conforming to BS 9253:2014
 8/ The parking area will need a sprinkler system conforming with BS EN 12845:2015
 9/ All new elements of structure to achieve 30 minutes of fire resistance

Floor Design U-Value 0.08W/msqK
 Glazing U-Value 1.4W/msqK
 Roof Design U-Value 0.12W/msqK
 Walls Design U-Value 0.15W/msqK

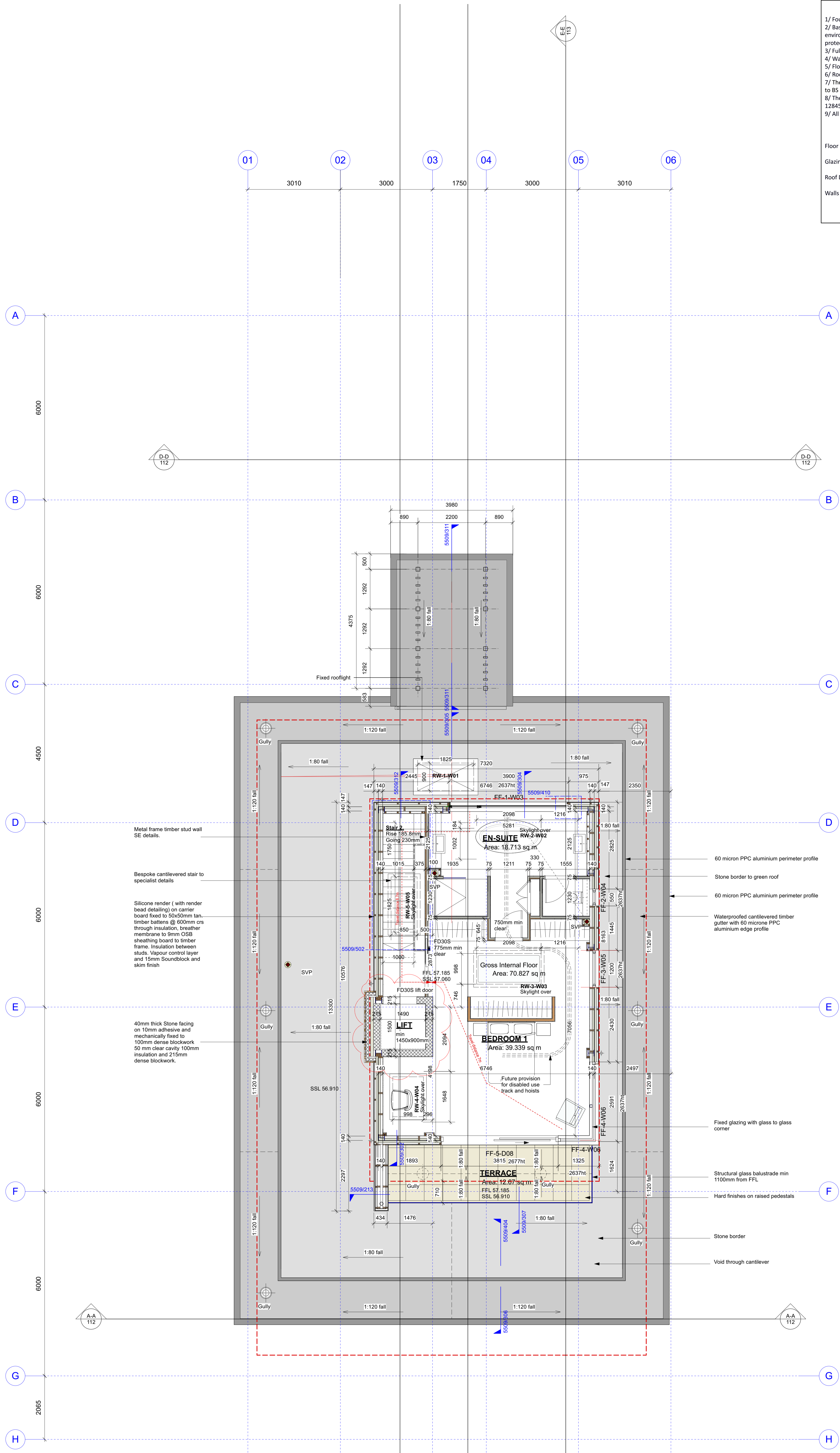

Metal frame timber stud wall SE details.

Bespoke cantilevered stair to specialist details

Silicone render (with render bead detailing) on carrier board fixed to 50x50mm tan timber battens @ 600mm c/s through insulation, breather membrane to 5mm OSB sheathing board to timber frame. Insulation between studs. Vapour control layer and 15mm Soundblock and skim finish

40mm thick Stone facing on 10mm adhesive and mechanically fixed to 100mm dense blockwork 50 mm clear cavity 100mm insulation and 215mm dense blockwork.

60 micron PPC aluminium perimeter profile

Stone border to green roof

60 micron PPC aluminium perimeter profile

Waterproofed cantilevered timber gutter with 60 micron PPC aluminium edge profile

Fixed glazing with glass to glass corner

Structural glass balustrade min 1100mm from FFL

Hard finishes on raised pedestals

Stone border

Void through cantilever

Area Schedule	
BEDROOM 1	39.339 sq m
EN-SUITE	18.713 sq m
TERRACE	12.67 sq m
Gross Internal Area	
Floor	Area (sqm)
Gross Internal Floor	70.827 sq m

FIRST FLOOR
SCALE 1:50

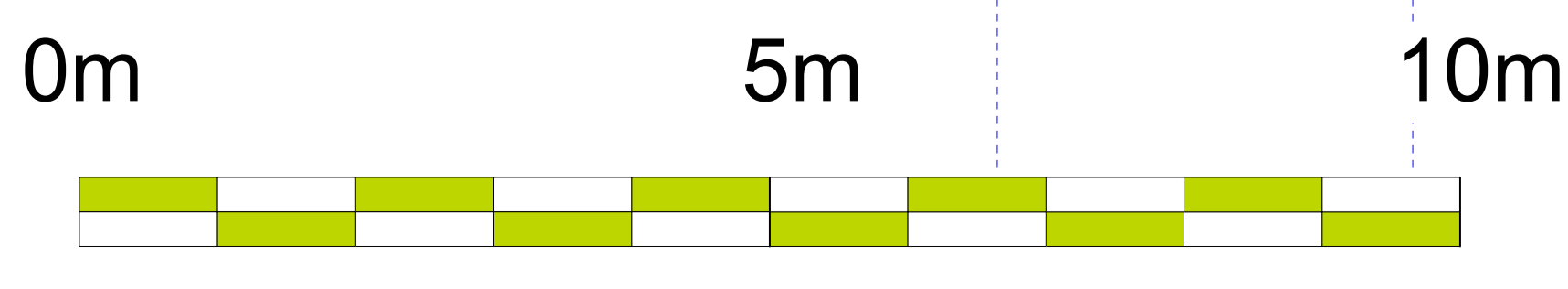

02/06/2021 F DK Amended IRI sheet size
 30/03/2021 E EP Window references amended, see revision history
 05/02/21 D SN Status changed, issued for tender
 Date: Rev: To: Revised Notes:

FOR CONSTRUCTION

Client: Saroor Ltd
 Project Title/Address: Cambray House
 Project Address:

Sheet Title: First Floor
 Date: March 2021
 Sheet Code: 5509-WA-00-01-DR-A-004 F
 Drawn By:

WADDINGTON
people-centred design

444010334 764788 +44201534 280000 +44201534 426222
 © Copyright Waddington Architects, Interior & Landscape
 All rights reserved. No part of this drawing may be reproduced, stored in a retrieval system, or transmitted in any form or by any means, electronic, mechanical, photocopying, recording, or by any information storage and retrieval system, without the prior written permission of Waddington Architects, Interior & Landscape. This drawing is provided for the specific project and site only. It is not to be used for any other project or site without the prior written permission of Waddington Architects, Interior & Landscape. No part of this drawing may be reproduced, stored in a retrieval system, or transmitted in any form or by any means, electronic, mechanical, photocopying, recording, or by any information storage and retrieval system, without the prior written permission of Waddington Architects, Interior & Landscape.