

- 1/ Foundation is subject to a later design by structural engineer.
 - 2/ Basement construction to BS 8102:2009 (clause 6.1) to achieve a Grade 3 environment using a type A (membrane) and Type B (Structural integral protection) construction methods.
 - 3/ Full radon protection will also be required.
 - 4/ Wall stability subject to a later calculation by Structural Engineer
 - 5/ Floor design is subject to a later design by structural engineer
 - 6/ Roof construction subject to a later design by Structural Engineer
 - 7/ The dwelling will be fitted throughout with a sprinkler system conforming to BS 9251:2014
 - 8/ The parking area will need a sprinkler system conforming with BS EN 12845:2015
 - 9/ All new elements of structure to achieve 30 minutes of fire resistance
- Floor Design U-Value 0.08W/msqK
 Glazing U-Value 1.4W/msqK
 Roof Design U-Value 0.12W/msqK
 Walls Design U-Value 0.15W/msqK

Area Schedule	
TERRACE	63.745 sq m
BEDROOM 4	23.884 sq m
BEDROOM 2	23.436 sq m
BEDROOM 3	20.24 sq m
BEDROOM 5	15.868 sq m
EN-SUITE	6.509 sq m
EN-SUITE	5.22 sq m
EN-SUITE	5.22 sq m
EN-SUITE	5.22 sq m
Gross Internal Area	172.477 sq m
Floor	Area (sqm)
Gross Internal Floor	172.477 sq m

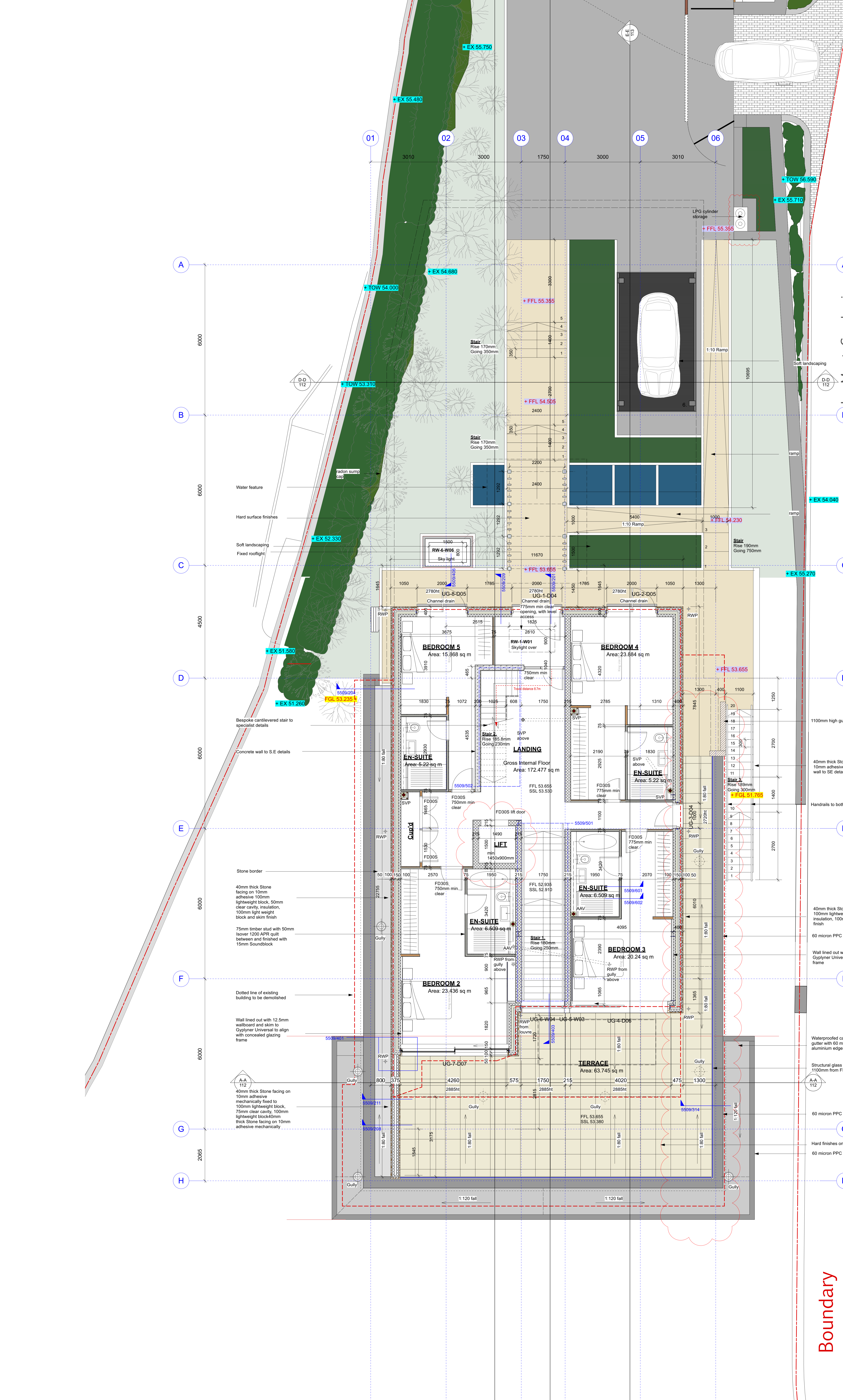

- Le Mont Cambrai**
- 1100mm high guarding
- 40mm thick Stone facing on 10mm adhesive to relating wall to SE detail.
- Handrails to both sides
- 40mm thick Stone facing on 10mm adhesive 100mm lightweight block, 50mm clear cavity, insulation, 100mm light weight block and skim finish
- 60 micron PPC aluminium perimeter profile
- Wall lined out with 12.5mm wallboard and skim to Gyplyner Universal to align with concealed glazing frame
- Waterproofed cantilevered timber gutter with 60 micron PPC aluminium edge profile.
- Structural glass balustrade min 1100mm from FFL
- 60 micron PPC aluminium perimeter profile
- Hard finishes on raised pedestals
- 60 micron PPC aluminium perimeter profile

UPPER GROUND FLOOR
SCALE 1:50

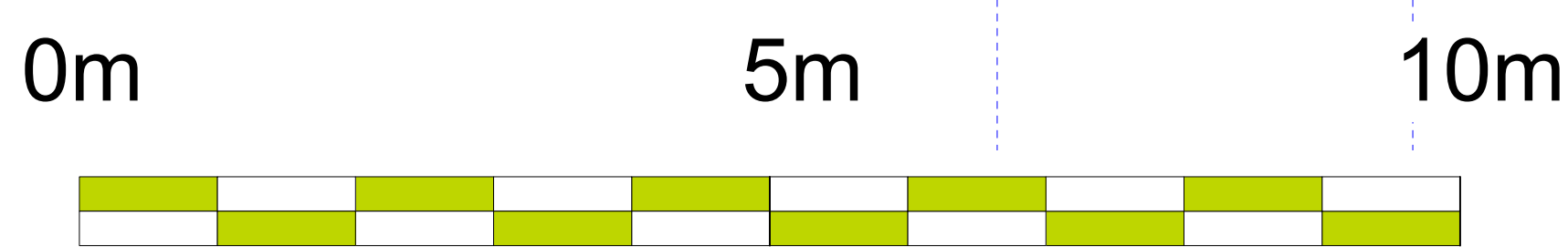

14/03/2021 G OK Amended Floor Plan 2 gip columns
 13/03/2021 F OK Added notes office to drawing
 05/02/21 E SV Status changed, issued for tender
 01/02/21 M SV Revised Notes

FOR CONSTRUCTION

Client: Sioron Ltd
 Project Title/Address: Cambrai House
 Project Address: [Redacted]

When To: Upper Ground Floor
 Date: March 2021
 Drawn By: 5509-WA-00-00-DR-A-003 G
 Checked By: [Redacted]

WADDINGTON
people-centred design

44001034 760788 44001034 280700 44001034 426222

© Copyright Waddington Architects, Interior & Landscape
 All rights reserved. No part of this drawing may be reproduced, stored in a retrieval system, or transmitted in any form or by any means, electronic, mechanical, photocopying, recording, or by any information storage and retrieval system, without the prior written permission of Waddington Architects. This drawing is prepared for the specific project and site only. It is not to be used for any other project or site. All dimensions shall be checked on site. Do not scale from drawings. All dimensions shall be checked on site.

Original design by Marc Medard Architects P/2018/1702