

21 October 2020

Our Ref: 5935

Attn: Adrian  
 CP Interiors  
 Unit 28, Rue des Pres Trading Estate  
 St Saviour  
 Jersey  
 JE2 7QN

T: 07797 715 454  
 E: [adrian@cpinteriors.ie](mailto:adrian@cpinteriors.ie)

Dear Adrian

**Re: DASH Modular Shelters for CP Interiors**

Thank you for your recent enquiry, please see below our outline brief and costings.

**Project outline:**

To provide modular shelters to CP Interiors to protect customers during wet weather conditions, enhancing the customer experience. We have priced both DASH options for you.

<b>DASH Shelter</b>				
Line	Qty	Description	Unit Price	Total Price
1	1	Starter Bay	£699.00	£699.00
2	1	Add-On Bay	£399.00	£449.00
3	1	Bespoke Advertising Banners (Ea)	£75.00	£75.00
4	0	No allowance for Weights. DASH needs 48 kg per leg.	£0.00	£0.00
5	1	Carriage - Priced ex works	£0.00	£0.00
<b>Total</b>				<b>£1,223.00</b>

2m STARTER      2m ADDON      1.2m ADDON

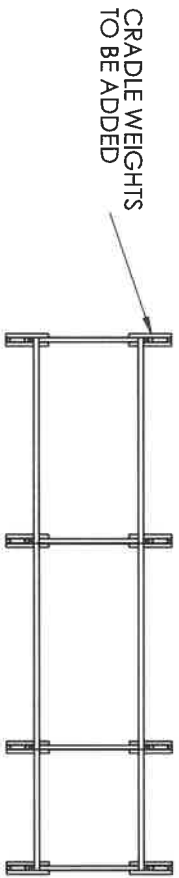

CLIENT LOGO & CONTACT INFO LASER CUT HERE

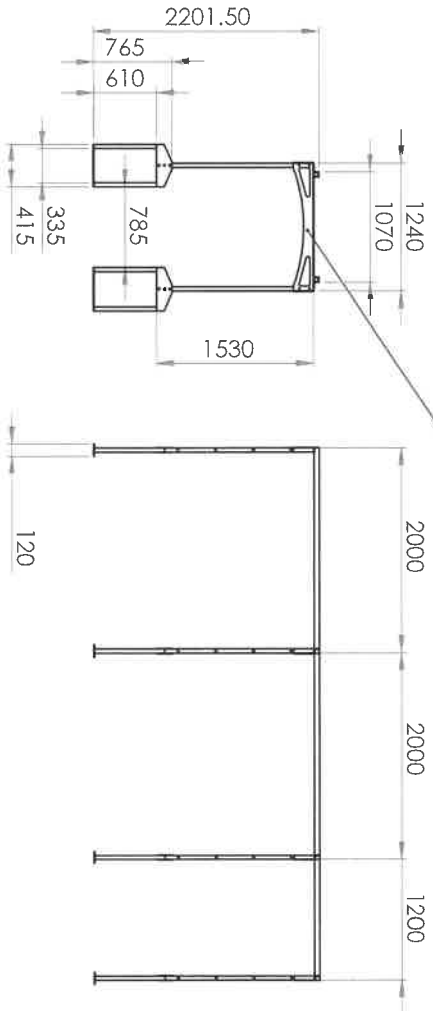

ITEM NO.	PART NUMBER	QTY.
1	Component 1	4
2	Cradle Base Plate	8
3	Cradle Fixing Plate	16
4	685 Box	16
5	Cradle Leg	8
6	Component 4 Box	2
7	Component 4&5 Fin Plate	8
8	Component 5 Box	2
9	Component 5 Channel Connection	4
10	Component 5 1.2 Box	2

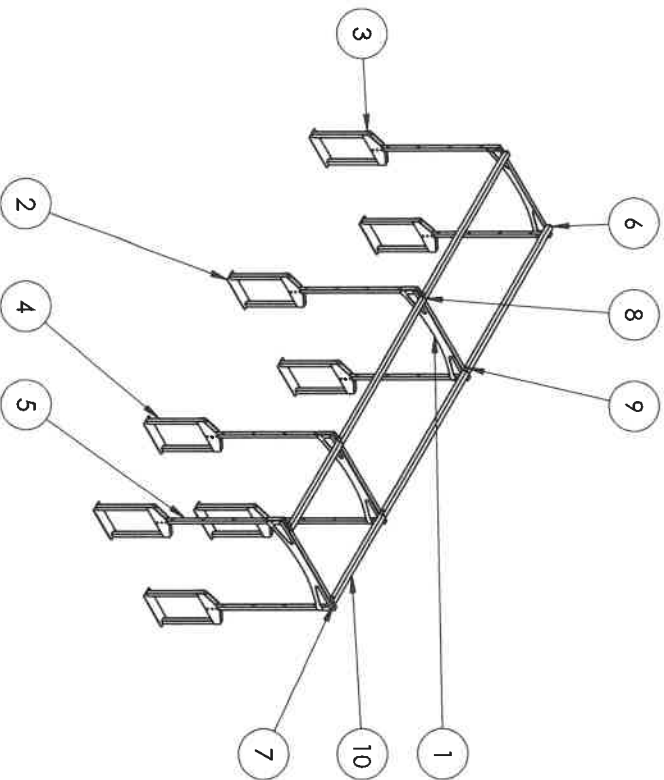

60

GP INTERIORS

01534 768141

www.gpinteriors.je

440

UNLESS OTHERWISE SPECIFIED: DIMENSIONS ARE IN MILLIMETERS		FINISH: PAINT: NIGHT BLUE RAL 5022		DEBUR AND BREAK SHARP EDGES		DO NOT SCALE DRAWING		REVISION	
DATE:	24/11/2000	DATE:	24/11/2000						
DRAWN BY:	MANNON	DRAWN BY:	MANNON						
CHECKED BY:	LOCKER	CHECKED BY:	LOCKER						
APPROVED BY:		APPROVED BY:							
MFG:		MFG:		VARIOUS					
G.A.:		G.A.:		VARIOUS					
TITLE: <b>DALE OFFICE DASH XL SHELTER</b>				DWG NO.:		SCALE:		SHEET 1 OF 1	
DASH XL Combined Drawing				A3					

2m STARTER      2m ADDON      1.2m ADDON

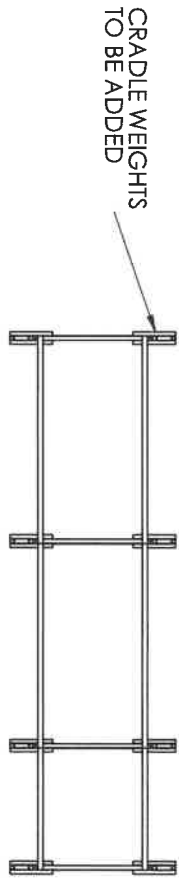

CRADLE WEIGHTS  
TO BE ADDED

CLIENT LOGO &  
CONTACT INFO  
LASER CUT HERE

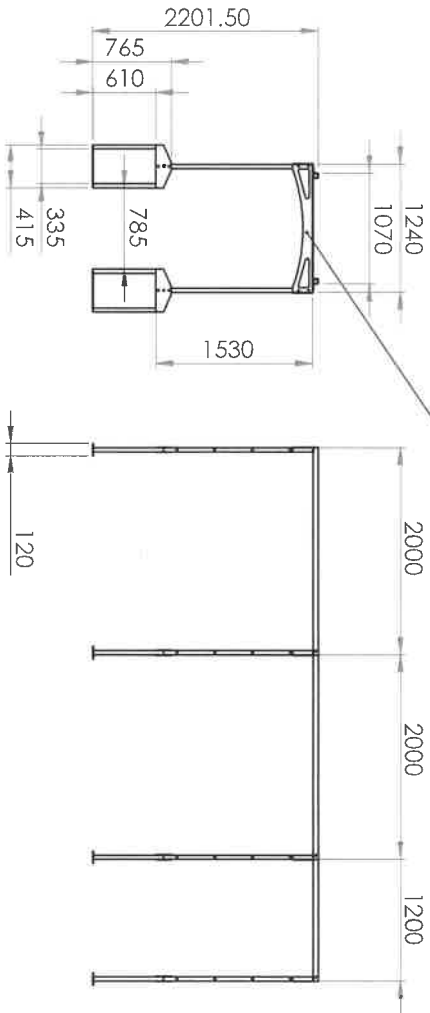

ITEM NO.	PART NUMBER	QTY.
1	Component 1	4
2	Cradle Base Plate	8
3	Cradle Fixing Plate	16
4	685 Box	16
5	Cradle Leg	8
6	Component 4 Box	2
7	Component 4&5 Fin Plate	8
8	Component 5 Box	2
9	Component 5 Channel Connection	4
10	Component 5 1.2 Box	2

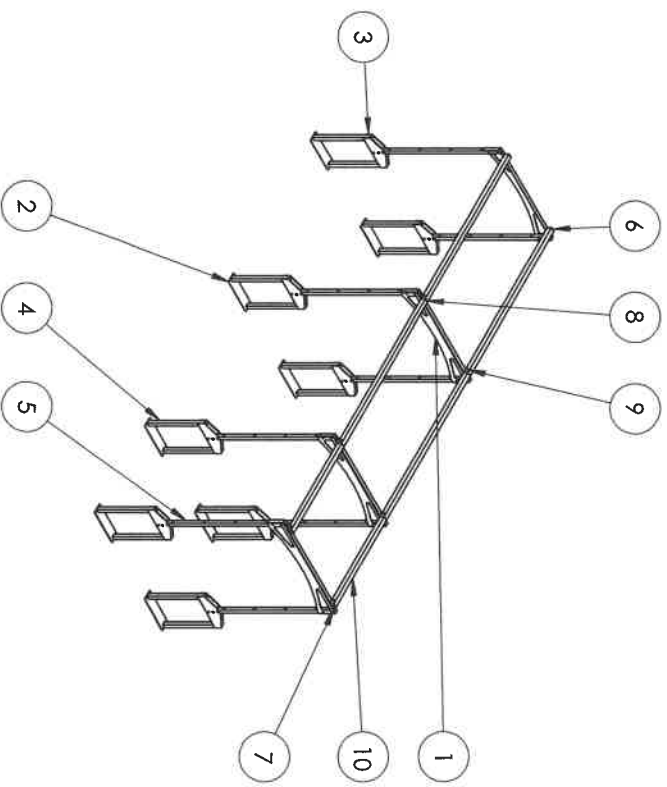

60

CP INTERIORS

CP

01534 768141

www.cpinteriors.ie

440

DATE OF ISSUE:	12/11/2020	FINISH:	PAINT NIGHT BLUE	DRAWING AND REVISIONS:	
DIMENSIONS ARE IN MILLIMETERS		SURFACE FINISH:	RAL 5022	TOLERANCES:	
ANGLE:					
NAME:	MAHON	SIGNATURE:		DATE:	12/11/2020
DRAWN BY:	LICKER	CHECKED BY:		DATE:	12/11/2020
APPROVED BY:					
SCALE:		MATERIAL:	VARIOUS	WEIGHT:	
TITLE:			DALE OFFICE DASH XL SHELTER		
DWG NO.:			Dash XL Combined Drawing		
SCALE:			A3		
SHEET:			SHEET 1 OF 1		

2m STARTER      2m ADDON      1.2m ADDON

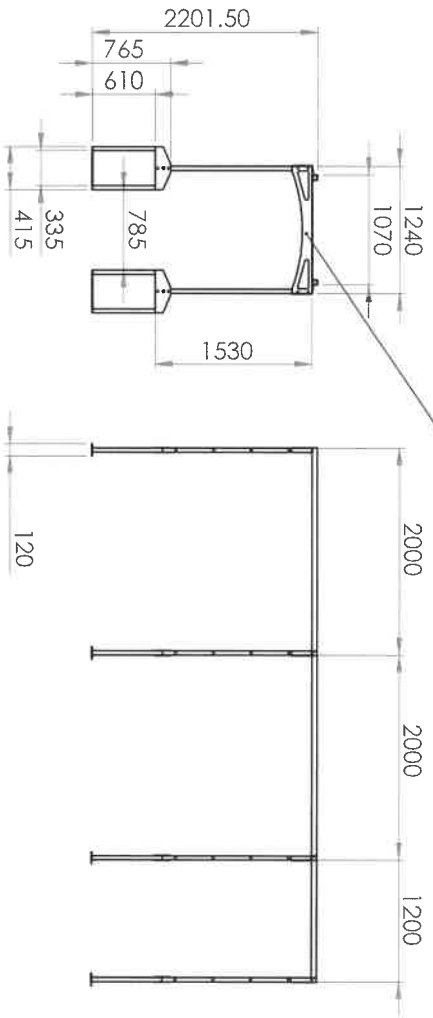
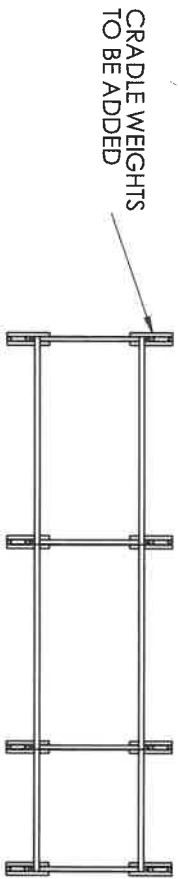

ITEM NO.	PART NUMBER	QTY.
1	Component 1	4
2	Cradle Base Plate	8
3	Cradle Fixing Plate	16
4	685 Box	16
5	Cradle Leg	8
6	Component 4 Box	2
7	Component 4&5 Fin Plate	8
8	Component 5 Box	2
9	Component 5 Channel Connection	4
10	Component 5 1.2 Box	2

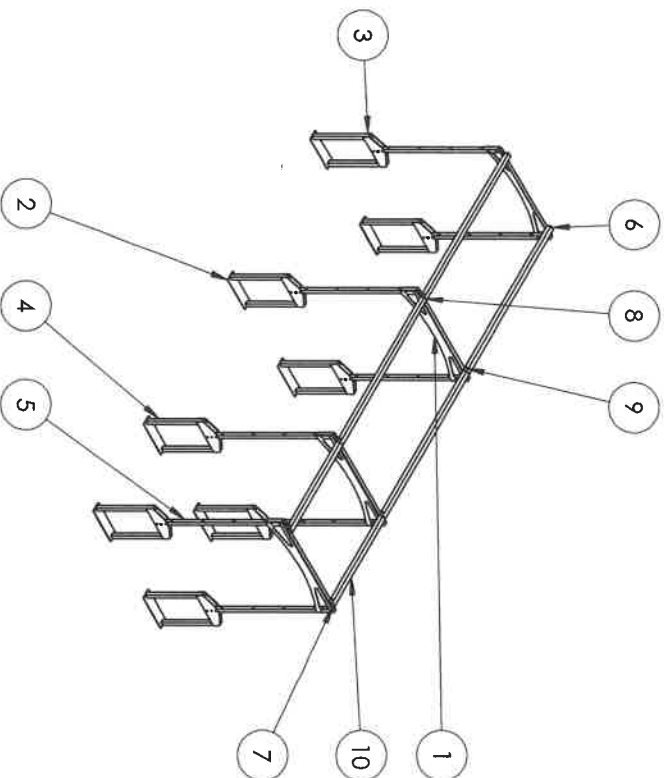

60

CP INTERIORS

01534 768141

www.cpinteriors.ie

440

UNLESS OTHERWISE SPECIFIED: DIMENSIONS ARE IN MILLIMETERS TOLERANCES: LINEAR: ANGULAR:		FINISH: PAINT: NIGHT BLUE RAL 5022	DEBUR AND BREAK SHARP EDGES	DO NOT SCALE DRAWING	REVISION
NAME: MAIYON	SIGNATURE:	DATE: 12/11/2020		TITLE: DALE OFFICE DASH XL SHELLTER	
CHKD: L'CAER		DATE: 12/11/2020		DWG NO: Dash XL Combined Drawing	
MFG: CA				SCALE: 1:50	SHEET 051
MATERIAL: VARIOUS					A3

2m STARTER      2m ADDON      1.2m ADDON

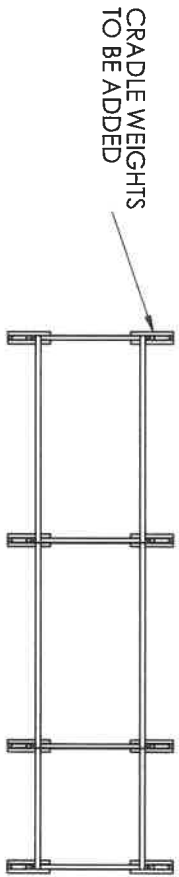

CLIENT LOGO & CONTACT INFO LASER CUT HERE

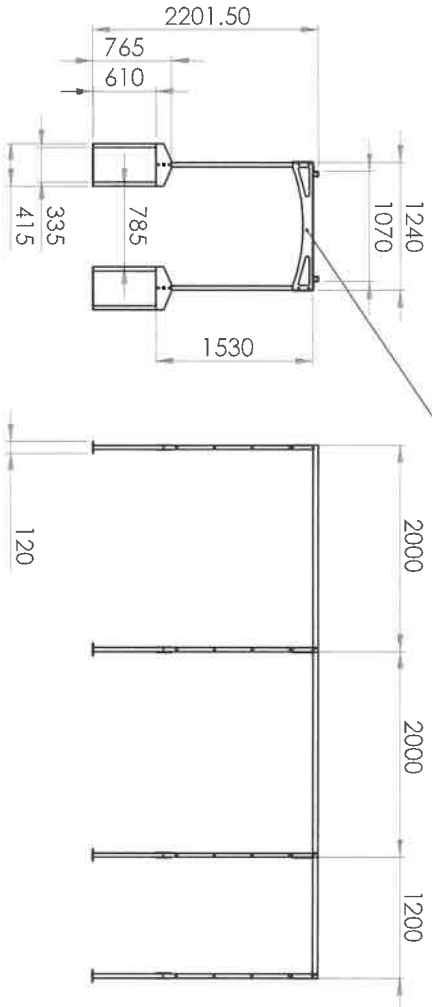

ITEM NO.	PART NUMBER	QTY.
1	Component 1	4
2	Cradle Base Plate	8
3	Cradle Fixing Plate	16
4	685 Box	16
5	Cradle Leg	8
6	Component 4 Box	2
7	Component 4&5 Fin Plate	8
8	Component 5 Box	2
9	Component 5 Channel Connection	4
10	Component 5 1.2 Box	2

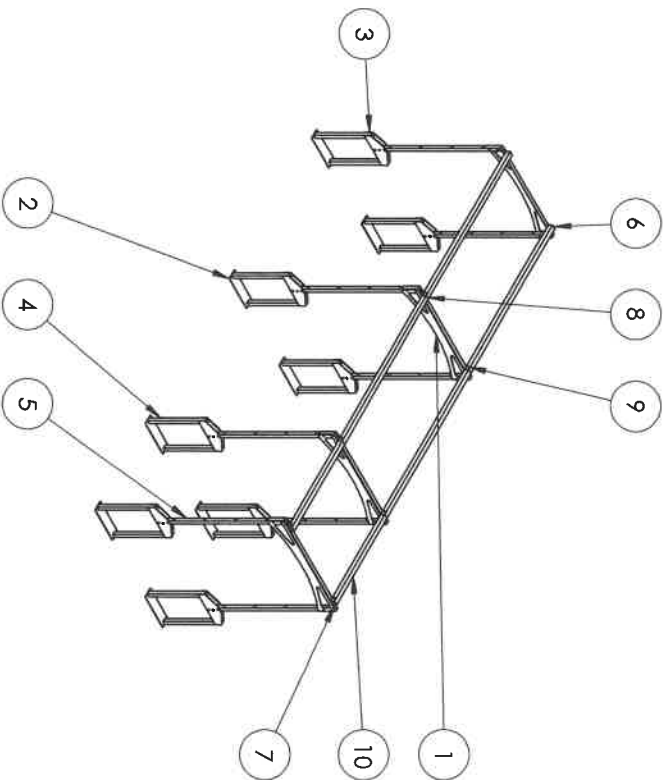

60

**CP**

**CP INTERIORS**

01534 768141

www.cpinteriors.ie

440

UNLESS OTHERWISE SPECIFIED: DIMENSIONS ARE IN MILLIMETERS		FINISH: PAINT: NIGHT BLUE RAL 5022		DEBUR AND BREAK SHARP EDGES		DO NOT SCALE DRAWING		REVISION	
SURFACE FINISH: POLYURETHANE		DRAWN: MANNON		DATE: 12/11/2020		TITLE: <b>DALE OFFICE DASH XL SHELTER</b>			
ANGULARS:		NAME: MANNON		DATE: 12/11/2020		DASH XL Combined Drawing			
CHECKED: LOARF		SIGNATURE:		DATE: 12/11/2020		SCALE: 1:30			
APPROVED: MFG		DATE:		MATERIAL: VARIOUS		SHEET 01/1			
C.A.:		WEIGHT:		VARIOUS		A3			

**Fiona Potts**

**From:** Fiona Potts  
**Sent:** 05 November 2020 13:51  
**To:** david.bricknell@daleoffice.co.uk  
**Cc:** Adrian Colston-Weeks  
**Subject:** Order SO10722 - JT  
**Attachments:** Screen Shot 2020-11-04 at 13.14.26.png; 76778 CP Interiors - Logo For Queue Shelter v1.eps; 5935 - CP Interiors.pdf

**Importance:** High

**Follow Up Flag:** Follow up  
**Flag Status:** Flagged

Hello David

**Your Reference: 005935**

Further to your conversation with Adrian earlier this week

Can we please place and order the following:

Shelter as priced in the quotation

We need it 5200 mm long , 2m + 2m + 1.2m pieces

Colour and our logo. See below for colour and attached is our vector logo, positioning as per our mock up

Plus no advertising banners,, system to have adjustable feet.

The blocks are used to hold it down, I am sure we can source locally save shipping heavy blocks.

This is the colour they would like – this is based on their marketing – I would guess Night Blue 5022 Ral equivalent

**Fiona Potts**

**From:** David Bricknell <david.bricknell@daleoffice.co.uk>  
**Sent:** 12 November 2020 17:05  
**To:** Adrian Colston-Weeks  
**Cc:** Fiona Potts  
**Subject:** RE: Order SO10722 - JT

Thanks

Will do

Regards

**David Bricknell**  
Managing Director

**t:** 0114 233 1115  
**m:** 07848 452 929  
**e:** david.bricknell@daleoffice.co.uk  
**w:** www.daleoffice.co.uk

**From:** Adrian Colston-Weeks <Adrian@cpiinteriors.ie>  
**Sent:** 12 November 2020 16:49  
**To:** David Bricknell <david.bricknell@daleoffice.co.uk>  
**Cc:** Fiona Potts <Fiona@cpiinteriors.ie>  
**Subject:** RE: Order SO10722 - JT

Hi David

Please proceed,

Many thanks



Adrian Colston-Weeks  
Director



Tel: (01534) 768141  
[www.cpiinteriors.ie](http://www.cpiinteriors.ie)  
Rue des Pres Trading Estate, St Savour, Jersey, JE2 7QN  
Blinds | Curtains | Awnings | Shutters | Furnishings | Interior Design | Project Management

Cc: Fiona Potts <Fiona@cpinteriors.ie>  
Subject: RE: Order SO10722 - JT

Thanks

Do those dimensions below work for you?

If so, I'll get drawings amended for final sign off.

Regards

**David Bricknell**  
Managing Director

t: 0114 233 1115  
m: 07848 452 929  
e: david.bricknell@daleoffice.co.uk  
w: www.daleoffice.co.uk

From: Adrian Colston-Weeks <Adrian@cpinteriors.ie>  
Sent: 12 November 2020 12:45  
To: David Bricknell <david.bricknell@daleoffice.co.uk>  
Cc: Fiona Potts <Fiona@cpinteriors.ie>  
Subject: RE: Order SO10722 - JT

Hi David

Lets do that, thanks



Adrian Colston-Weeks  
Director



CP INTERIORS

Tel: (01534) 768141  
[www.cpinteriors.ie](http://www.cpinteriors.ie)  
Rue des Pres Trading Estate, St Savour, Jersey, JE2 7QN  
Blinds | Curtains | Awnings | Shutters | Furnishings | Interior Design | Project Management

From: David Bricknell <david.bricknell@daleoffice.co.uk>  
Sent: Thursday, 12 November 2020 12:40  
To: Adrian Colston-Weeks <Adrian@cpinteriors.ie>  
Subject: RE: Order SO10722 - JT

Adrian

**t:** 0114 233 1115  
**m:** 07848 452 929  
**e:** [david.bricknell@daleoffice.co.uk](mailto:david.bricknell@daleoffice.co.uk)  
**w:** [www.daleoffice.co.uk](http://www.daleoffice.co.uk)

**From:** Adrian Colston-Weeks <[Adrian@cpinteriors.ie](mailto:Adrian@cpinteriors.ie)>  
**Sent:** 12 November 2020 11:12  
**To:** David Bricknell <[david.bricknell@daleoffice.co.uk](mailto:david.bricknell@daleoffice.co.uk)>; Fiona Potts <[Fiona@cpinteriors.ie](mailto:Fiona@cpinteriors.ie)>  
**Subject:** Re: Order SO10722 - JT

Hi Dave

Sorry, can you remind me of why we have to have XI.  
And the drawing doesn't show adjustable legs.  
I also have a concern over the central pathway being restricted to 785. This is very narrow for disabled access. Can this be changed to maybe allow the weights to be completely out side the passage.

Thanks.  
Adrian

[Get Outlook for IOS](#)

---

**From:** David Bricknell <[david.bricknell@daleoffice.co.uk](mailto:david.bricknell@daleoffice.co.uk)>  
**Sent:** Thursday, November 12, 2020 9:26:54 AM  
**To:** Fiona Potts <[Fiona@cpinteriors.ie](mailto:Fiona@cpinteriors.ie)>  
**Cc:** Adrian Colston-Weeks <[Adrian@cpinteriors.ie](mailto:Adrian@cpinteriors.ie)>  
**Subject:** RE: Order SO10722 - JT

Hello Fiona

Please find our drawings attached for your review and sign off.  
These drawings don't include the 10mm composite roof panel.  
On drawing sign off we will commence manufacture.

Regards

**David Bricknell**  
Managing Director

**t:** 0114 233 1115  
**m:** 07848 452 929  
**e:** [david.bricknell@daleoffice.co.uk](mailto:david.bricknell@daleoffice.co.uk)  
**w:** [www.daleoffice.co.uk](http://www.daleoffice.co.uk)

**From:** Fiona Potts <[Fiona@cpinteriors.ie](mailto:Fiona@cpinteriors.ie)>  
**Sent:** 09 November 2020 08:33  
**To:** David Bricknell <[david.bricknell@daleoffice.co.uk](mailto:david.bricknell@daleoffice.co.uk)>  
**Subject:** RE: Order SO10722 - JT



CP INTERIORS

Tel: (01534) 768141  
[www.cpiinteriors.ie](http://www.cpiinteriors.ie)  
Rue Des Pres Trading Estate, St Savour, Jersey, JE2 7QN

Blinds | Curtains | Awnings | Shutters | Furnishings | Interior Design | Project Management

---

**From:** David Bricknell <[david.bricknell@daleoffice.co.uk](mailto:david.bricknell@daleoffice.co.uk)>  
**Sent:** 06 November 2020 13:29  
**To:** Fiona Potts <[Fiona@cpiinteriors.ie](mailto:Fiona@cpiinteriors.ie)>  
**Subject:** RE: Order SO10722 - JT

I'm sure it well.

Many thanks

**David Bricknell**  
Managing Director

**t:** 0114 233 1115  
**m:** 07848 452 929

**e:** [david.bricknell@daleoffice.co.uk](mailto:david.bricknell@daleoffice.co.uk)  
**w:** [www.daleoffice.co.uk](http://www.daleoffice.co.uk)

---

**From:** Fiona Potts <[Fiona@cpiinteriors.ie](mailto:Fiona@cpiinteriors.ie)>  
**Sent:** 06 November 2020 13:17

**To:** David Bricknell <[david.bricknell@daleoffice.co.uk](mailto:david.bricknell@daleoffice.co.uk)>  
**Subject:** FW: Order SO10722 - JT

Please see attached ..  
Is this all ok ?

Best Regards

Fiona

**Fiona Potts**  
Head of Customer Service and Business Development

**David Bricknell**  
Managing Director  
t: 0114 233 1115  
m: 07848 452 929  
e: david.bricknell@daleoffice.co.uk  
w: www.daleoffice.co.uk

Regards

Fiona, do you have .DXF file for the logo please?

**From:** David Bricknell <david.bricknell@daleoffice.co.uk>  
**Sent:** 06 November 2020 12:49  
**To:** Fiona Potts <Fiona@cpiinteriors.ie>  
**Cc:** Adrian Colston-Weeks <Adrian@cpiinteriors.ie>  
**Subject:** RE: Order SO10722 - JT

Blinds | Curtains | Awnings | Shutters | Furnishings | Interior Design | Project Management

Tel: (01534) 768141  
www.cpiinteriors.ie  
Rue Des Pres Trading Estate, St Savour, Jersey, JE2 7QN



**Fiona Potts**  
Head of Customer Service and Business Development

Fiona

Best Regards

Sorry I was asked for vector eps file  
I will have to see if the agency can cover for me ..  
Leave it with me

**From:** Fiona Potts  
**Sent:** 06 November 2020 12:50  
**To:** David Bricknell <david.bricknell@daleoffice.co.uk>  
**Subject:** RE: Order SO10722 - JT

- Price is ex works, as Adrian was going to collect from our Warehouse at S6 1QS. – we will need to arrange shipping to Jersey are you able to delivery to DSV Fareham 10 Brunel Way, Fareham, PO15 5TX Directions ?  
I will arrange from there

If you can approve all the above, we can arrange for the deposit invoice to be sent across and manufacture drawings to be completed. – if you can send to myself and I will pass to accounts

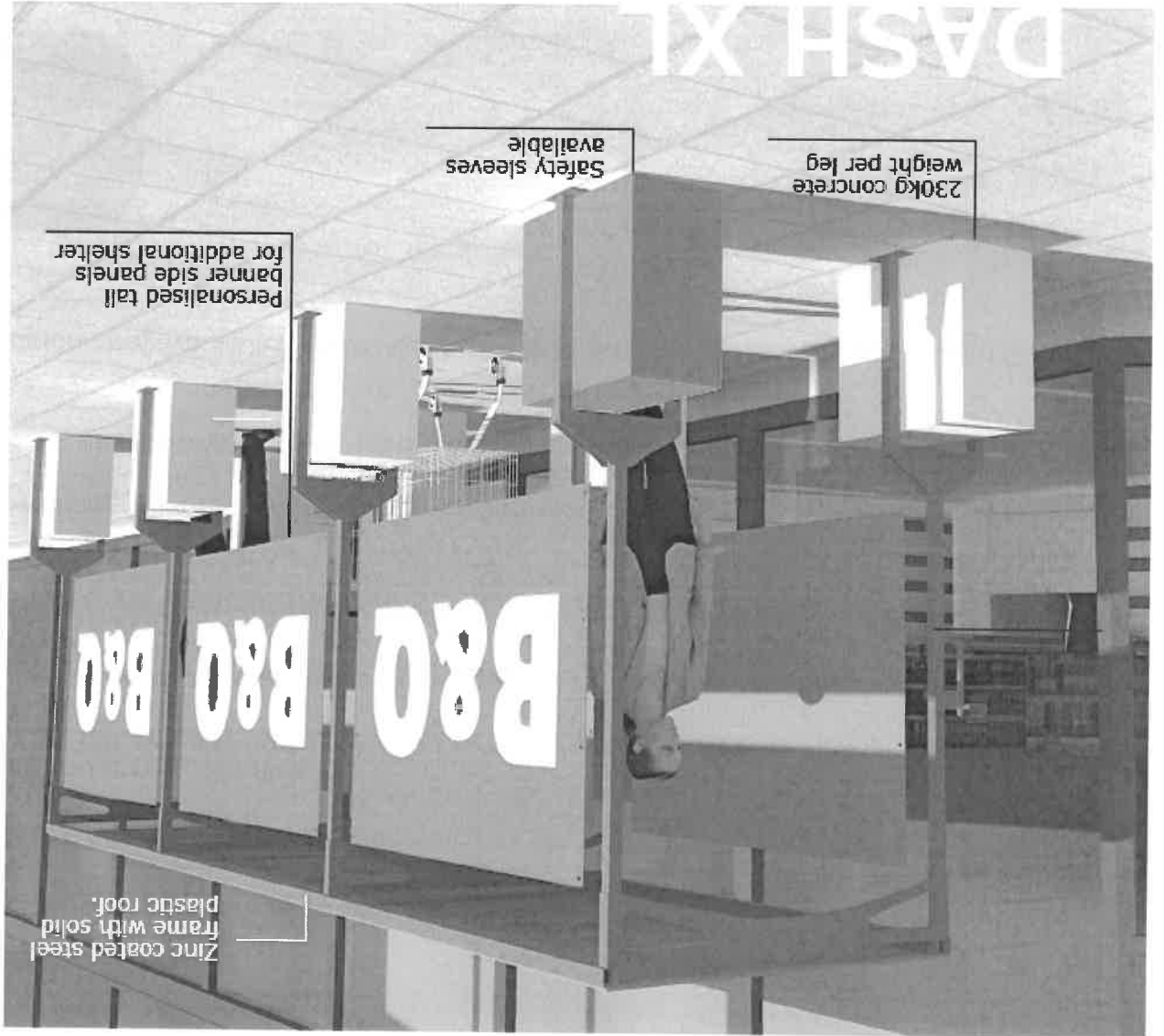

Regards

**David Bricknell**  
Managing Director

t: 0114 233 1115

m: 07848 452 929

e: david.bricknell@daleoffice.co.uk

Thanks in advance

Best Regards

Fiona

**Fiona Potts**

**Head of Customer Service and Business Development**



**CP INTERIORS**

Tel: (01534) 768141

[www.cpiinteriors.ie](http://www.cpiinteriors.ie)

Rue Des Pres Trading Estate, St Saviour, Jersey, JE2 7QN

Blinds | Curtains | Awnings | Shutters | Furnishings | Interior Design | Project Management