

Required Dims :

Sail 02	Sail 02 cntd.
AB 820	AD 2260
BC 880	BD 1740
CD 1500	BH 1700
DE 1445	CH 2265
EF 880	DH 1710
FG 815	DF 1685
GH 1450	DG 2220
HA 1495	EH 2250
	FH 1675

Sail 03
JH 1492
HK 1450
KL 825
LM 785
MN 500
NP 885
PQ 960
QJ 2680

JL 3050
JM 3350
JN 3760
JP 3165
HL 1670
HM 2170
HN 2800
HP 2510
HQ 2510
KQ 3080
LP 1860
MP 1235

Sail 04
JQ 2680
QR 1065
RS 1070
SJ 2690
JR 2400



- SURVEY CHECKLIST: \*\*\*to be completed on site\*\*\***
- All lower fitting points should be fixed to the vertical fascia with G and K either side of the metal beam.
  - Check if the metal beam is aluminium or steel. If aluminium and happy to drill into it, then fit A, B and C to its bottom face. If steel or unable to drill, then fit A to the white wooden beam to the side of the metal beam and B and C to the underside of the roof glazing beams.
  - Fit J to the underside of the ridge as close to the metal beam as possible.
  - Fit points Q & S in line with the other fittings on the front fascia and R to the underside of the roof glazing beam.
  - All intermediate points to be fitted in-line with the roof glazing beams.

Confirmation required for the following:

- Colour of Fabric **SX Solid Ivory**
- Colour of Fittings .....

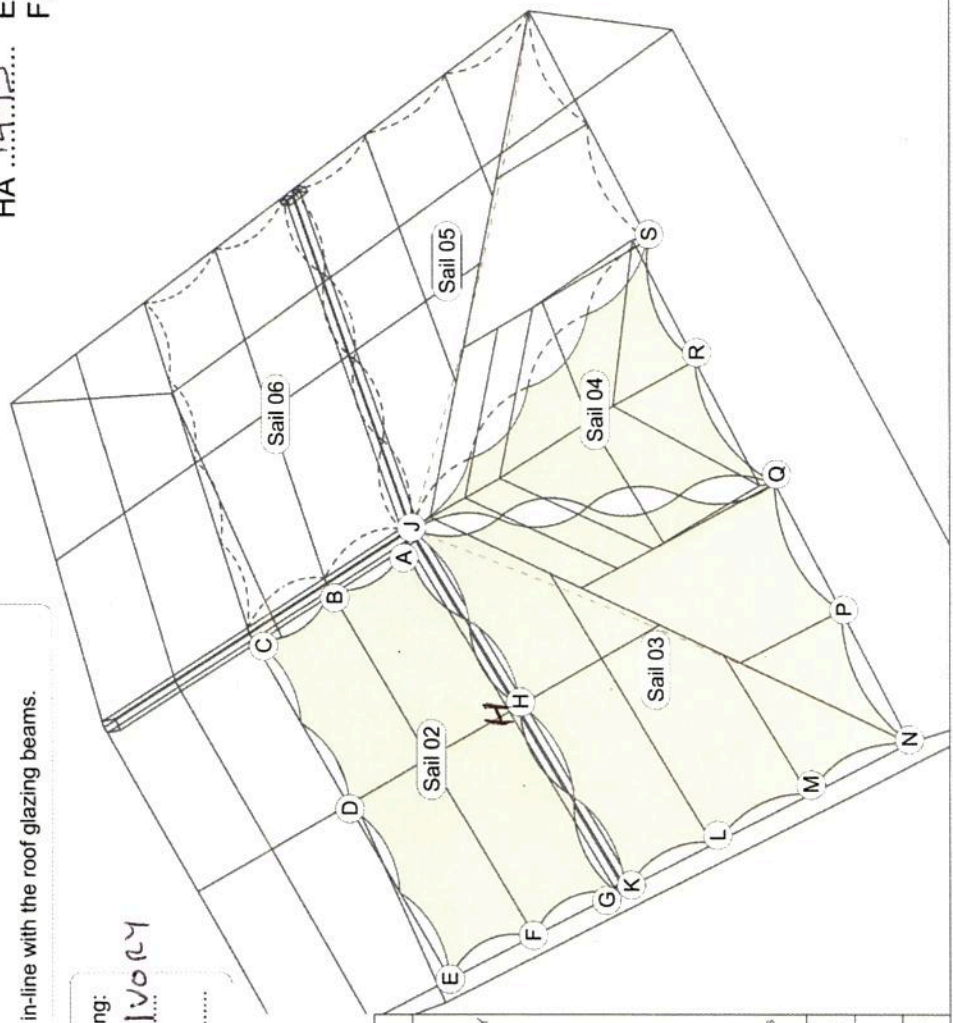

Notes:	
Survey points to be taken from point on conservatory where eye plates are to be fixed	
MARK ALL POINTS BEFORE COMMENCING SURVEY	
Dimensions should be taken as accurately as possible ideally +/-5mm	
Any queries regarding this please contact us on 01786 450083	
Design Shows: 5 x Made to Measure InShade Sails - ISX - TBC (Sails are shown in Ivory for design clarity)	
Obstructions: Deep Beams	
Special Fittings: None	
Some sails may require a colour matched seam, this will be confirmed on receipt of final dimensions.	
t: 01786 450083	e: inshade@shadepius.co.uk
Project: 72292-7994-McPhail	
Date: 07.02.20	Drawn: JH
	Check: AB



**Required Dims :**

<b>Sail 05</b>	<b>Sail 05 cntd.</b>	<b>Sail 06</b>
JS 269.0	JT 317.0	D1-E1 149.0
ST 95.0	JU 377.0	E1-X1 144.5
TU 29.0	JV 335.0	X1-Y 82.5
UV 80.5	JW 305.0	YZ 88.0
VW 78.5	SX 307.0	Z-A1 145.5
WX 81.5	SW 247.5	A1-B1 149.5
X-E1 145.0	S-E1 249.0	B1-C1 88.0
E1-J 149.0	TV 124.0	C1-D1 82.0
	T-E1 25.0	
	U-E1 279.0	D1-A1 226.0
	V-E1 216.0	E1-Y 167.0
	W-E1 166.5	E1-A1 170.0
		E1-B1 224.5
		E1-C1 170.0
		X1-A1 222.0
		Y-A1 168.5
		A1-C1 174.0
		A1-D1 226.0

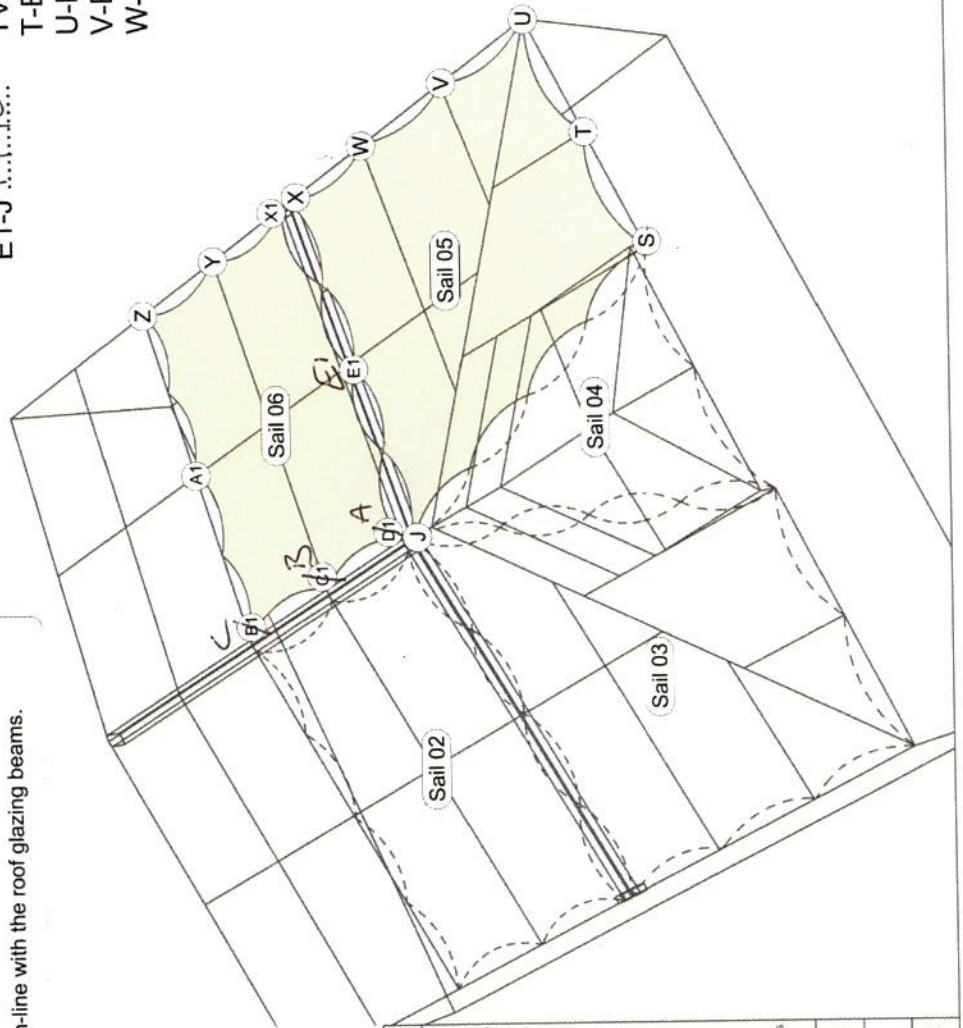

**SURVEY CHECKLIST: \*\*\*to be completed on site\*\*\***

- All lower fitting points should be fixed to the vertical fascia with X and X1 either side of the metal beam.
- Check if the metal beam is aluminium or steel. If aluminium and happy to drill into it, then fit D1, C1 and B1 to its bottom face. If steel or unable to drill, then fit D1 to the white wooden beam to the side of the metal beam and C1 and D1 to the underside of the roof glazing beams.
- Fit J to the underside of the ridge as close to the metal beam as possible.
- Fit point S in line with the other fittings on the front fascia.
- All intermediate points to be fitted in-line with the roof glazing beams.

**Notes:**  
 Survey points to be taken from point on conservatory where eye plates are to be fixed.

**MARK ALL POINTS BEFORE COMMENCING SURVEY**  
 Dimensions should be taken as accurately as possible ideally +/-5mm

Any queries regarding this please contact us on 01786 450083

**Design Shows:**  
 5 x Made to Measure InShade Sails - ISX - TBC  
 (Sails are shown in Ivory for design clarity)

**Obstructions:** Deep Beams  
**Special Fittings:** None

Some sails may require a colour matched seam, this will be confirmed on receipt of final dimensions.

t : 01786 450083	e : inshade@shadepius.co.uk	
Project: 72292-7994-McPhail		
Date: 07.02.20	Drawn: JH	Check: AB