

Plot Numbers & Handing:
 AS - 2, 3, 4, 92, 93, 94, 135
 OPP - 64, 71, 99, 100, 101, 129, 134

Revision Schedule		
Rev	Date	Description
E	17 May 2019	See Amendment Schedule

Wall Legend

	Standard External Insulated Cavity Wall 102.5mm facing brickwork 100mm cavity filled with blown mineral fibre insulation 100mm aerated concrete block (2.9N/mm ²) 12.5mm gypsum board on adhesive dabs
	Mid Strength External Insulated Cavity Wall 102.5mm facing brickwork 100mm cavity filled with blown mineral fibre insulation 100mm high strength aerated concrete block (7.3N/mm ²) 12.5mm gypsum board on adhesive dabs
	High Strength External Insulated Cavity Wall 102.5mm facing brickwork 100mm cavity filled with blown mineral fibre insulation 100mm high strength aerated concrete block (7.3N/mm ²) 12.5mm gypsum board on adhesive dabs
	External Uninsulated Cavity Wall (to garage, cold roof space etc.) 102.5mm facing brickwork 100mm air cavity 100mm aerated concrete block (2.9N/mm ²)
	Party Wall 100mm aircrete block (3.5N/mm ²) 100mm Party Wall blown glass mineral wool insulation 100mm aircrete block (3.5N/mm ²) 12.5mm gypsum board on adhesive dabs
	Internal Blockwork Partition Between Dwelling and Garage 100mm aerated concrete block (2.9N/mm ²) 70mm British Gypsum Thermaline Super Thermal Laminate Plasterboard on adhesive dabs
	Internal Blockwork Partition 12.5mm gypsum board on adhesive dabs 100mm aerated concrete block (2.9N/mm ²) 12.5mm gypsum board on adhesive dabs
	Structural Stud Partition 12.5mm gypsum board 12.5mm OSB2 sheathing 63 x 38mm timber studs (studs and noggings rotated through 90°) 12.5mm gypsum board 12.5mm OSB2 sheathing
	Non-Load Bearing Stud Partition 12.5mm gypsum board 63 x 38mm timber studs 12.5mm gypsum board
	Stud Partition with Acoustic Insulation 12.5mm gypsum board 63 x 38mm timber studs, with 65mm thick Isover APR 1200 acoustic insulation packed between 12.5mm gypsum board

Note:- all blockwork drawn magenta to be 3.6N/mm²
 Note:- all blockwork drawn blue to be 7.3N/mm²
 Refer to current Bellway Construction Specification for further details

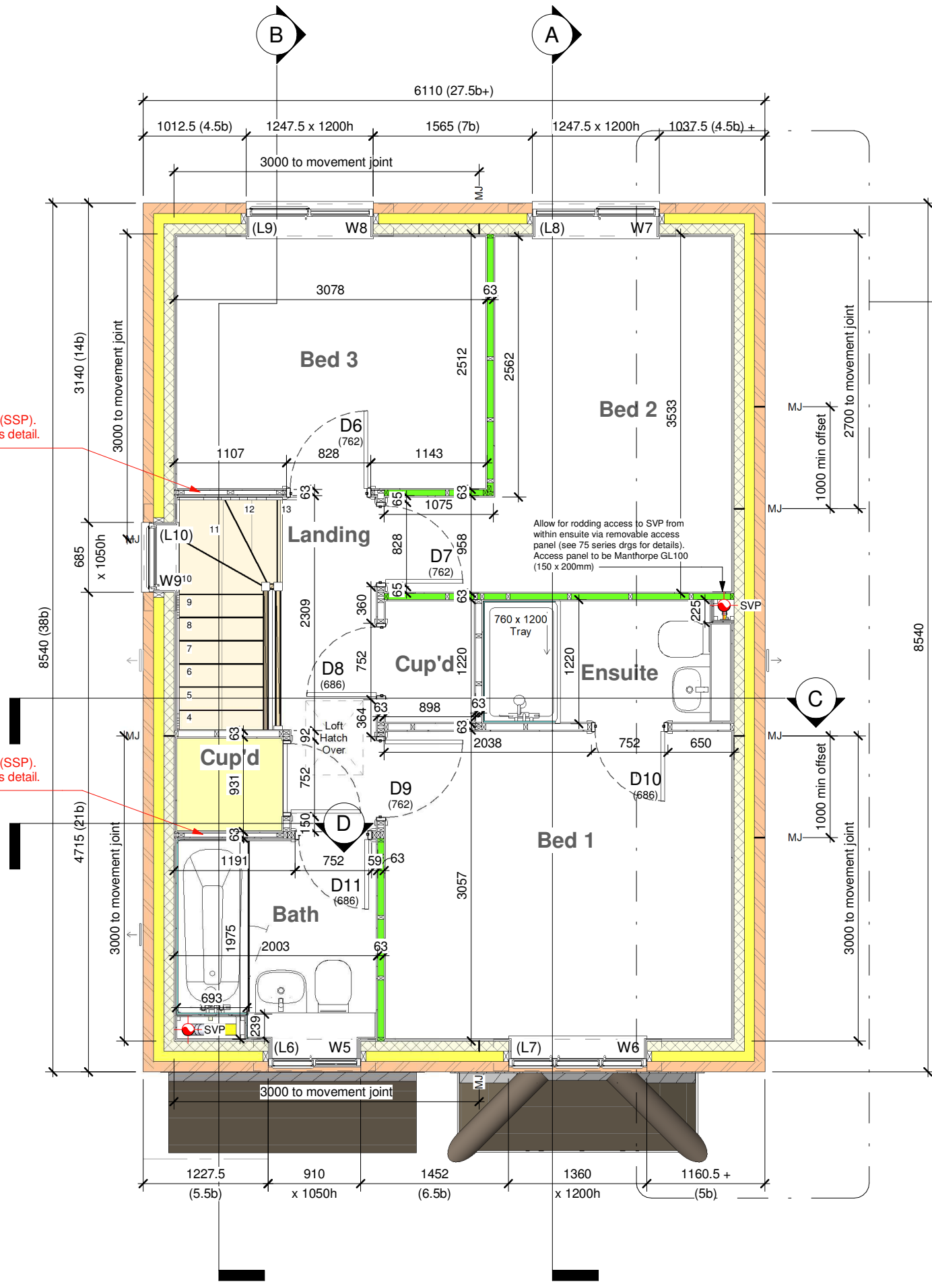

Structural Stud Partition (SSP).
 Refer to Struct Engineers detail.
 Ref: A/SD/S50/B/01

Structural Stud Partition (SSP).
 Refer to Struct Engineers detail.
 Ref: A/SD/S50/B/01

1 First Floor
 1 : 50

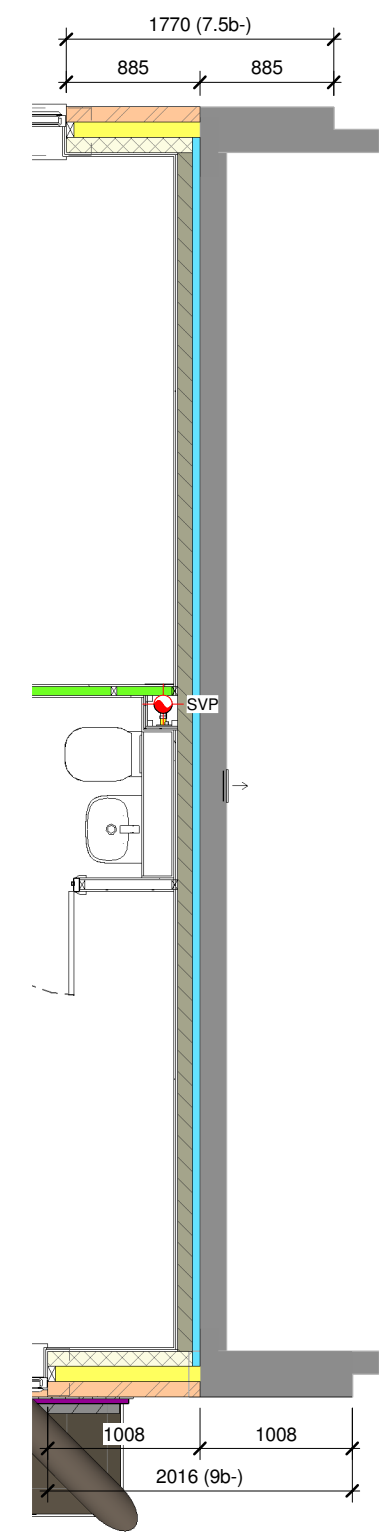

2 FF Call Out - Semi Detached
 1 : 50

CONSTRUCTION www.bellway.co.uk

Bellway Group Technical
 Seaton Burn House, Dudley Lane, Seaton Burn
 Newcastle upon Tyne NE13 6BE
 Tel: 0191 217 0717 | Fax: 0191 236 6230

Project
The Artisan Collection
 2018 Issue
 Working Drawings

Drawing Title
The Chandler
 951 ft² | 3b Det/Semi | All Traditional Variants
 First Floor Setting Out Plan
CH-3B-2S-AT

Drawn By DL	First Issue Date 16 Nov 2018	Scale(s) 1 : 50
Job No	Drg Status Construction	Revision E
Drawing No. A/951/10/AT/02		

Do not scale - if in doubt, ask