

SYMBOL	DESCRIPTION
	13 AMP. TWIN SWITCHED SOCKET OUTLET
	13 AMP. SWITCHED SOCKET OUTLET
	13 AMP UN-SWITCHED SOCKET OUTLET - ONLY WHEN FREE STANDING APPLIANCES
	HARD WIRED 13 AMP UN-SWITCHED SPUR - ONLY WHEN BUILT-IN APPLIANCES
	13 AMP. TWIN SWITCHED SOCKET OUTLET ABOVE WORKTOP
	13 AMP. SWITCHED SOCKET OUTLET ABOVE WORKTOP
	MULTI GRID SWITCH ABOVE WORKTOP CONTROLLING UNSWITCHED SOCKETS BELOW WORKTOP & FAN BOOST SWITCH
	13 AMP. SPUR UNIT
	13 AMP SWITCHED SPUR UNIT
	13 AMP. TWIN SWITCHED SOCKET & USB OUTLET ABOVE WORKTOP
	ONE WAY SWITCH
	TWO WAY SWITCH
	THREE WAY SWITCH
	TELEPHONE POINT
	TELEVISION POINT
	TELECOM ENTRY POINT
	COOKER SWITCH
	CONSUMER SERVICE UNIT, SEMI RECESSED WHERE REQUIRED
	SHAVER POINT AS SITE SPEC
	CEILING LIGHTING POINT - PENDANT TYPE WITH ENERGY EFFICIENT LAMPS
	CEILING LIGHTING POINT - BATTEN TYPE WITH ENERGY EFFICIENT LAMPS
	4-TRACK CEILING LIGHT
	RECESSED SPLASHPROOF ENERGY EFFICIENT DOWNLIGHTER OR LED
	DOWN LIGHTERS, ENERGY EFFICIENT OR LED
	WALL MOUNTED LIGHTING POINT (Fully Diffused Luminaire)
	EXTERNAL WALL MOUNTED SWITCHED LIGHT FITTING - PHOTOCCELL DUSK TO DAWN (Fully Diffused Luminaire)
	CEILING MOUNTED BULKHEAD FITTING
	BATHROOM / EN - SUITE LIGHT FITTING
	PROGRAMMABLE ROOM THERMOSTAT (ALSO ADD TO CYLINDER OPTIONS)
	CONTINUOUS RUNNING EXTRACT FAN
	RECIRCULATING COOKER HOOD
	3 POLE ISOLATOR SWITCH FOR EXTRACT MARKED WITH FAN SYMBOL.
	CENTRAL HEATING WIRING JUNCTION BOX
	RADIATOR
	SMOKE DETECTOR
	HEAT DETECTOR (WHERE APPLICABLE)
	REMOTE TEST FOR LOFT SMOKE DETECTOR
	COMBINED SMOKE DETECTOR AND HEAT DETECTOR
	CO ALARM
	GAS POINT
	BOILER
	GAS METER
	ELECTRIC METER
	SHOWER HEAD
	EXTERNAL WATER TAP
	DOOR BELL & CHIME
	a) THERMOSTATIC MIXING VALVE DEVICE FITTED TO BATH
	b) WATER SAVING RESTRICTORS FITTED TO TAPS & SHOWERS
	c) WATER USAGE WILL NOT EXCEED 125 LITRES PER PERSON PER DAY TO COMPLY WITH APPROVED DOCUMENT G (Apr 2010)
	<b>VENTILATION REQUIREMENTS</b> WC & BATHROOM/ENSUITE (no window) - BOOST VIA LIGHT SWITCH WITH BUILT IN HUMIDISTAT & TIMER, WC & BATHROOM/ENSUITE (with window) - BOOST VIA BUILT IN HUMIDISTAT & TIMER PLUS MANUAL BOOST SWITCH (NOT LIGHT SWITCH).

Only Curtain Pole to be installed  
Material: Wooden  
Design: Simple

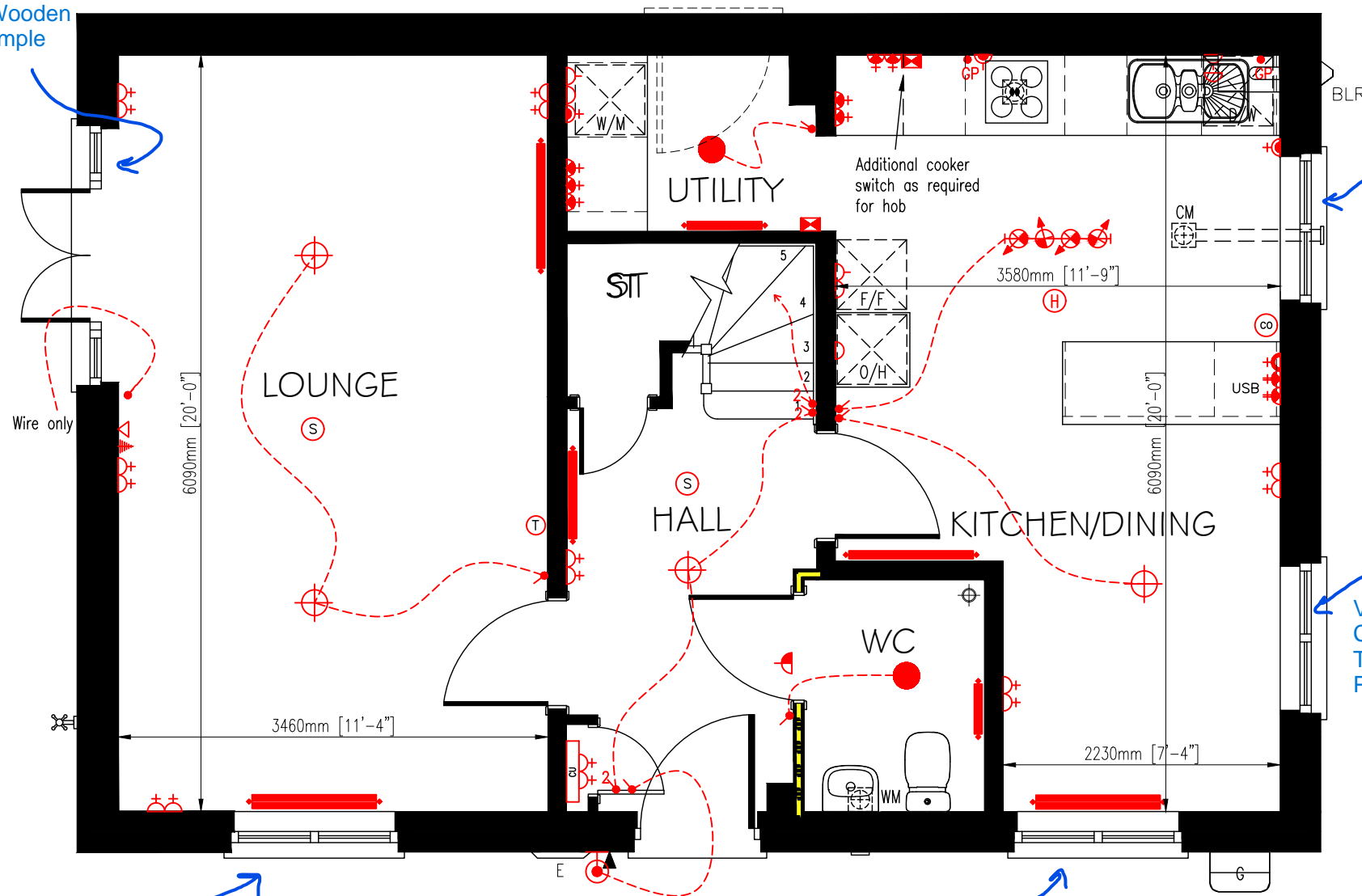

GROUND FLOOR PLAN (OPP)

Venetian Blinds - Faux Wood  
Colour: Light oak  
Taped: No  
Pelmet: Yes

Venetian Blinds - Faux Wood  
Colour: Light oak  
Taped: No  
Pelmet: Yes

Venetian Blinds - Faux Wood  
Colour: Light oak  
Taped: No  
Pelmet: Yes

Venetian Blinds - Faux Wood  
Colour: Light oak  
Taped: No  
Pelmet: Yes

**Taylor Wimpey**

Title: TRUSDALE  
CUSTOMER SERVICES  
GROUND FLOOR PLAN-OPP

Dwg No: NT41/WIX /113 F

Scale: 1 : 50 @ A3 Date: JUN 2021

Taylor Wimpey UK Ltd

Gate House, Turnpike Road,  
High Wycombe, Bucks HP12 3NR  
Tel 01494 558323 Fax 01494 885663  
www.taylorwimpey.com

THIS DRAWING SHOWS THE STANDARD SPECIFICATION FOR PLOT .  
IT DOES NOT SHOW ANY AMENDMENTS OR OPTIONS ORDERED BY  
THE CUSTOMER OUTSIDE OF THE STANDARD SPECIFICATION.

THIS PLAN IS NOT TO BE SCALED FOR SPECIFIC DETAILED LOCATIONS  
OF ANY ITEMS NOTED ON IT.

ALL ROOM DIMENSIONS ARE + OR - 50mm

SYMBOL	DESCRIPTION
	13 AMP. TWIN SWITCHED SOCKET OUTLET
	13 AMP. SWITCHED SOCKET OUTLET
	13 AMP UN-SWITCHED SOCKET OUTLET - ONLY WHEN FREE STANDING APPLIANCES
	HARD WIRED 13 AMP UN-SWITCHED SPUR - ONLY WHEN BUILT-IN APPLIANCES
	13 AMP. TWIN SWITCHED SOCKET OUTLET ABOVE WORKTOP
	13 AMP. SWITCHED SOCKET OUTLET ABOVE WORKTOP
	MULTI GRID SWITCH ABOVE WORKTOP CONTROLLING UNSWITCHED SOCKETS BELOW WORKTOP & FAN BOOST SWITCH
	13 AMP. SPUR UNIT
	13 AMP SWITCHED SPUR UNIT
	13 AMP. TWIN SWITCHED SOCKET & USB OUTLET ABOVE WORKTOP
	ONE WAY SWITCH
	TWO WAY SWITCH
	THREE WAY SWITCH
	TELEPHONE POINT
	TELEVISION POINT
	TELECOM ENTRY POINT
	COOKER SWITCH
	CONSUMER SERVICE UNIT, SEMI RECESSED WHERE REQUIRED
	SHAVER POINT AS SITE SPEC
	CEILING LIGHTING POINT - PENDANT TYPE WITH ENERGY EFFICIENT LAMPS
	CEILING LIGHTING POINT - BATTEN TYPE WITH ENERGY EFFICIENT LAMPS
	4-TRACK CEILING LIGHT
	RECESSED SPLASHPROOF ENERGY EFFICIENT DOWNLIGHTER OR LED
	DOWN LIGHTERS, ENERGY EFFICIENT OR LED
	WALL MOUNTED LIGHTING POINT (Fully Diffused Luminaire)
	EXTERNAL WALL MOUNTED SWITCHED LIGHT FITTING - PHOTOCCELL DUSK TO DAWN (Fully Diffused Luminaire)
	CEILING MOUNTED BULKHEAD FITTING
	BATHROOM / EN-SUITE LIGHT FITTING
	PROGRAMMABLE ROOM THERMOSTAT (ALSO ADD TO CYLINDER OPTIONS)
	CONTINUOUS RUNNING EXTRACT FAN
	RECIRCULATING COOKER HOOD
	3 POLE ISOLATOR SWITCH FOR EXTRACT MARKED WITH FAN SYMBOL.
	CENTRAL HEATING WIRING JUNCTION BOX
	RADIATOR
	SMOKE DETECTOR
	HEAT DETECTOR (WHERE APPLICABLE)
	REMOTE TEST FOR LOFT SMOKE DETECTOR
	COMBINED SMOKE DETECTOR AND HEAT DETECTOR
	CO ALARM
	GAS POINT
	BOILER
	GAS METER
	ELECTRIC METER
	SHOWER HEAD
	EXTERNAL WATER TAP
	DOOR BELL & CHIME
	a) THERMOSTATIC MIXING VALVE DEVICE FITTED TO BATH
	b) WATER SAVING RESTRICTORS FITTED TO TAPS & SHOWERS
	c) WATER USAGE WILL NOT EXCEED 125 LITRES PER PERSON PER DAY TO COMPLY WITH APPROVED DOCUMENT G (Apr 2010)
	VENTILATION REQUIREMENTS
	WC & BATHROOM/ENSUITE (no window) - BOOST VIA LIGHT SWITCH WITH BUILT IN HUMIDISTAT & TIMER, WC & BATHROOM/ENSUITE (with window) - BOOST VIA BUILT IN HUMIDISTAT & TIMER PLUS MANUAL BOOST SWITCH (NOT LIGHT SWITCH).

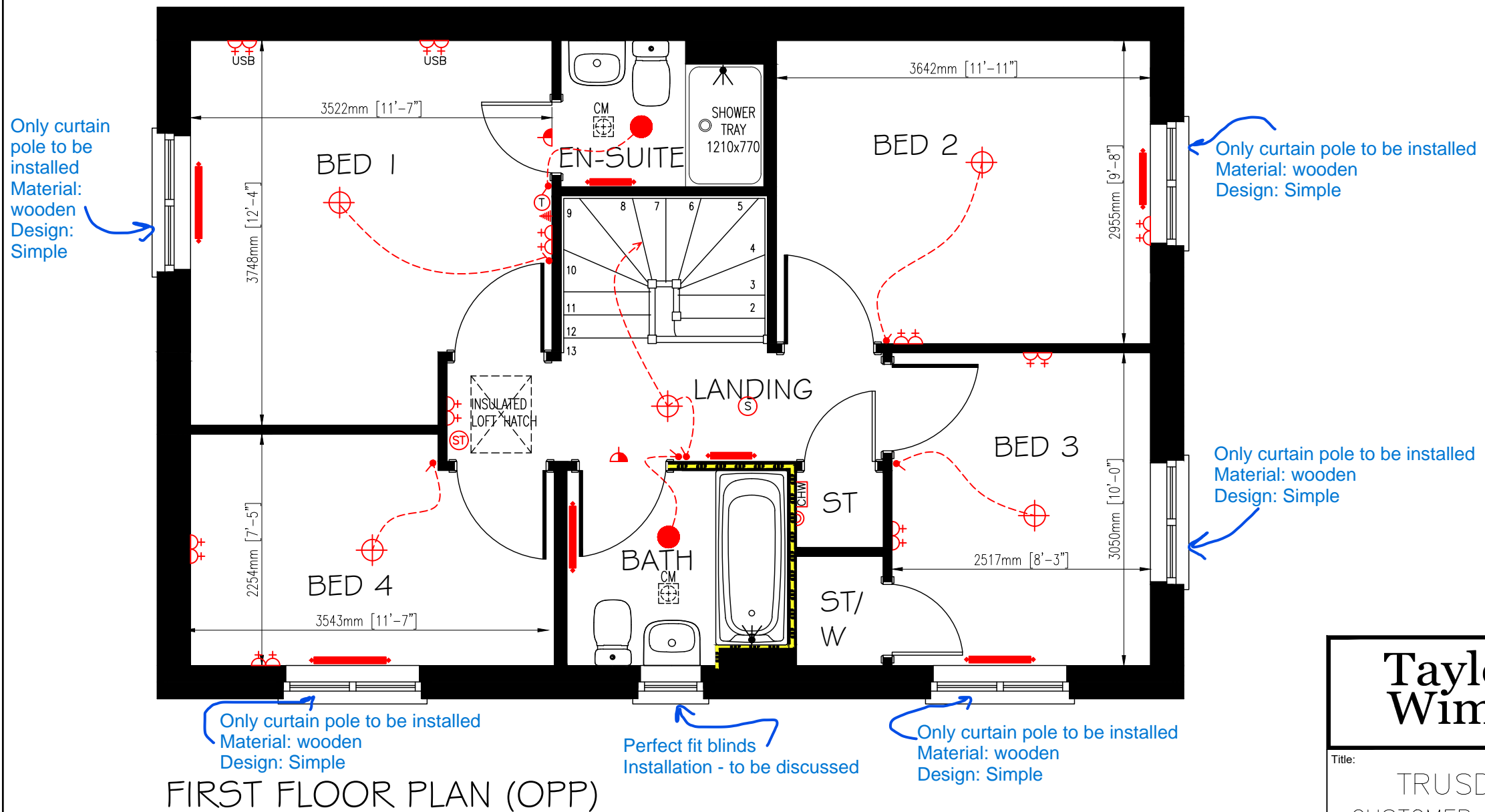

FIRST FLOOR PLAN (OPP)

**Taylor Wimpey**

Title: TRUSDALE CUSTOMER SERVICES FIRST FLOOR PLAN-OPP

Dwg No: NT41/WIX /114 F

Scale: 1 : 50 @ A3 Date: JUN 2021

Taylor Wimpey UK Ltd  
Gate House, Turnpike Road,  
High Wycombe, Bucks HP12 3NR  
Tel 01494 558323 Fax 01494 885663  
www.taylorwimpey.com

THIS DRAWING SHOWS THE STANDARD SPECIFICATION FOR PLOT . IT DOES NOT SHOW ANY AMENDMENTS OR OPTIONS ORDERED BY THE CUSTOMER OUTSIDE OF THE STANDARD SPECIFICATION.

THIS PLAN IS NOT TO BE SCALED FOR SPECIFIC DETAILED LOCATIONS OF ANY ITEMS NOTED ON IT.

ALL ROOM DIMENSIONS ARE + OR - 50mm