

NOTE:  
 1. THIS DRAWING IS BASED ON EXISTING INFORMATION/DRAWINGS PROVIDED BY THE CLIENT.  
 2. ALL LOOSE FURNITURE IS TO BE PROVIDED BY THE TENANT / WARRENPOINT HC. LAYOUTS ARE INDICATIVE.  
 3. DRAWING TO BE READ IN CONJUNCTION WITH ARCHITECT'S SPECIFICATION

This document has been prepared in accordance with the scope of Collins Rolston's appointment with its client and is subject to the terms of that appointment. Collins Rolston accepts no liability for any use of this document other than by its client and only for the purposes for which it was prepared and provided. Only written dimensions will be used.  
 © Collins Rolston Architects

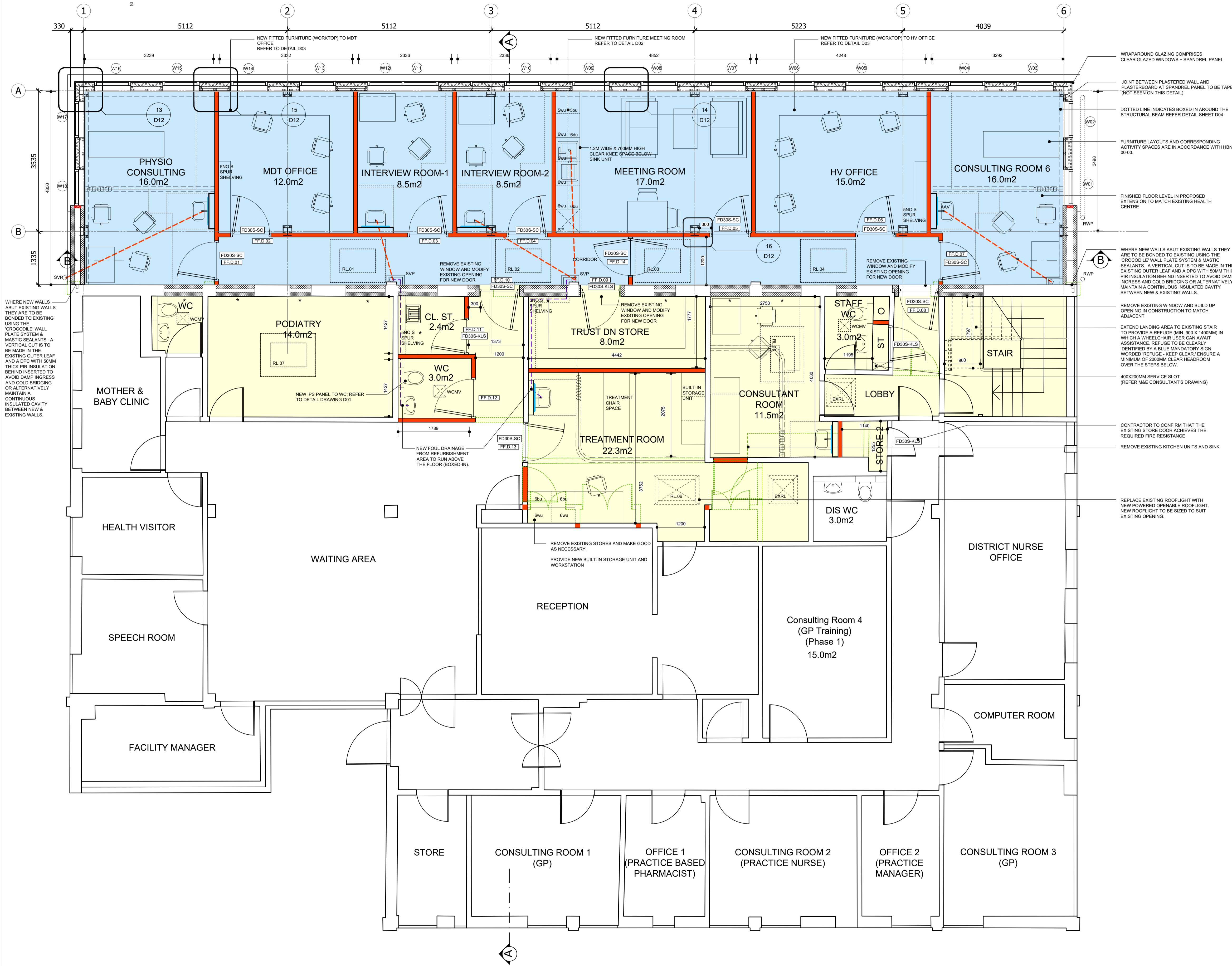

**KEY**

- NEW 120MM STUD WALLS
- WORKS AREA - EXTENSION
- WORKS AREA - REFURBISHMENT
- PHASE 1 - CONSULTING ROOM (EXISTING)
- NEW CAVITY WALL
- DEMOLITION
- PROPOSED ROOFLIGHTS
- EXISTING ROOFLIGHTS
- WCMV WC MECHANICAL VENT THROUGH ROOF
- PROPOSED FOUL DRAINAGE PASSING THROUGH SCREEN
- NEW FOUL DRAINAGE FROM REFURBISHMENT AREA TO RUN ABOVE THE FLOOR (BOXED-IN)
- FD30S-SC 30 MINUTES, SELF-CLOSING FIRE RESISTANT DOOR & FRAME WITH SMOKE SEALS
- FD30S-KLS 30 MINUTES FIRE RESISTANT DOOR & FRAME WITH SMOKE SEALS - KEPT LOCKED SHUT
- CURTAIN TACK

**KEY TO KITCHEN UNITS**

- 6bu (600X600)MM BASE UNIT
- 6du (600X300)MM DRAWER UNIT
- 6wu (600X300)MM WALL UNIT
- 6su (600X300)MM BASE UNIT
- 6sw (600X300)MM WALL UNIT
- F/F (600X600)MM SPACE FOR FRIDGE

WHERE NEW WALLS ABUT EXISTING WALLS THEY ARE TO BE BOXED TO EXISTING USING THE 'CROCODILE' WALL PLATE SYSTEM & MASTIC SEALANTS. A VERTICAL CUT IS TO BE MADE IN THE EXISTING OUTER LEAF AND A DPC WITH 50MM THICK PIR INSULATION BEHIND INSERTED TO AVOID DAMP INGRESS AND COLD BRIDGING OR ALTERNATIVELY MAINTAIN A CONTINUOUS INSULATED CAVITY BETWEEN NEW & EXISTING WALLS.

REMOVE EXISTING WINDOW AND BUILD UP OPENING IN CONSTRUCTION TO MATCH ADJACENT.

EXTEND LANDING AREA TO EXISTING STAIR TO PROVIDE A REFUGE (MIN. 900 X 1400MM) IN WHICH A WHEELCHAIR USER CAN AWAIT ASSISTANCE. REFUGE TO BE CLEARLY IDENTIFIED BY A BLUE MANDATORY SIGN WORDED 'REFUGE - KEEP CLEAR'. ENSURE A MINIMUM OF 2000MM CLEAR HEADROOM OVER THE STEPS BELOW.

400X200MM SERVICE SLOT (REFER M&E CONSULTANT'S DRAWING)

CONTRACTOR TO CONFIRM THAT THE EXISTING STORE DOOR ACHIEVES THE REQUIRED FIRE RESISTANCE

REMOVE EXISTING KITCHEN UNITS AND SINK

REPLACE EXISTING ROOFLIGHT WITH NEW POWERED OPERABLE ROOFLIGHT. NEW ROOFLIGHT TO BE SIZED TO SUIT EXISTING OPENING.

Rev	Description	Date/By
I	Layout changes to refurbishment area (request by Client)	29 JAN 26/JW
II	Increase store size for comm. unit (as discussed site mtg 7)	14 JAN 26/JW
G	Layout changes to refurbishment area (request by Client)	17 DEC 25/JW
F	RL08 and Roof access hatch removed (request by Client)	12 NOV 25/JW
E	Updates as requested by Client	18 NOV 24/DL
D	Updates as requested by Client/ Building Control	08 SEP 24/SS
C	Mechanical extract fans omitted from Offices	25 APR 24/CKC
B	Updates after project team meeting	26 MAR 24/SS
A	Updates to reflect change to traditional procurement.	11 MAR 24/SS

Project Name and Address  
**PROPOSED EXTENSION TO EXISTING HEALTH CENTER AT WARRENPOINT HEALTH CENTER, SUMMERHILL, WARRENPOINT, BT34 3JD.**

Client  
**SOUTHERN HEALTH AND SOCIAL CARE TRUST**

Drawing  
**PROPOSED FIRST FLOOR PLAN**

Project Reference <b>23.1187</b>	Depg No. <b>WD04</b>	Rev. <b>I</b>
Scale <b>1:50 / A1</b> <b>1:100 / A3</b>	Drawn <b>SS</b>	Checked <b>OL</b>
Date <b>04 DEC 23</b>		