

SG6100 White with SG6650

Fit bottom of profile 2100mm from floor

Floor to suspended ceiling 2300mm to 2420mm

Floor to underside of joists 2680mm to 2650mm

Treatment Room supply 2 roughwood timber battens 800 x 44 x 44 for grounds for hanger under timber joists

This document has been prepared in accordance with the scope of Collins Rolston's appointment with its client and is subject to the terms of that appointment. Collins Rolston accepts no liability for any use of this document other than by its client and only for the purposes for which it was prepared and provided. Only written dimensions will be used. © Collins Rolston Architects.

KEY

- NEW 120MM STUD WALLS
- WORKS AREA - EXTENSION
- WORKS AREA - REFURBISHMENT
- PHASE 1 - CONSULTING ROOM (EXISTING)
- NEW CAVITY WALL
- DEMOLITION
- PROPOSED ROOFLIGHTS
- EXISTING ROOFLIGHTS
- WCMV WC MECHANICAL VENT THROUGH ROOF
- PROPOSED FOUL DRAINAGE PASSING THROUGH SCREED
- NEW FOUL DRAINAGE FROM REFURBISHMENT AREA TO RUN ABOVE THE FLOOR (BOXED-IN)
- 30 MINUTES, SELF-CLOSING FIRE RESISTANT DOOR & FRAME WITH SMOKE SEALS
- 30 MINUTES FIRE RESISTANT DOOR & FRAME WITH SMOKE SEALS - KEPT LOCKED SHUT
- CURTAIN TACK

KEY TO KITCHEN UNITS

- 6bu (600X900)MM BASE UNIT
- 6du (600X300)MM DRAWER UNIT
- 6su (600X300)MM WALL UNIT
- 6bu (600X900)MM BASE UNIT
- 6su (600X300)MM WALL UNIT
- F/F (600X600)MM SPACE FOR FRIDGE

NOTE:
 1. THIS DRAWING IS BASED ON EXISTING INFORMATION/DRAWINGS PROVIDED BY THE CLIENT.
 2. ALL LOOSE FURNITURE IS TO BE PROVIDED BY THE TENANT / WARRENPOINT HC. LAYOUTS ARE INDICATIVE.
 3. DRAWING TO BE READ IN CONJUNCTION WITH ARCHITECT'S SPECIFICATION

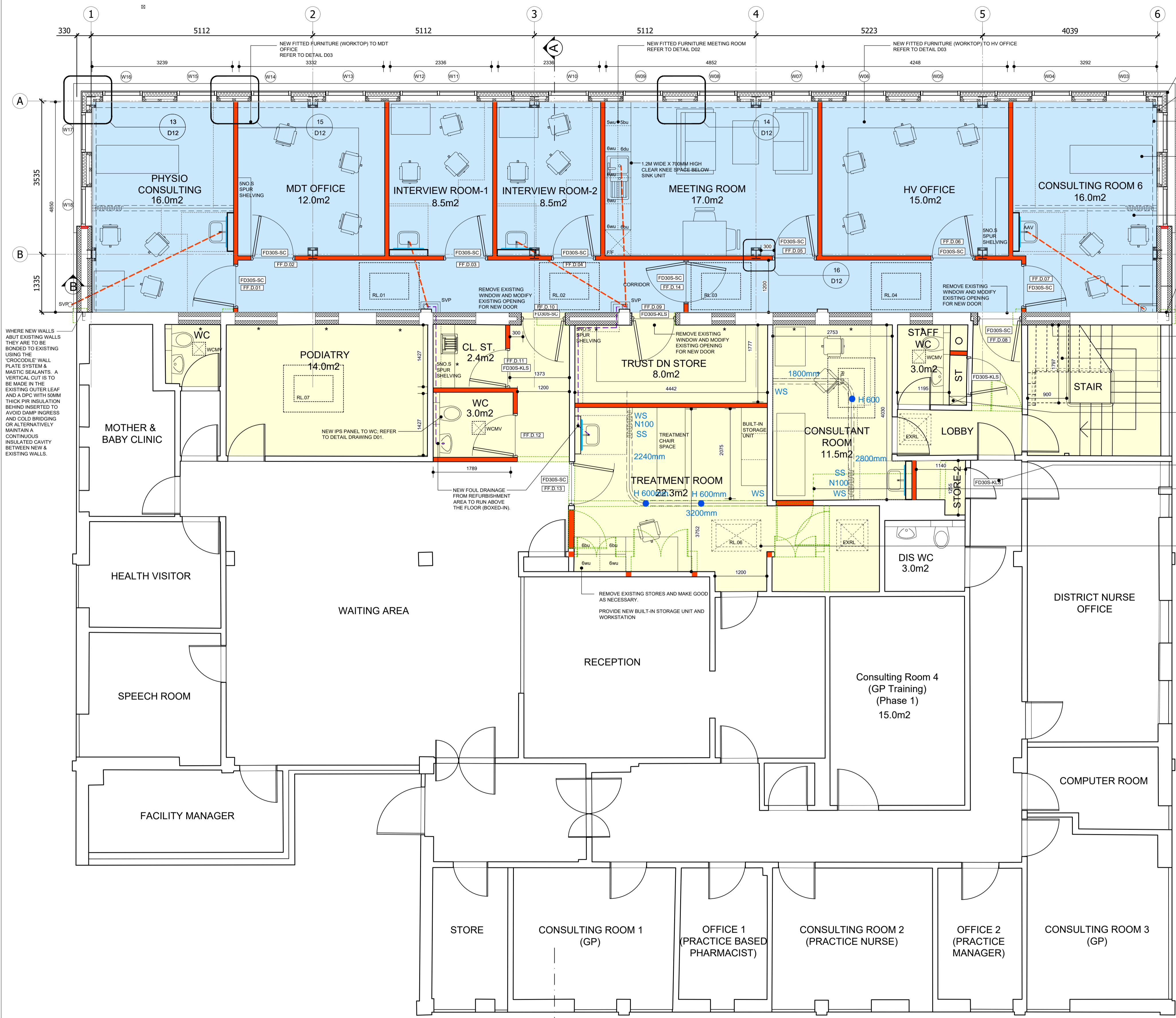

WRAPAROUND GLAZING COMPRISES CLEAR GLAZED WINDOWS + SPANDREL PANEL

JOINT BETWEEN PLASTERED WALL AND PLASTERBOARD AT SPANDREL PANEL TO BE TAPED (NOT SEEN ON THIS DETAIL)

DOTTED LINE INDICATES BOXED-IN AROUND THE STRUCTURAL BEAM REFER DETAIL SHEET D04

FURNITURE LAYOUTS AND CORRESPONDING ACTIVITY SPACES ARE IN ACCORDANCE WITH HEN 00-03.

FINISHED FLOOR LEVEL IN PROPOSED EXTENSION TO MATCH EXISTING HEALTH CENTRE

WHERE NEW WALLS ABUT EXISTING WALLS THEY ARE TO BE BOXED TO EXISTING USING THE 'CROCODILE' WALL PLATE SYSTEM & MASTIC SEALANTS. A VERTICAL CUT IS TO BE MADE IN THE EXISTING OUTER LEAF AND A DPC WITH 50MM THICK PIR INSULATION BEHIND INSERTED TO AVOID DAMP INGRESS AND COLD BRIDGING OR ALTERNATIVELY MAINTAIN A CONTINUOUS INSULATED CAVITY BETWEEN NEW & EXISTING WALLS.

REMOVE EXISTING WINDOW AND BUILD UP OPENING IN CONSTRUCTION TO MATCH ADJACENT

EXTEND LANDING AREA TO EXISTING STAIR TO PROVIDE A REFUGE (MIN. 900 X 1400MM) IN WHICH A WHEELCHAIR USER CAN AWAIT ASSISTANCE. REFUGE TO BE CLEARLY IDENTIFIED BY A BLUE MANDATORY SIGN WORDED 'REFUGE - KEEP CLEAR'. ENSURE A MINIMUM OF 2000MM CLEAR HEADROOM OVER THE STEPS BELOW.

400X200MM SERVICE SLOT (REFER M&E CONSULTANT'S DRAWING)

CONTRACTOR TO CONFIRM THAT THE EXISTING STORE DOOR ACHIEVES THE REQUIRED FIRE RESISTANCE

REMOVE EXISTING KITCHEN UNITS AND SINK

REPLACE EXISTING ROOFLIGHT WITH NEW POWERED OPERABLE ROOFLIGHT. NEW ROOFLIGHT TO BE SIZED TO SUIT EXISTING OPENING.

WHERE NEW WALLS ABUT EXISTING WALLS THEY ARE TO BE BONDED TO EXISTING USING THE 'CROCODILE' WALL PLATE SYSTEM & MASTIC SEALANTS. A VERTICAL CUT IS TO BE MADE IN THE EXISTING OUTER LEAF AND A DPC WITH 50MM THICK PIR INSULATION BEHIND INSERTED TO AVOID DAMP INGRESS AND COLD BRIDGING OR ALTERNATIVELY MAINTAIN A CONTINUOUS INSULATED CAVITY BETWEEN NEW & EXISTING WALLS.

Rev	Description	Date/By
I	Layout changes to refurbishment area (request by Client)	29 JAN 26/JW
II	Increase store size for comm. unit (as discussed site mtg 7)	14 JAN 26/JW
G	Layout changes to refurbishment area (request by Client)	17 DEC 25/JW
F	RL08 and Roof access hatch removed (request by Client)	12 NOV 25/JW
E	Updates as requested by Client	18 NOV 24/DL
D	Updates as requested by Client/ Building Control	08 SEP 24/SS
C	Mechanical extract fans omitted from Offices	25 APR 24/CJK
B	Updates after project team meeting	26 MAR 24/SS
A	Updates to reflect change to traditional procurement.	11 MAR 24/SS

Project Name and Address
PROPOSED EXTENSION TO EXISTING HEALTH CENTER AT WARRENPOINT HEALTH CENTER, SUMMERHILL, WARRENPOINT, BT34 3JD.

Client
SOUTHERN HEALTH AND SOCIAL CARE TRUST

Drawing
PROPOSED FIRST FLOOR PLAN

Project Reference	Dep. No.	Rev.
23.1187	WD04	I

Scale: 1:50 / A1
 1:100 / A3

Drawn: SS
 Checked: OL
 Date: 04 DEC 23