



Consulting Room 10

Consulting Room 11

Consulting Room 1:

UPVC CONNECTION

UPVC CONNECTION

DRAINAGE CONNECTION & WATER PIPEWORK TO BE INSTALLED WITH ACCESS FOR

PROPOSED FRAMED OUT CEILING MOUNTED ROUTE FOR INSTALLED A/C REFRIGERANT PIPEWORK TO OUTDOOR SPLIT SYSTEM A/C UNIT.

Corridor 3

NEW DOOR OPENING FORMED WHERE PREVIOUSLY BLOCKED UP

FORMATION OF NEW DOOR OPENING REQUIRED

NEW DOOR OPENING FORMED WHERE PREVIOUSLY BLOCKED UP

FORMATION OF NEW DOOR OPENING REQUIRED

FORMATION OF NEW DOOR OPENING REQUIRED

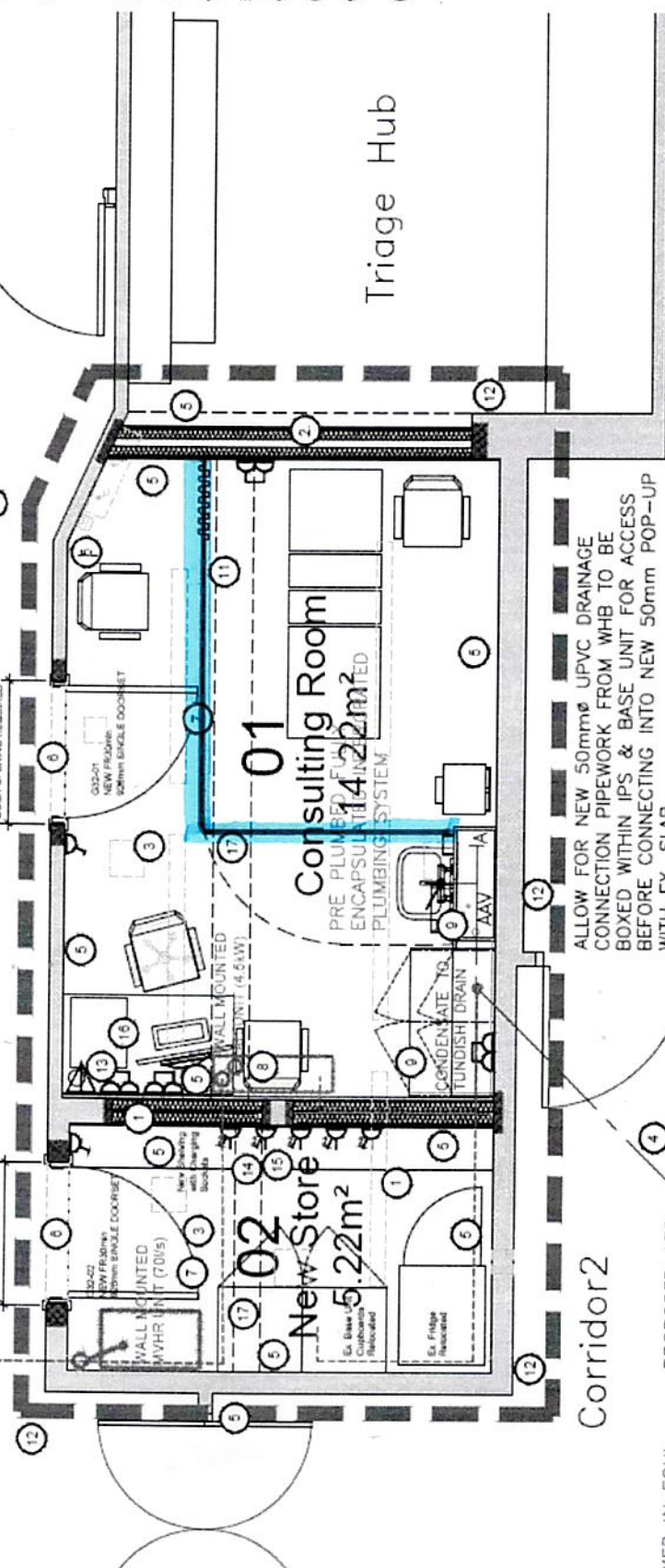

Corridor 2

ALLOW FOR NEW 50mm Ø UPVC DRAINAGE CONNECTION PIPEWORK FROM WHB TO BE BOXED WITHIN IPS & BASE UNIT FOR ACCESS BEFORE CONNECTING INTO NEW 50mm POP-UP WITH EX. SLAB.

ALLOW FOR BREAKING INTO EX. BOXED IN SOIL STACK, ALLOW FOR 50mm BRANCH CONNECTION TO BE MADE ON TO EX. STACK TO ALLOW PROPOSED 50mm UPVC PIPEWORK RUN WITHIN SLAB, ALLOW FOR A 135° DRAINAGE BEND TO BE FITTED TO ALTERED DRAINAGE DIRECTION WITHIN EX. SLAB OVER TO NEW IPS/BASE UNIT.

BOXED IN FOUL DRAINAGE SOIL STACK

PROPOSED 135° CONNECTION

ALLOW FOR BREAKING INTO EX. BOXED IN SOIL STACK, ALLOW FOR 50mm BRANCH CONNECTION TO BE MADE ON TO EX. STACK TO ALLOW PROPOSED 50mm UPVC PIPEWORK RUN WITHIN SLAB, ALLOW FOR A 135° DRAINAGE BEND TO BE FITTED TO ALTERED DRAINAGE DIRECTION WITHIN EX. SLAB OVER TO NEW IPS/BASE UNIT.

1 Allow for the formation of new door opening in Consulting Room 10 & 11. Provide door at either side of opening with surface to match existing. Provide door at either side of opening with surface to match existing.

2 Allow for the formation of new door opening in Consulting Room 11. Provide door at either side of opening with surface to match existing. Provide door at either side of opening with surface to match existing.

3 Ex. existing finish to be retained. Provide new finish to match existing. Provide new finish to match existing.

4 Where required for access to corridor & 11. Provide door at either side of opening with surface to match existing. Provide door at either side of opening with surface to match existing.

5 Allow for paint to be applied to all walls & ceilings in all rooms. Provide paint to match existing. Provide paint to match existing.

6 Allow for 200mm x 200mm x 200mm ceiling tiles to be installed in all rooms. Provide ceiling tiles to match existing. Provide ceiling tiles to match existing.

7 Allow for the supply & fit of single sitting desks. Provide desks to match existing. Provide desks to match existing.

8 Allow for supply & fit of office chairs. Provide chairs to match existing. Provide chairs to match existing.

9 Allow for supply & fit of office desks. Provide desks to match existing. Provide desks to match existing.

10 Allow for supply & fit of office chairs. Provide chairs to match existing. Provide chairs to match existing.

11 Allow for supply & fit of office desks. Provide desks to match existing. Provide desks to match existing.

12 Allow for supply & fit of office chairs. Provide chairs to match existing. Provide chairs to match existing.

13 Allow for supply & fit of office desks. Provide desks to match existing. Provide desks to match existing.

14 Allow for supply & fit of office chairs. Provide chairs to match existing. Provide chairs to match existing.

15 Allow for supply & fit of office desks. Provide desks to match existing. Provide desks to match existing.

16 Allow for supply & fit of office chairs. Provide chairs to match existing. Provide chairs to match existing.

17 Allow for supply & fit of office desks. Provide desks to match existing. Provide desks to match existing.

18 Allow for supply & fit of office chairs. Provide chairs to match existing. Provide chairs to match existing.

19 Allow for supply & fit of office desks. Provide desks to match existing. Provide desks to match existing.

20 Allow for supply & fit of office chairs. Provide chairs to match existing. Provide chairs to match existing.

21 Allow for supply & fit of office desks. Provide desks to match existing. Provide desks to match existing.

22 Allow for supply & fit of office chairs. Provide chairs to match existing. Provide chairs to match existing.

23 Allow for supply & fit of office desks. Provide desks to match existing. Provide desks to match existing.

24 Allow for supply & fit of office chairs. Provide chairs to match existing. Provide chairs to match existing.

25 Allow for supply & fit of office desks. Provide desks to match existing. Provide desks to match existing.

26 Allow for supply & fit of office chairs. Provide chairs to match existing. Provide chairs to match existing.

27 Allow for supply & fit of office desks. Provide desks to match existing. Provide desks to match existing.

28 Allow for supply & fit of office chairs. Provide chairs to match existing. Provide chairs to match existing.

29 Allow for supply & fit of office desks. Provide desks to match existing. Provide desks to match existing.

30 Allow for supply & fit of office chairs. Provide chairs to match existing. Provide chairs to match existing.

31 Allow for supply & fit of office desks. Provide desks to match existing. Provide desks to match existing.



MACKIE R

01224 839295

mail@mrrarchitect

www.mrrarchitect

Project

NHSGrar

Banchory

Dee Street

Drawing

FORMATIO

CONSULTI

PROPOSEI

Scale