

Living room - Zenith white wooden blind.
Curtains? Piper silver - drop to floor - just
above window.

281

296

652

619

Master bedroom - Zenith white wooden blind.
Roman blind over top - Spirit silver.

602
272

287

732

695

Second bedroom - Zenith white wooden blind.

175

166

Third bedroom - Little stars silver - Roman blind.
Blackout?

371

352

Kitchen - on door - Range A - OISO.
Any sheer finish ones? Will look into this
once made in.

140

133

Bathroom -

- Will come back for this.

Thurs 24/2
10-12

Sales

From: Holly Allan <holly_allan@hotmail.co.uk>
Sent: Monday, January 31, 2022 1:44 PM
To: Sales
Subject: Re: Pricing for new build

Follow Up Flag: Follow up
Flag Status: Completed

Ryan will be at sales office

Hello,

Thanks for your email please see better explanation below.

1572 x 1353 STAN

Living room- W1- 1601x1425mm - require wooden slated blinds, curtain pole and curtains. *1106x1050 612x670 PA 2100 STAN COAT* *Price when* (296)

Master bedroom- W2 - 1151x1125 & W6-656x750mm require wooden slated blinds. *750x1050 size on size + 100mm depth of 14200* *Price when* (112) (175) (437) (295)

Bathroom - W3-656x1125mm - roman blind *614x1047 1/2 - 753x1150 - OPS SIZE ON SIZE + 100mm ASO-G PA 2100 21* (371)

3rd Bedroom - W5-656x1125mm - roman blind

Second bedroom- W5 - 1151x1425mm - wooden slated blind. *1105x1045 STAN 14200* *Price when* (175)

I do not have a measurement for the perfect blinds in the kitchen patio doors yet and would require a pole and curtains here too. *Door 695 x 1756 W4 0150* (140)

Would it be possible for you to organise to go out?

The sales office is Barratt at Countesswells and it plot 62 the Coull, Holly Allan & Duncan Hardisty.

Thanks,
Holly

Ryan- Sales Advisor
01224 054244
Call when on way.

~~CANT DO SIDE PANELS~~
TOO NARROW
FOR P/PT SO
ONE STANDING
BAND

Get Outlook for iOS

From: Sales <sales@aberdeen-blinds.co.uk>
Sent: Monday, January 31, 2022 1:29:45 PM
To: Holly Allan <holly_allan@hotmail.co.uk>
Subject: RE: Pricing for new build

Good morning

Thank you for sending this through – I am struggling to see which doors are which and what rooms have what windows, the plan won't seem to load it's just blurry on my screen, I have priced up the below based on the sizes (from what I can make out) from the list below, we would need to get one of our boys out to measure just to get the correct measurements, they usually do let us gain access to measure, we would arrange this via yourself or directly with the housing office.

- 1 x 610 x 1981
- Perfect Fit Roller - £190
- Perfect Fit Pleated - £227

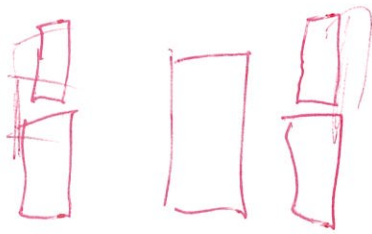

2290

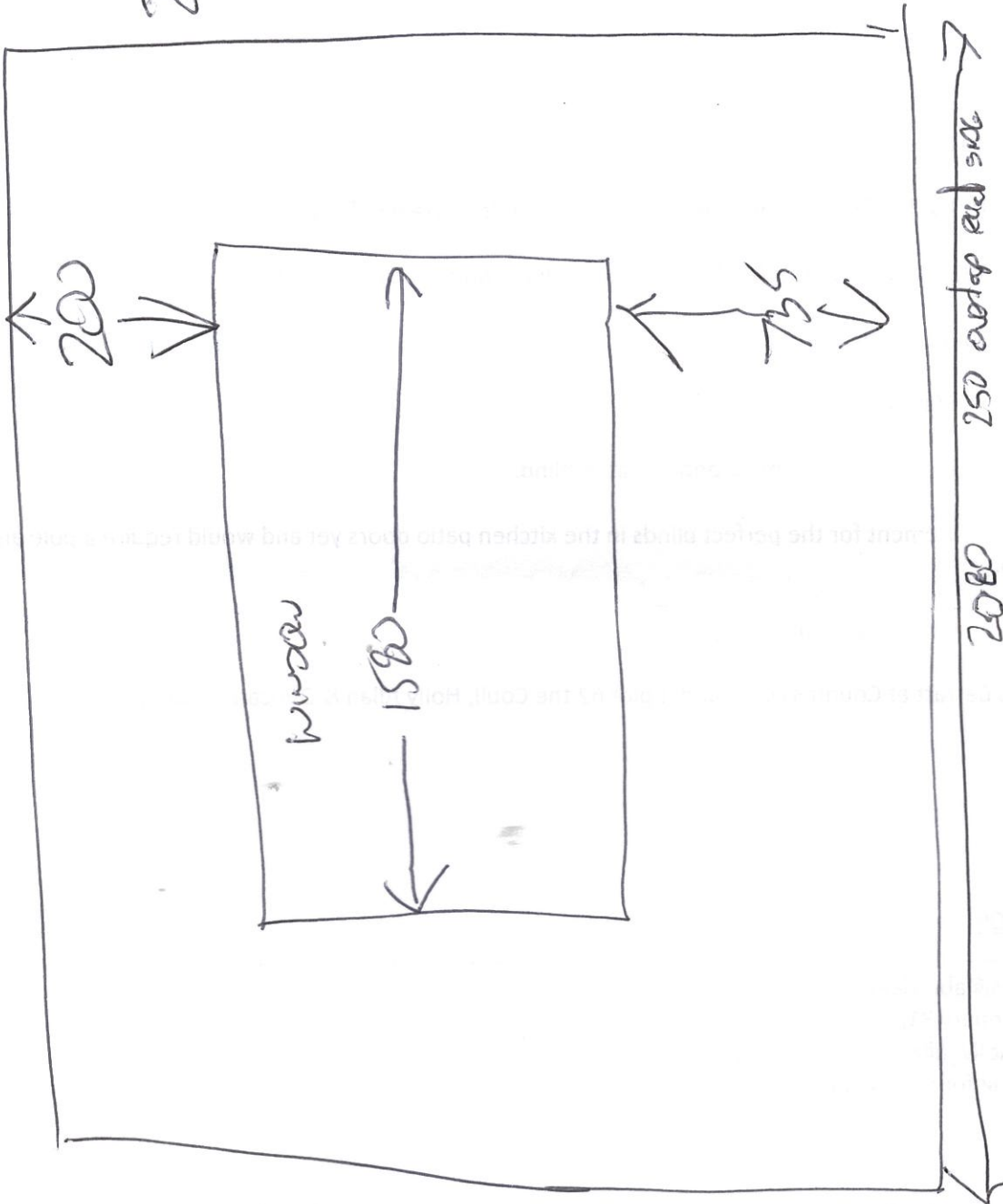

2080 250 outer and side